

**TECHNICAL MANUAL**  
**ORGANIZATIONAL, DIRECT SUPPORT, AND**  
**GENERAL SUPPORT MAINTENANCE REPAIR**  
**PARTS AND SPECIAL TOOLS LIST**  
**(INCLUDING DEPOT MAINTENANCE REPAIR**  
**PARTS AND SPECIAL TOOLS)**  
**FOR**  
**TERMINAL, TELEGRAPH AN/TSC-58**  
**(NSN 5805-00-089-8365)**  
**(Less Power)**  
**AND**  
**TERMINAL, TELEGRAPH**  
**AN/TSC-58A**  
**(NSN 5805-01-095-6232)**  
**(Less Power)**

---

**HEADQUARTERS, DEPARTMENT OF THE ARMY**

**26 APRIL 1983**

TECHNICAL MANUAL }  
 No. 11-5805-574-24P }

HEADQUARTERS  
 DEPARTMENT OF THE ARMY,  
 WASHINGTON, DC, 26 April 1983

**ORGANIZATIONAL, DIRECT SUPPORT, AND GENERAL SUPPORT  
 MAINTENANCE REPAIR PARTS AND SPECIAL TOOLS LIST  
 (INCLUDING DEPOT MAINTENANCE REPAIR PARTS  
 AND SPECIAL TOOLS)  
 FOR  
 TERMINAL, TELEGRAPH AN/TSC-58  
 (NSN 5805-00-089-8365) (Less Power)  
 AND  
 TERMINAL, TELEGRAPH AN/TSC-58A  
 (NSN 5805-01-095-6232) (Less Power)**

Current as of 12 November 1982

**REPORTING ERRORS AND RECOMMENDING IMPROVEMENTS**  
 You can help improve this manual. If you find any mistakes or if you know of a way to improve the procedures, please let us know. Mail your letter, DA Form 2028 (Recommended Changes to Publications and Blank Forms), or DA Form 2028-2 located in the back of this manual directly to: Commander, US Army Communications-Electronics Command and Fort Monmouth, ATTN: DRSEL-ME-MP, Fort Monmouth, NJ 07703.  
 In either case, a reply will be furnished direct to you.

**Table of Contents**

		Page	Illus Figure
SECTION	I. Introduction .....	1	
	II. Repair Parts List.....	5	
GROUP	00 Terminal, Telegraph AN/TSC-58 and AN/TSC-58A .....	5	1
	Shelter, Modified S-348A/TSC-58A, Curbside .....	9	2
	Shelter, Modified S-348A/TSC58A, Roadside.....	13	3
	Holder, Battery Assembly .....	15	4
	01 Communications Security Equipment TSEC/KW-7 (See TM 11-5810-221-12P for parts)		
	02 Distribution Box J-1077A/U (See TM 11-6110-201-12P for parts)		
	03 Intercommunication Station LS-147C/F1 (See TM 11-5830-221-24P for parts)		

\*This manual supersedes TM 11-5805-574-24P, 30 June 1977, including Change 1, 6 December 1979.

**Table of Contents-Continued**

	Page	Illus Figure
04	Low Level Signaling Device TT-523/GGC (See TM 11-5815-338-40P for parts)	
05	Telephone Set TA-312/PT (See TM 11-5805-201-34P for parts)	
06	Teletypewriter, Reperforator-Transmitter TT-76B/GGC (See TM 11-5815-238-34P for parts)	
07	Terminal, Communications AN/UGS-74A(V)3 (See TM 11-5815-602-34P for parts)	
08	Telegraph Terminal TH-22/TG (See TM 11-5805-356-34P-1 for parts)	
09	Switchboard, Telephone, Manual SB-22PT (See TM 11-5820-262-34P for parts)	
10	Shelter, Electrical Equipment S-348/TSC-58 and S-348A/TSC-58A, Curbside Wall .....	17
	Welded Rack Assembly .....	19
	KW-7 Equipment Shelf .....	21
	Shelter, Electrical Equipment S-348/TSC-58 and S-348A/TSC-58A, Roadside Wall.....	23
	Shelter, Electrical Equipment S-348/TSC-58 and S-348A/TSC-58A, Ceiling Plan.....	25
	Shelter, Electrical Equipment S-348/TSC-58 and S-348A/TSC-58A, Front Wall.....	27
	Shelter, Electrical Equipment S-348/TSC-58 and S-348A/TSC-58A, Rear Wall.....	29
	Shelter, Electrical Equipment S-348/TSC-58 and S-348A/TSC-58A, Power Box.....	31
	Shelter, Electrical Equipment S-348/TSC-58 and S-348A/TSC-58A, Signal Entrance Box.....	33
	Shelter, Electrical Equipment S-348/TSC-58 and S-348A/TSC-58A, Block Power Distribution Panel.....	35
	Shelter, Electrical Equipment S-348/TSC-58 and S-348A/TSC-58A, Red Power Distribution Panel.....	37
	Shelter, Electrical Equipment S-348/TSC-58 and S-348A/TSC-58A, Auxiliary-Dummy Box ..	39
	Shelter, Electrical Equipment S-348/TSC-58 and S-348A/TSC-58A, Interconnection Box.....	41
	1001 Air Conditioner, 9,000 BTU/HR (See TM 5-4120-282-13 for parts)	
	1002 Heater, Space (No parts authorized)	
	1003 Cable Assembly, Power, Electrical CX-7453A/U.....	43
	1004 Cable Assembly, Power, Electrical CX-7705A/U.....	45
	1005 Cable Assembly, Telephone CX-4566A/U .....	47
	1006 Cable Assembly, Telephone CX-4760A/U .....	49
	1007 Special Purpose Cable SC-D-960025-001 .....	51
	1008 AC Power Cable SC-D-960025-000.....	53
	1009 Cable Assembly, Signal SC-D-960324.....	55
SECTION III.	Special Tools List (Not applicable)	
IV.	National Stock Number and Part Number Index .....	56

**SECTION I**

**INTRODUCTION**

**1. Scope**

This manual lists spares and repair parts; special tools; special test, measurement, and diagnostic equipment (TMDE), and other special support equipment required for performance of organizational, direct support, and general support maintenance of the AN/TSC-58 and AN/TSC-58A. It authorizes the requisitioning and issue of spares and repair parts as indicated by the source and maintenance codes.

**2. General**

This Repair Parts and Special Tools List is divided into the following sections:

a. *Section II. Repair Parts List.* A list of spares and repair parts authorized for use in the performance of maintenance. The list also includes parts which must be removed for replacement of the authorized parts. Parts lists are composed of functional groups in numeric sequence, with the parts in each group listed in figure and item number sequence.

b. *Section III. Special Tools List.* Not applicable.

c. *Section IV. National Stock Number and Part Number Index.* A list, in National item identification number (NIIN) sequence, of all National stock numbers (NSN) appearing in the listings, followed by a list, in alphanumeric sequence, of all part numbers appearing in the listings. National stock numbers and part numbers are cross-referenced to each illustration figure and item number appearance.

**3. Explanation of Columns**

a. *Illustration.* This column is divided as follows:

(1) *Figure number.* Indicates the figure number of the illustration on which the item is shown.

(2) *Item number.* The number used to identify item called out in the illustration.

b. *Source, Maintenance, and Recoverability (SMR) Codes.*

(1) *Source code.* Source codes indicate the manner of acquiring support items for maintenance, repair, or overhaul of end items. Source codes are entered in the first and second positions of the Uniform SMR Code format as follows:

<i>Code</i>	<i>Definition</i>
PA-	Item procured and stocked for anticipated or known usage.
PD-	Support item, excluding support equipment, procured for initial issue or outfitting and stocked only for subsequent or additional initial issues or outfittings. Not subject to automatic replenishment.
MD-	Item to be manufactured or fabricated at the depot maintenance level.
XA-	Item is not procured or stocked because the requirements for the item will result in the replacement of the next higher assembly.
XB-	Item is not procured or stocked. If not available through salvage, requisition.
XD-	A support item that is not stocked. When required, item will be procured through normal supply channels.

**NOTE**

Cannibalization or salvage may be used as a source of supply for any items source coded above except those coded XA and aircraft support items as restricted by AR 700-42.

(2) *Maintenance code.* Maintenance codes are assigned to indicate the levels of maintenance authorized to USE and REPAIR support items. The maintenance codes are entered in the third and fourth positions of the Uniform SMR Code format as follows:

(a) The maintenance code entered in the third position will indicate the lowest maintenance level authorized to remove, replace, and use the support item. The maintenance code entered in the third position will indicate one of the following levels of maintenance:

<i>Code</i>	<i>Application/Explanation</i>
O-	Support item is removed, replaced, used at the organizational level.
F-	Support item is removed, replaced, used at the direct support level.
H-	Support item is removed, replaced, used at the general support level.

(b) The maintenance code entered in the fourth position indicates whether the item is to be repaired and identifies the lowest maintenance level with the capability to perform complete repair (i.e., all authorized maintenance functions). This position will contain one of the following maintenance codes:

<i>Code</i>	<i>Application/Explanation</i>
O-	The lowest maintenance level capable of complete repair of the support item is the organizational level.
F-	The lowest maintenance level capable of complete repair of the support item is the direct support level.
H-	The lowest maintenance level capable of complete repair of the support item is the general support level.
D-	The lowest maintenance level capable of complete repair of the support item is the depot level.
Z-	nonrepairable. No repair is authorized.

(3) *Recoverability code.* Recoverability codes are assigned to support items to indicate the disposition action on unserviceable items. The recoverability code is entered in the fifth position of the Uniform SMR Code format as follows:

<i>Recoverability codes</i>	<i>Definition</i>
Z-	nonrepairable item. When unserviceable, condemn and dispose at the level indicated in position 3.
O-	Reparable item. When uneconomically repairable, condemn and dispose at organizational level.
F-	Reparable item. When uneconomically repairable, condemn and dispose at the direct support level.
H-	Reparable item. When uneconomically repairable, condemn and dispose at the general support level.

c. *National Stock Number.* Indicates the National stock number assigned to the item and will be used for requisitioning purposes.

d. *Federal Supply Code for Manufacturer (FSCM).* The FSCM is a 5-digit numeric code listed in SB 708-41/42 which is used to identify the manufacturer, distributor, or Government agency, etc.

e. *Part Number.* Indicates the primary number used by the manufacturer (individual, company, firm, corporation, or Government activity), which controls the design and characteristics of the item by means of its engineering drawings, specifications, standards, and inspection requirements to identify an item or range of items

**NOTE**

When a stock numbered item is requisitioned, the repair part received may have a different part number than the part being replaced.

f. *Description.* Indicates the Federal item name and, if required, a minimum description to identify the item.

g. *Unit of Measure (U/M).* Indicates the standard of the basic quantity of the listed item as used in performing the actual maintenance function. This measure is expressed by a two-character alphabetical abbreviation (e.g., EA, in, pr, etc.). When the unit of measure differs from the unit of issue, the lowest unit of issue that will satisfy the required units of measure will be requisitioned.

h. *Quantity Incorporated in Unit.* Indicates the quantity of the item used in the breakout shown on the illustration figure, which is prepared for a functional group, subfunctional group, or an assembly. A "V" appearing in this column in lieu of a quantity indicates that no specific quantity is applicable, (e.g., shims, spacers, etc.).

**4. Special Information**

a. Usable on codes are shown in the description column. Uncoded items are applicable to all models. Identification of the usable on codes used in this publication are:

<i>Code</i>	<i>Used on</i>
2QU	AN/TSC-58
EHB	AN/TSC-58A

b. Detailed manufacturing instructions for items source coded to be manufactured or fabricated are found in TM 11-5805-574-15.

c. The following publications pertain to the AN/TTC-38(V)1 and the AN/TTC-38(V)2 and their components:

TM 5-4120-282-13, Air Conditioner, Floor Mounted, Air Cooled, Electric Motor Driven, 3/4 HP, 60 Hz, AC, Single Phase; 9,000 BTU/HR (Harvey W. Hattel Inc. Model MAC-750M), (Keco Model F-9000-2), (Columbia Specialty Model CAS9000) and (Redmanson Model A-9000).

TM 11-5805-201-12, Telephone Set, TA-312/PT.

TM 11-5805-201-20P, Telephone Set, TA-312/PT.

TM 11-5805-201-34P, Telephone Set, TA-312/PT.

TM 11-5805-201-35, Telephone Set, TA-312/PT.

TM 11-5805-262-12, Switchboards, Telephone, Manual, SB-22/PT and SB-22A/PT and Adapter, Tone Signaling, TA-977/PT.

TM11-5805-262-20P, Switchboards, Telephone, Manual, SB-22/P,T-and SB-22A/PT.

- TM 11-5805-262-34P, Switchboards, Telephone, Manual, SB-22/PT and SB-22A/PT.
- TM 11-5805-262-35, Switchboards, Telephone, Manual, SB-22/PT and SB-22A/PT.
- TM 11-5805-356-12, Terminal, Telegraph Telephone AN/TCC-29 (Including Terminal, Telegraph TH-22/TG and Converter, Telegraph Telephone Signal CV-425/U).
- TM 11-5805-356-34-1, Terminal, Telegraph, TH-22/TG and Filter Assembly, Electrical, F-316/U.
- TM 11-5805-356-34P-1, Terminal, Telegraph TH-22/TG.
- TM 11-5805-574-15, Terminal, Telegraph, AN/TSC-58 (Less Power) and AN/TSC-58A (Less Power).
- TM 11-5810-221-12P, Communications Security Equipment TSEC/KW-7, TSEC/KW-7 with KW-10/TSEC.
- TM 11-5810-221-34P, Communications Security Equipment TSEC/KW-7-2.
- TM 11-5815-238-12, Teletypewriter Sets, AN/GGC-3, AN/GGC-34A, AN/GGC-53 and AN/GGC-53A and Teletypewriter, Reperforator Transmitters, TT-76/GGC, TT-76A/GGC, TT-76B/GGC, TT-76C/GGC, TT-699/GGC, TT-699A/GGC, TT-699B/GGC and TT-699C/GGC.
- TM 11-5815-238-20P, Teletypewriter Sets, AN/GGC-3 and AN/GGC-3A and Teletypewriters, Reperforator-Transmitters, TT-76/GGC, TT-76A/GGC, TT-76B/GGC and TT-76C/GGC.
- TM 11-5815-238-34P, Teletypewriter Sets, AN/GGC-3, AN/GGC-3A, AN/GGC-53 and AN/GGC-53A and Teletypewriter, Reperforator Transmitters, TT-76/GGC, TT-76A/GGC, TT-76B/GGC, TT-76C/GGC, TT-699/GGC, TT-699A/GGC, TT-699B/GGC and TT-699C/GGC.
- TM 11-5815-238-35, Teletypewriter Sets, AN/GGC-3, AN/GGC-3A, AN/GGC-53 and AN/GGC-53A and Teletypewriter, Reperforator Transmitters, TT-76/GGC, TT-76A/GGC, TT-76B/GGC, TT-76C/GGC, TT-699/GGC, TT-699A/GGC, TT-699B/GGC and TT-699C/GGC.
- TM 11-5830-221-12, Intercommunication Stations, LS-147A/F1, LS-147B/F1, LS-147C/F1 and LS-147D/F1.
- TM 11-5815-388-15, Device, Low Level Signaling, TT-523/GGC and TT-523A/GGC.
- TM 11-5815-338-40P, Device, Low Level Signaling, TT-523A/GGC.
- TM 11-5805-574-24P
- TM 11-5815-602-12, Terminal, Communications, AN/UGC-74A(V)3.
- TM 11-5815-602-20P, Terminal, Communications, AN/UGC-74A(V)3.
- TM 11-5815-602-34, Terminal, Communications, AN/UGC-74A(V)3.
- TM 11-5815-602-34P, Terminal, Communications, AN/UGC-74A(V)3.
- TM 11-6110-201-12P, Distribution Boxes, J-1077/U and J-1077A/U.
- TM 11-6110-201-34P, Distribution Boxes, J-1077/U and J-1077A/U.

d. National stock numbers (NSN's) that are missing from P source coded items have been applied for and will be added to this TM by future change/revision when they are entered in the Army Master Data File (AMDF). Until the NSN's are established and published, submit exception requisitions to: Commander, US Army Communications-Electronics Command and Fort Monmouth, ATTN: DRSEL-MM, Fort Monmouth, NJ 07703 for the part required to support your equipment.

**5. How to Locate Repair Parts**

a. When National stock number or part number is unknown.

(1) *First.* Using the table of contents, determine the functional group within which the item belongs. This is necessary since illustrations are prepared for functional groups and listings are divided into the same groups.

(2) *Second.* Find the illustration covering the functional group to which the item belongs.

(3) *Third.* Identify the item on the illustration and note the illustration figure and item number of the item.

(4) *Fourth.* Using the Repair Parts Listing, find the figure and item number noted on the illustration.

b. When National stock number or part number is known.

(1) *First.* Using the Index of National Stock Numbers and Part Numbers, find the pertinent National stock number or part number. This index is in NIIN sequence followed by a list of part numbers in alphanumeric sequence, cross-referenced to the illustration figure number and item number.

(2) *Second.* After finding the figure and item number, locate the figure and item number in the repair parts list.

**6. Abbreviations**

Not applicable.

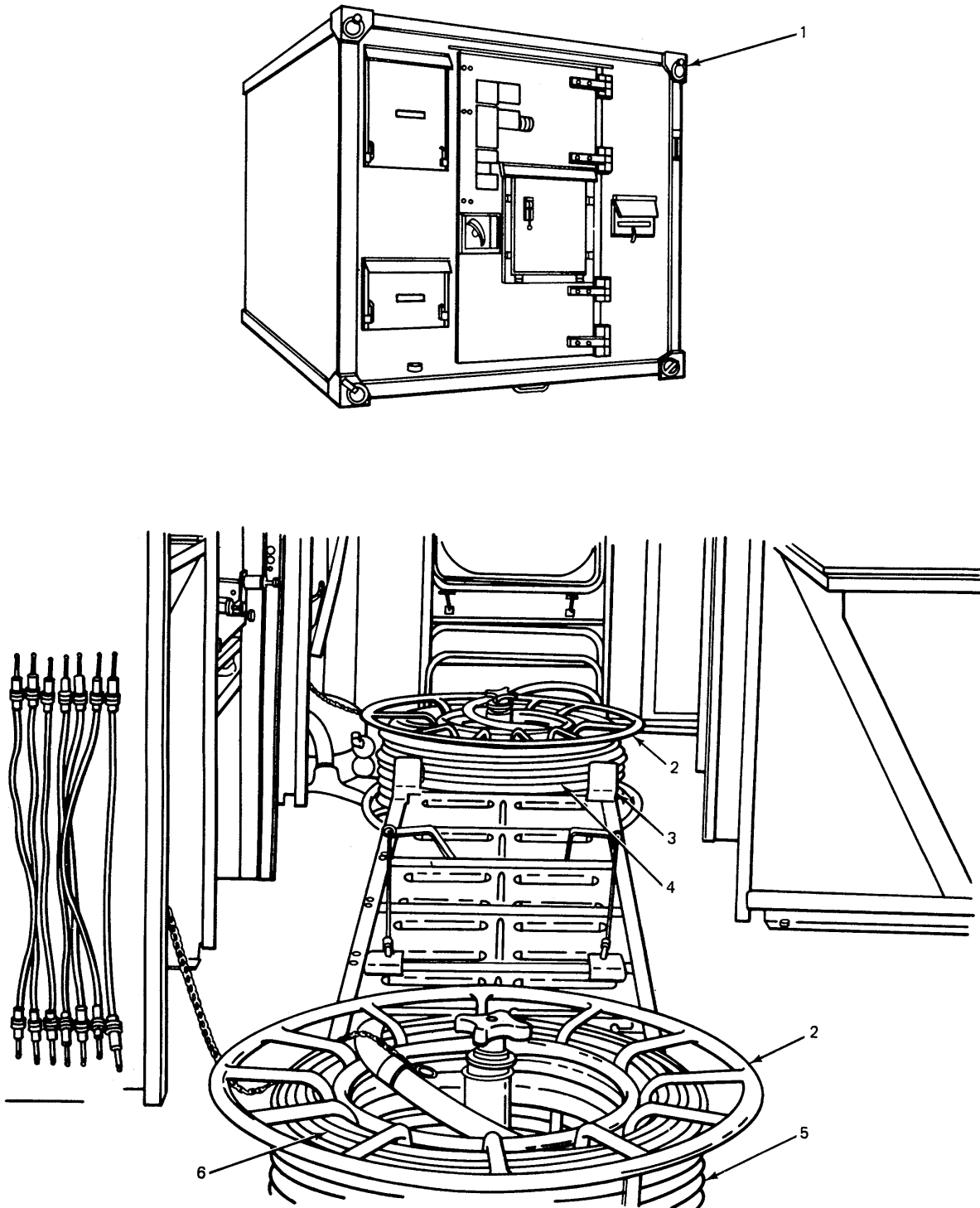

EL3GZ001

Figure 1. Terminal, Telegraph AN/TSC-58 and AN/TSC-58A.

**SECTION II**

**TM 11-5805-574-24P**

(1) ILLUS- TRATION		(2)	(3)	(4)	(5)	(6)	(7)	(8)
(a) FIG NO.	(b) ITEM NO.	SMR CODE	NATIONAL STOCK NUMBER	FSCM	PART NUMBER	DESCRIPTION	USABLE ON CODE	U/M INC IN UNIT
						<b>GROUP 00 TERMINAL, TELEGRAPH ANTSC-58 AND ANTSC-58A</b>		
1	1	PAOOF	5411-00-404-5965	80058	S-348/TSC-58	SHELTER NONEXPANDAB.....2QU	EA	1
1	1	PDODD		80058	S-348/TSC-58A	SHELTER, ELECTRICAL .....EHB	EA	1
1	2	PAOZZ	5995-00-143-9858	80058	RC-435/U	CABLE ASSEMBLY AND .....	EA	2
1	3	PAOHH	5995-00-985-7571	80058	CX-4566A/G	CABLE ASSEMBLY, TELE .....	EA	1
1	4	PAHHH	5995-00-889-0803	80058	CX-4760A/U	CABLE ASSEMBLY .....	EA	1
1	5	XDOOO		80058	CX-7453A/U	CABLE ASSEMBLY .....	EA	1
1	6	PAOOF	5995-00-935-2686	80058	CX-7705A/U	CABLE ASSEMBLY .....	EA	1



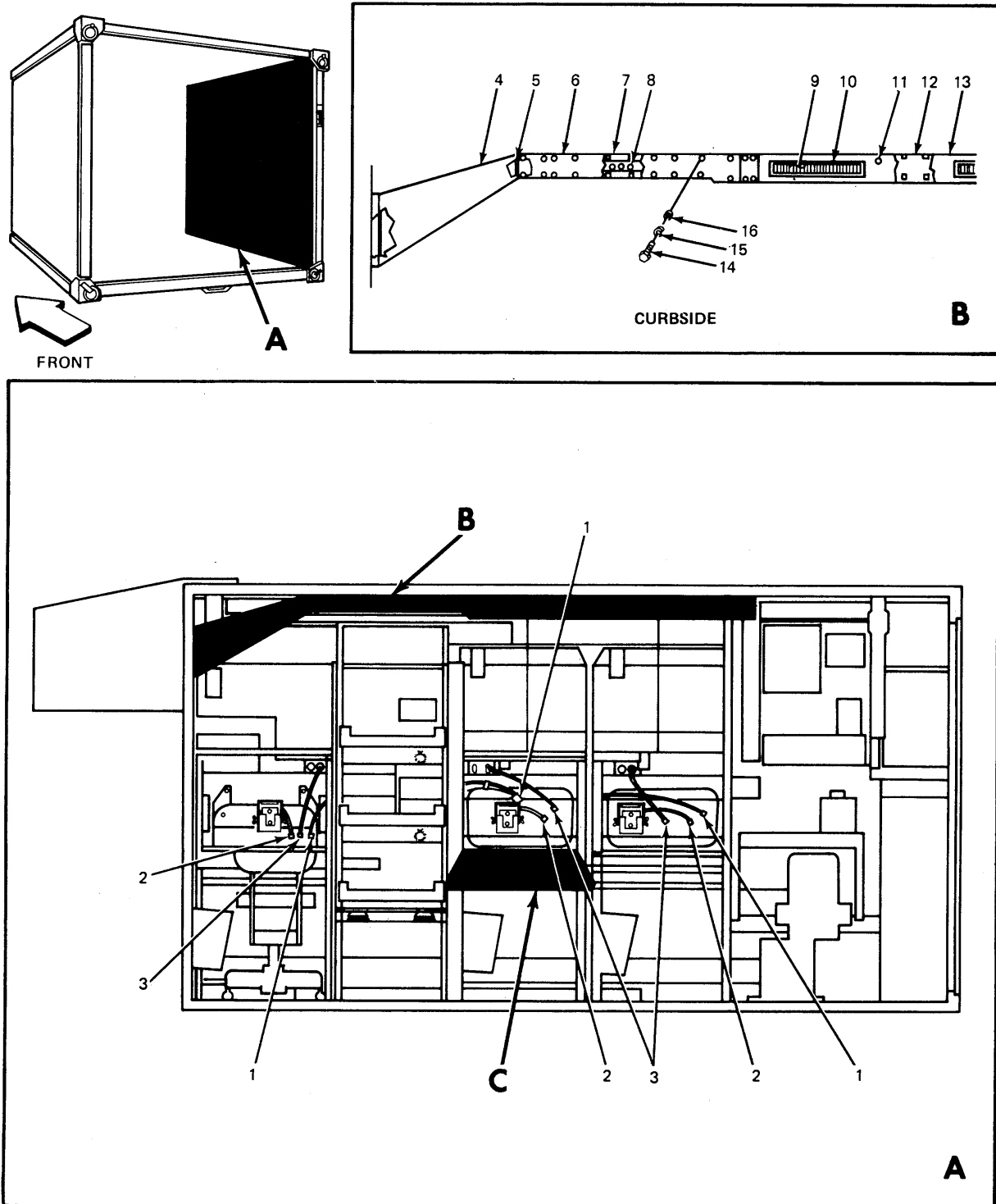

EL3GZ002

Figure 2. Shelter, Modified S-348A/TSC-58A, Curbside (Sheet 1 of 2).

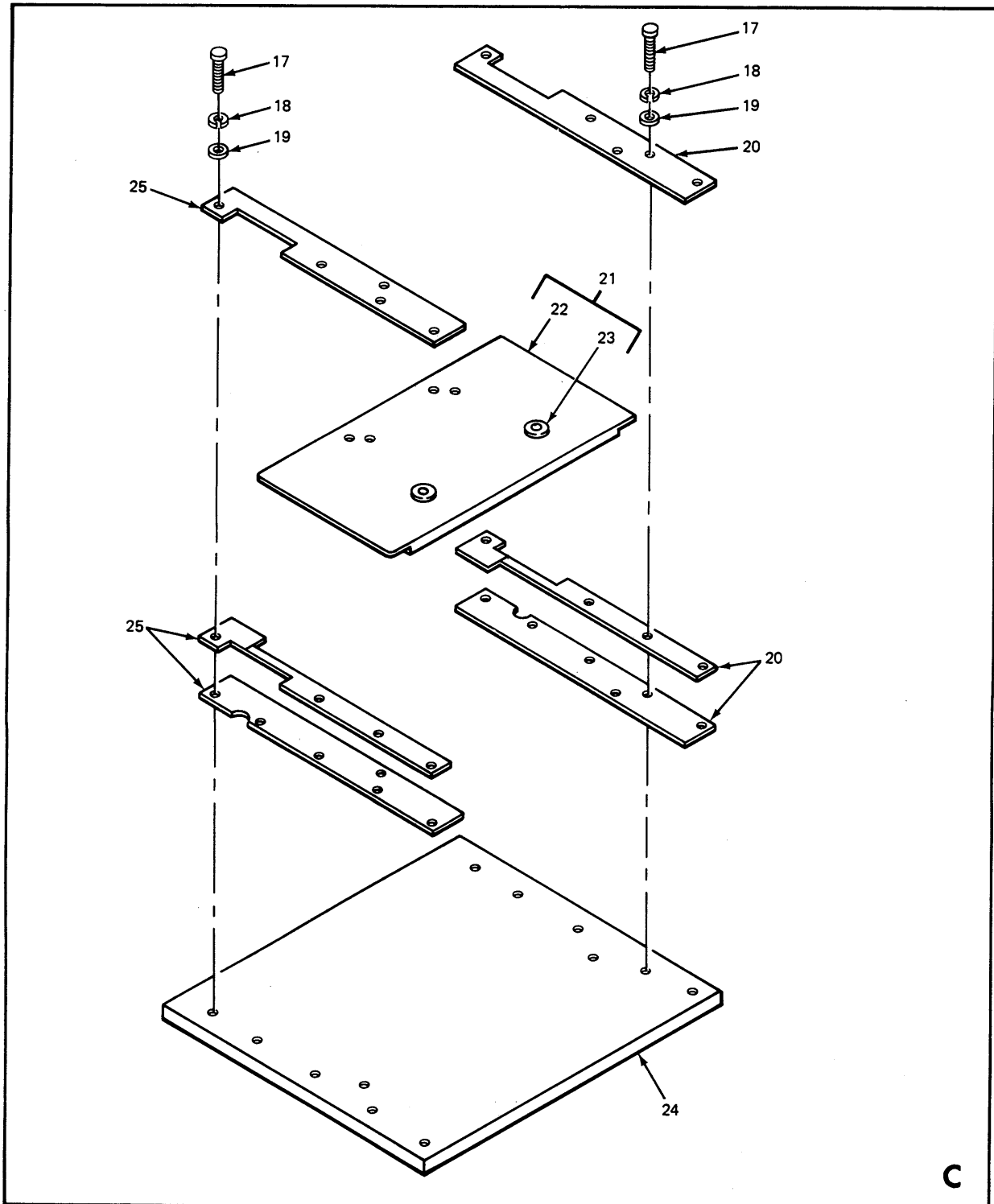

EL3GZ003

Figure 2. Shelter, Modified S-348A/TSC-58A, Curbside (Sheet 2 of 2).

**SECTION II**

**TM 11-5805-574-24P**

(1) ILLUS- TRATION		(2)	(3)	(4)	(5)	(6)	(7)	(8)
(a) FIG NO.	(b) ITEM NO.	SMR CODE	NATIONAL STOCK NUMBER	FSCM	PART NUMBER	DESCRIPTION	USABLE ON CODE	U/M INC IN UNIT
						<b>GROUP 10 SHELTER, ELECTRICAL EQUIPMENT S-348/TSC-58 AND S-348/TESS-58A, CURBSIDE WALL</b>		
2	1	XBOFF		80063	SC-D-960324-001	CABLE ASSY, SIGNAL.....EHB	EA	2
2	2	XBOFF		80063	SC-D-960025-003	CABLE ASSY, SP.....EHB	EA	6
2	3	XBOFF		80063	SC-D-960027-000	CABLE, POWER.....EHB	EA	6
2	4	XBFZZ		80063	SC-C-960340	COVER, DUCT.....EHB	EA	1
2	5	XAFFF		80063	SC-C-960376	DUCT ASSY.....EHB	EA	1
2	6	XBFZZ		80063	SC-C-960339	COVER, DUCT.....EHB	EA	1
2	7	XAFFF		80063	SC-D-960350	DUCT ASSY.....EHB	EA	1
2	8	PAFZZ	5305-00-995-3441	96906	MS35207-269	SCREW MACHINE.....EHB	EA	30
2	9	XAFFF		80063	SC-C-629275	VENTILATOR, AIR COND.....EHB	EA	5
2	10	XBFZZ		80063	SC-C-960385	COVER, BLANK.....EHB	EA	2
2	11	PAFZZ		96906	MS51861-22	SCREW, TPG, THD.....EHB	EA	30
2	12	XAFFF		80063	SC-D-960343	DUCT ASSY.....EHB	EA	1
2	13	XBFZZ		80063	SC-D-960344	COVER, DUCT.....EHB	EA	1
2	14	PAFZZ	5305-00-984-6195	96906	MS35206-247	SCREW, MACHINE.....EHB	EA	94
2	15	PAFZZ	5310-00-225-5328	96906	MS15795-841	WASHER, FLAT.....EHB	EA	94
2	16	PAFZZ	5310-00-933-8119	96906	MS35338-137	WASHER, LOCK.....EHB	EA	94
2	17	PAFZZ	5305-00-225-3839	96906	MS90725-8	SCREW, CAP, HEX HD.....EHB	EA	60
21	18	PAFZZ	5310-00-582-5965	96906	MS35338-44	WASHER, LOCK.....EHB	EA	60
2	19	PAFZZ	5310-00-809-4058	96906	MS27183-10	WASHER, FLAT.....EHB	EA	60
2	20	XDFZZ		80063	SC-D-960329	SLIDE ASSY, WELDER.....EHB	EA	6
2	21	XAFFF		80063	SC-D-960384	SLIDE PLATE ASSY.....EHB	EA	6
2	22	XDFZZ		80063	SC-D-960337	SLIDE PLATE.....EHB	EA	1
2	23	XDFZZ		80063	SC-B-960038	WASHER, CUSHION.....EHB	EA	2
2	24	XDFZZ		80063	SC-D-960374	SHELF, MODIFIED.....EHB	EA	6
2	25	XDFZZ		80063	SC-D-960379	SLIDE ASSY, WELDED.....EHB	EA	6

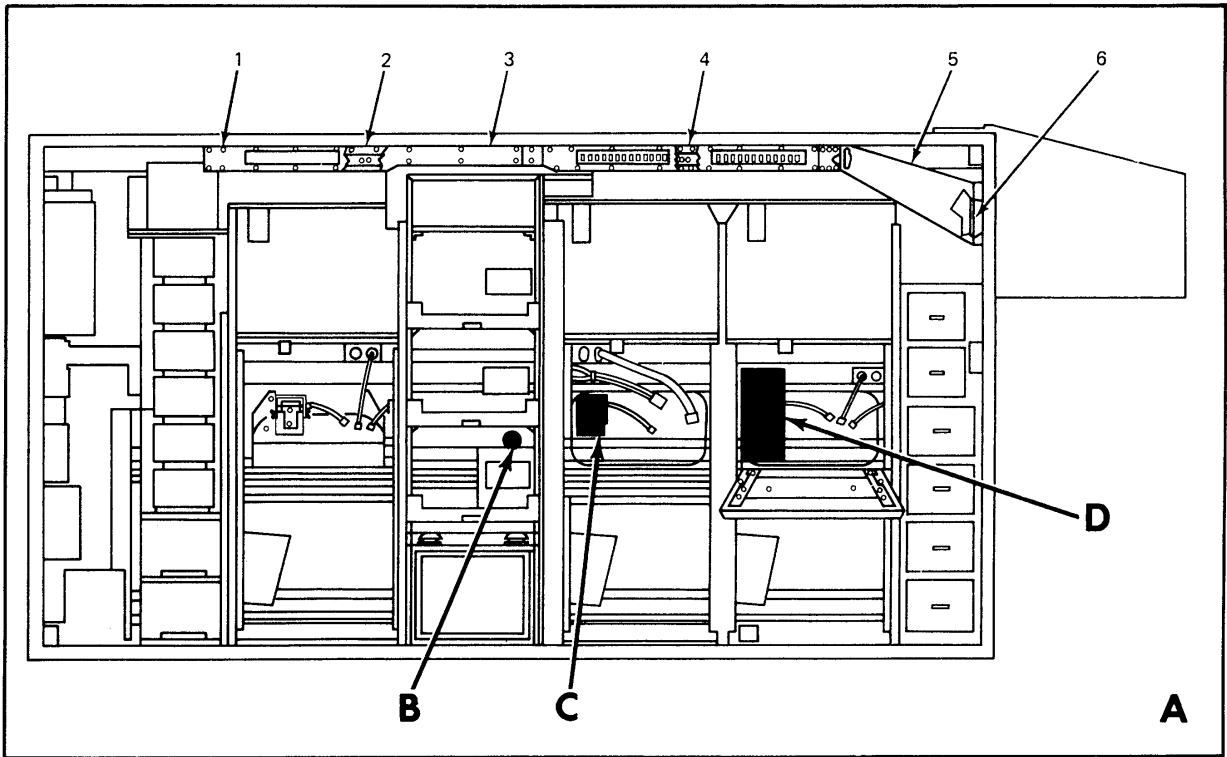
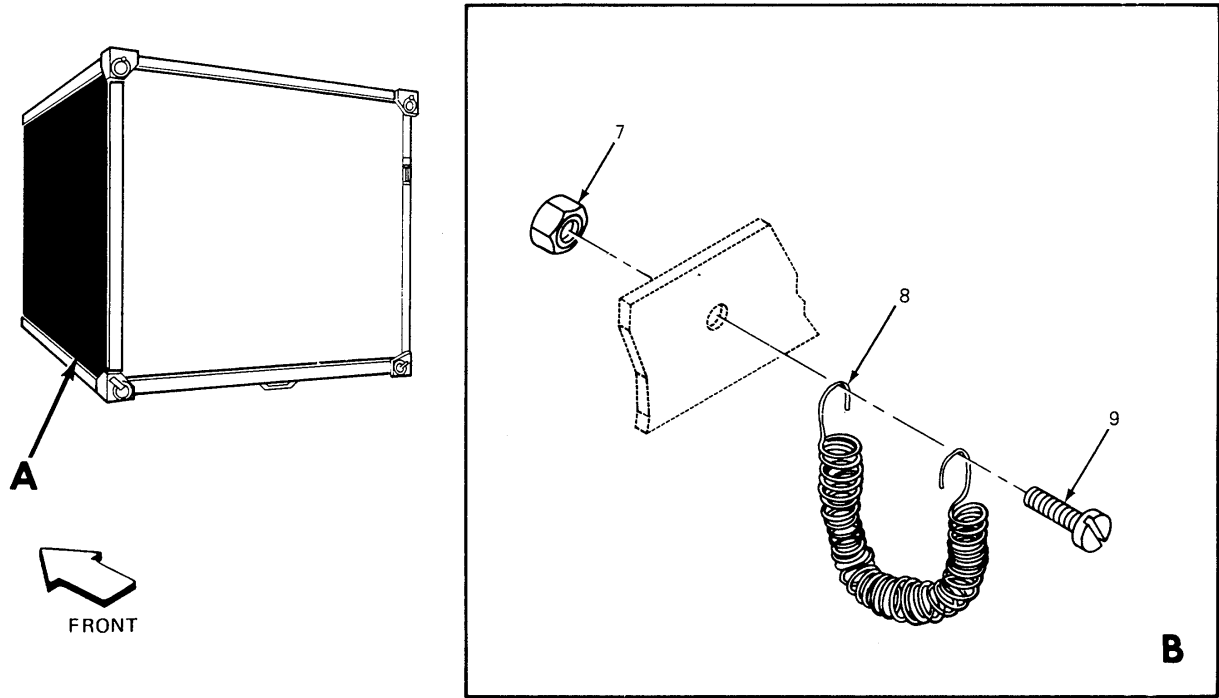

EL3GZ004

Figure 3. Shelter, Modified S-348A/TSC-58A, Roadside (Sheet 1 of 2).

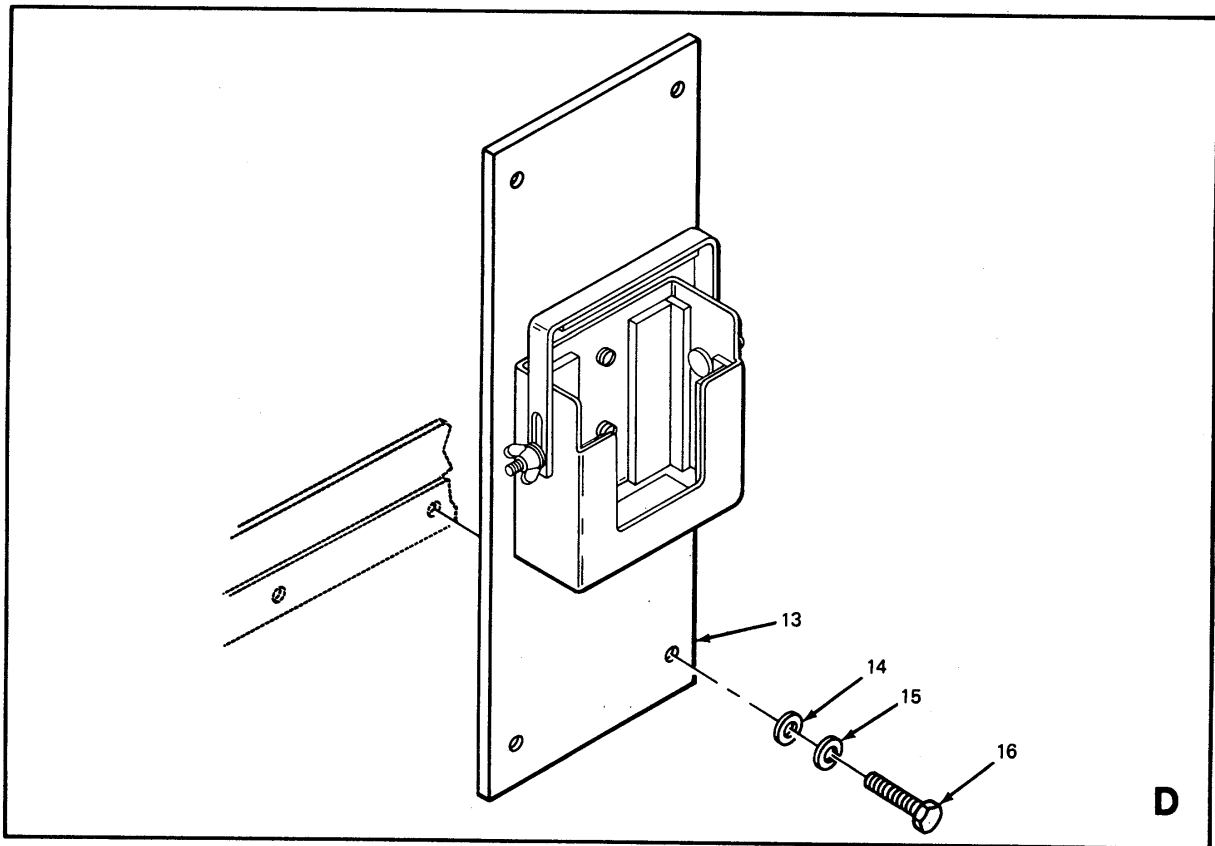
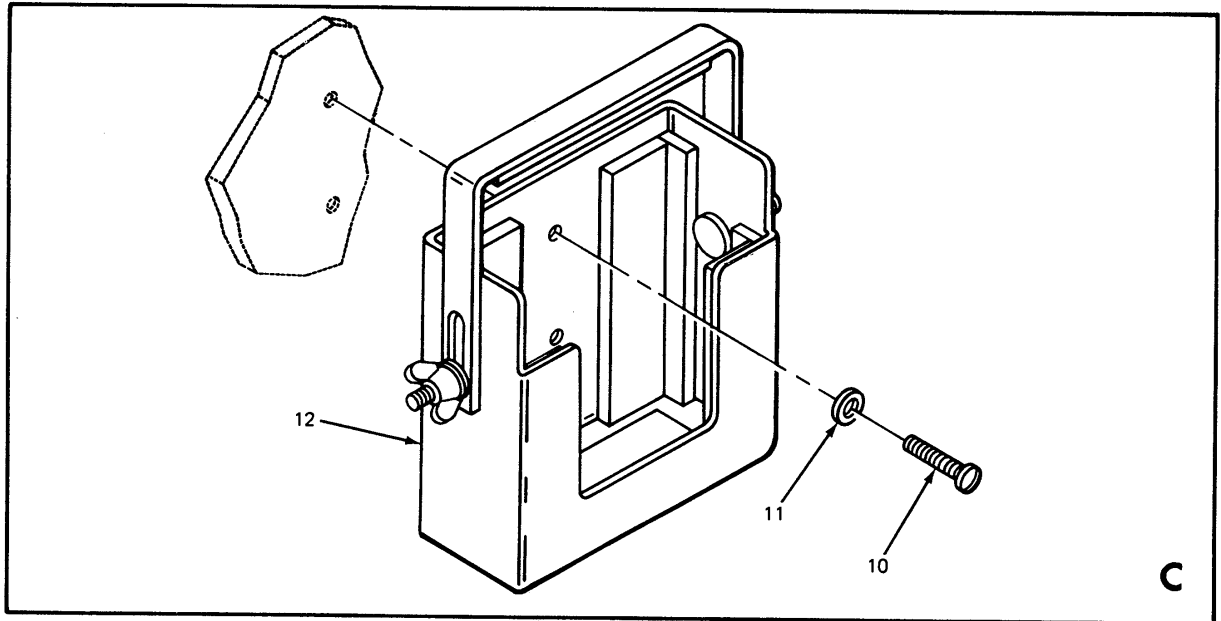

EL3GZ005

Figure 3. Shelter, Modified S-348A/TSC-58A, Roadside (Sheet 2 of 2).

**SECTION II**

**TM 11-5805-574-24P**

(1) ILLUS- TRATION		(2)	(3)	(4)	(5)	(6)	(7)	(8)
(a) FIG NO.	(b) ITEM NO.	SMR CODE	NATIONAL STOCK NUMBER	FSCM	PART NUMBER	DESCRIPTION	USABLE ON CODE	U/M INC IN UNIT
3	1	XBFZZ		80063	SC-D-960359	COVER DUCT .....	EHB	EA 1
3	2	XAFFF		80063	SC-D-960364	DUCT ASSY.....	EHB	EA 1
3	3	XBFZZ		80063	SC-C-960360	COVER, DUCT .....	EHB	EA 1
3	4	XAFZZ		80063	SC-D-960331	DUCT ASSY.....	EHB	EA 1
3	5	XBFZZ		80063	SC-C-960361	COVER DUCT .....	EHB	EA 1
3	6	XAFFF		80063	SC-C-960375	DUCT ASSY.....	EHB	EA 1
3	7	PAFZZ	5310-00-997-1888	96906	MS35649-2252	NUT, PLAIN, HEXAGON .....	EHB	EA 6
3	8	XDFZZ		80063	SC-C-960367	SPRING, CABLE SUPPOR .....	EHB	EA 6
3	9	PAFZZ	5305-00-993-2738	96906	MS35207-280	SCREW, MACHINE .....	EHB	EA 6
3	10	PAFZZ	5305-00-984-5674	96906	MS35206-294	SCREW, MACHINE .....	EHB	EA 12
3	11	PAFZZ	5310-00-087-7493	96906	MS27183-13	WASHER, FLAT .....	EHB	EA 12
3	12	XAFFF		80063	SC-D-960667	BATTERY HOLDER ASSY.....	EHB	EA 6
3	13	XDFZZ		80063	SC-C-960380	PLATE .....	EHB	EA 1
3	14	PAFZZ	5310-00-080-6004	96906	MS27183-14	WASHER FLAT .....	EHB	EA 4
3	15	PAFZZ	5310-00-407-9566	96906	MS35338-45	WASHER, LOCK .....	EHB	EA 4
3	16	PAFZZ	5306-00-225-8498	96906	MS90725-33	BOLT, MACHINE .....	EHB	EA 4

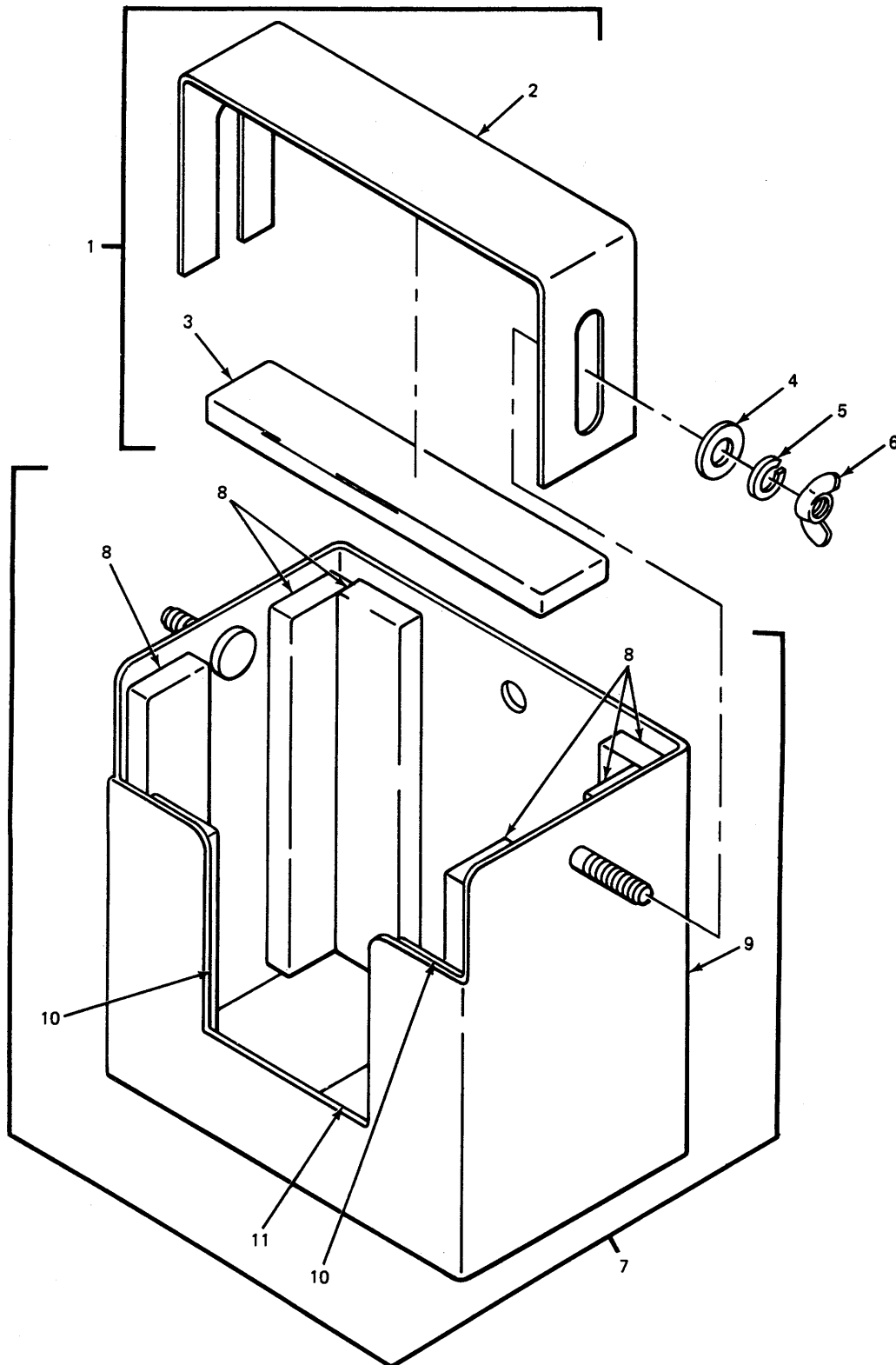

EL3GZ006

Figure 4. Holder, Battery Assembly.

**SECTION II**

**TM 11-5805-574-24P**

(1) ILLUS- TRATION		(2)	(3)	(4)	(5)	(6)	(7)	(8)
(a) FIG NO.	(b) ITEM NO.	SMR CODE	NATIONAL STOCK NUMBER	FSCM	PART NUMBER	DESCRIPTION	USABLE ON CODE	U/M INC IN UNIT
4	1	XAFFF		80063	SC-C-960649	CLAMP ASSY, BATT BOX .....	EHB	EA 1
4	2	XDFZZ		80063	SC-C-960697	CLAMP .....	EHB	EA 1
4	3	MDFZZ		80063	SC-D-959762-9	PAD, RUBBER .....	EHB	EA 1
4	4	PAFZZ	5310-00-809-4058	96906	MS27183-10	WASHER, FLAT .....	EHB	EA 2
4	5	PAFZZ	5310-00-582-5965	96906	MS35338-44	WASHER, LOCK .....	EHB	EA 2
4	6	PAFZZ	5310-01-064-8787	96906	MS35425-70	NUT, PLAIN WING .....	EHB	EA 12
4	7	XAFFF		80063	SC-D-960663	PAD ASSY, BTRY BOX .....	EHB	EA 1
4	8	XBFZZ		80063	SC-D-959762-9	PAD, RUBBER .....	EHB	EA 6
4	9	XDFZZ		80063	SC-D-960648	HOLDER, BATTERY BOX.....	EHB	EA 1
4	10	XBFZZ		80363	SC-D-959762-8	PAD, RUBBER .....	EHB	EA 2
4	11	XBFZZ		80063	SC-D-959762-10	PAD, RUBBER .....	EHB	EA 1



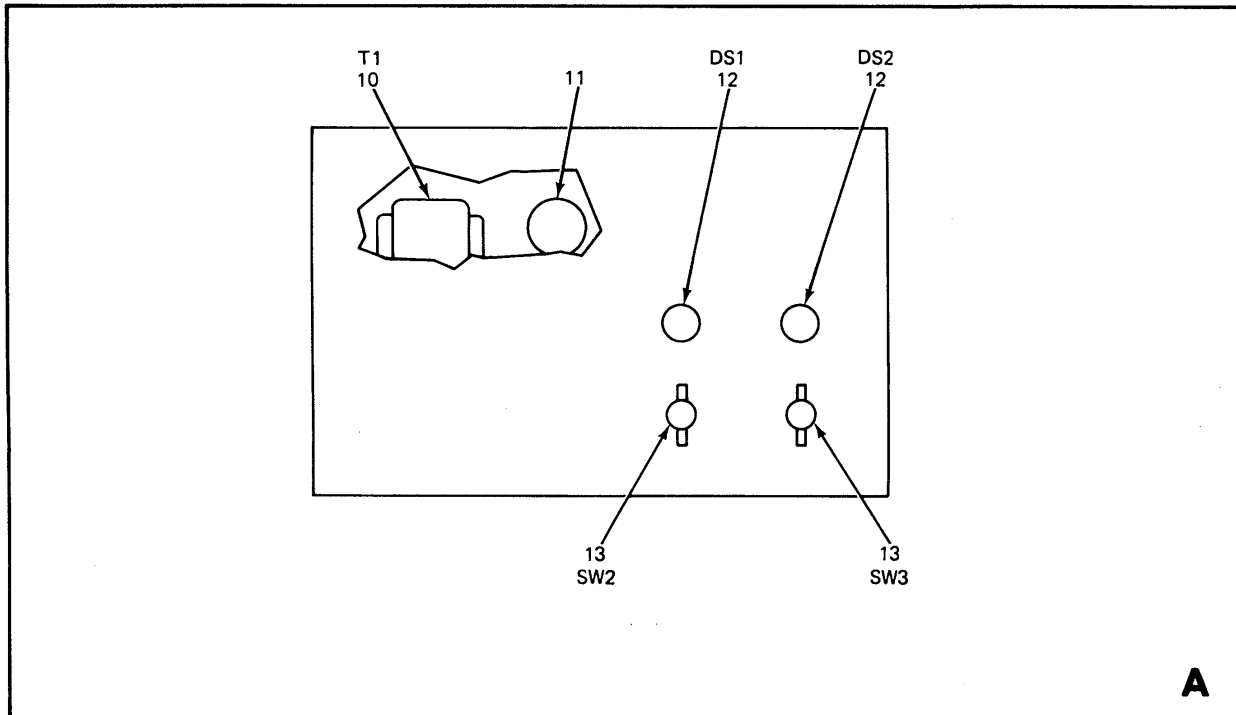
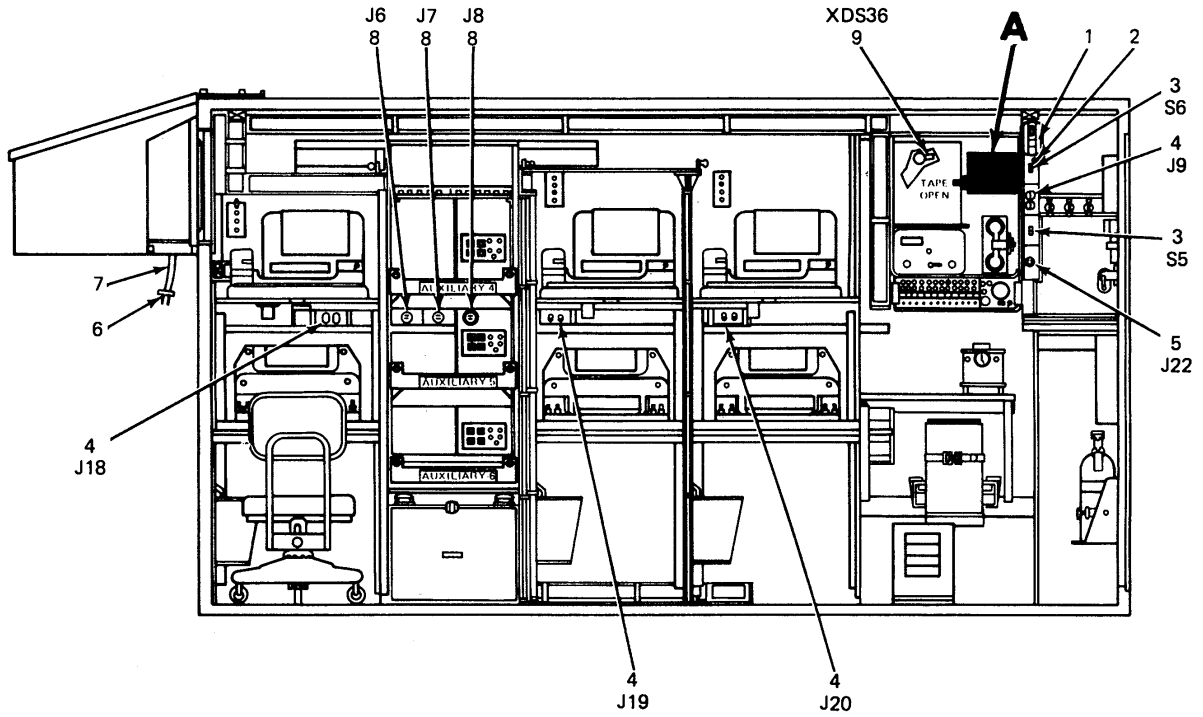

EL3GZ007

Figure 5. Shelter, Electrical Equipment S-348/TSC-58 and S-348A/TSC-58A, Curbside Wall.

**SECTION II**

**TM 11-5805-574-24P**

(1) ILLUS- TRATION		(2)	(3)	(4)	(5)	(6)	(7)	(8)
(a) FIG NO.	(b) ITEM NO.	SMR CODE	NATIONAL STOCK NUMBER	FSCM	PART NUMBER	DESCRIPTION	USABLE ON CODE	U/M INC IN UNIT
						<b>GROUP 10 SHELTER, ELECTRICAL EQUIPMENT S-348/TSC-58 AND S-348A/TSC-58A, CURBSIDE WALL</b>		
5	1	PAOZZ	5930-00-501-1739	05624	TC153	THERMOSTAT .....		EA 1
5	2	PAOZZ	6210-00-151-5243	81349	LH74-1LC13RN2	LIGHT, INDICATOR.....		EA 1
5	3	PAOZZ		24446	WS-896-STYLE-41	SWITCH, TOGGLE .....		EA 2
5	4	PAOZZ	5910-01-022-3080	14752	23081C505F	CONNECTOR, RECEPT.....		EA 4
5	5	PAOZZ	5935-00-933-3454	74545	5361	CONNECTOR.....		EA 1
5	6	PAOZZ	5935-00-149-2919	81349	WC596STYLEJ23	CONNECTOR, PLUG, ELEC .....		EA 1
5	7	PAOZZ	5995-00-119-2921	80063	SC-C-578639GR2	CABLE ASSY, PWR, ELEC.....		EA 1
5	8	PAOZZ	5935-00-350-1834	80063	SM-8-657092	CONNECTOR, RECEPTAC.....		EA 3
5	9	XDOZZ	6250-00-822-8550	74545	4229	LAMP HOLDER.....		EA 1
5	10	PAOZZ	5950-00-942-8457	94227	320	TRANSFORMER, POWER .....		EA 1
5	11	PAOZZ	5805-00-503-1145	96344	BZ-23PT	RINGER, TELEPHONE .....		EA 1
5	12	PAOZZ	6210-00-485-9856		140-5030-1471-20 72619 1	LIGHT, INDICATOR.....		EA 2
5	13	PAOZZ	5930-00-802-1164	82389	6009L	SWITCH, LEVER.....		EA 2

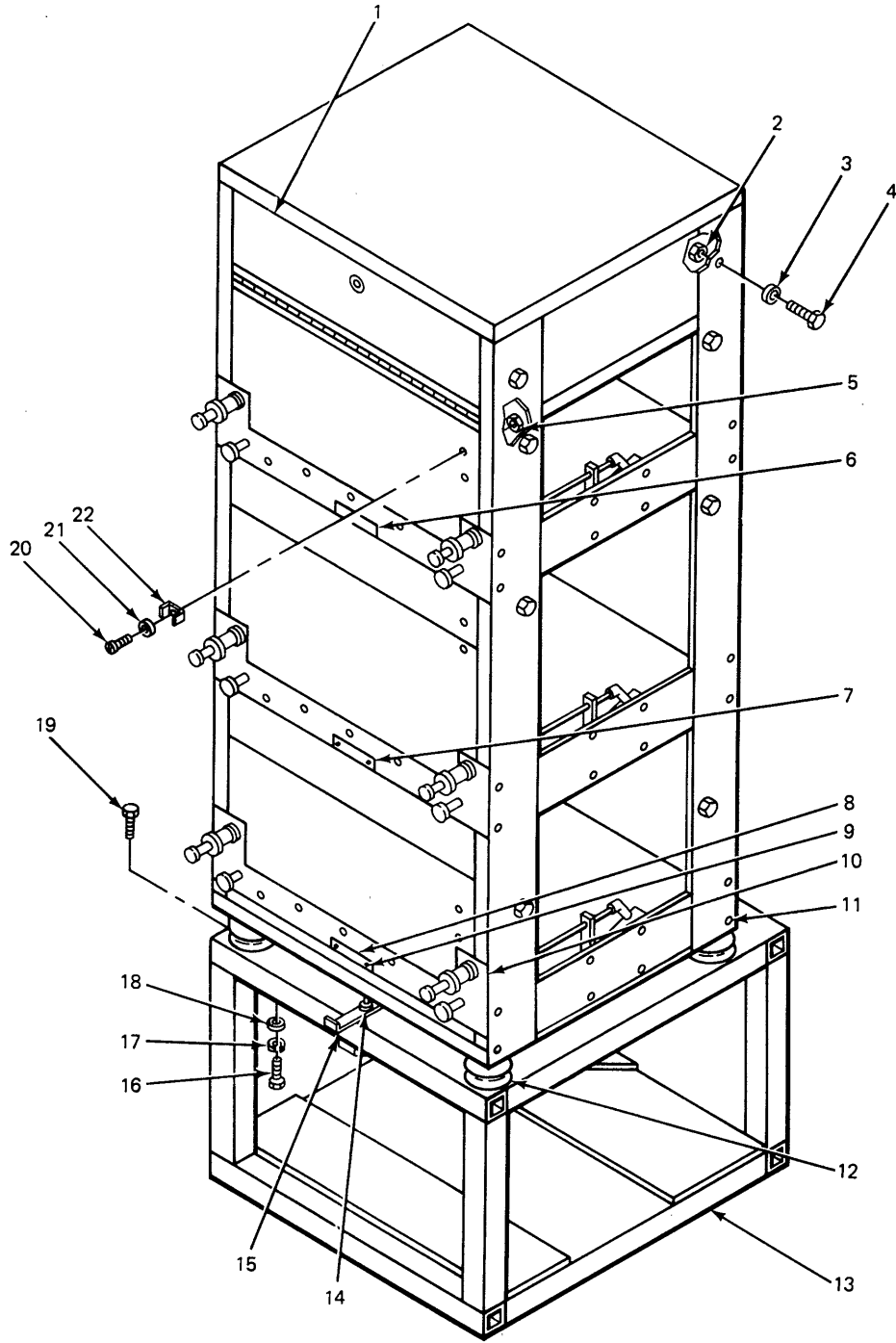

EL3GZ008

Figure 6. Welded Rack Assembly.

SECTION II

TM 11-5805-574-24P

(1) ILLUS- TRATION		(2)	(3)	(4)	(5)	(6)	(7)	(8)
(a) FIG NO.	(b) ITEM NO.	SMR CODE	NATIONAL STOCK NUMBER	FSCM	PART NUMBER	DESCRIPTION	USABLE ON CODE	U/M INC IN UNIT
6	1	PAFZZ		83063	SC-D-578725	STORAGE BOX ASSEMB.....		EA 1
6	2	XDFZZ		80063	SC-C-960385-1	NUT SELF-LO.....		EA 1
6	3	PAFZZ	5310-00-809-4058	96906	MS27183-10	WASHER, FLAT.....		EA 4
6	4	PAFZZ	5305-00-068-0499	96906	MS90725-2	SCREW, CAP, HEXAGON H.....		EA 4
6	5	PAFZZ	5310-00-807-1466	96906	MS21042-08	NUT, SELF-LOCKING, EX.....		EA 6
6	6	XDFZZ		80063	SC-B-564065-1	PLATE, IDENT.....		EA 1
6	6	XDFZZ		80063	SC-B-564065-4	PLATE, IDENT.....		EA 1
6	7	XDFZZ		80063	SC-B-564065-2	PLATE, IDENT.....		EA 1
6	7	XDFZZ		80063	SC-B-564065-5	PLATE, IDENT.....		EA 1
6	8	XDFZZ		80063	SC-8-564065-3	PLATE, IDENT.....		EA 1
6	8	XDFZZ		80063	SC-B-564065-6	PLATE, IDENT.....		EA 1
6	9	PAFZZ	5305-00-175-3230	96906	MS21318-14	SCREW, DRIVE EA.....		EA 6
6	10	XAFFF		80063	SC-D-960366	SHELF ASSEMBLY.....		EA 3
6	10	XAFFF		80063	SC-D-578693	SHELF ASSEMBLY.....2QU		EA 3
6	11	XAFFF		80063	SC-D-564150-GRI	RACK ASSEMBLY.....		EA 1
6	11	XAFFF		80063	SC-D-564150-GRII	RACK ASSEMBLY.....		EA 1
6	12	PAFZZ		80063	SC-D-564150-2	SHOCK MOUNT.....		EA 4
6	13	XDFZZ		80063	SC-D-564129	RACK ASSY WELDED*.....		EA 1
6	13	XDFZZ		80063	SC-D-578636	RACK ASSY, WELDED.....		EA 1
6	14	PAFZZ		80063	SC-D-564011-4	NUT, STOP.....		EA 2
6	15	XDFZZ		80063	SM-B-475056	KEEPER.....		EA 1
6	16	PAFZZ	5305-00-068-0502	96906	MS90725-6	SCREW, CAP, HEXAGON H.....		EA 16
6	17	PAFZZ	5310-00-582-5965	96906	MS35338-44	WASHER, LOCK.....		EA 16
6	18	PAFZZ	5310-00-809-4058	96906	MS27183-10	WASHER, FLAT.....		EA 16
6	19	PAFZZ		80063	SC-D-564011-1	SCREW, FLAT HEAD.....		EA 4
6	20	PAFZZ		80063	SC-D-564011-3	SCREW, PAN HEAD.....		EA 6
6	21	PAFZZ	5310-00-809-8544	96906	MS27183-7	WASHER, FLAT.....		EA 6

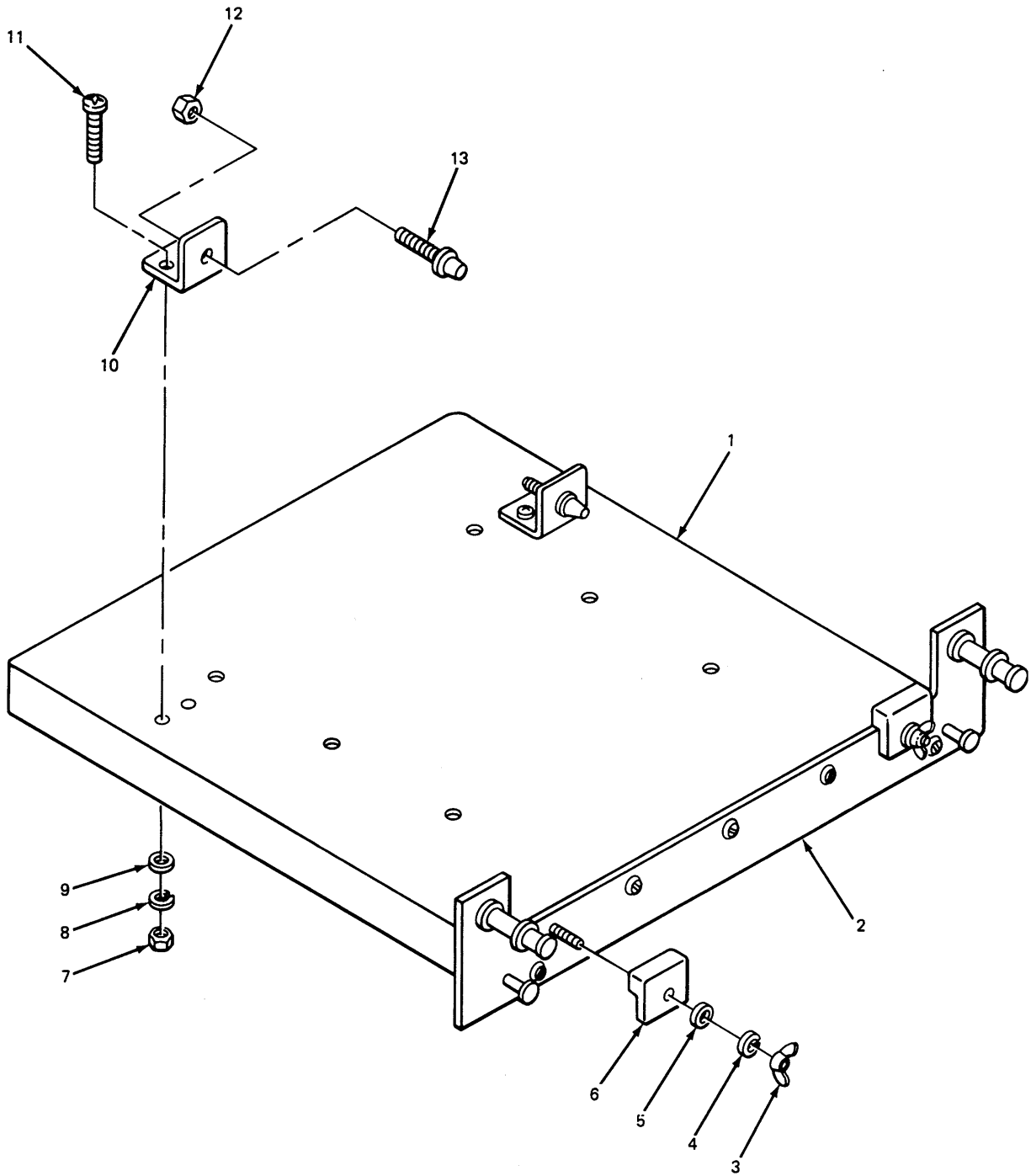

EL3GZ009

Figure 7. KW-7 Equipment Shelf.

**SECTION II**

**TM 11-5805-574-24P**

(1) ILLUS- TRATION		(2)	(3)	(4)	(5)	(6)	(7)	(8)
(a) FIG NO.	(b) ITEM NO.	SMR CODE	NATIONAL STOCK NUMBER	FSCM	PART NUMBER	DESCRIPTION	USABLE ON CODE	U/M INC IN UNIT
7	1	PAFZZ		80063	SC-D-960372	SHELF ASSEMBLY, MODIFIED.....		EA 1
7	2	PAFZZ		80063	SC-D-960373	PLATE, MODIFIED .....		EA 1
7	3	PAFZZ		96906	MS35425-70	NUT, PLAIN, WING .....		EA 2
7	4	PAFZZ		96906	MS35338-44	WASHER, LOCK .....		EA 2
7	5	PAFZZ		96906	MS27183-L0	WASHER, FLAT .....		EA 2
7	6	PAFZZ		80063	SM-B-730717	STOP.....		EA 2
7	7	PAFZZ		96906	MS35650-302	NUT, PLAIN, HEXAGON HEAD .....		EA 4
7	8	PAFZZ		96906	MS35338-43	WASHER, LOCK .....		EA 4
7	9	PAFZZ		96906	MS27183-42	WASHER, FLAT .....		EA 4
7	10	PAFZZ		80063	SC-C-959452	ANGLE .....		EA 2
7	11	PAFZZ		96906	MS35207263	SCREW, MACHINE .....		EA 4
7	12	PAFZZ		96906	MS51922-9	NUT, SELF LOCKING .....		EA 2
7	13	PAFZZ		80063	SM-B-730719	PIN, GUIDE .....		EA 2

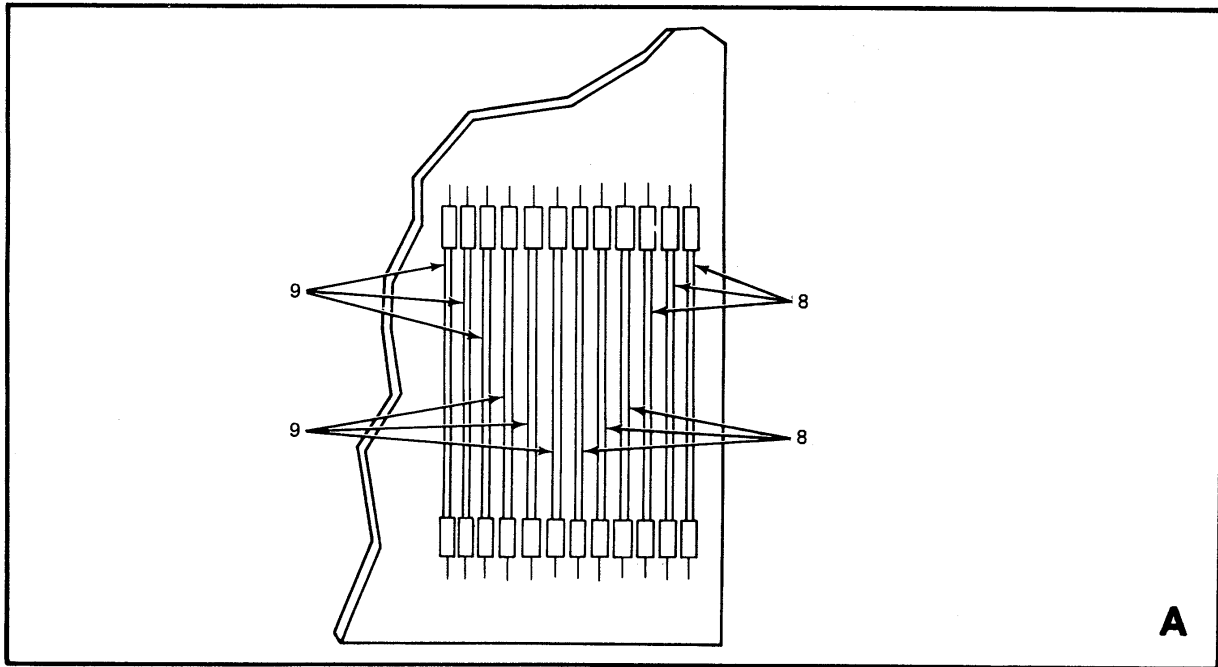
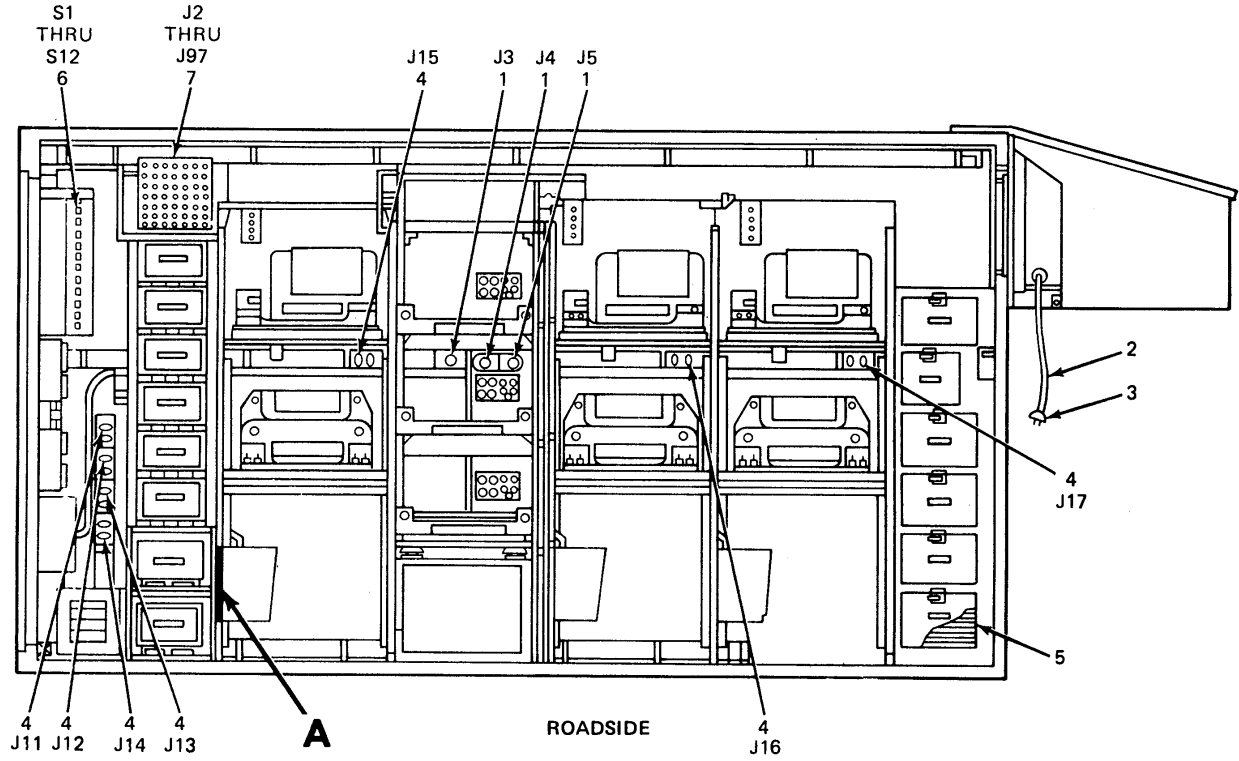

EL3G2010

Figure 8. Shelter, Electrical Equipment S-348/TSC-58 and S-348A/TSC-58A, Roadside Wall.

**SECTION II**

**TM 11-5805-574-24P**

(1) ILLUS- TRATION		(2)	(3)	(4)	(5)	(6)	(7)	(8)
(a) FIG NO.	(b) ITEM NO.	SMR CODE	NATIONAL STOCK NUMBER	FSCM	PART NUMBER	DESCRIPTION	USABLE ON CODE	U/M INC IN UNIT
8	1	PAOZZ	5935-00-350-1834	80063	SM-B-657092	CONNECTOR, RECEPTACLE .....		EA 3
8	2	PAOZZ	5995-00-179-2922	80063	SC-C-578639GR1	CABLE ASSY, PWR, ELEC.....		EA 1
8	3	PADZZ	5935-00-149-2919	81349	WC596STYLEJ23	CONNECTOR, PLUG, ELEC .....		EA 1
8	4	PAOZZ	5910-01-022-3080	14752	23081C505F	COUNNECTOR, RECPT.....		EA 7
8	5	PAOZZ	6150-00-495-1214	80063	SC-B-539492	LEAD, ELECTRICAL.....		EA 1
8	6	PAOZZ	5930-00-087-4712	27193	8906K1384	SWITCH, TOGGLE .....		EA. 12
8	7	PAOZZ	5935-00-228-4038	80058	JJ-085	JACK, TELEPHONE .....		EA. 96
8	8	PAOZZ		80063	SC-C-564143GR1	CABLE ASSEMBLY .....		EA. 6
8	9	PAOZZ	5995-00-179-2925	80063	SC-C-564143GR2	CABLE ASSEMBLY .....		EA 6



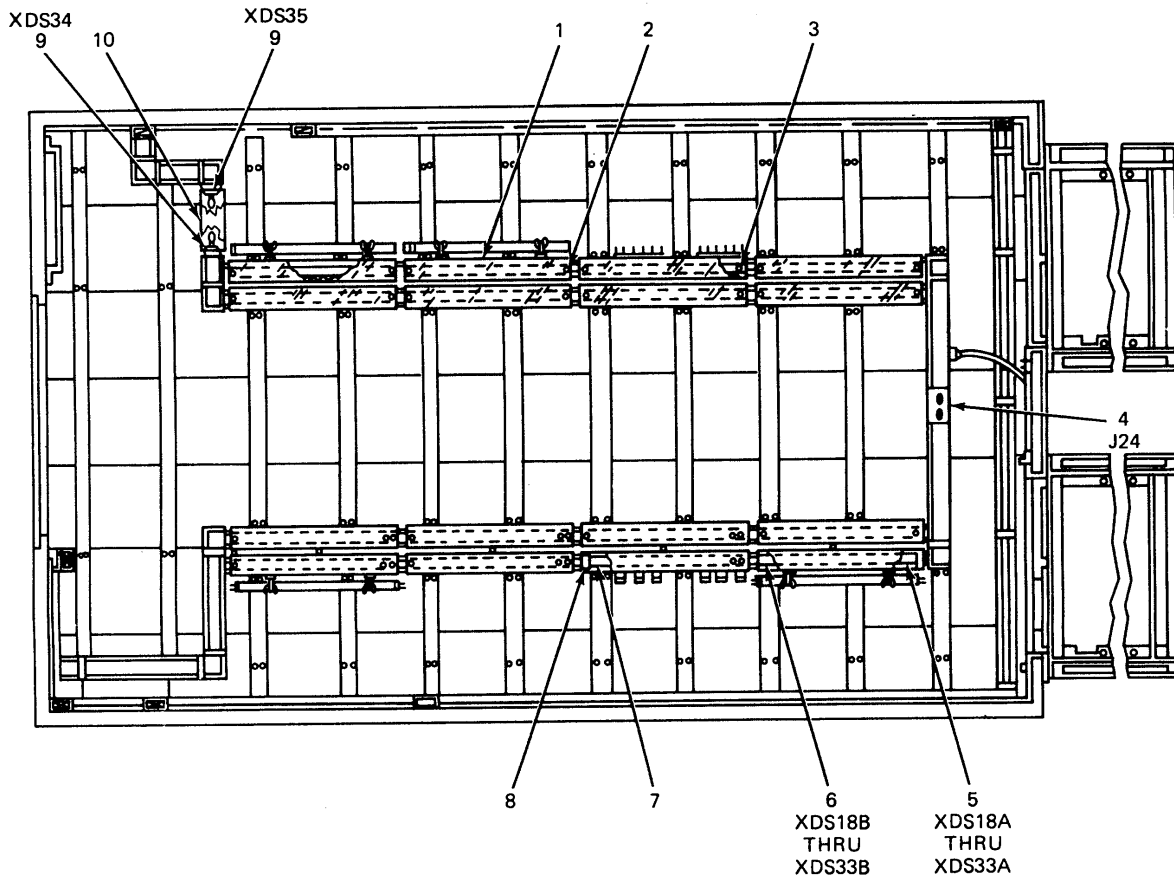
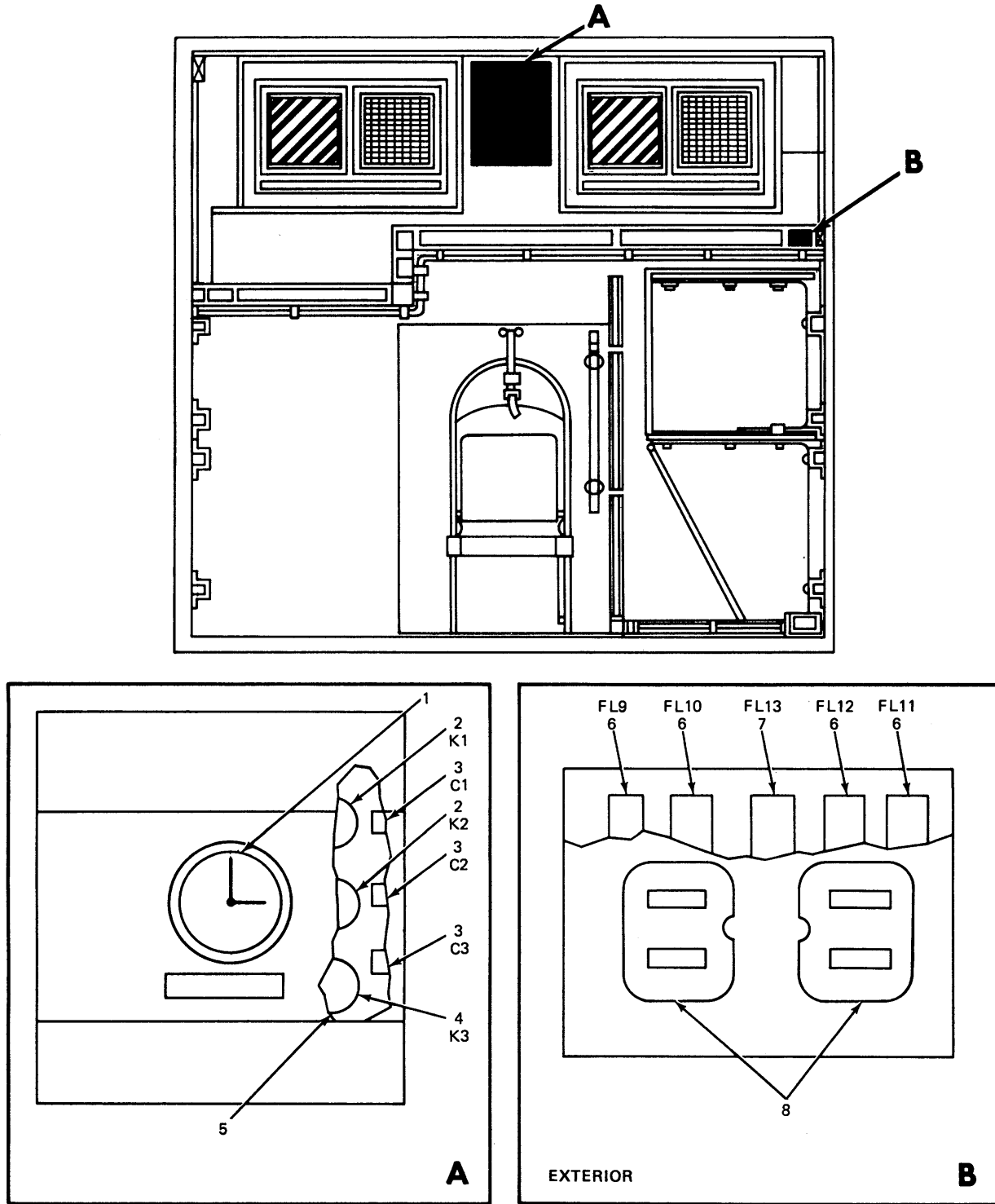

Figure 9. Shelter, Electrical Equipment S-348/TSC-58 and S-348A/TSC-58A, Ceiling Plan.

**SECTION II**

**TM 11-5805-574-24P**

(1) ILLUS- TRATION		(2)	(3)	(4)	(5)	(6)	(7)	(8)
(a) FIG NO.	(b) ITEM NO.	SMR CODE	NATIONAL STOCK NUMBER	FSCM	PART NUMBER	DESCRIPTION	USABLE ON CODE	U/M INC IN UNIT
9	1	PAOZZ	6210-00-921-6682	80063	SC-C-539466	SHIELD, FLUORESCENT .....		EA 16
9	2	PAOZZ		19634	P4D	LAMPLOCK.....		EA 32
9	3	PAOZZ	5910-01-022-3080	14752	23081C505F	CAPACITOR FIXED, MET.....		EA 1
9	4	PAOZZ		24446	78X736	LAMPHOLDER.....		EA 1
9	5	PAOZZ	6250-00-158-8900	73586	9200A	LAMPHOLDER.....		EA 16
9	6	PAOZZ		24446	89G457D	BALLAST, LAMP.....		EA 16
9	7	PAOZZ	5915-00-116-8916	02777	591B	FILTER, RADIO FREQUENCY .....		EA 16
9	8	PAOZZ	6250-00-995-9074	71744	4365-034	LAMP HOLDER.....		EA 2
9	9	PAOZZ	6210-00-451-8350	80063	SC-C-539466-1	SHIELD, INCANDESCENT .....		EA 1



EL3G2012

Figure 10. Shelter, Electrical Equipment S-348/TSC-58 and S-348A/TSC-58A, Front Wall

**SECTION II**

**TM 11-5805-574-24P**

(1) ILLUS- TRATION		(2)	(3)	(4)	(5)	(6)	(7)	(8)
(a) FIG NO.	(b) ITEM NO.	SMR CODE	NATIONAL STOCK NUMBER	FSCM	PART NUMBER	DESCRIPTION	USABLE ON CODE	U/M INC IN UNIT
10	1	PAOFF	6645-01-135-2296	80063	SM-C-349904	CLOCK, AIRCRAFT.....		EA 1
10	2	PAOZZ	5945-00-758-4564	77342	PR07AY0240V	RELAY, ELECTRONAGNET .....		EA 2
10	3	PAOZZ	5910-00-161-6862	81349	CP6981EF504K1	CAPACITOR, FIXED.....		EA 3
10	4	PAOZZ	5945-00-606-2903	18876	8898876	RELAY, THERHAL.....		EA 1
10	5	PAOZZ	5935-00-222-9828	81349	M12883-03-01	SOCKET, PLUG-1N ELEC-.....		EA 1
10	6	PAOZZ	5915-00-080-4606	51932	SP266	FILTER, RADIO FREUE-.....		EA 4
10	7	PAOZZ	5915-00-496-3372	14655	NFTIF246	FILTER, RADIO .....		EA 1
10	8	XDOZZ	5935-00-350-1835	80063	SM-C-657095	CONNECTOR, RECEPTACL.....		EA 2

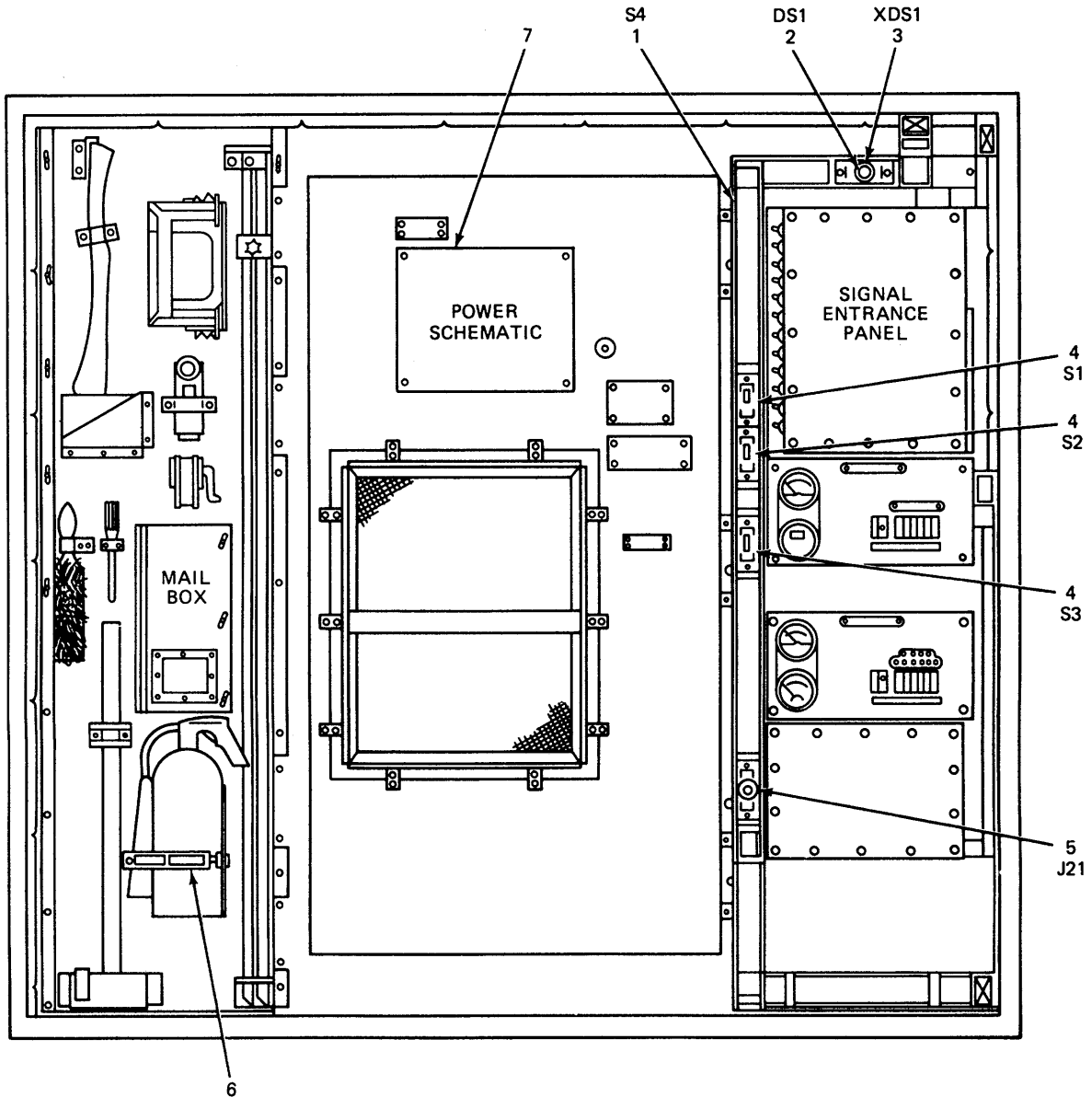

EL3GZ013

Figure 11. Shelter, Electrical Equipment S-348/TSC-58 and S-348A/TSC-58A, Rear Wall.

**SECTION II**

**TM 11-5805-574-24P**

(1) ILLUS- TRATION		(2)	(3)	(4)	(5)	(6)	(7)	(8)
(a) FIG NO.	(b) ITEM NO.	SMR CODE	NATIONAL STOCK NUMBER	FSCM	PART NUMBER	DESCRIPTION	USABLE ON CODE	U/M INC IN UNIT
11	1	PAOZZ	5930-00-683-2703	91929	8Z2RQ18A2	SWITCH, SENSITIVE .....		EA 1
11	2	PAOZZ	6240-00-635-9153	81349	N15098-3-002	LAMP, GLOW .....		EA 1
11	3	PAOZZ	6250-00-299-4722	74545	4113	LAMPHOLDER.....		EA 1
11	4	PAOZZ	5930-00-660-5584	81348	WSB96-Z-02A	SWITCH,TOGGLE .....		EA 3
11	5	PAOZZ	5935-00-933-3454	74545	5361	CONNECTOR .....		EA 1
11	6	PAOZZ	4210-00-288-6849	82796	11900514	BRACKET, FIRE EXTING .....		EA 1
11	7	XBFZZ		80063	SC-B-960381	PLATE, IDENT .....	EHB	EA 1

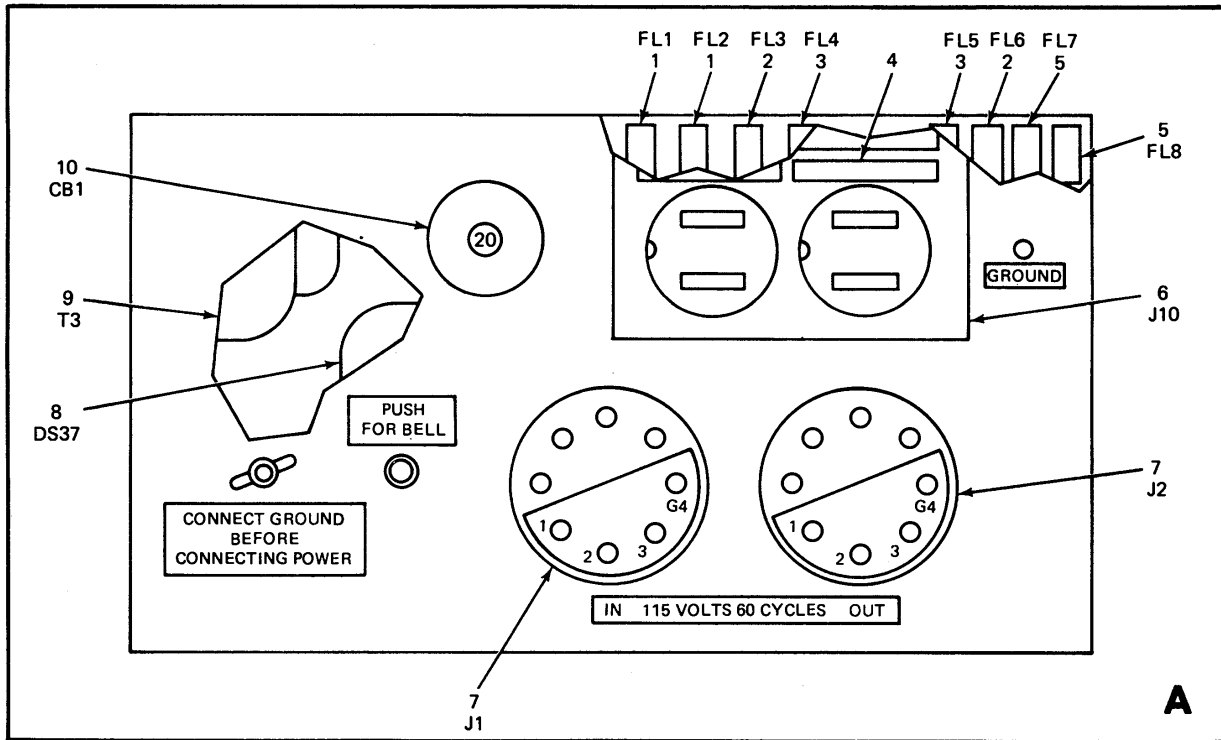
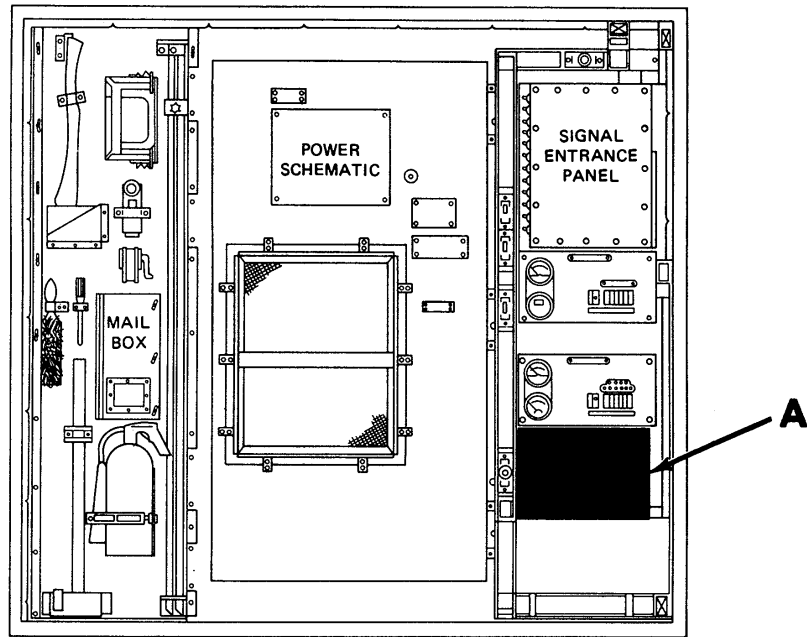

EL3GZ014

Figure 12. Shelter, Electrical Equipment S-348/TSC-58 and S-348A/TSC-58A, Power Box.

**SECTION II**

**TM 11-5805-574-24P**

(1) ILLUS- TRATION		(2)	(3)	(4)	(5)	(6)	(7)	(8)
(a) FIG NO.	(b) ITEM NO.	SMR CODE	NATIONAL STOCK NUMBER	FSCM	PART NUMBER	DESCRIPTION	USABLE ON CODE	U/M INC IN UNIT
12	1	PAOZZ	5915-00-880-6034	51932	SP126	FILTER,RADIO FREQUE .....	EA	2
12	2	PAOZZ	5915-00-057-4845	81831	SP-285	FILTER,RADIO FREQUE .....	EA	2
12	3	PAOZZ		37695	368220-1	FILTER,RADIO FREQUE .....	EA	2
12	4	PAOZZ		21873	N3780-F5	COVER,ELECTRICAL .....	A	1
12	5	PAOZZ	5915-00-496-3372	14655	NFTIF246	FILTER, RADIO INTRF.....	EA	2
12	6	PAOZZ	5910-01-022-3080	14752	230BIC505F	CONNECTOR,RECEPT .....	EA	1
12	7	PAOZZ	5935-01-123-4520	80058	U-2388/G	CONNECTOR .....	EA	2
12	8	XDOZZ		19557	156	BELL,ELECTRICAL .....	EA	1
12	9	PAOZZ	5950-00-942-8457	94227	320	TRANSFORNER,POWER .....	EA	1
12	10	PAOZZ	5925-00-682-4015	96906	MS25244-20	CIRCUIT BREAKER .....	EA	1



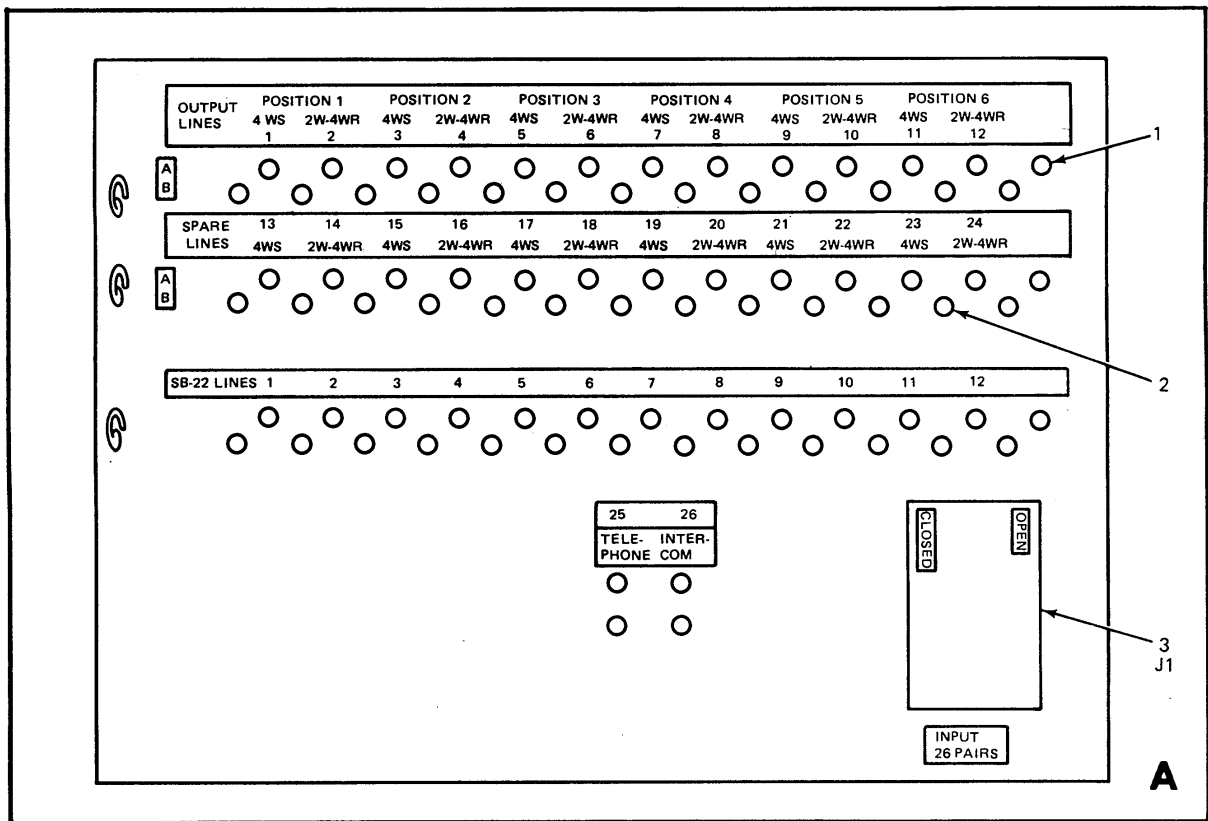
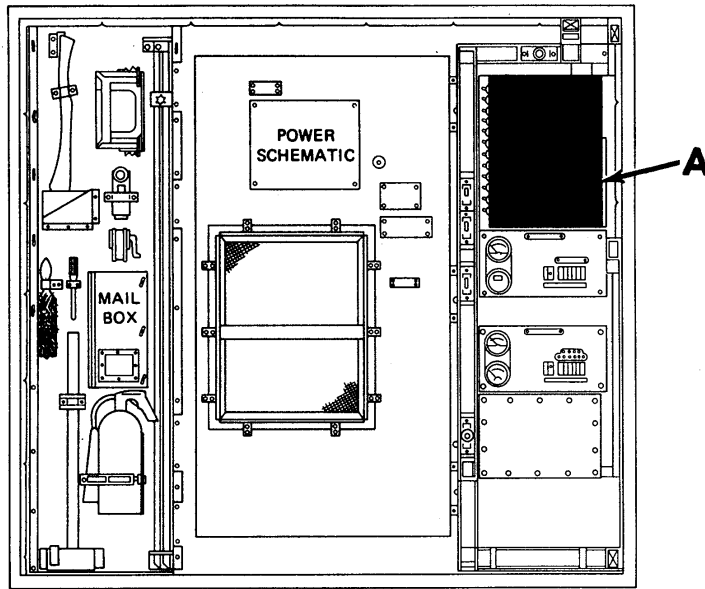

EL3GZ015

Figure 13. Shelter, Electrical Equipment S-348/TSC-58 and S-348A/TSC-58A, Signal Entrance Box.

**SECTION II**

**TM 11-5805-574-24P**

(1) ILLUS- TRATION		(2)	(3)	(4)	(5)	(6)	(7)	(8)
(a) FIG NO.	(b) ITEM NO.	SMR CODE	NATIONAL STOCK NUMBER	FSCM	PART NUMBER	DESCRIPTION	USABLE ON CODE	U/M INC IN UNIT
13	1	PAOZZ		81349	U-106/U	POST,BINOING .....		EA 82
13	2	PAOZZ	5970-00-869-6263	80063	SCC76202-1	CAP,ELECTRICAL.....		EA 82
13	3	PAOZZ	5935-00-045-9832	80058	U-187A/G	CONNECTOR,RECEPTACL .....		EA 1

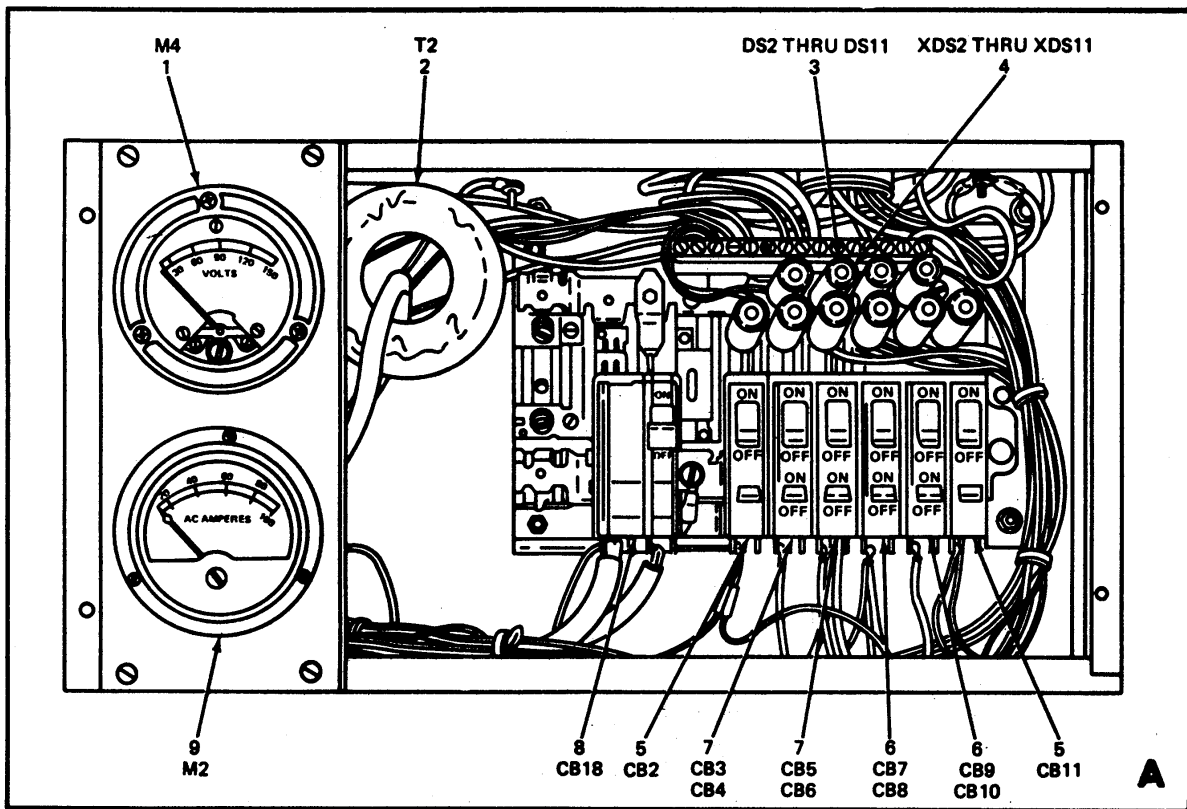
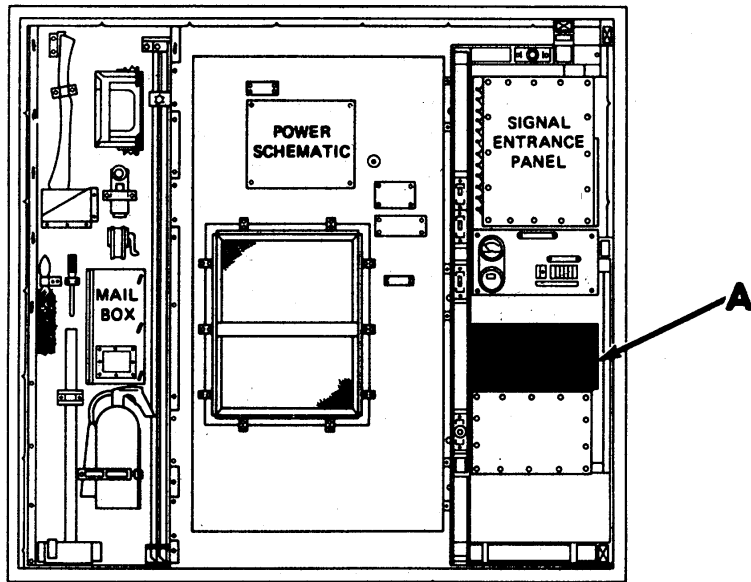

EL362016

Figure 14. Shelter, Electrical Equipment S-348/TSC-58 and S-348A/TSC-58A, Block Power Distribution Panel.

**SECTION II**

**TM 11-5805-574-24P**

(1) ILLUS- TRATION		(2)	(3)	(4)	(5)	(6)	(7)	(8)
(a) FIG NO.	(b) ITEM NO.	SMR CODE	NATIONAL STOCK NUMBER	FSCM	PART NUMBER	DESCRIPTION	USABLE ON CODE	U/M INC IN UNIT
14	1	PAOZZ	6625-00-193-0636	81349	MR36W150ACVVR	VOLTMETER .....		EA 1
14	2	PAOZZ	5950-00-705-9105	80063	SM-C-349908	TRANSFORMER,CURRENT .....		EA 1
14	3	PAOZZ	6240-00-223-9100	81349	M15098-10-001	LAMP,GLOW .....		EA 10
14	4	PAOZZ	6210-00-949-8353	T2619	37408-331-241	LIGHT,INDICATOR.....		EA 10
14	5	PAOZZ	5925-00-818-4811	04809	Q0-115	CIRCUIT BREAKER .....		EA 2
14	6	PAOZZ	5925-00-815-6657	04809	Q01515	CIRCUIT BREAKER .....		EA 2
14	7	PAOZZ	5925-00-011-2540	56365	Q02020	CIRCUIT BREAKER .....		EA 2
14	8	PAOZZ	5925-00-103-6084	56365	Q0250	CIRCUIT BREAKER .....		EA 1
14	9	PAOZZ	6625-00-542-1897	81349	MR36W050ACAAR	AMMETER .....		EA 1

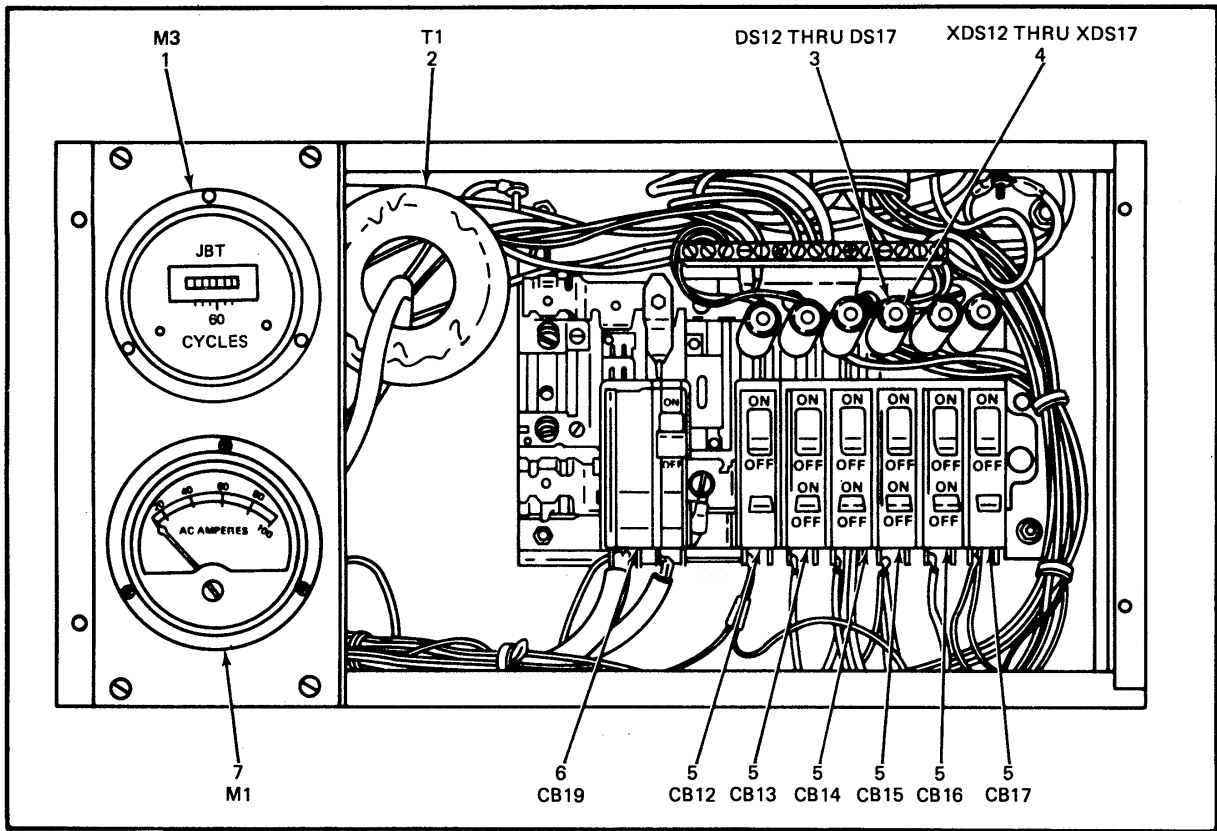
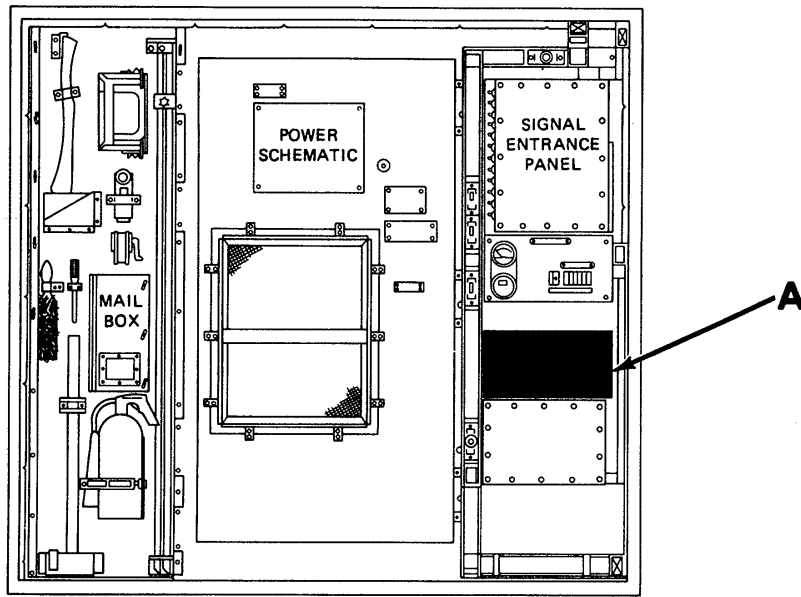

EL3G2017

Figure 15. Shelter, Electrical Equipment S-348/TSC-58 and S-348A/TSC-58A, Red Power Distribution Panel.

**SECTION II**

**TM 11-5805-574-24P**

(1) ILLUS- TRATION		(2)	(3)	(4)	(5)	(6)	(7)	(8)
(a) FIG NO.	(b) ITEM NO.	SMR CODE	NATIONAL STOCK NUMBER	FSCM	PART NUMBER	DESCRIPTION	USABLE ON CODE	U/M INC IN UNIT
15	1	PAOZZ	6625-00-841-6641	31356	31FHXXRUG	METER,ELECTRICAL .....		EA 1
15	2	PACZZ	5950-00-705-9105	80063	SM-C-349908	TRANSFORMER,CURRENT .....		EA 1
15	3	PAOZZ	6240-00-223-9100	81349	M15098-10-001	LAP,GLOW .....		EA 6
15	4	PACZZ	6210-00-949-8353	72619	37408-331-241	LIGHT,INDICATOR.....		EA 6
15	5	PAGZZ	5925-00-818-4811	04809	Q0-115	CIRCUIT BREAKER .....		EA 6
15	6	PAOZZ	5925-00-703-6084	56365	Q0250	CIRCUIT BREAKER .....		EA 1
15	7	PAOZZ	6625-00-542-1897	81349	MR36W050ACAAR	AMMETER .....		EA 1

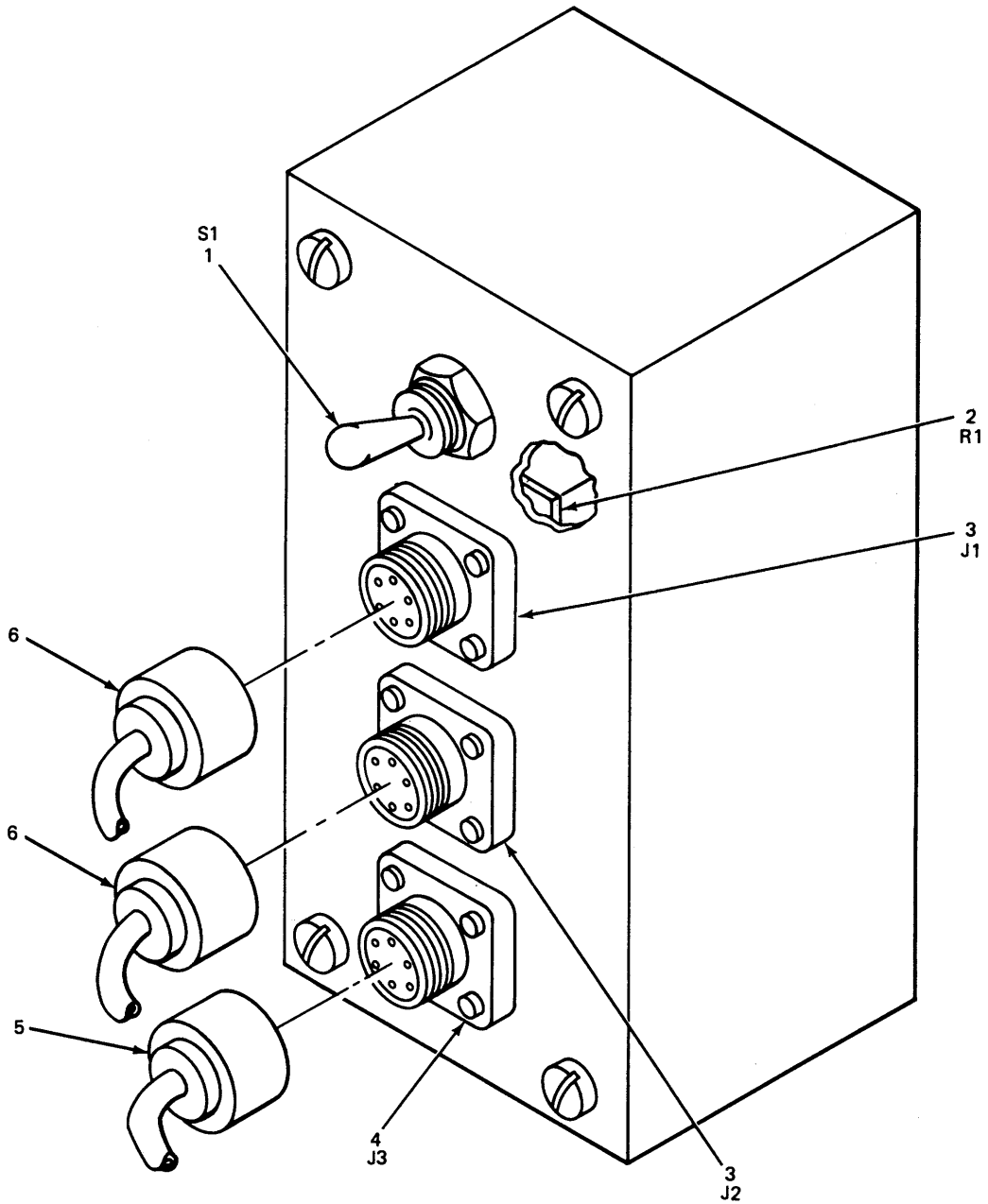

EL3GZ018

Figure 16. Shelter, Electrical Equipment S-348/TSC-58 and S-348A/TSC-58A, Auxiliary-Dummy Box.

**SECTION II**

**TM 11-5805-574-24P**

(1) ILLUS- TRATION		(2)	(3)	(4)	(5)	(6)	(7)	(8)
(a) FIG NO.	(b) ITEM NO.	SMR CODE	NATIONAL STOCK NUMBER	FSCM	PART NUMBER	DESCRIPTION	USABLE ON CODE	U/M INC IN UNIT
16	1	PAOZZ	5930-00-655-1514	96906	MS35058-22	SWITCH,TOGGLE .....		EA 6
16	2	PAOZZ	5905-00-104-5757	81349	RCR32G273JS	RESISTOR,FIXED COMP .....		EA 6
16	3	PAOZZ	5935-00-402-3956	77820	PT02A10-98P	CONNECTOR,RCPT,ELE .....		EA 12
16	4	XDOZZ		77820	PT02A-10-98S	CONNECTOR,RCPT,ELEC .....		EA 6
16	5	PAOZZ	5935-00-992-0304	13973	860488-2	CONNECTOR,PLUG,ELEC .....		EA 6
16	6	PAOZZ	5935-00-992-0303	77820	PT06E10-98SSR	CONNECTOR,PLUG,ELEC .....		EA 12



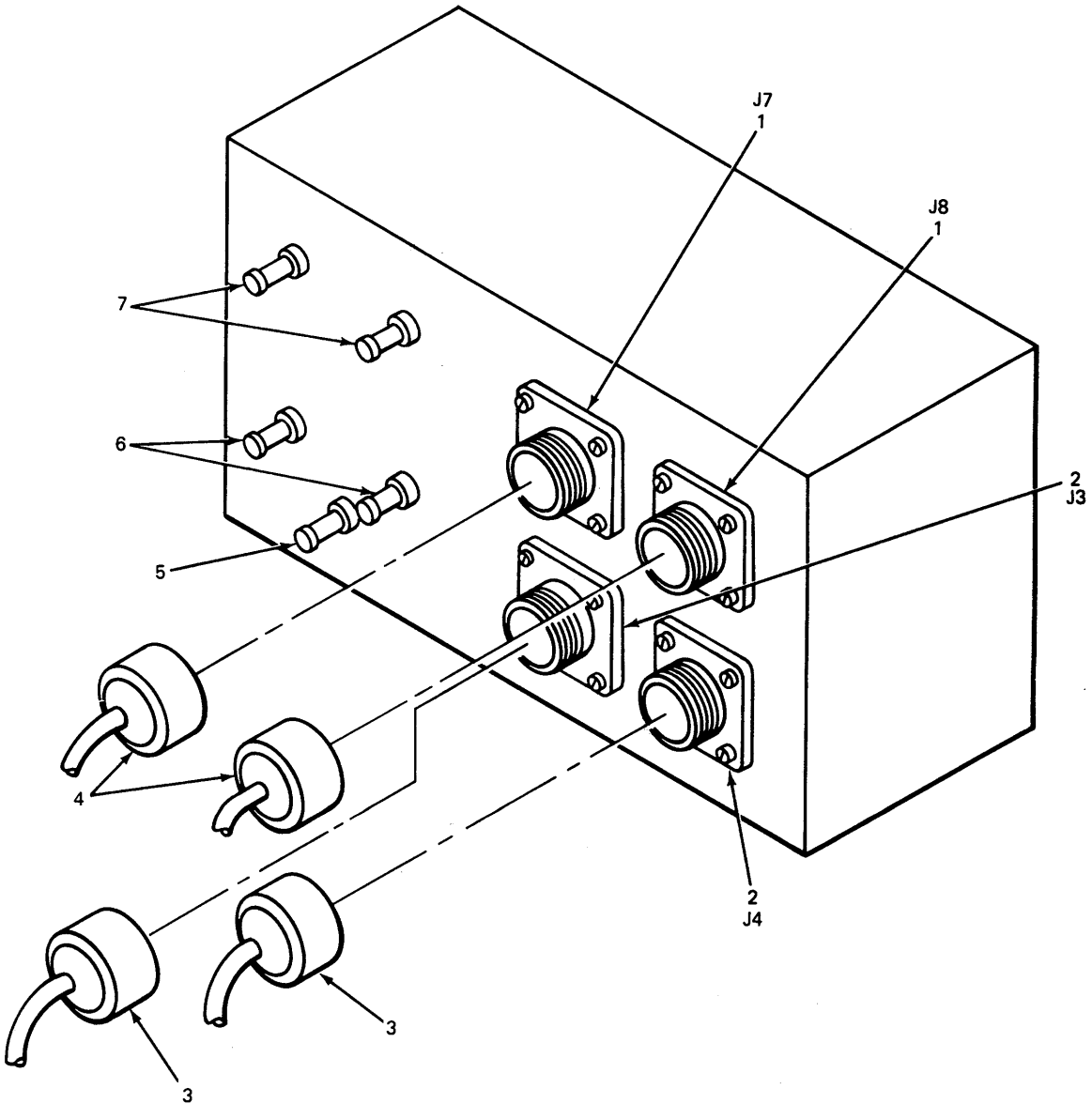

EL3GZ019

Figure 17. Shelter, Electrical Equipment S-348/TSC-58 and S-348/TSC-58A, Interconnection Box.

**SECTION II**

**TM 11-5805-574-24P**

(1) ILLUS- TRATION		(2)	(3)	(4)	(5)	(6)	(7)	(8)
(a) FIG NO.	(b) ITEM NO.	SMR CODE	NATIONAL STOCK NUMBER	FSCM	PART NUMBER	DESCRIPTION	USABLE ON CODE	U/M INC IN UNIT
17	1	PAOZZ	5935-00-992-0311	77820	PT02E10-98S	CONNECTOR,RCPTELEC .....		EA 1
17	2	PAOZZ	5935-00-992-0312	77820	PT02E10-98P	CONNECTOR,RCPTELEC .....		EA 12
17	3	PAOZZ	5935-00-992-0303	77820	PT06E10-98SSR	CONNECTOR,PLUG,ELEC .....		EA 12
17	4	PAOZZ	5935-00-992-0304	13973	860488-2	CONNECTOR,PLUG,ELEC .....		EA 12
17	5	PAOZZ	5940-00-269-2219	81349	PB01FA04	POST,BINING,ELECTR .....		EA 6
17	6	PAOZZ	5940-00-116-6595	58474	DF30WTCWHITE	POST,BINDING,ELECTR.....		EA 12
17	7	PAOZZ	5940-00-685-8603	83330	257-105	POST,BINDING,ELECTR.....		EA 12

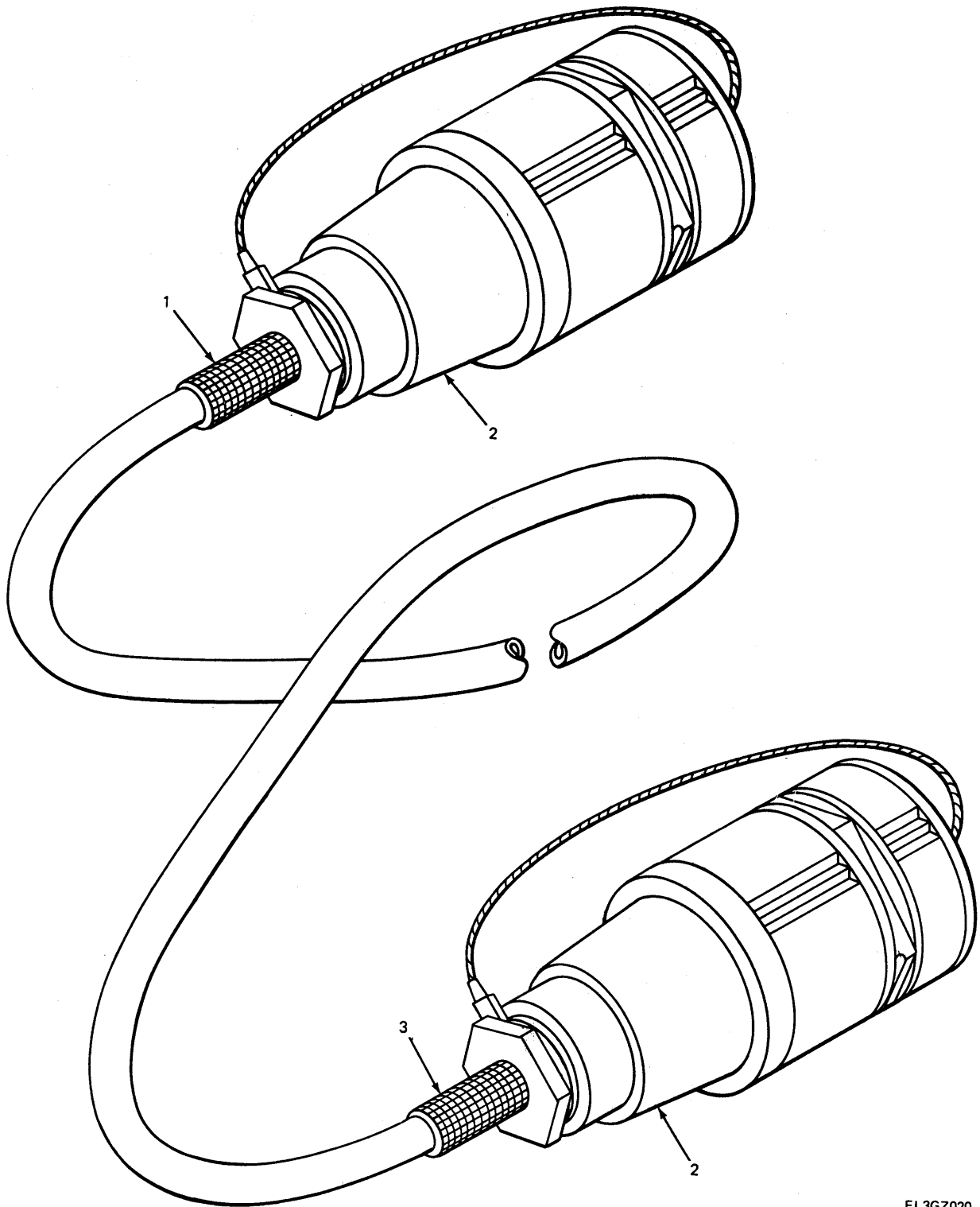

EL3GZ020

Figure 18. Cable Assembly, Power, Electrical CX-7453 A/U.

**SECTION II**

**TM 11-5805-574-24P**

(1) ILLUS- TRATION		(2)	(3)	(4)	(5)	(6)	(7)	(8)
(a) FIG NO.	(b) ITEM NO.	SMR CODE	NATIONAL STOCK NUMBER	FSCM	PART NUMBER	DESCRIPTION	USABLE ON CODE	U/M INC IN UNIT
						GROUP 1003 CABLE ASSEMBLY, POWER, ELECTRICAL CX-7453 A/U		
18	1	PAOZZ	5120-00-946-5114	80063	SCB539593	GRIP,CABLE,WOVEN.....	EA	1
18	2	PAOZZ		80058	U-237A/G	CONNECTOR,PLUG,ELEC .....	EA	2
18	3	PAOZZ	5120-00-946-5148	80063	SC8539592	GRIP,CABLE,WOVEN.....	EA	1

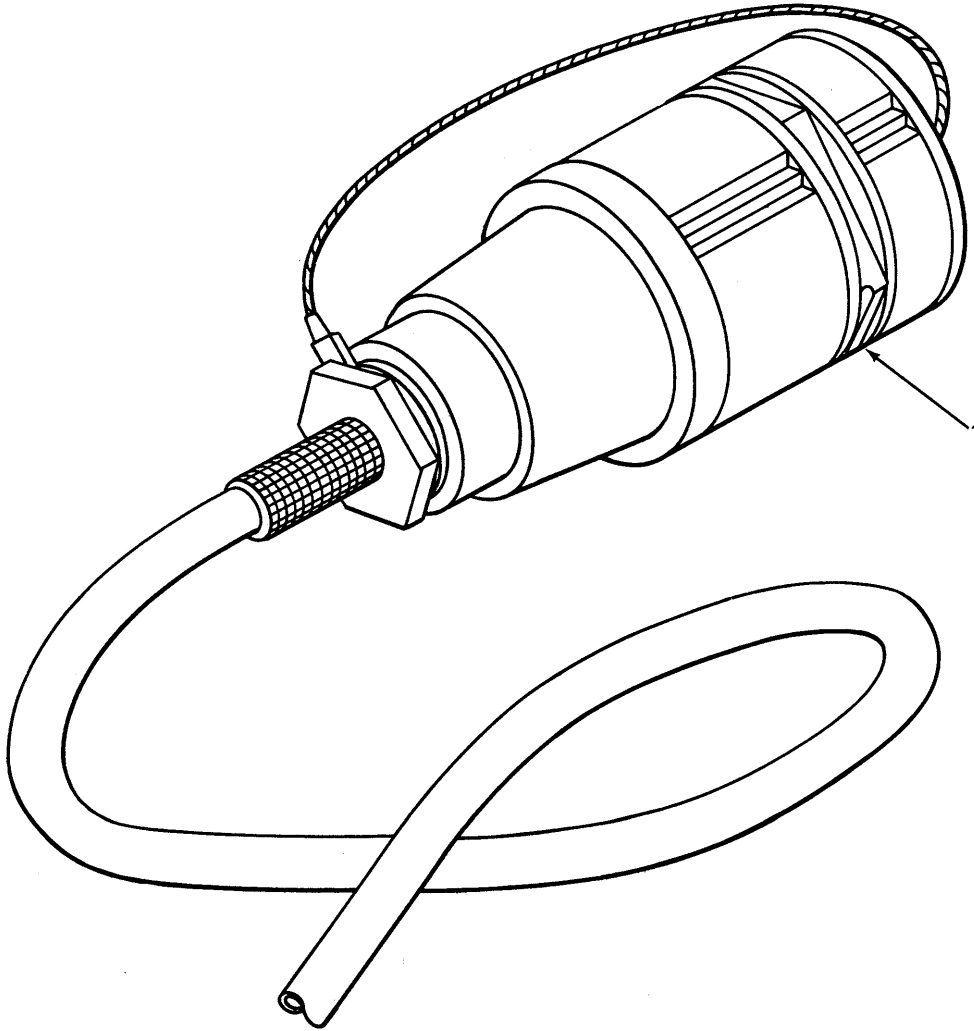
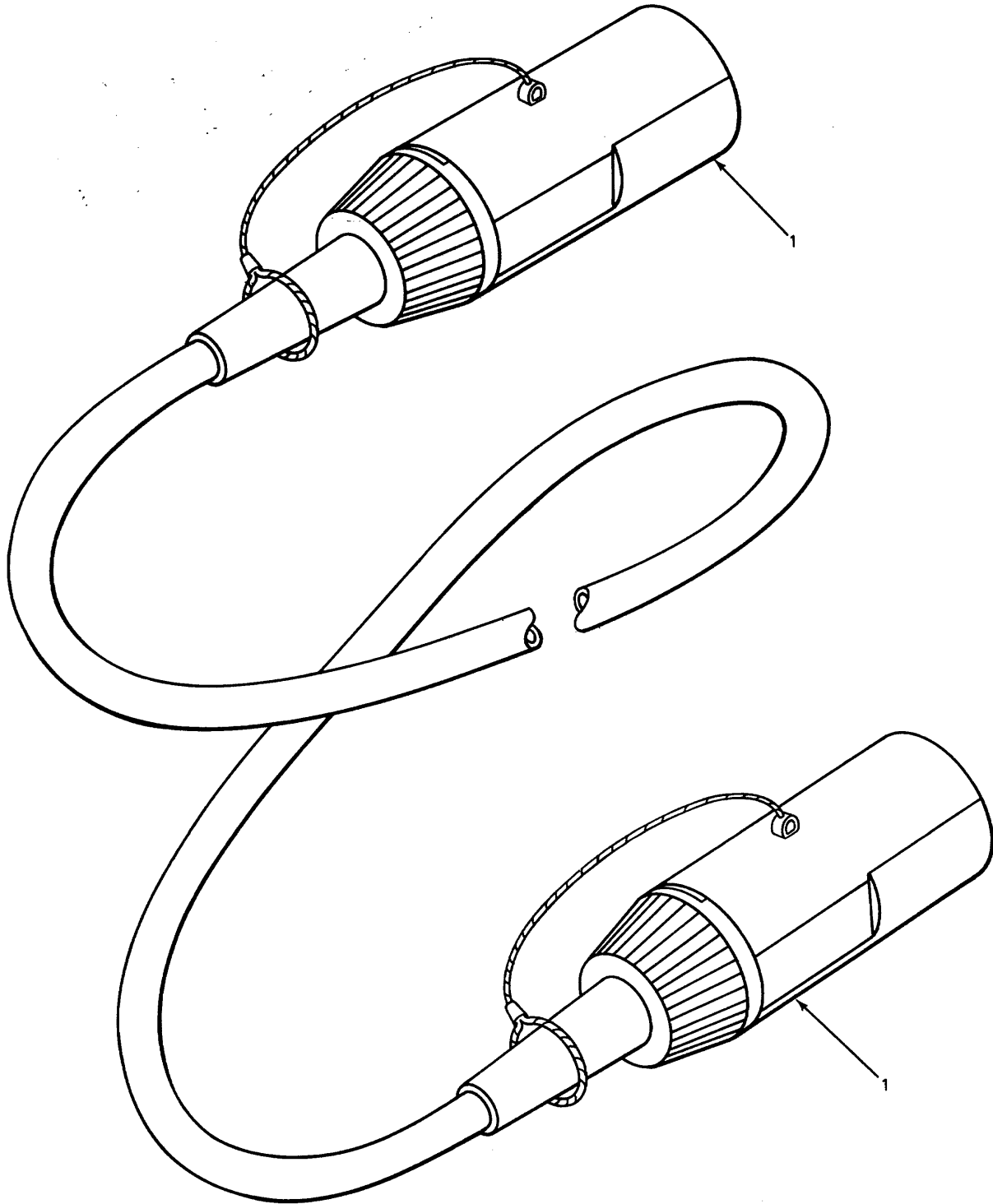

Figure 19. Cable Assembly, Power, Electrical CX-7705 A/U

**SECTION II**

**TM 11-5805-574-24P**

(1) ILLUS- TRATION		(2)	(3)	(4)	(5)	(6)	(7)	(8)
(a) FIG NO.	(b) ITEM NO.	SMR CODE	NATIONAL STOCK NUMBER	FSCM	PART NUMBER	DESCRIPTION	USABLE ON CODE	U/M INC IN UNIT
19	1	PAOZZ		80058	U-231A/G	GROUP 1004 CABLE ASSEMBLY, POWER, ELECTRICAL CX-7705 A/U  CONNECTOR, PLUG, ELEC .....		EA 1



EL3GZ022

Figure 20. Cable Assembly, Telephone CX-4566 A/U.

**SECTION II**

**TM 11-5805-574-24P**

(1) ILLUS- TRATION		(2)	(3)	(4)	(5)	(6)	(7)	(8)
(a) FIG NO.	(b) ITEM NO.	SMR CODE	NATIONAL STOCK NUMBER	FSCM	PART NUMBER	DESCRIPTION	USABLE ON CODE	U/M INC IN UNIT
20	1	PAHZZ	5935-00-577-8846	80058	U-185/G	GROUP 1005 CABLE ASSEMBLY, TELEPHONE CX-4566 A/U CONNECTCOR, PLUG. ELEC.....		EA 2



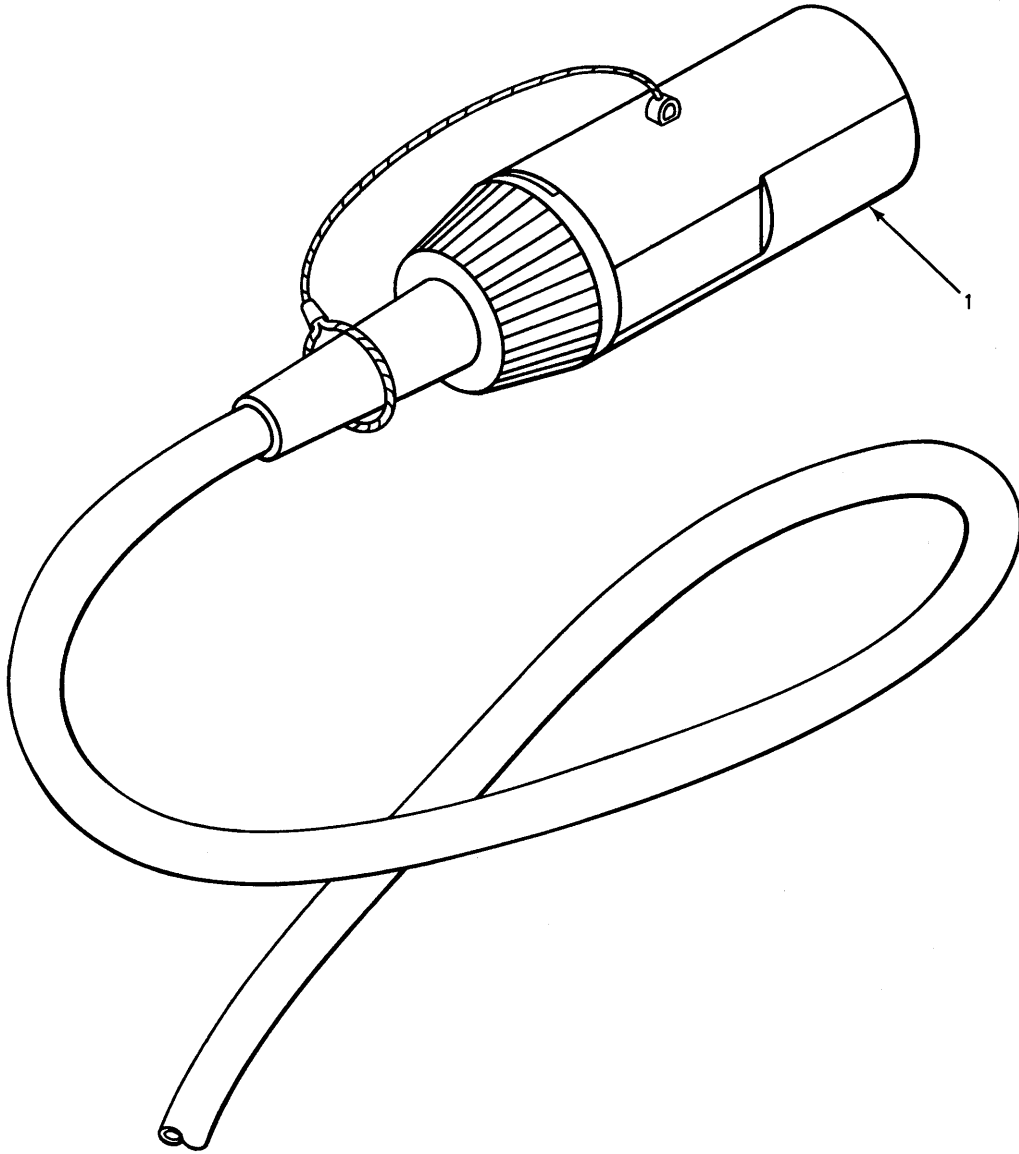

EL3G2023

Figure 21. Cable Assembly, Telephone CX-4760 A/U

**SECTION II**

**TM 11-5805-574-24P**

(1) ILLUS- TRATION (a) (b) FIG ITEM NO. NO.		(2) SMR CODE	(3) NATIONAL STOCK NUMBER	(4) FSCM	(5) PART NUMBER	(6) DESCRIPTION  USABLE ON CODE	(7) U/M	(8) QTY INC IN UNIT
21	1	PAHZZ	5935-00-577-8846	80058	U-185/G	GROUP 1006 CABLE ASSEMBLY, TELEPHONE CX-4760 A/U  CONNECTOR, PLUG ELEC .....EA		1

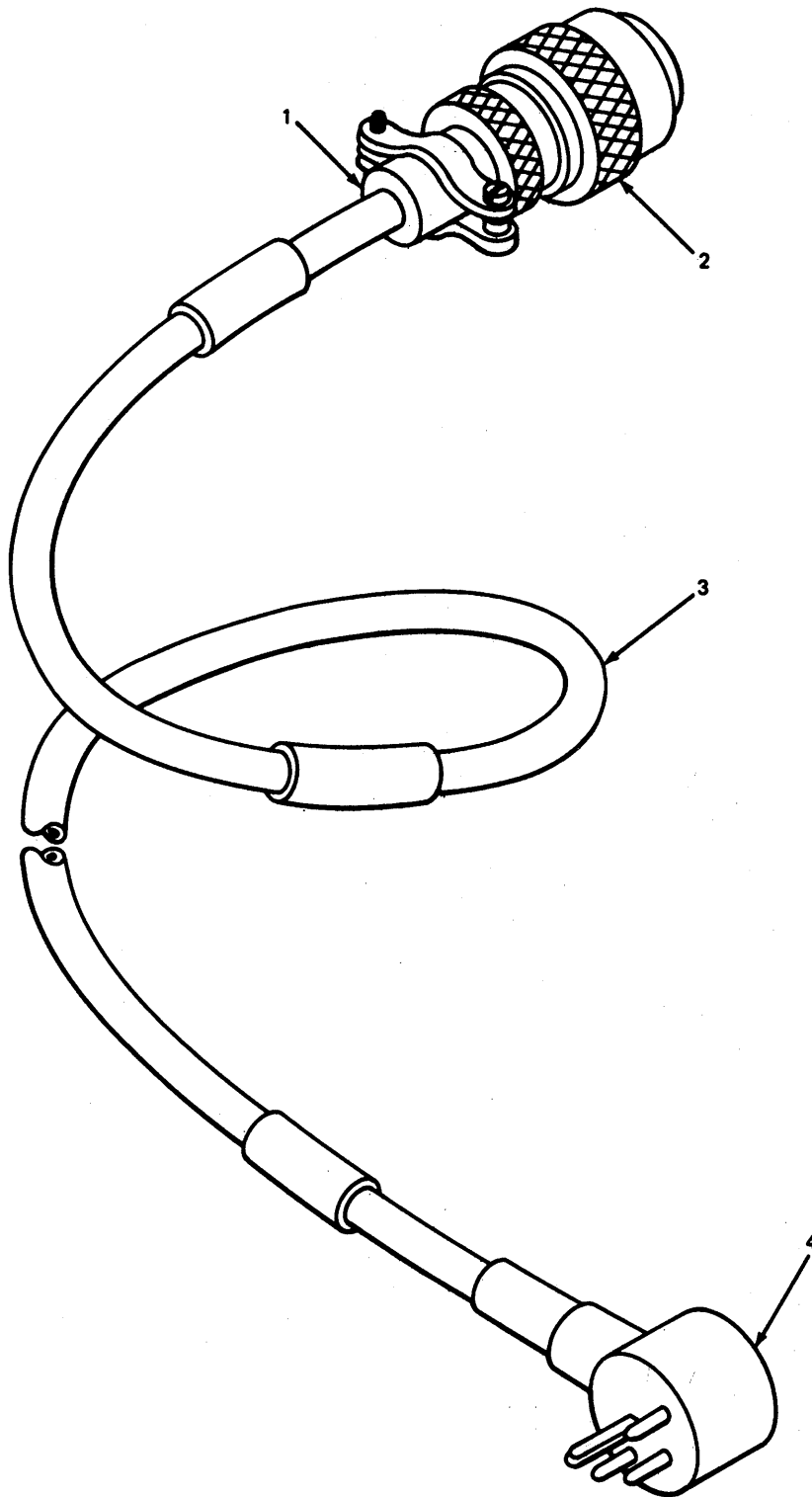

EL3GZ024

Figure 22. Special Purpose Cable SC-D-960025-001.

**SECTION II**

**TM 11-5805-574-24P**

(1) ILLUS- TRATION (a) (b) FIG ITEM NO. NO.		(2) SMR CODE	(3) NATIONAL STOCK NUMBER	(4) FSCM	(5) PART NUMBER	(6) DESCRIPTION	(7) U/M	(8) QTY INC IN UNIT
							USABLE ON CODE	
						GROUP 1007 SPECIAL PURPOSE CABLE SC-D-960025-001		
22	1	PAFZZ	5365-00-828-8526	96906	MS3420-6A	BUSHING, RUBBER.....	EHB	EA 1
22	2	PAFZZ	5935-00-901-9871	96906	MS3116F-12-3S	CONNECTOR, PLUG ELEC .....	EHB	EA 1
22	3	XDFZZ		81349	C0-02MGE(2/20)SJ	CABLE, ELECTRICAL .....	EHB	FT V
				80063	0290			
22	4	XAFZZ		80063	SC-C-960036	HOUSING, CONNECTOR.....	EHB	EA 1

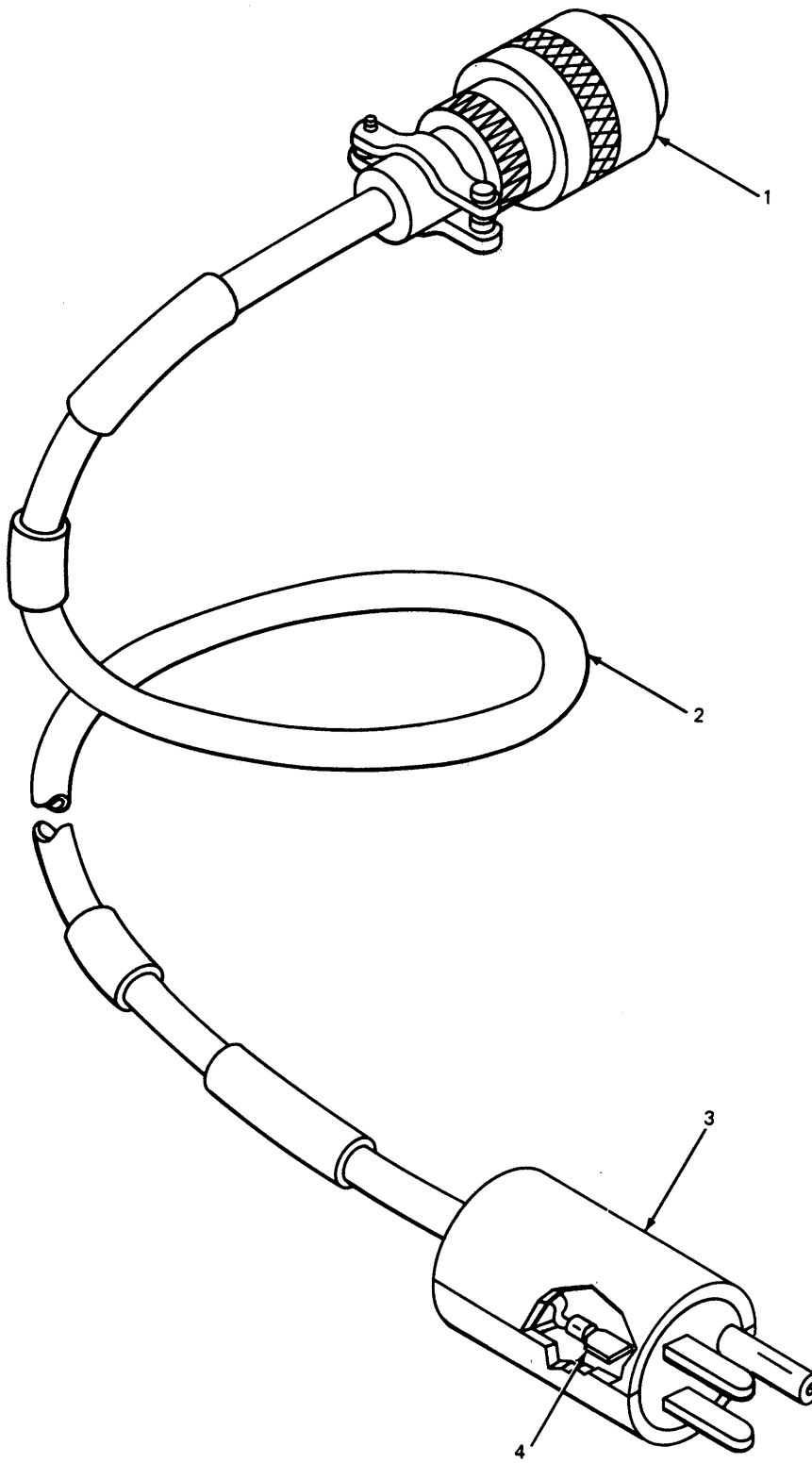

EL3GZ025

Figure 23. AC Power Cable SC-D-960025-000.

**SECTION II**

**TM 11-5805-574-24P**

(1) ILLUS- TRATION (a) (b) FIG ITEM NO. NO.		(2) SMR CODE	(3) NATIONAL STOCK NUMBER	(4) FSCM	(5) PART NUMBER	(6) DESCRIPTION  USABLE ON CODE	(7) U/M	(8) QTY INC IN UNIT
23	1	PAFZZ	5935-00-892-9776	96906	MS3116F14-12S	GROUP 1008 AC POWER CABLE SC-D-960025-000 CONNECTOR, PLUG, ELEC .....EHB	EA	1
232	XDFZZ			81349	C0-03MLF(3/16)SJ 0420	CABLE, ELECTRICAL .....EHB	FT	V
23	3	PAFZZ	5935-01-005-3579	81348	WC596-13-3	CONNECTOR, PLUG, ELEC .....EHB	EA	1
234	PAFZZ			80063	SC-D-681322-8	TERMINAL, LUG.....EHB	EA	1

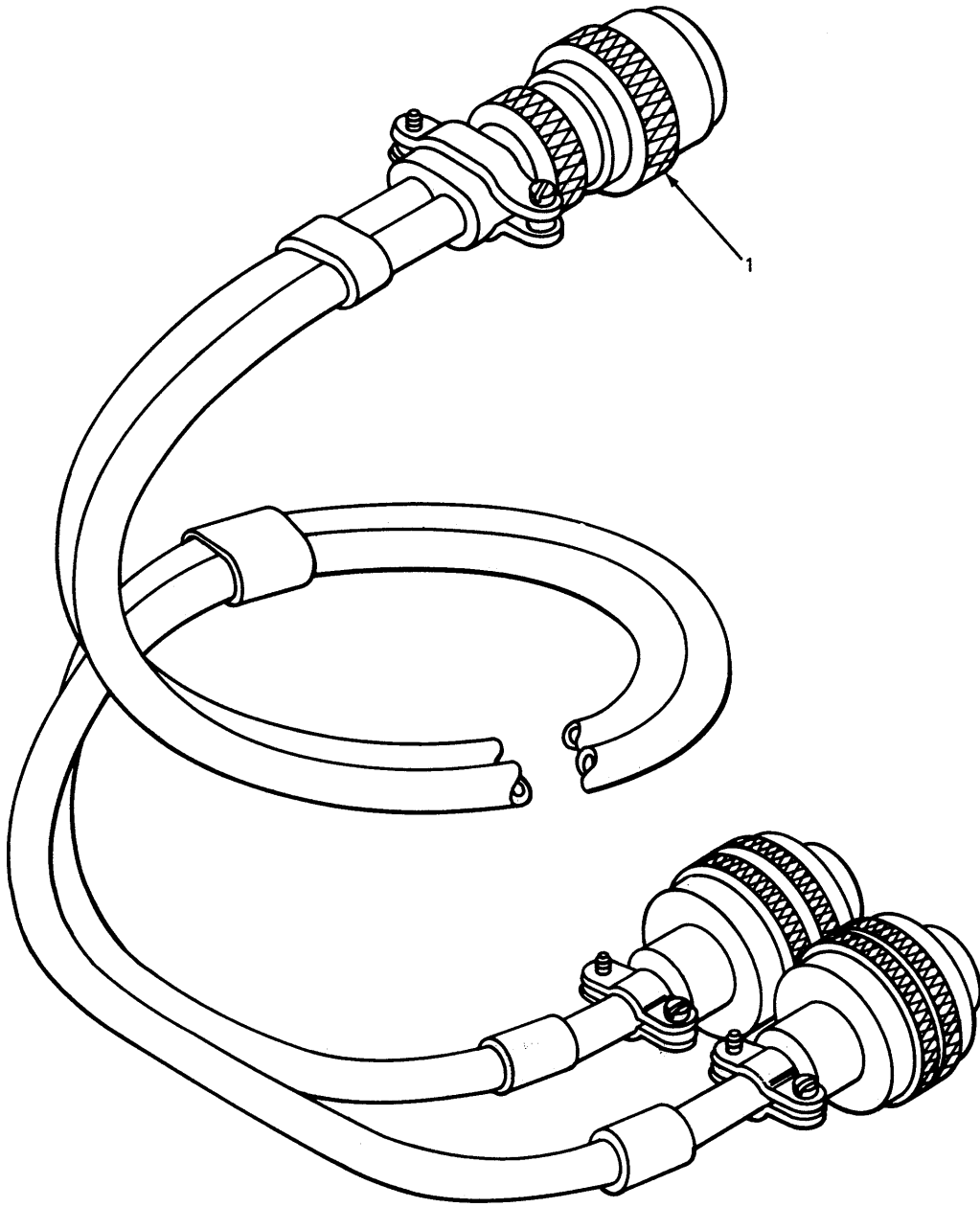

EL3GZ026

Figure 24. Cable Assembly, Signal SC-D-960324

**SECTION II**

**TM 11-5805-574-24P**

(1) ILLUS- TRATION (a) (b) FIG ITEM NO. NO.		(2) SMR CODE	(3) NATIONAL STOCK NUMBER	(4) FSCM	(5) PART NUMBER	(6) DESCRIPTION  USABLE ON CODE	(7) U/M	(8) QTY INC IN UNIT
24	1	PAFZZ	5935-00-772-9261	96906	MS3116F-16-26P	GROUP 1009 CABLE ASSEMBLY, SIGNAL SC-D-960324 CONNECTOR, PLUG. ELEC .....EHB	EA	1



NATIONAL STOCK NUMBER AND PART NUMBER INDEX

STOCK NUMBER	FIGURE NO.	ITEM NO.	STOCK NUMBER	FIGURE NO.	ITEM NO.
5925-00-011-2540	14	7	5940-00-685-8603	17	7
5935-00-045-9832	13	3	5925-00-703-6084	14	8
5915-00-057-4845	12	2	5925-00-703-6084	15	6
5305-00-068-0499	6	4	5950-00-705-9105	14	2
5305-00-068-0502	6	16	5950-00-705-9105	15	2
5915-00-080-4606	10	6	5940-00-716-6595	17	6
5310-00-080-6004	3	14	5945-00-758-4564	10	2
5930-00-087-4712	8	6	5935-00-772-9261	24	1
5310-00-017-7493	3	11	5930-00-802-1164	5	13
5905-00-104-5751	16	2	5310-00-807-1466	6	5
5915-00-116-8916	9	7	5310-00-809-4058	2	19
5995-00-143-9858	1	2	5310-00-809-4058	4	4
5935-00-149-2919	5	6	5310-00-809-4058	6	3
5935-00-149-2919	8	3	5310-00-809-4058	6	18
6210-00-151-5243	5	2	5310-00-809-8544	6	21
6250-00-158-8900	9	5	5925-00-815-6657	14	6
5910-00-161-6862	10	3	5925-00-818-4811	14	5
5305-00-175-3230	6	9	5925-00-818-4811	15	5
5995-00-179-2921	5	7	6250-00-822-8550	5	9
5995-00-179-2922	8	2	5305-00-828-8526	22	1
5995-00-179-2925	8	9	6625-00-841-6641	15	1
6625-00-193-0636	14	1	5970-00-869-6263	13	2
5935-00-222-9828	10	5	5915-00-880-6034	12	1
6240-00-223-9100	14	3	5995-00-889-0803	1	4
6240-00-223-9100	15	3	5935-00-892-9776	23	1
5305-00-225-3839	2	17	5935-00-901-8871	22	i
5310-00-225-5328	2	15	6210-00-921-6682	9	1
5306-00-225-8498	3	16	5935-00-933-3454	5	5
5935-00-228-4038	8	7	5935-00-933-3454	11	5
5940-00-269-2219	17	5	5310-00-933-8119	2	16
4210-00-288-6849	11	6	5995-00-935-2686	1	6
6250-00-299-4722	11	3	5950-00-942-8457	5	10
5935-00-350-1834	5	8	5950-00-942-8457	12	9
5935-00-350-1834	8	1	5120-00-966-5114	18	1
5935-00-350-1835	10	8	5120-00-946-5148	18	3
5935-00-402-3956	16	3	6210-00-949-8353	14	4
5411-00-404-5965	1	1	6210-00-949-8353	15	4
5310-00-407-9566	3	15	5305-00-984-5674	3	10
6210-00-451-8350	9	9	5305-00-984-6195	2	14
6210-00-485-9856	5	12	5995-00-985-7571	1	3
6150-00-495-1214	8	5	5935-00-992-0303	16	6
5915-00-496-3372	10	7	5935-00-992-0303	17	3
5915-00-496-3372	12	5	5935-00-992-0304	16	5
5930-00-501-1739	5	1	5935-00-992-0304	17	4
5805-00-503-1145	5	11	5935-00-992-0311	17	1
6625-00-542-1897	14	9	5935-00-992-0312	17	2
6625-00-542-1897	15	7	5305-00-993-2738	3	9
5935-00-577-8846	20	1	5305-00-995-3441	2	8
5935-00-577-8846	21	1	6250-00-995-9074	9	8
5310-00-582-5965	2	18	5310-00-997-1888	3	7
5310-00-582-5965	4	5	5935-01-005-3579	23	3
5310-00-582-5965	6	17	5910-01-022-3080	5	4
5945-00-606-2903	10	4	5910-01-022-3080	8	4
6240-00-635-9753	11	2	5910-01-022-3080	9	3
5930-00-655-1514	16	1	5910-01-022-3080	12	6
5930-00-660-5584	11	4	5310-01-064-8787	4	6
5925-00-682-4015	12	10	5935-01-123-4520	12	7
5930-00-683-2703	11	1	6645-01-135-2296	10	1

FSCM	PART NUMBER	FIGURE NO.	ITEM NO.	FSCM	PART NUMBER	FIGURE NO.	ITEM NO.
96344	BZ-23PT	5	11	96906	MS21318-14	6	9
91929	BZ2RQ18A2	11	1	96906	MS25244-20	12	10
81349	CP69B1EF504K1	10	3	96906	MS27183-10	2	19
80058	CX-4566A/G	1	3	96906	MS27183-10	4	4
80058	CX-4760A/U	1	4	96906	MS27183-10	6	3
80058	CX-7453A/U	1	5	96906	MS27183-10	6	18
80058	CX-7105A/U	1	6	96906	MS27183-13	3	11
81349	CO-02MGE(2/20)SJ0290	22	3	96906	MS27183-14	3	14
81349	CO-03MLF(3/16)SJ0420	23	2	96906	MS27183-7	6	21
58474	DF30WTCWHITE	17	6	96906	MS3116F-12-3S	22	2
80058	JJ-085	8	7	96906	MS3116F-16-26P	24	1
81349	LH74-1LC13RN2	5	2	96906	MS3116F14-12S	23	1
81349	MR36W050ACAAR	14	9	96906	MS3420-6A	22	1
81349	MR36W050ACAAR	15	7	96906	MS35058-22	16	1
81349	MR36W150ACVVR	14	1	96906	MS35206-247	2	14
96906	MS15795-841	2	15	96906	MS35206-294	3	10
96906	MS21042-08	6	5	96906	MS35207-269	2	8

## NATIONAL STOCK NUMBER AND PART NUMBER INDEX

FSCM	PART NUMBER	FIGURE NO.	ITEM NO.	FSCM	PART NUMBER	FIGURE NO.	ITEM NO.
96906	MS35207-280	3	9	80063	SC-0-681322-8	23	4
96906	MS35338-137	2	16	80063	SC-0-959762-10	4	11
96906	MS35338-44	2	18	80063	SC-0-959762-8	4	10
96906	MS35338-44	4	5	80063	SC-D-959162-9	4	3
96906	MS35338-44	6	17	80063	SC-D-959762-9	4	8
96906	MS35338-45	3	15	80063	SC-D-960025-003	2	2
96906	MS35425-70	4	6	80063	SC-D-960027-000	2	3
96906	MS35649-2252	3	7	80063	SC-D-960324-001	2	1
96906	MS51861-22	2	11	80063	SC-D-960329	2	20
96906	MS90725-2	6	4	80063	SC-D-960331	3	4
96906	MS90725-33	3	16	80063	SC-D-960337	2	22
96906	MS90725-6	6	16	80063	SC-D-960343	2	12
96906	MS90725-8	2	17	80063	SC-D-960344	2	13
81349	M12883-03-01	10	5	80063	SC-D-960350	2	7
81349	M15098-10-001	14	3	80063	SC-D-960359	3	1
81349	M15098-10-001	15	3	80063	SC-D-960364	3	2
81349	M15098-3-002	11	2	80063	SC-D-960366	6	10
21873	M3780-F5	12	4	80063	SC-D-960374	2	24
14655	NFT1F246	10	7	80063	SC-D-960379	2	25
14655	NFT1F246	12	5	80063	SC-D-960384	2	21
81349	PB01FA04	17	5	80063	SC-D-960648	4	9
77342	PR07AY0240V	10	2	80063	SC-D-960663	4	7
77820	PT02A-10-98S	16	4	80063	SC-D-960667	3	12
77820	PT02A10-98P	16	3	80063	SCB539592	18	3
77820	PT02E10-98P	17	2	80063	SCB539593	18	1
77820	PT02E10-98S	17	1	80063	SCC76202-1	13	2
77820	PT06E10-98SSR	16	6	80063	SM-B-475056	6	15
77820	PT06E10-98SSR	17	3	80063	SM-B-657092	5	8
19634	P4D	9	2	80063	SM-B-657092	8	1
04809	Q0-115	14	5	80063	SM-C-349904	10	1
04809	Q0-115	15	5	80063	SM-C-349908	14	2
04809	Q01515	14	6	80063	SM-C-349908	15	2
56365	Q02020	14	7	80063	SM-C-657095	10	8
56365	Q0250	14	8	81831	SP-285	12	2
56365	Q0250	15	6	51932	SP126	12	1
80058	RC-435/U	1	2	51932	SP266	10	b
81349	RCR32G273JS	16	2	05624	TC153	5	1
80058	S-348/TSC-58	1	1	81349	U-106/U	13	1
80058	S-348/TSC-58A	1	1	80058	U-185/G	20	1
80063	SC-B-539492	8	5	80058	U-185/G	21	1
80063	SC-B-564065-1	6	6	80058	U-187A/G	13	3
80063	SC-B-564065-2	6	7	80058	U-237A/G	18	2
80063	SC-B-564065-3	6	8	80058	U-237A/G	19	1
80063	SC-B-564065-4	6	6	80058	U-2388/G	12	7
80063	SC-B-564065-5	6	7	81348	WC596-13-3	23	3
80063	SC-B-564065-6	6	8	81349	WC596STYLEJ23	5	6
80063	SC-B-960038	2	23	81349	WC596STYLEJ23	8	3
80063	SC-B-960381	11	7	24446	WS-896-STYLE-41	5	3
80063	SC-C-539466	9	1	81348	WS896-2-02A	11	4
80063	SC-C-539466-1	9	9	82796	11900514	11	6
80063	SC-C-564143GR1	8	8	72619	140-5030-1471-201	5	12
80063	SC-C-564143GR2	8	9	19557	156	12	8
80063	SC-C-578639GR1	8	2	14752	23081C505F	5	4
80063	SC-C-578639GR2	5	7	14752	23081C505F	8	4
80063	SC-C-629275	2	9	14752	23081C505F	9	3
80063	SC-C-960036	22	4	14752	23081C505F	12	6
80063	SC-C-960339	2	6	83330	257-105	17	7
80063	SC-C-960340	2	4	31356	31FHXXRUG	15	1
80063	SC-C-960360	3	3	94227	320	5	10
80063	SC-C-960361	3	5	94227	320	12	9
80063	SC-C-960367	3	8	37695	368220-1	12	3
80063	SC-C-960375	3	6	72619	37408-331-241	14	4
80063	SC-C-960376	2	5	72619	37408-331-241	15	4
80063	SC-C-960380	3	13	74545	4113	11	3
80063	SC-C-960385	2	10	74545	4229	5	9
80063	SC-C-960385-1	6	2	71744	4365-034	9	8
80063	SC-C-960649	4	1	74545	5361	5	5
80063	SC-C-960697	4	2	74545	5361	11	5
80063	SC-D-564011-1	6	19	02777	5918	9	1
80063	SC-D-564011-3	6	20	82389	6009L	5	13
80063	SC-0-564011-4	6	14	24446	78X736	9	4
80063	SC-D-564129	6	13	13973	860488-2	16	5
80063	SC-D-564150-GRI	6	11	13973	860488-2	17	4
80063	SC-D-564150-GRII	6	11	18876	8898876	10	4
80063	SC-D-564150-2	6	12	24446	89G4570	9	6
80063	SC-D-578636	6	13	27193	8906K1384	8	6
80063	SC-D-578693	6	10	73586	9200A	9	5
80063	SC-D-578725	6	1				

RECOMMENDED CHANGES TO EQUIPMENT TECHNICAL PUBLICATIONS

 <p style="font-size: small; margin: 0;"><i>THEN...JOT DOWN THE DOPE ABOUT IT ON THIS FORM. CAREFULLY TEAR IT OUT, FOLD IT AND DROP IT IN THE MAIL.</i></p>		SOMETHING WRONG WITH PUBLICATION	
		FROM: (PRINT YOUR UNIT'S COMPLETE ADDRESS)	
		DATE SENT	
PUBLICATION NUMBER		PUBLICATION DATE	PUBLICATION TITLE
IN THIS SPACE, TELL WHAT IS WRONG AND WHAT SHOULD BE DONE ABOUT IT.			
BE EXACT PIN-POINT WHERE IT IS			
PAGE NO.	PARA-GRAPH	FIGURE NO.	TABLE NO.
PRINTED NAME, GRADE OR TITLE AND TELEPHONE NUMBER		SIGN HERE	

TEAR ALONG PERFORATED LINE

By Order of the Secretary of the Army:

E.C. MEYER  
*General, United States Army*  
*Chief of Staff*

Official:

ROBERT M. JOYCE  
*Major General, United States Army*  
*The Adjutant General*

Distribution:

To be distributed in accordance with Special Mailing List.



This fine document...

Was brought to you by me:



## [Liberated Manuals -- free army and government manuals](#)

Why do I do it? I am tired of sleazy CD-ROM sellers, who take publicly available information, slap “watermarks” and other junk on it, and sell it. Those masters of search engine manipulation make sure that their sites that sell free information, come up first in search engines. They did not create it... They did not even scan it... Why should they get your money? Why are not letting you give those free manuals to your friends?

I am setting this document FREE. This document was made by the US Government and is NOT protected by Copyright. Feel free to share, republish, sell and so on.

I am not asking you for donations, fees or handouts. If you can, please provide a link to [liberatedmanuals.com](http://liberatedmanuals.com), so that free manuals come up first in search engines:

<A HREF=<http://www.liberatedmanuals.com/>>Free Military and Government Manuals</A>

- Sincerely  
Igor Chudov  
<http://igor.chudov.com/>
- [Chicago Machinery Movers](#)