

DEPARTMENT OF THE ARMY TECHNICAL MANUAL

DEPOT MAINTENANCE REPAIR PARTS AND SPECIAL TOOL LISTS
TABLE, TILTING, GYRO INSTRUMENT TESTING MX-4042 (□) /ASW-12(V)

Headquarters, Department of the Army, Washington 25, D.C.

13 August 1962

CHANGE

HEADQUARTERS
DEPARTMENT OF THE ARMY
Washington, DC, 30 November 1982

No. 1

**DEPOT MAINTENANCE REPAIR PARTS AND SPECIAL TOOL LISTS
TABLE, TILTING, GYRO INSTRUMENT TESTING MX-4042()/ASW-12(V)
(4920-00-889-1880)**

TM 11-4920-209-50P, 13 August 1962, is changed as follows:

Page 2-8, Section II.1 is added after Section II.

By Order of the Secretary of the Army:

Official:

ROBERT M. JOYCE
Major General, United States Army
The Adjutant General

E. C. MEYER
General, United States Army
Chief of Staff

DISTRIBUTION:

To be distributed in accordance with DA Form 12-36, Direct and General Support Maintenance Requirements for AN/ASW-12.

SECTION I INTRODUCTION

1-1. GENERAL.

1-2. This illustrated Parts Breakdown lists, describes and illustrates the parts of the following equipment manufactured by the Sperry Phoenix Company Division of Sperry Rand Corporation, Phoenix, Arizona.

Description	Part Number
Table Scorsby	T100925 2585881
Adapter Scorsby	T100945

1-3. This breakdown will be used for requisitioning, storing, issuing and identifying parts. For overhaul procedures of the equipment refer to the appropriate handbook of overhaul instructions.

1-4. GROUP ASSEMBLY PARTS LIST.

1-5. GENERAL. Section II, Group Assembly Parts List, consists of a breakdown of the complete unit into subassemblies and detailed parts. Each assembly is listed in its order of disassembly and is followed immediately by its component parts indented to show their relationship to the assembly. Attaching parts are listed immediately following the part which they attach. Items which are made from raw stock, such as cut lengths of wire, insulating materials, and seal wire are not included in the Group Assembly Parts List.

1-6. FIGURE AND INDEX NUMBER COLUMN. In this column, the digits preceding the hyphen refer to the figure in the parts breakdown on which a part or assembly is illustrated. The digits following the hyphen are the index numbers of procurable and non-procurable parts and assemblies. Parts shown for reference purposes only are not given index numbers. The index numbers are arranged numerically in the Group Assembly Parts List and are used mainly to identify parts found on an illustration, and to assist in locating a part in the Group Assembly Parts List after it has been found in the Numerical Index.

1-7. PART NUMBER COLUMN. In this column are listed either the Sperry part numbers which are the same as drawing numbers, AN (Air Force-Navy), JAN (Joint Army-Navy), MIL (Military), FED (Federal) standard part numbers, or part numbers of vendors other than Sperry. If a part is purchased from a vendor and the part is not physically altered by Sperry, the vendor's part number is listed in the

part number column. Part numbers are used exclusively to identify parts.

1-8. Parts to which no number has been assigned but which may be purchased on the open market are identified by the word "Coml", shown in the part number column. When ordering these parts, the complete description must be given.

1-9. DESCRIPTION COLUMN. In this column is listed the noun name of the part, as assigned according to Federal Item Identification Guides for Supply Cataloging H6-1 or ANA Bulletin No. 411A, together with modifiers and enough descriptive information to completely identify the part. Parts purchased from vendors other than Sperry are so indicated by means of manufacturer's code symbols as assigned by Federal Supply Code for Manufacturer H4-1, or by the name and address of the vendor when no manufacturer's code symbol has been assigned. If a part is purchased from a vendor other than Sperry, the Sperry number of the part is listed on the descriptive column while the vendor's part number is listed in the part number column.

1-10. UNITS PER ASSEMBLY COLUMN. This column lists the quantity of assemblies or parts required in the immediately preceding assembly of which the given part of assembly is a component. The quantities specified, therefore, are not necessarily the total used per equipment. Refer to the Numerical Index, Section III, for the total quantities used per equipment. The Letters "AR" denote that the selection of a part or parts should be made "as required". "REF" refers to an assembly which is completely assembled on a preceding illustration, and is now exploded on the illustration on which it is referenced. In this case the description has a notation which refers to the illustration on which the assembly is shown completely assembled and indexed.

1-11. USABLE ON CODE COLUMN. Part variations within the groups of equipment are indicated by a letter symbol immediately following the units per assembly in the "Usable on Code" column. In cases where the "Usable on Code" column has been left blank, parts listed apply to all the equipment covered by this book.

1-12. NUMERICAL INDEX.

1-13. GENERAL. Section III, Numerical Index lists all the part numbers appearing in the part number column of the Group Assembly Parts List.

1-14. PART NUMBER COLUMN. In this column are listed part numbers, which are the same as

drawing numbers, for procurable and non-procurable parts and assemblies in the Group Assembly Parts List.

1-15. CLASS CODE OR STOCK NUMBER COLUMN. This column, which appears in both Section III, Numerical Index and Section IV, Reference Designation Index, contains only Federal Stock Numbers. When Federal Stock Number has not been assigned by the Procuring Service, to an item which appears in the Illustrated Parts Breakdown, reference should then be made to the Master Cross-Reference Indexes, Publication Numbers S-00-1 and S-00-1-1.

1-16. FIGURE AND INDEX NUMBER COLUMN. In this column the digits preceding the dash refer to the figure in the parts breakdown on which the parts or assemblies are illustrated. The digits following the dash are the index numbers of procurable or non-procurable parts or assemblies. For Government and contractor standard parts, the figure and index number shown in the Numerical Index is the figure and index for the first occurrence only of such parts in the Group Assembly Parts List.

1-17. QUANTITY PER ARTICLE COLUMN. In this column is listed the total quantity of parts or assemblies per unit of equipment. Where the total quantity of a part is not the same for the different units of equipment covered by this parts breakdown, the largest quantity for any one unit is shown.

1-18. SOURCE CODE COLUMN. Source coding has not been supplied by the procuring department.

1-19. REFERENCE DESIGNATION INDEX. The Reference Designation Index is not applicable to this publication.

1-20. IDENTIFICATION OF PARTS.

1-21. FINDING ILLUSTRATION AND NOMENCLATURE WHEN PART NUMBER IS KNOWN. When a part number is known and it is desired to locate the illustration and proper nomenclature for the part, refer first to Section III, Numerical Index. Using the alphabetical-numerical arrangement, locate the part number in the list. Opposite the part number will be

found the figure-index number which refers back to Section II, Group Assembly Parts List. Proper nomenclature for the part in question will be found in its correct sequence in the Group Assembly Parts List. The part will be illustrated on the reference figure number in the Group Assembly Parts List, and may be located in the illustration by means of the index number.

1-22. FINDING THE PART NUMBER. When the part number is not known and it is desired to locate its number and nomenclature, first refer to the Table of Contents of the Parts Breakdown for the page number of the major assembly which illustrates the desired part. Then refer to Section II, Group Assembly Parts List, and identify the part on the illustration by its index number. The proper part number and nomenclature will be found immediately opposite the figure and index number in the listing for the illustration.

1-23. MANUFACTURER'S CODE SYMBOLS. If a part is purchased from a vendor other than Sperry, and a manufacturer's code symbol has been assigned to the vendor and is listed in Federal Supply Code for Manufacturers H4-1, the vendor's code is listed in the description column. The vendor's codes which are used in this Illustrated Parts Breakdown are listed below:

C O D E SYMBOL	VENDOR'S NAME AND ADDRESS
07296	Billings and Spencer Co., The Hartford, Connecticut
30120	Ideal Aerosmith, Inc. Cheyenne, Wyoming
70318	Allmetal Screw Products Co., Inc. Garden City, New York
82084	Geier and Bluhm, Inc. Troy, New York
90045	Williams, J. H., and Co. New York, New York

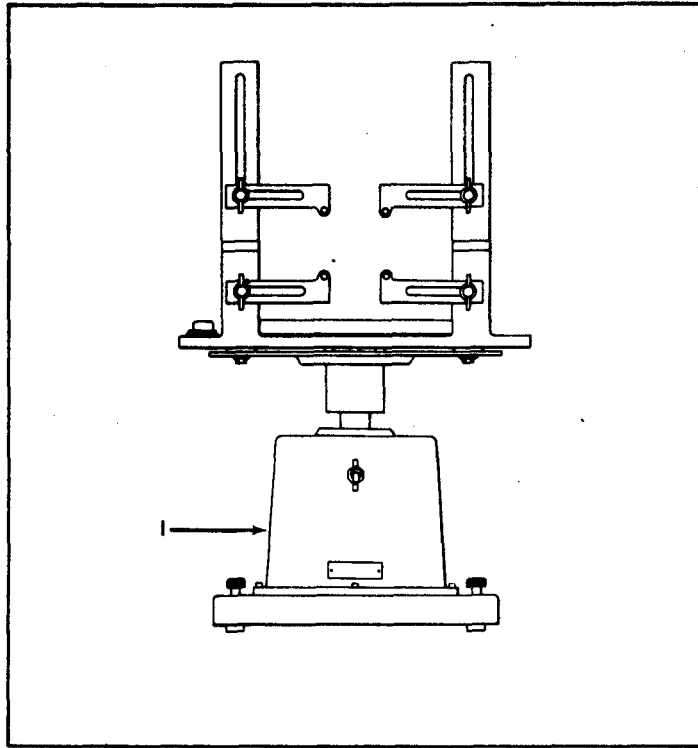

Figure 1. Table Scorsby

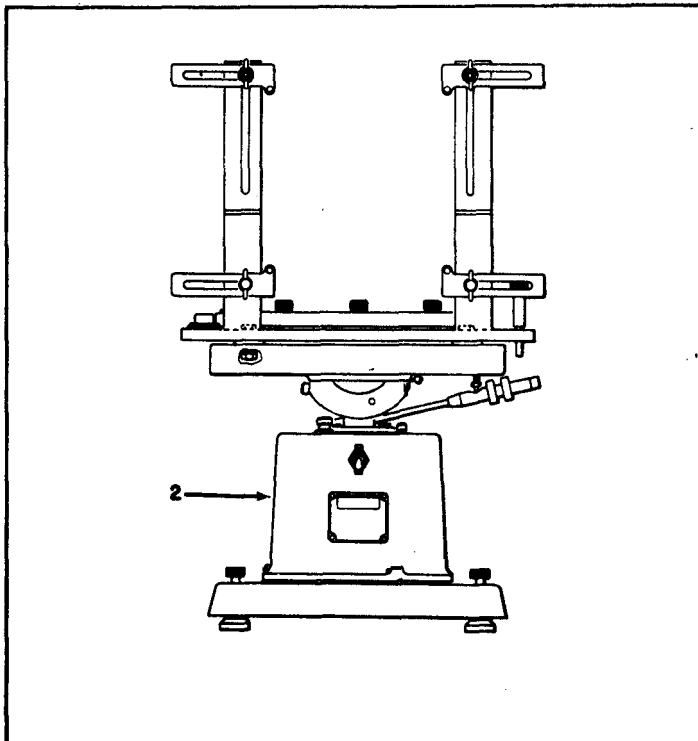

Figure 2. Table Scorsby

SECTION II
GROUP ASSEMBLY PARTS LIST

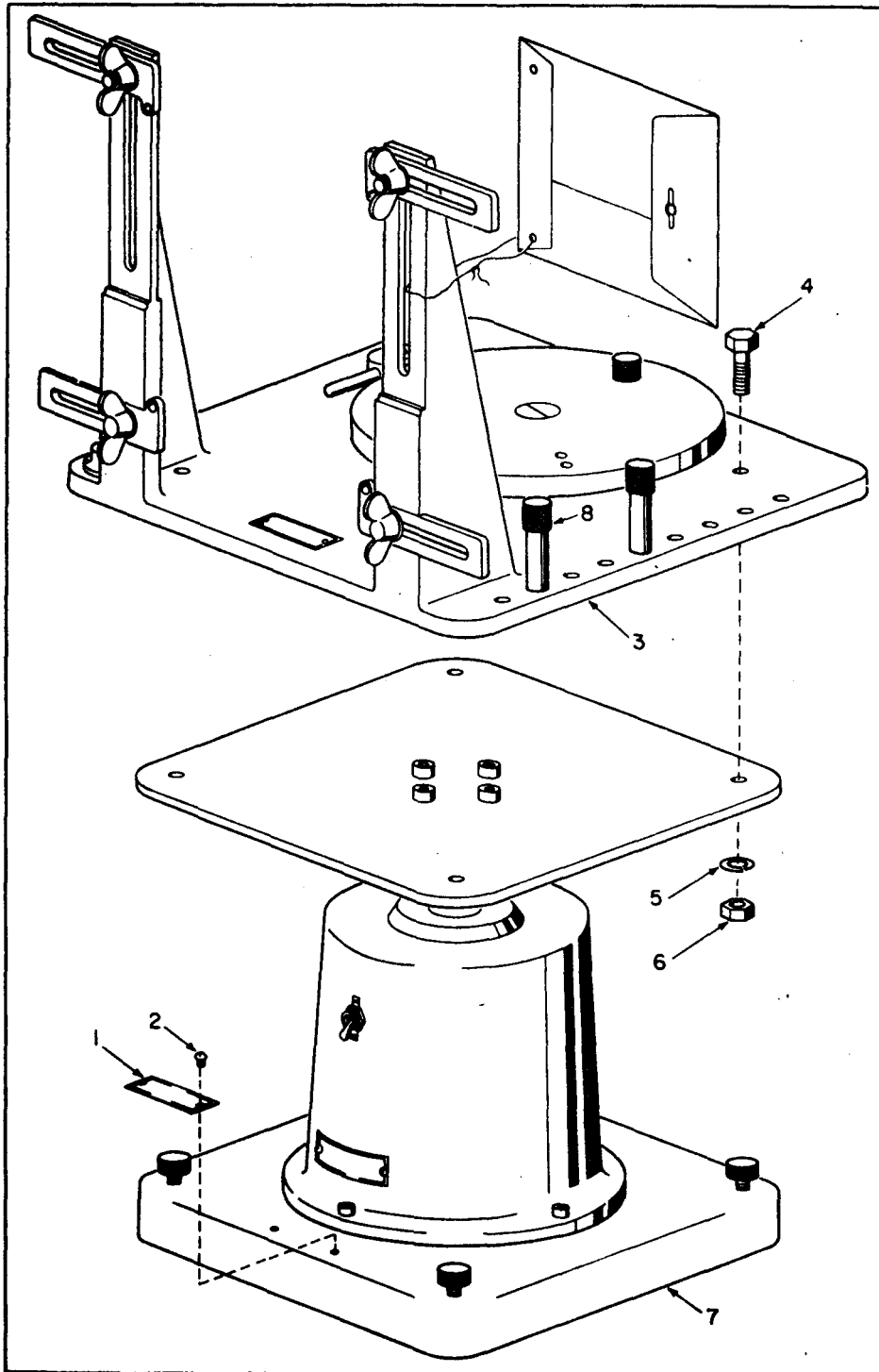

Figure 3. Table Scorsby

SECTION II
GROUP ASSEMBLY PARTS LIST

T.O. 33D3-10-6-4

FIGURE AND INDEX NUMBER	PART NUMBER	DESCRIPTION 1 2 3 4 5 6 7	UNITS PER ASSY	USABLE ON CODE
TABLE SCORSBY				
3-	T100925	TABLE SCORSBY	1	
-1	T100925-100	.PLATE, IDENTIFICATION /ATTACHING PARTS/	1	
-2	AN535-6-5	.SCREW, DRIVE, STL CAU PL NO.6 X 5/16 IN. /SPERRY PT.NO.0466-017/ - - - * - - -	2	
-3	T100930	.MOUNT ASSY /SEE FIG.5 FOR BREAKDOWN/ /ATTACHING PARTS/	1	
-4	MS35307-7	.SCREW, CAP, HEX HD, SST 1/4-20 X 7/8 IN. /SPERRY PT.NO.0419-388/	4	
-5	MS35338-82	.WASHER, LOCK, CRES, FOR NO.1/4 SCREW /SPERRY PT.NO.0164-11/	4	
-6	COML	.NUT, PLAIN, HEX, CRES NO.1/4-20 /70318/SPERRY PT.NO.0424-018/ - - - * - - -	4	
-7	14C6R	.TABLE, SCORSBY /30120/SPERRY PT.NO.T100925-600/	1	
TABLE SCORSBY				
4-	2585881	TABLE SCORSBY	1	
-1	2554367	.PLATE, IDENTIFICATION /ATTACHING PARTS/	1	
-2	AN535-6-5	.SCREW, DRIVE, STL CAU PL NO.6 X 5/16 IN. /SPERRY PT.NO.0466-017/ - - - * - - -	2	
-3	2518579	.THUMBSCREW NO.6-32 X 2-1/4 IN.	4	
-4	2518578	.THUMBSCREW NO.10-32 X 2-1/4 IN.	4	
-5	2585889	.MOUNT ASSY /SEE FIG.6 FOR BREAKDOWN/ /ATTACHING PARTS/	1	
-6	MS35307-7	.SCREW, CAP, HEX HD, SST 1/4-20 X 7/8 IN. /SPERRY PT.NO.0419-388/	4	
-7	MS35338-82	.WASHER, LOCK, CRES, FOR NO.1/4 SCREW /SPERRY PT.NO.0164-11/	4	
-8	COML	.NUT, PLAIN, HEX, CRES NO.1/4-20 /70318/SPERRY PT.NO.0424-018/ - - - * - - -	4	
-9	1406-RS	.TABLE, SCORSBY /3012C/SPERRY PT.NO.2585909/	1	

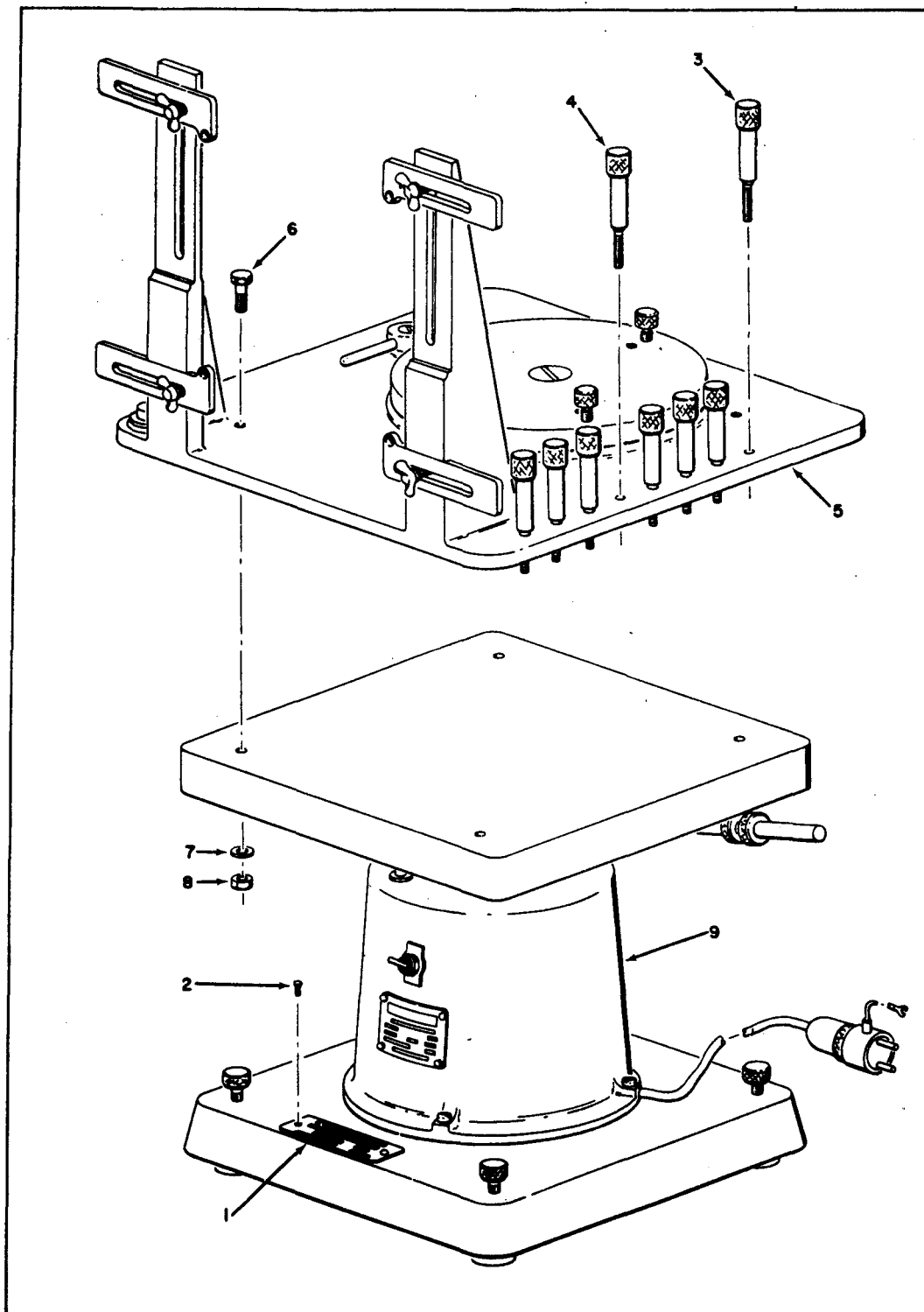

Figure 4. Table Scorsby

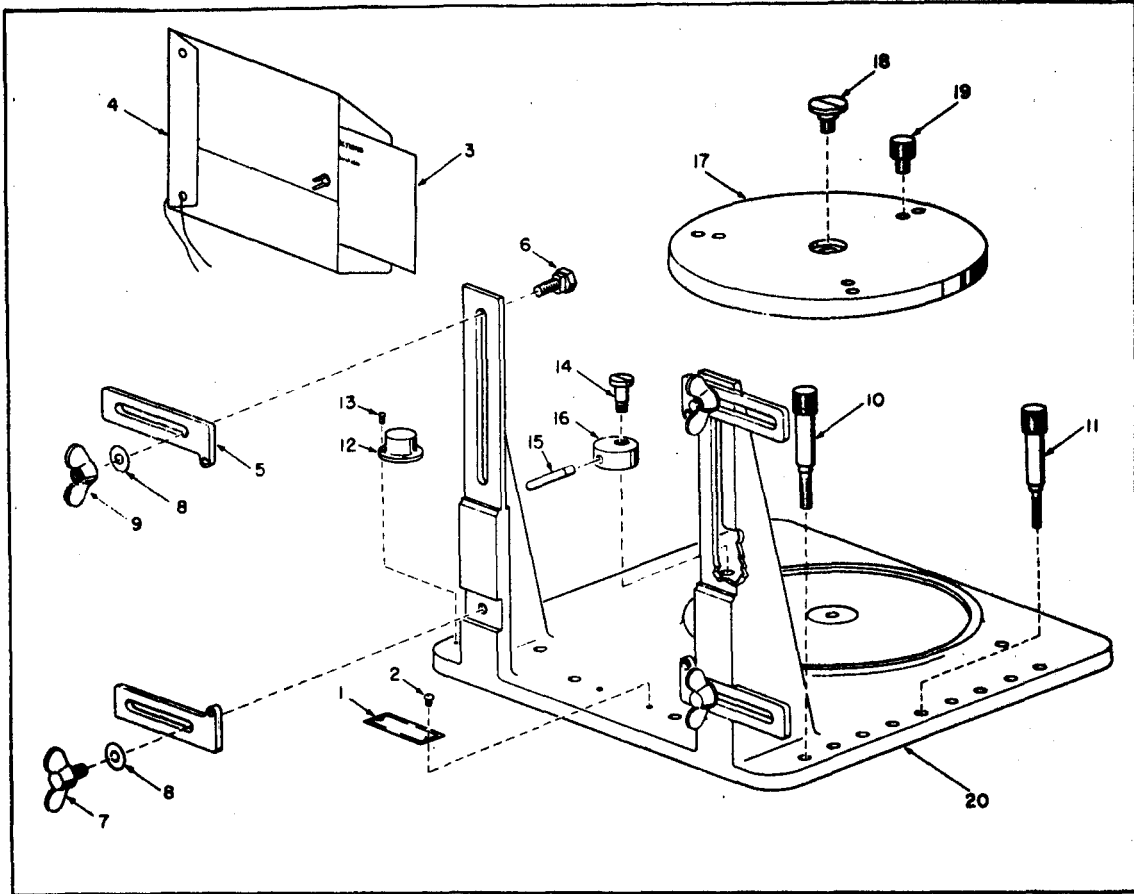

Figure 5. Mount Assembly

FIGURE AND INDEX NUMBER	PART NUMBER	DESCRIPTION							UNITS PER ASSY	USABLE ON CODE
		1	2	3	4	5	6	7		
MOUNT ASSEMBLY										
5-	T100930	MOUNT ASSY /SEE FIG.3-4 FOR NEAT HIGHER ASSY/								
- 1	T100930-104	• PLATE, IDENTIFICATION /ATTACHING PARTS/							1	
- 2	AN535-2-3	• SCREW, DRI VE, STL CAD PL NO.2 X 3/16 IN. /SPERRY PT. NO.0466-008/							2	
- 3	T100930-111	• SHEET, INSTRUCTION							1	
- 4	T100930-113	• ENVELOPE, INSTRUCTION							1	
- 5	T100930-105	• SUPPORT /ATTACHING PARTS/							4	
- 6	T100930-103	• SCREW, GUIDE							2	
- 7	COHL	• THUMBSCREW, WING HD, STL 1/4-20 X 1/2 IN. /90045/SPERRYPT. NO.0469-304/							2	
- 8	O188-11	• WASHER, FLAT, SST, FOR 0.265 IN. SCREW							4	
- 9	COHL	• NUT, PLAIN, WING, STL 1/4-20 X 11/16 IN. LG. OA /07296/SPERRYPT. NO.0132-6/							2	
- 10	T100930-101	• THUMBSCREW NO.10-32 X 2-1/4 IN.							4	
- 11	T100930-102	• THUMBSCREW NO.6-32 X 2-1/4 IN.							4	

FIGURE AND INDEX NUMBER	PART NUMBER	DESCRIPTION	UNITS PER ASSY							USABLE ON CODE
			1	2	3	4	5	6	7	

MOUNT ASSEMBLY (c ont)

5-	12	• LEVEL, CIRCULAR /82084/SPERRY PT. NO. T100930-112/								1
-	13	• SCREW, DRIVE, STL CAD PL NO. 00 X 1/4 IN. /SPERRY PT. NO. 0466-003/								3
5-	T100930-109	• CAM LOCK ASSY /ATTACHING PARTS/								1
-	14	• SCREW, PIVOT								1
-	15	• HANDLE								1
-	16	• CAM								1
-	17	• TABLE, MOUNTING /ATTACHING PARTS/								1
-	18	• SCREW, REVOLVING TABLE								1
-	19	• THUMBSCREW 1/4-20 X 1/2 IN.								3
-	20	• BASE, TEST TABLE								1

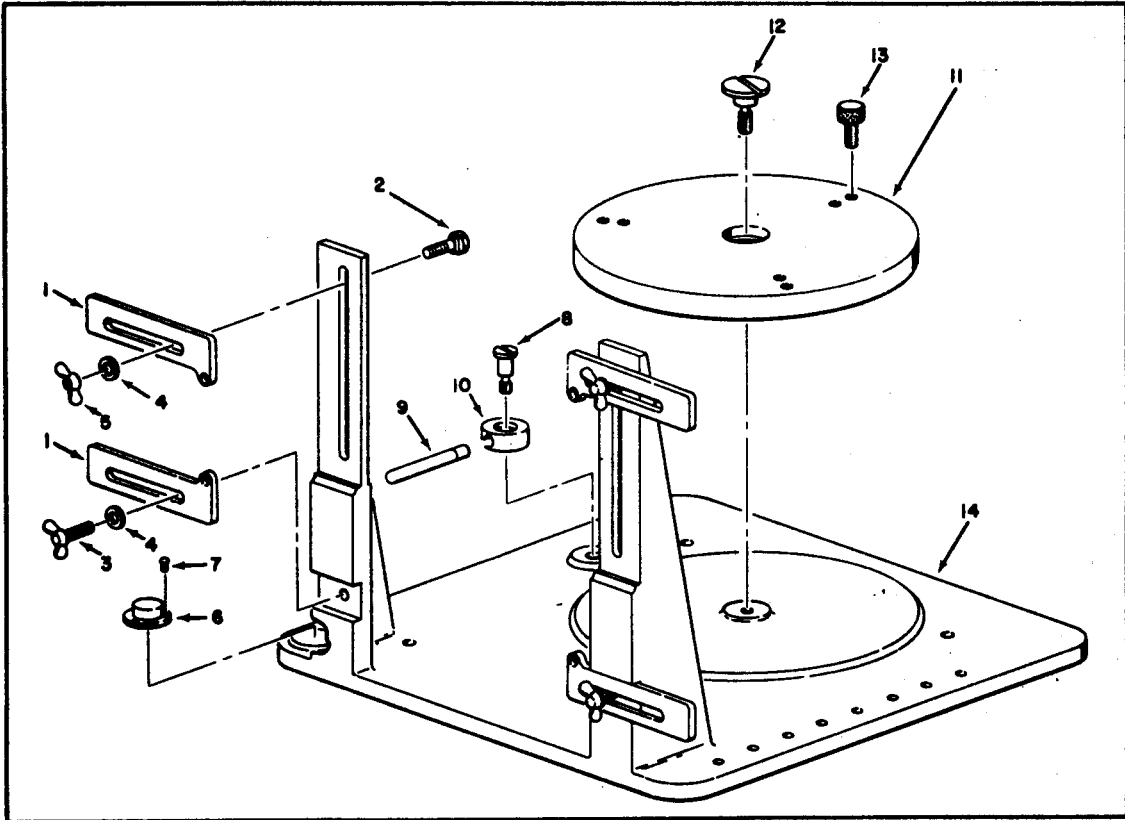

Figure 6. Mount Assembly

SECTION II
GROUP ASSEMBLY PARTS LIST

T.O. 33D3-10-6-4

FIGURE AND INDEX NUMBER	PART NUMBER	DESCRIPTION 1 2 3 4 5 6 7 MOUNT ASSEMBLY	UNITS	USABLE
			PER ASSY	ON CODE
6-	2585889	MOUNT ASSY /SEE FIG.4-6 FOR NEXT HIGHER ASSY/	REF	
-1	2518581	.SUPPORT /ATTACHING PARTS/	4	
-2	2518580	.SCREW,GUIDE	2	
-3	COML	.THUMBSCREW,WING HD,STL 1/4-20 X 1 IN. /90045/SPERRY PT.NO.0469-389/	2	
-4	Q188-11	.WASHER,FLAT,SST,FOR 0.265 IN. SCREW	4	
-5	MS35425-14	.NUT,PLAIN,WING,STL ZINC PL 1/4-20 /SPERRY PT.NO.0470-018/ - - - * - - -	2	
-6	10	.LEVEL,CIRCULAR /82084/SPERRY PT.NO.2518586/ /ATTACHING PARTS/	1	
-7	AN535-0-2	.SCREW,DRIVE,STL CAD PL NO.00 X 1/4 IN. /SPERRY PT.NO.0466-003/ - - - * - - -	3	
6-	2554365	.CAM LOCK ASSY /ATTACHING PARTS/	1	
-4	2518582	.SCREW,PIVOT - - - * - - -	1	
-9	2518585	.HANDLE	1	
-10	2518584	.CAM	1	
-11	2554366	.TABLE,MOUNTING /ATTACHING PARTS/	1	
-12	2518577	.SCREW,SHOULDERED	1	
-13	2518583	.THUMBSCREW 1/4-20 X 1/2 IN. - - - * - - -	3	
-14	2585888	.BASE,TEST TABLE	1	

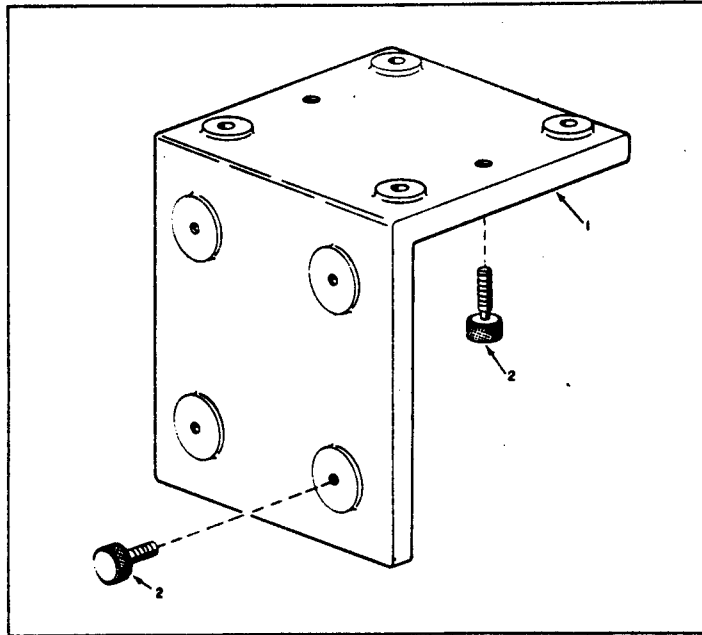

Figure 7. Adapter Scorsby

FIGURE AND INDEX NUMBER	PART NUMBER	DESCRIPTION							UNITS PER ASSY	USABLE ON CODS
		1	2	3	4	5	6	7		
ADAPTER SCORSBY										
7-	T100945	ADAPTER SCORSBY							1	
- 1	T100945-800	SUPPORT							1	
- a	T100945-100	SCREW							6	

SECTION II.1

CROSS REFERENCE INDEX. The Cross-Reference Index is a cross-reference listing of part number to National Stock Number.

a. Use of Cross-Reference Index. To order a part listed in the Cross-Reference Index, note part number and then cross-reference that part number to the National Stock Number in the cross-reference index. Then order through normal ordering channels.

b. Ordering Part Numbers Without National Stock Number. If the part number does not have a National Stock Number, then order the part through normal ordering channels using the part number and the FSCM.

CROSS REFERENCE INDEX

PARTS WITH AN FSN

FSN	NEW NSN	FSCM	PART NUMBER
53100426758	NONE	96906	MS35338-82
53051753230	5305001753230	88044	AN535-2-3
53051753238	NONE	88044	AN535-6-5
53051753238	NONE	88044	AN535-6-5
53052078253	5305002078253	96906	MS35307-7
53052078253	5305002078253	96906	MS35307-7
53052081859	NONE	88044	AN535-0-2
53052081859	5305002081859	88044	AN535-0-2
53102713223	NONE	53100	0188-11
53102713223	NONE	53100	0188-11
53102755512	NONE	56232	0424-018
53102755512	NONE	56232	0424-018
53102933739	NONE	56323	T100930-112
49203344680	NONE	56232	T100925
49203495972	NONE	56232	T100945
53108163637	NONE	96906	MS35425-14

CROSS REFERENCE INDEX

PARTS WITH NO FSN

OLD PART NUMBER	NEW NSN	FSCM	NEW PART NUMBER
MS35338-82		96906	
T100925-100		56232	
T100925-600		56232	
T100930		56232	
T100930		56232	
T100930-100		56232	
T100930-101		56232	
T100930-102		56232	
T100930-103		56232	
T100930-104		56232	
T100930-105		56232	
T100930-106		56232	
T100930-107		56232	
T100930-108		56232	
T100930-109		56232	
T100930-110		56232	
T100930-111		56232	
T100930-113		56232	
T100930-600		56232	
T100930-900		56232	
T100945-100		56232	
T100945-800		56232	
0132-6		56232	
0469-384		56232	
0469-389		56232	
2518580		56232	
2518581		56232	
2518582		56232	
2518583		56232	
2518584		56232	
2518585		56232	
2518586		56232	
2518577		56232	
2518578		56232	
2518579		56232	
2554365		56232	
2554366		56232	
2554367		56232	
2585881		56232	
2585888		56232	
2585889		56232	
2585889		56232	
2585909		56232	

SECTION III
NUMERICAL INDEX

PART NUMBER	STOCK NUMBER		FIGURE AND INDEX NUMBER	QTY PER ART	SOURCE CODE	PART NUMBER	STOCK NUMBER		FIGURE AND INDEX NUMBER
	CLASS CODE	SERIAL NUMBER					CLASS CODE	SERIAL NUMBER	
AN535-0-2		5305-208-1859	5- 13 6- 7	6		0188-11		5310-271-3223	5- 8 6- 4
						0132-6			/SEE NUT 1/4-20X 11/16
AN535-2-3		5305-175-3230	5- 2	2		0164-11			/SEE MS35338-82/
AN535-6-5		5305-175-3238	3- 2	4					/SEE MS35338-82/
MS35307-7		5305-207-8253	4- 2 3- 4	8		0419-388			/SEE MS35307-7/
MS35338-82			4- 6 4- 7	8		0424-18			/SEE MS35307-7/
MS35425-14		5310-042-6758	3- 5			0466-17			/SEE NUT, HEX 1/4-20/ /SEE NUT, HEX 1/4-20/
NUT, HEX 1/4-20		5310-816-3637	6- 5	2		0466-3			/SEE AN535-6-5/ /SEE AN535-6-5/
NUT 1/4-20X 11/16		5310-275-5512	4- 6 3- 6	8					/SEE AN535-0-2/ /SEE AN535-C-2/
THUMBSCREW 1/4-20			5- 9	2	0466-8				/SEE AN535-2-3/
T100925-100			5- 7	2		0469-384			/SEE THUMBSCREW 1/4-20/
T100925-600			6- 3	2		0469-389			/SEE THUMBSCREW 1/4-20/
T100925			3- 1	1		0470-18			/SEE MS35425-14/
T100925-100		4920-334-4680	/SEE 1406R/			10		5210-293-3739	5- 12
T100930-101			3- 19	3		1406-RS			6- 6
T100930-102			5-10	4		1406R			4- 9
T100930-103			5- 11	4		2518577			3- 7
T100930-104			5- 6	2		2518578			6- 12
T100930-105			5- 1	1		2518579			4- 4
T100930-106			5- 5	4		2518580			4- 3
T100930-107			5- 18	1		2518581			6- 2
T100930-108			5- 16	1		2518582			6- 1
T100930-109			5- 15	1		2518583			6- 8
T100930-110			5- 13	1		2518584			6- 13
T100930-111			5- 14	1		2518585			6- 10
T100930-112			/SEE 210/			2518586			6- 9
T100930-113			5- 3	1		2554365			/SEE 10/
T100930-600			5- 4	1		2554366			6- 7
T100930-900			5- 17	1		2554367			6- 11
T100930			5- 20	1		2585881			4- 1
			3- 3	1		2585888			4-
			5-	REF		2585889			6- 14
T100945-100			7- 2	1		2585909			4- 5
T100945-800			7- 1	1					6-
T100945		4920-349-5972	7-	1					/SEE 1406-RS/

BY ORDER OF THE SECRETARY OF THE ARMY:

G. H. DECKER,
General, United States Army,
Chief of Staff.

Official:

J. C. LAMBERT,
Major General, United States Army,
The Adjutant General.

Distribution:

Active Army:

DASA (3)
CNGB (1)
Tech Stf, DA (1) except
CSigO (14)
Tech Stf Bd (1)
USAARTYBD (1)
USAARMBD (1)
USAIB (1)
USARADB (1)
USAAVNBD (1)
USAATBD (1)
USA Abn, Elct & SPWAR Bd (1)
USCONARC (5)
ARADCOM (2)
ARADCOM Rgn (2)
OS Maj Comd (3)
OS Base Comd (2)
LOGCOMD (2)
Armies (2)
Corps (2)

GENDEP (2) except
Atlanta GENDEP (None)
Sig Sec, GENDEP (5)
Sig Dep (10)
Ft Monmouth (30)
OSA (1)
USAOMC (2)
USA Strat Comm Comd (1)
USA Sig Msl Spt Agcy (4)
Sig Fld Maint Shops (3)
USASSA (15)
USASSAMRO (1)
USASIMSA (10)
USARCARIB Sig Agcy (1)
JBUSMC (2)
USA Corps (1)
Units org under fol TOE:
11-158 (2)
11-587 (2)
11-592 (2)
11-597 (2)

NG: None.

USAR: None.

For explanation of abbreviations used, see AR 320-50.

This fine document...

Was brought to you by me:



[Liberated Manuals -- free army and government manuals](#)

Why do I do it? I am tired of sleazy CD-ROM sellers, who take publicly available information, slap “watermarks” and other junk on it, and sell it. Those masters of search engine manipulation make sure that their sites that sell free information, come up first in search engines. They did not create it... They did not even scan it... Why should they get your money? Why are not letting you give those free manuals to your friends?

I am setting this document FREE. This document was made by the US Government and is NOT protected by Copyright. Feel free to share, republish, sell and so on.

I am not asking you for donations, fees or handouts. If you can, please provide a link to liberatedmanuals.com, so that free manuals come up first in search engines:

<A HREF=<http://www.liberatedmanuals.com/>>Free Military and Government Manuals

- Sincerely
Igor Chudov
<http://igor.chudov.com/>
- [Chicago Machinery Movers](#)