

TECHNICAL MANUAL

ORGANIZATIONAL, DIRECT SUPPORT  
AND GENERAL SUPPORT MAINTENANCE  
REPAIR PARTS AND SPECIAL TOOLS LIST  
(INCLUDING DEPOT MAINTENANCE REPAIR PARTS AND  
SPECIAL TOOLS)

FOR

INTERROGATOR SET PROGRAMMER  
AN/GSX-1 (NSN 5895-01-032-4266)  
AN/GSX-1A (NSN 5895-01-119-1273)



ORGANIZATIONAL, DIRECT SUPPORT, AND GENERAL SUPPORT MAINTENANCE  
REPAIR PARTS AND SPECIAL TOOLS LIST  
(INCLUDING DEPOT MAINTENANCE REPAIR PARTS AND SPECIAL TOOLS)  
FOR

INTERROGATOR SET PROGRAMMER  
AN/GSX-1 (NSN: 5895-01-032-4266)  
AN/GSX-1A (NSN: 5895-01-119-1273)

Current as of 5 March 1985

REPORTING ERRORS AND RECOMMENDING IMPROVEMENTS

You can help improve this manual. If you find any mistakes or if you know of a way to improve the procedures, please let us know. Mail your letter, DA Form 2028 (Recommended Changes to Publications and Blank Forms), or DA Form 2028-2 located in back of this manual direct to: Commander, U.S. Army Communications - Electronics Command and Fort Monmouth, ATTN: AMSEL-ME-MP, Fort Monmouth, NJ 07703-5007. A reply will be furnished direct to you.

TABLE OF CONTENTS

		Page	Illus Figure
Section I	Introduction . . . . .	1	
Section II	Repair Parts List . . . . .	1-1	
Group 00	Interrogator Set Programmer AN/GSX-1, AN/GSX-1A . . . . .	1-1	1
01	Programmer to Interrogator Cable Assembly W1 . . . . .	2-1	2
02	Power Cable Assembly W2 . . . . .	3-1	3
03	Programmer to Computer Cable Assembly W3 . . . . .	4-1	4
04	Battery Charger Circuit Card Assembly AN/GSX-1 A1 . . . . .	5-1	5
05	Battery Charger Circuit Card Assembly AN/GSX-1A A1 . . . . .	6-1	6
06	Time Set Circuit Card Assembly AN/GSX-1 A2 . . . . .	7-1	7
07	Time Set Circuit Card Assembly AN/GSX-1A A2 . . . . .	8-1	8
08	Mode 4 Control Circuit Card Assembly AN/GSX-1 A3 . . . . .	9-1	9
09	Mode 4 Control Circuit Card Assembly AN/GSX-1A A3 . . . . .	10-1	10
10	Mode 4 Address Circuit Card Assembly AN/GSX-1 A4 . . . . .	11-1	11
11	Mode 4 Address Circuit Card Assembly AN/GSX-1A A4 . . . . .	12-1	12
12	Mode 4 Clock Circuit Card Assembly AN/GSX-1 A5 . . . . .	13-1	13
13	Mode 4 Clock Circuit Card Assembly AN/GSX-1A . . . . .	14-1	14

TABLE OF CONTENTS - Continued

		Page	ILLUS Figure
Group 14	IFF Programmer Panel Assembly A6 . . . . .	15-1	15
	1401 Battery Charger Assembly A6A3 . . . . .	16-1	16
	1402 Speaker Assembly A6LS1 . . . . .	17-1	17
	1403 Connector Plate Assembly . . . . .	18-1	18
15	Power Supply Assembly PS1 (No parts authorized)		
Section III	Special Tools List (Not applicable)		
IV	National Stock Number and Part Number Index . . . . .	I-1	

# SECTION I INTRODUCTION

---

## 1. Scope

This manual lists and authorizes spares and repair parts; special tools; special test, measurement, and diagnostic equipment (TMDE), and other special support equipment required for performance of organizational, direct support, and general support maintenance of the AN/GSX-1 and AN/GSX-1A. It authorizes the requisitioning, issue, and disposition of spares, repair parts and special tools as indicated by the source, maintenance and recoverability (SMR) codes.

## 2. General

This Repair Parts and Special Tools List is divided into the following sections:

*a. Section II. Repair Parts List.* A list of spares and repair parts authorized by this RPSTL for use in the performance of maintenance. The list also includes parts which must be removed for replacement of the authorized parts. Parts lists are composed of functional groups in ascending numeric sequence, with the parts in each group listed in ascending item number sequence. Figure numbers are listed directly beneath the group header.

*b. Section III. Special Tools List.* Not applicable.

*c. Section IV. National Stock Number and Part Number Index.* A list, in National item identification number (NIIN) sequence, of all National stock numbered items appearing in the listings, followed by a list in alphameric , sequence of all part numbers appearing in the listings. National stock numbers and part numbers are cross-referenced to each illustration figure and item number appearance.

## 3. Explanation of Columns (Section II and III)

*a. Item No. (Column (1)).* Indicates the number used to identify items called out in the illustration.

*b. SMR Code (Column (2)).* The source, maintenance, and recoverability (SMR) code is a five-position code containing supply/requisitioning information, maintenance category authorization criteria, and disposition instruction, as shown in the following breakout:

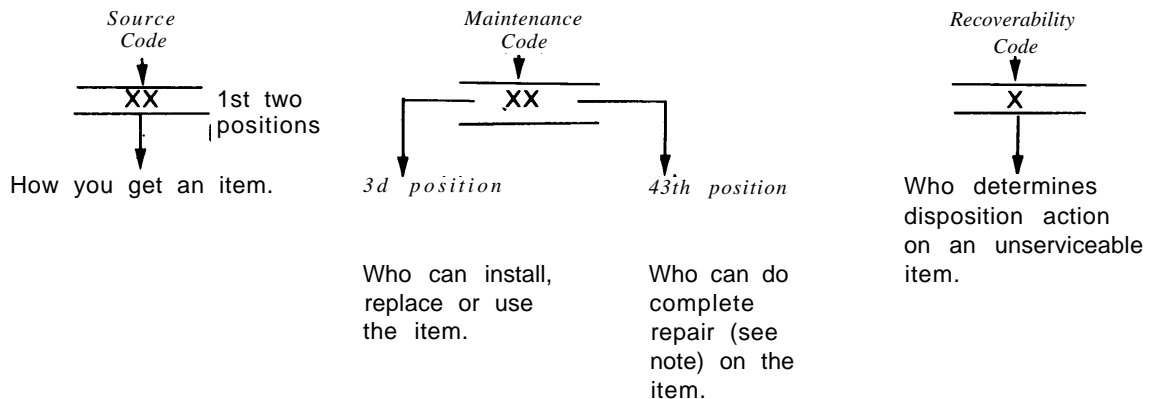

**NOTE**

Complete repair: Maintenance capacity, capability, and authority to perform all corrective maintenance tasks of the "Repair" function in a use/user environment in order to restore serviceability to a failed item.

(1) *Source Code*. The source code tells you how to get an item needed for maintenance, repair, or overhaul of an end item/equipment. Explanations of source codes follows:

<i>Code</i>	<i>Explanation</i>
PA PB PC PD PE PF PG	Stocked items; use the applicable NSN to request/requisition items with these source codes. They are authorized to the category indicated by the code entered in the third position of the SMR code.

**NOTE**

items coded PC are subject to deterioration,

KD KF KB	Items with these codes are not to be requested/requisitioned individually. They are part of a kit which is authorized to the maintenance category indicated in the third position of the SMR code. The complete kit must be requisitioned and applied.
----------------	--

MO — Made at org/ AVUM category MF — Made at DS/ AVUM category MH — Made at GS category ML — Made at Spec- ialized Repair Activity (SRA) MD — Made at Depot	Items with these codes are not to be requested/requisitioned individually. They must be made from bulk material which is identified by the part number in the description and usable on code (UOC) column and listed in the Bulk Material group of the repair parts list. If the item is authorized to you by the third position code of the SMR code, but the source code indicates it is made at a higher category, order the item from the higher category of maintenance.
--	---

AO — Assembled by org/ AVUM category AF — Assembled by DS/ AVIM category AH — Assembled by GS category AL — Assembled by SRA AD — Assembled by Depot	items with these codes are not to be requested/requisitioned individually. The parts that make up the assembled item must be requisitioned or fabricated and assembled at the category of maintenance indicated by the source code. If the disposition code of the SMR code authorizes you to replace the item, but the source code indicates the item is assembled at a higher category, order the item from the higher category of maintenance.
---	---

- XA — Do not requisition an "XA" coded item. Order its next higher assembly.
- XB — if an "XB" item is not available from salvage, order it using the FSCM and part number given.
- XC — installation drawing, diagram, instruction sheet, field service drawing, that is identified by manufacturers part number.
- XD — item is not stocked. Order an "XD" coded item through normal supply channels using the FSCM and part number given, if no NSN is available.

## NOTE

Cannibalization or controlled exchange, when authorized, may be used as a source of supply for items with the above source codes, except for those source coded "XA" or those aircraft support items restricted by requirements of AR 750-1,

(2) *Maintenance Code*, Maintenance codes tell you the category of maintenance authorized to USE and REPAIR support items. The maintenance codes are entered in the third and fourth positions of the SMR code as follows:

(a) The maintenance code entered in the third position tells you the lowest maintenance category authorized to remove, replace, and use an item. The maintenance code entered in the third position will indicate authorization to one of the following categories of maintenance.

<i>Code</i>	<i>Application/Explanation</i>
<b>C</b>	— Crew or operator maintenance done within organizational or aviation maintenance.
<b>O</b>	— Organizational or aviation unit category can remove, replace, and use the item.
<b>F</b>	— Direct support or aviation intermediate category can remove, replace, and use the item.
<b>H</b>	— General support category can remove, replace, and use the item.
<b>L</b>	— Specialized repair activity can remove, replace, and use the item.
<b>D</b>	— Depot category can remove, replace, and use the item.

(b) The maintenance code entered in the fourth position tells whether or not the item is to be repaired and identifies the lowest maintenance category with the capability to do complete repair (i.e., perform all authorized repair functions). This position will contain one of the following maintenance codes:

## NOTE

Some limited repair may be done on the item at a lower category of maintenance, if authorized by the Maintenance Allocation Chart (MAC) and SMR codes.

<i>Code</i>	<i>Application/Explanation</i>
<b>O</b>	— Organizational or aviation unit is the lowest category that can do complete repair of the item.
<b>F</b>	— Direct support or aviation intermediate is the lowest category that can do complete repair of the item.
<b>H</b>	— General support is the lowest category that can do complete repair of the item.
<b>L</b>	— Specialized repair activity (designate the specialized repair activity) is the lowest category that can do complete repair of the item.
<b>D</b>	— Depot is the lowest category that can do complete repair of the item.
<b>Z</b>	— Nonreparable. No repair is authorized.
<b>B</b>	— No repair is authorized. (No parts or special tools are authorized for the maintenance of a "B" coded item.) However, the item may be reconditioned by adjusting, lubricating, etc., at the user category.

(3) *Recoverability Code*. Recoverability codes are assigned to items to action on unserviceable items. The recoverability code is entered in the fifth position of the SMR Code as follows.

<i>Recoverability codes</i>	<i>Application/Explanation</i>
<b>Z</b>	Nonreparable item. When unserviceable, condemn and dispose of the item at the category of maintenance shown in the third position of SMR Code.
<b>O</b>	Reparable item. When uneconomically reparable, condemn and dispose of the item at organizational or aviation unit category.
<b>F</b>	Reparable item. When uneconomically reparable, condemn and dispose of the item at the direct support or aviation intermediate category.
<b>H</b>	Reparable item. When uneconomically reparable, condemn and dispose of the item at general support category.
<b>D</b>	Reparable item. When beyond lower level repair capability, return to depot. Condemnation and disposal of item not authorized below depot category.
<b>L</b>	Reparable item. Condemnation and disposal not authorized below specialized repair activity (SRA).
<b>A</b>	Item requires special handling or condemnation procedures because of specific reasons (e.g., precious metal content, high dollar value, critical material, or hazardous material). Refer to appropriate manuals/directives for specific instructions.

c. *FSCM (Column (3))*. The Federal Supply Code for Manufacturer (FSCM) is a 5-digit numeric code which is used to identify the manufacturer, distributor, or Government agency, etc., that supplies the item.

d. *Part Number (Column (4))*. Indicates the primary number used by the manufacturer (individual, company, firm, corporation, or Government activity), which controls the design and characteristics of the item by means of its engineering drawings, specifications, standards, and inspection requirements to identify an item or range of items.

**NOTE**

When you use a NSN to requisition an item, the item you receive may have a different part number from the part ordered.

e. *Description and Usable on Code (UOC)(Column (5))*. This column includes the following information.

(1) The Federal item name and, when required, a minimum description to identify the item.

(2) Usable on code, when applicable (para 5).

(3) The statement "END OF FIGURE" appears just below the last item description in Column (5) for a given figure in both section II and section III.

f. *Qty (Column (6))*. Indicates the quantity of the item used in the breakout shown on the illustration figure, which is prepared for a functional group, subfunctional group, or an assembly. A "V" appearing in this column in lieu of a quantity indicates that the quantity is variable and the quantity may vary from application to application.



#### 4. Explanation of Columns (Section IV)

##### *a. National Stock Number (NSN) Index.*

(1) *Stock number column.* This column lists the NSN by National item identification number (NIIN) sequence. The NIIN consists of the last nine digits of the NSN. When using this column to locate an item, ignore the first four digits of the NSN. When requisitioning items use the complete NSN (13 digits).

(2) *Fig. column.* This column lists the number of the figure where the item is identified/located. The illustrations are in numerical sequence in sections II and III.

(3) *Item column.* The item number identifies the item associated with the figure listed in the adjacent Fig. column. This item is also identified by the NSN listed on the same line.

*b. Part Number Index.* Part numbers in this index are listed by part number in ascending alphameric sequence.

(1) *FSCM column.* This column lists the Federal supply code for manufacturer (FSCM).

(2) *Part number column.* This column indicates the part number assigned to the item.

(3) *Stock number column.* This column lists the National stock number for the associated part number and manufacturer identified in the part number and FSCM columns to the left.

(4) *Fig. column.* This column lists the number of the figure where the item is identified/located in sections II and III.

(5) *Item column.* The item number is that number assigned to the item as it appears in the figure referenced in the adjacent figure number column.

#### 5. Special Information

*a. Usable on Code.* The usable on code appears in the lower left corner of the description column heading. Usable on codes are shown as "UOC: "in the description column (justified left) on the first line applicable item description nomenclature. Uncoded items are applicable to all models. Identification of the usable on codes used in this RPSTL are:

<i>Code</i>	<i>Used on</i>
ELV	AN/GSX-1
EZC	AN/GSX-1A

*b. Associated Publications.* The publications listed below pertain to the AN/GSX-1 and AN/GSX-1A and their components:

TM 9-1425-429-12, Intercept-Aerial Guided Missile System

TM 9-1425-429-24P, Intercept-Aerial Guided Missile System

TM 11-5895-1194-24, Interrogator Kit AN/PPX-3A and AN/PPX-3B; Interrogator Set Programmer AN/GSX-1 and AN/GSX-1A

*c. National Stock Numbers.* National stock numbers (NSN's) that are missing from P source coded items have been applied for and will be added to this TM by future change/revision when they are entered in the Army Master Data File (AMDF). Until the NSN's are established and published, submit exception requisitions to: Commander, US Army Communications-Electronics Command and Fort Monmouth, ATTN: AMSEL-MM, Fort Monmouth, NJ 07703-5006 for the part required to support your equipment.

## 6. How to Locate Repair Parts

*a. When National stock number or part number is not known.*

(1) *First.* Using the table of contents, determine the assembly group or subassembly group to which the item belongs. This is necessary since figures are prepared for assembly groups and subassembly, and listings are divided into the same groups.

(2) *Second,* Find the figure covering the assembly group or subassembly group to which the item belong.

(3) *Third.* Identify the item on the figure and not the item number.

(4) *Fourth.* Refer to the Repair Parts List for the figure to find the part number for the item number noted on the figure.

(5) *Fifth.* Refer to the Part Number Index to find the NSN, if assigned.

*b. When National stock number or part number is known.*

(1) *First.* Using the Index of National stock numbers and part numbers, find the pertinent National stock number or part number. The NSN index is in National item identification number (NIIN) sequence (para 4a(1)). The part numbers in the part number index are listed in ascending alphameric sequence (para 4b). Both indexes cross-reference you to the illustration figure and item number of the item you are looking for.

(2) *Second.* After finding the figure and item number, verify that the item is the one you're looking for, then locate the item number in the repair parts list for the figure.

## 7. Abbreviations

Not applicable.



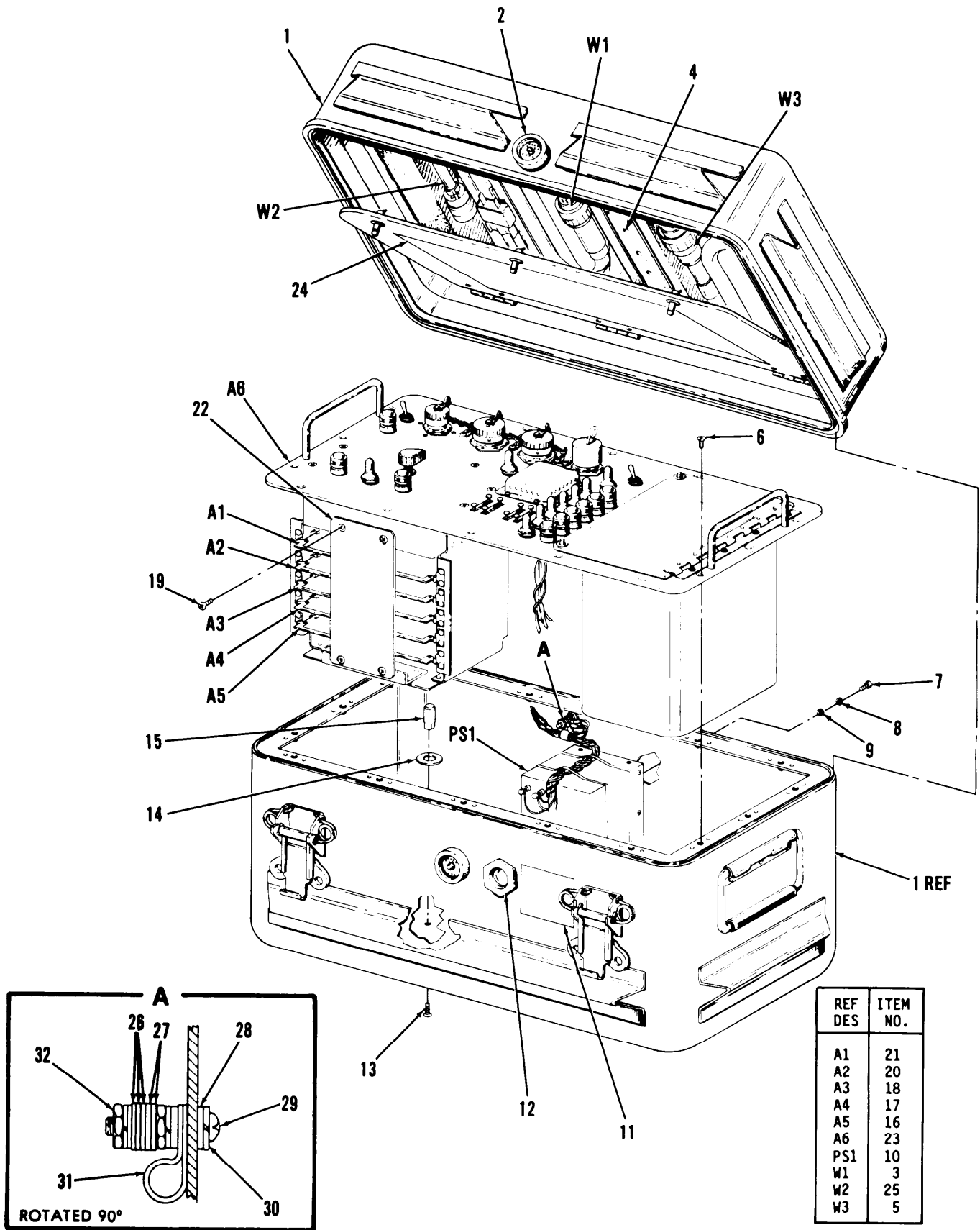

REF DES	ITEM NO.
A1	21
A2	20
A3	18
A4	17
A5	16
A6	23
PS1	10
W1	3
W2	25
W3	5

EL9SP001

Figure 1. Interrogator Set Programmer AN/GSX-1, AN/GSX-1A

SECTION II (1) ITEM NO	(2) SMR CODE	(3) FSCM	TM11-5895-1194-24P-2 (4) PART NUMBER	(5) DESCRIPTION AND USABLE ON CODE (UOC)	(6) QTY
GROUP 00 INTERROGATOR SET PROGRAMMER AN/GSX-1, AN/GSX-1A					
FIG, 1					
1	XBHZZ	98376	D40825	CASE, PRGMR EQPT	1
2	PAHZZ	98376	ZSP6-037-4	VALVE, VACUUM BREAKI	2
3	PAODD	45413	154252	PRGMR-INTRG CABLE W1 (SCD 11509859)	1
4	PAOZZ	96906	MS25237-328	LAMP, INCANDESCENT	7
5	PAODD	45413	154251	PRGMR-CMPTR CABLE W3 (SCD 11509860)	1
6	PAHZZ	96906	MS51960-66	SCREW, MACHINE	16
7	PAHZZ	96906	MS51957-44	SCREW, MACHINE	6
8	PAHZZ	96906	MS35338-137	WASHER, LOCK	6
9	PAHZZ	96906	MS15795-807	WASHER, FLAT	6
10	PAHDD	04879	PHX-291	POWER SUPPLY ASSY PS1	1
11	XBHZZ	18876	11567494	PLATE, IDENT	1
11	XBHZZ	18876	13149901	UOC:ELV PLATE, IDENT	1
12	PAHZZ	18876	MIS-23638	UOC:EZC INDICATOR, HUMIDITY,	1
13	PAHZZ	96906	MS24693-C272	SCREW, MACHINE	1
14	PAHZZ	96906	MS15795-808	WASHER, FLAT	1
15	PAHZZ	18876	11567515	UOC:ELV PIN, GUIDE	1
16	PAHLL	18876	11509874	M 4 CLK CCA GSX-1 A5	1
16	PAHLL	18876	13143988	UOC:ELV M 4 CLK CCA GSX-1A A5	1
17	PAHLL	18876	11509871	UOC:EZC M 4 ADRS CCA GSX-1 A4	1
17	PAHLL	18876	13143985	UOC:ELV M 4 ADRS CCA GSX-1A A4	1
18	PAHLL	18876	11509868	UOC:EZC M 4 CONT CCA GSX-1 A3	1
18	PAHLL	18876	13143982	UOC:ELV M 4 CONT CCA GSX-1A A3	1
19	PAHZZ	96906	MS51959-46	UOC:EZC SCREW, MACHINE	4
20	PAHLL	18876	11509865	TIME SET CCA GSX-1 A2	1
20	PAHLL	18876	13143979	UOC:ELV TIME SET CCA GSX-1A A2	1
21	PAHLL	18876	11509862	UOC:EZC BAT CHG CCA GSX-1 A1	1
21	PAHLL	18876	13143976	UOC:ELV BAT CHG CCA GSX-1A A1	1
22	XBHZZ	18876	11567516	UOC:EZC PLATE, COVER	1
23	XBHLL	18876	13143992	PANEL ASSY GSX-1A A6	1
24	XBHZZ	18876	11567546	UOC:EZC DECAL, INSTRUCTIONS	1
25	PAODD	18876	11509861	CABLE ASSEMBLY, POWE W2	1
26	PAHZZ	96906	MS25036-102	TERMINAL, LUG	3
27	PAHZZ	96906	MS25036-102	TERMINAL, LUG	2

SECTION II					
(1)	(2)	(3)	TM11-5895-1194-24P-2		(6)
ITEM	SMR		(4)	(5)	
NO	CODE	FSCM	PART	DESCRIPTION AND USABLE ON CODE (UOC)	QTY
			NUMBER		
28	PAHZZ	96906	MS15795-805	UOC:ELV WASHER, FLAT	3
29	PAHZZ	96906	MS51957-32	SCREW, MACHINE	1
29	PAHZZ	96906	MS51957-34	UOC:ELV SCREW, MACHINE	1
30	PAHZZ	96906	MS35338-136	UOC:EZC WASHER, LOCK	3
31	PAHZZ	15786	81487-4	CLAMP, LOOP	1
31	PAHZZ	80205	NAS1397P6N	UOC:ELV CLAMP, LOOP	1
32	PAHZZ	96906	MS35649-264	UOC:EZC NUT, PLAIN, HEXAGON	2
END OF FIGURE					



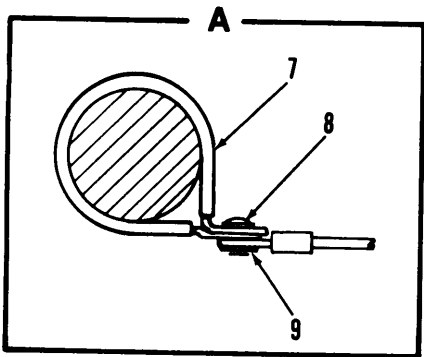
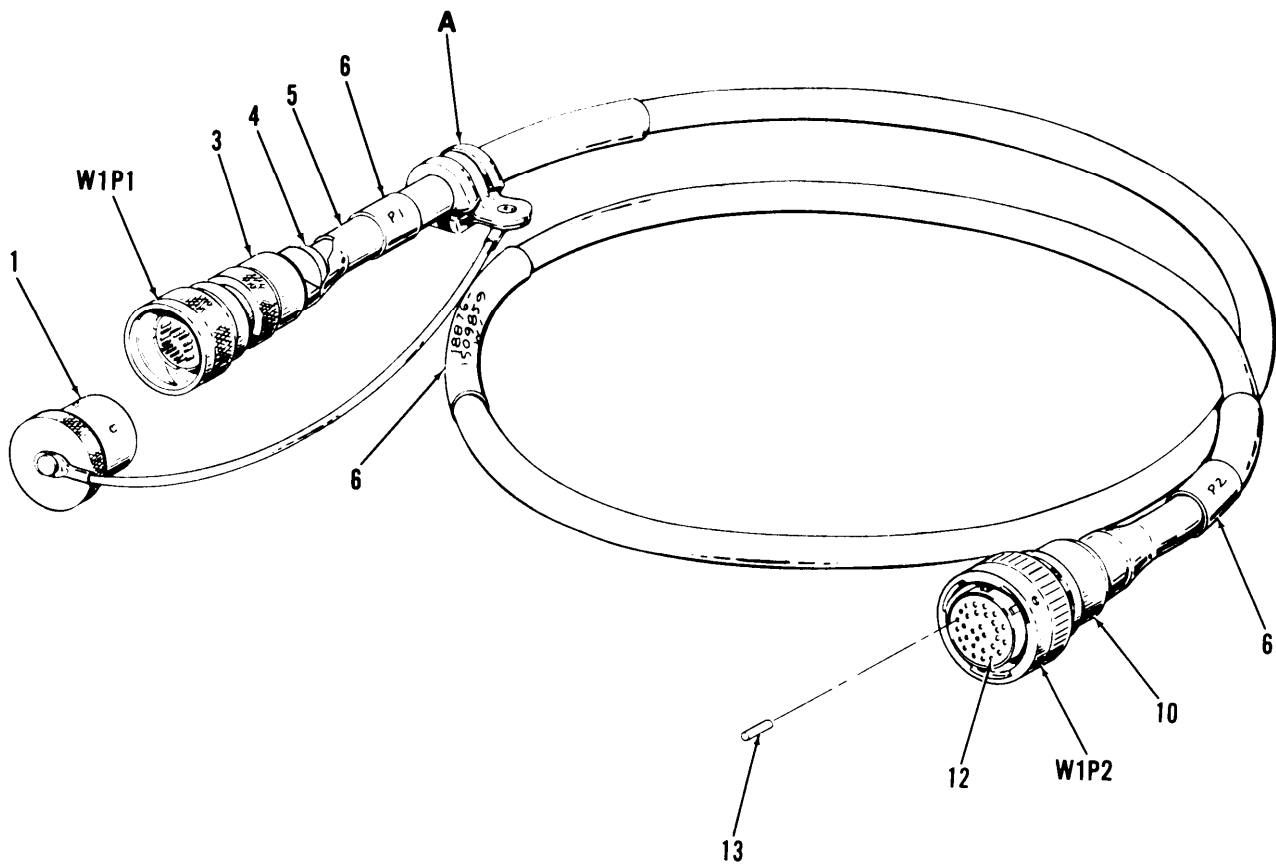

REF DES	ITEM NO.
W1P1	2
W1P2	11

EL9SP002

Figure 2. Programmer to Interrogator Cable Assembly W1



SECTION II		TM11-5895-1194-24P-2			
(1)	(2)	(3)	(4)	(5)	(6)
ITEM NO	SMR CODE	FSCM	PART NUMBER	DESCRIPTION AND USABLE ON CODE (UOC)	QTY
GROUP 01 PROGRAMMER TO INTERROGATOR CABLE ASSEMBLY W1					
FIG, 2					
1	PADZZ	98278	086-0345-00DI	COVER, PROTECTIVE	1
2	PADZZ	18876	MIS-23641	CONNECTOR	1
3	PADZZ	06324	G63114	BACKSHELL, CONN	1
4	PADZZ	96906	MS3161-12	RING, SHIELD, BACKSHE	2
5	PADZZ	96906	MS3109-02AC	INSULATION SLEEVING	2
6	PADZZ	81349	M23053/5-109-4	INSULATION SLEEVING	V
7	PADZZ	96906	MS21104-D8	CLAMP, LOOP	1
8	PADZZ	81349	M24243/6-C402H	RIVET	1
9	PADZZ	96906	MS27183-3	WASHER, FLAT	1
10	PADZZ	06324	G63120	BACKSHELL, CONN	1
11	PADZZ	96906	MS3126E18-32SW	CONNECTOR, PLUG, ELEC	1
12	PADZZ	96906	MS3193-20-20A	CONTACT, ELECTRICAL	24
13	PADZZ	96906	MS27488-20	PLUG, END SEAL, ELECT	8

END OF FIGURE

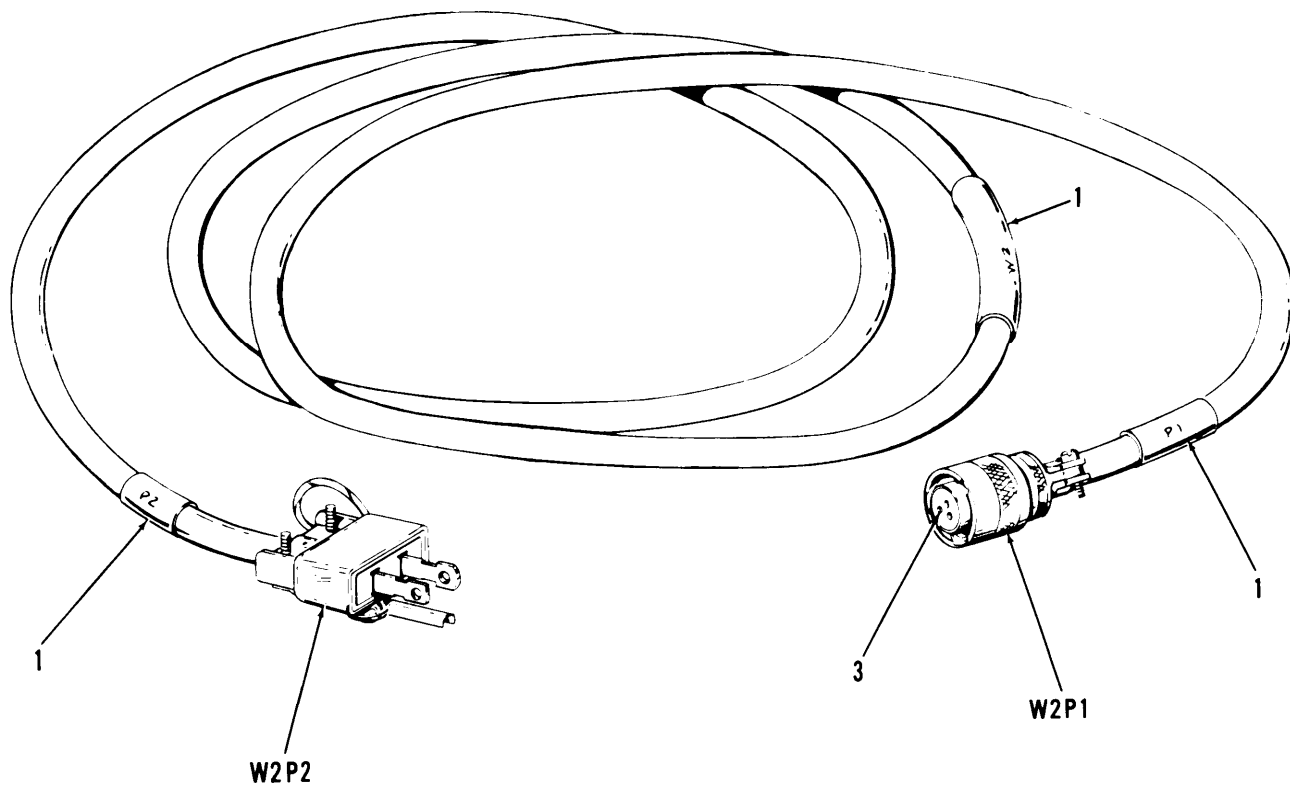

REF DES	ITEM NO.
W2P1	2
W2P2	4

EL9SP003

Figure 3. Power Cable Assembly W2

SECTION II		TM11-5895-1194-24P-2			
(1)	(2)	(3)	(4)	(5)	(6)
ITEM NO	SMR CODE	FSCM	PART NUMBER	DESCRIPTION AND USABLE ON CODE (UOC)	QTY
GROUP 02 POWER CABLE ASSEMBLY W2					
FIG, 3					
1	PADZZ	81349	M23053/5-108-4	INSULATION SLEEVING	V
2	PADZZ	96906	MS3126F12-3SN	CONNECTOR, PLUG, ELEC	1
3	PADZZ	96906	MS3193-16-16A	CONTACT, ELECTRICAL	3
4	PADZZ	81348	W-C-596/13-3	CONNECTOR, PLUG, ELEC	1
END OF FIGURE					

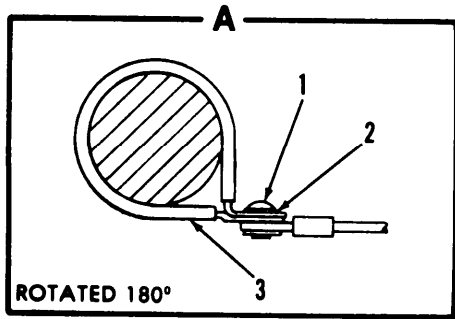
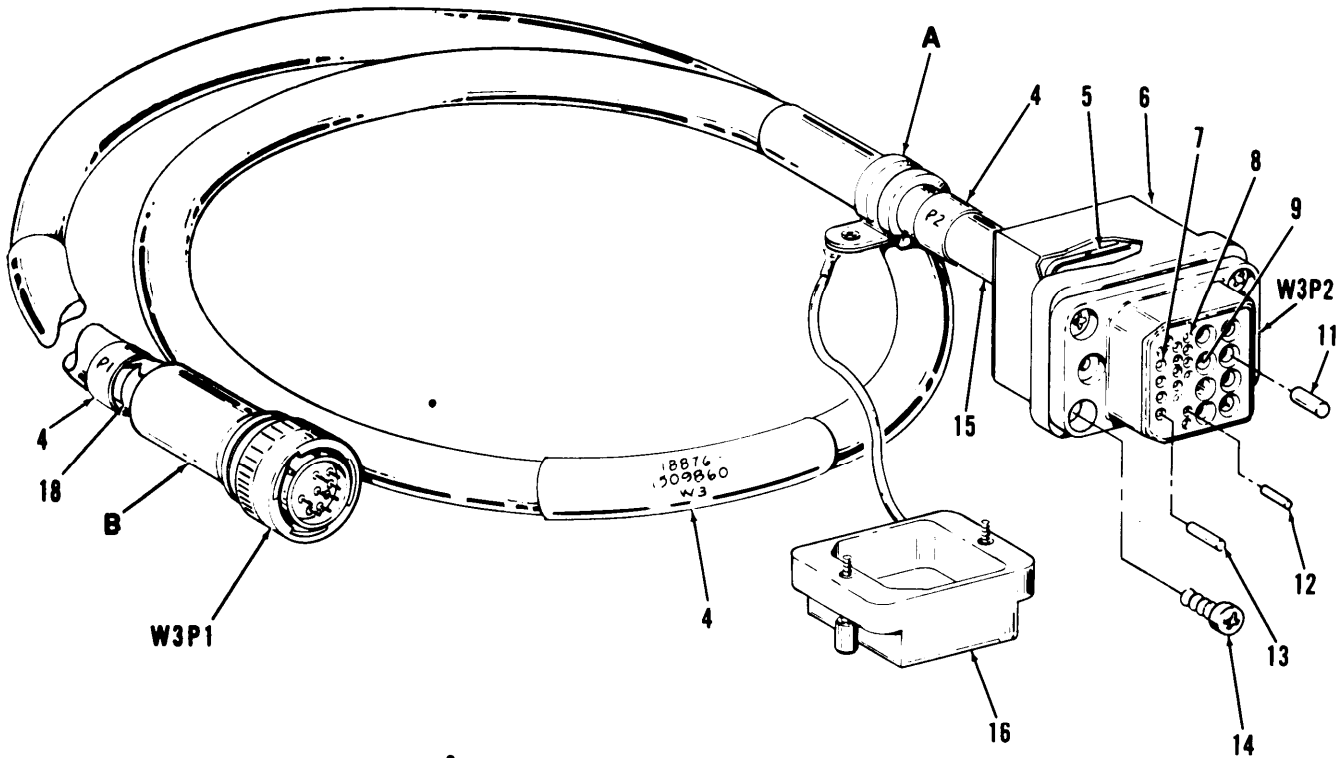

REF DES	ITEM NO.
W3P1	17
W3P2	10

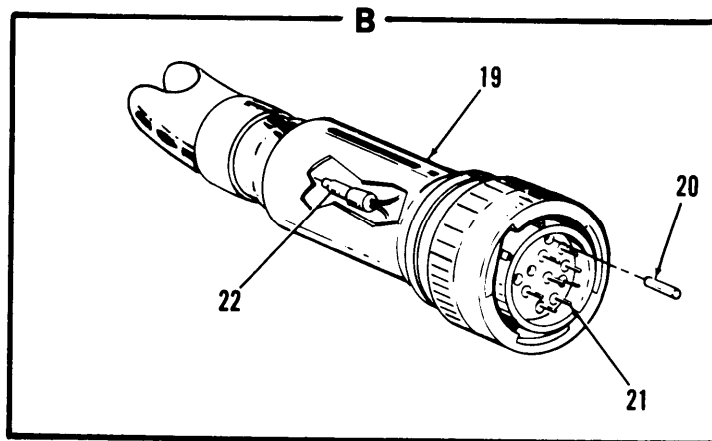

EL9SP004

Figure 4. Programmer to Computer Cable Assembly W3

SECTION II		TM11-5895-1194-24P-2			
(1)	(2)	(3)	(4)	(5)	(6)
ITEM NO	SMR CODE	FSCM	PART NUMBER	DESCRIPTION AND USABLE ON CODE (UOC)	QTY
GROUP 03 PROGRAMMER TO COMPUTER ASSEMBLY W3					
FIG, 4					
1	PADZZ	81349	M24243/6-C402H	RIVET	1
2	PADZZ	96906	MS27183-3	WASHER, FLAT	1
3	PADZZ	96906	MS21104-D10	CLAMP, LOOP	1
4	PADZZ	81349	M23053/5-109-4	INSULATION SLEEVING	V
5	PADZZ	45413	154324	GASKET, PREFORMED	1
6	PADZZ	45413	154279	CONNECTOR, BACKSHELL	1
7	PADZZ	81349	M39029-5-16-16	CONTACT, ELECTRICAL	1
8	PADZZ	81349	M39029/5-115	CONTACT, ELECTRICAL	13
9	PADZZ	98230	0N089558-2	CONTACT ASSEMBLY, EL	4
10	PADZZ	45413	154273	CONNECTOR, PLUG, ELEC	1
11	PADZZ	98230	0N089563	PLUG, END SEAL	4
12	PADZZ	96906	MS27488-20	PLUG, END SEAL, ELECT	12
13	PADZZ	96906	MS27488-16	PLUG, END SEAL, ELECT	3
14	PADZZ	96906	MS51957-44	SCREW, MACHINE	4
15	PADZZ	96906	MS3109-02AC	INSULATION SLEEVING	2
16	PADZZ	31461	900-414	COVER, PROTECTIVE	1
17	PADZZ	96906	MS3126E18-32PN	CONNECTOR	1
18	PADZZ	96906	MS3161-14	RING, CRIMP	2
19	PADZZ	06324	G63113	BACKSHELL, CONN	1
20	PADZZ	96906	MS27488-20	PLUG, END SEAL, ELECT	14
21	PADZZ	81349	M39029/31-223	CONTACT, ELECTRICAL	18
22	PADZZ	06090	D-133-06	SPLICE, CONDUCTOR	4

END OF FIGURE

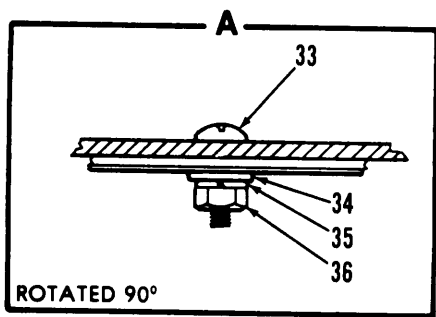
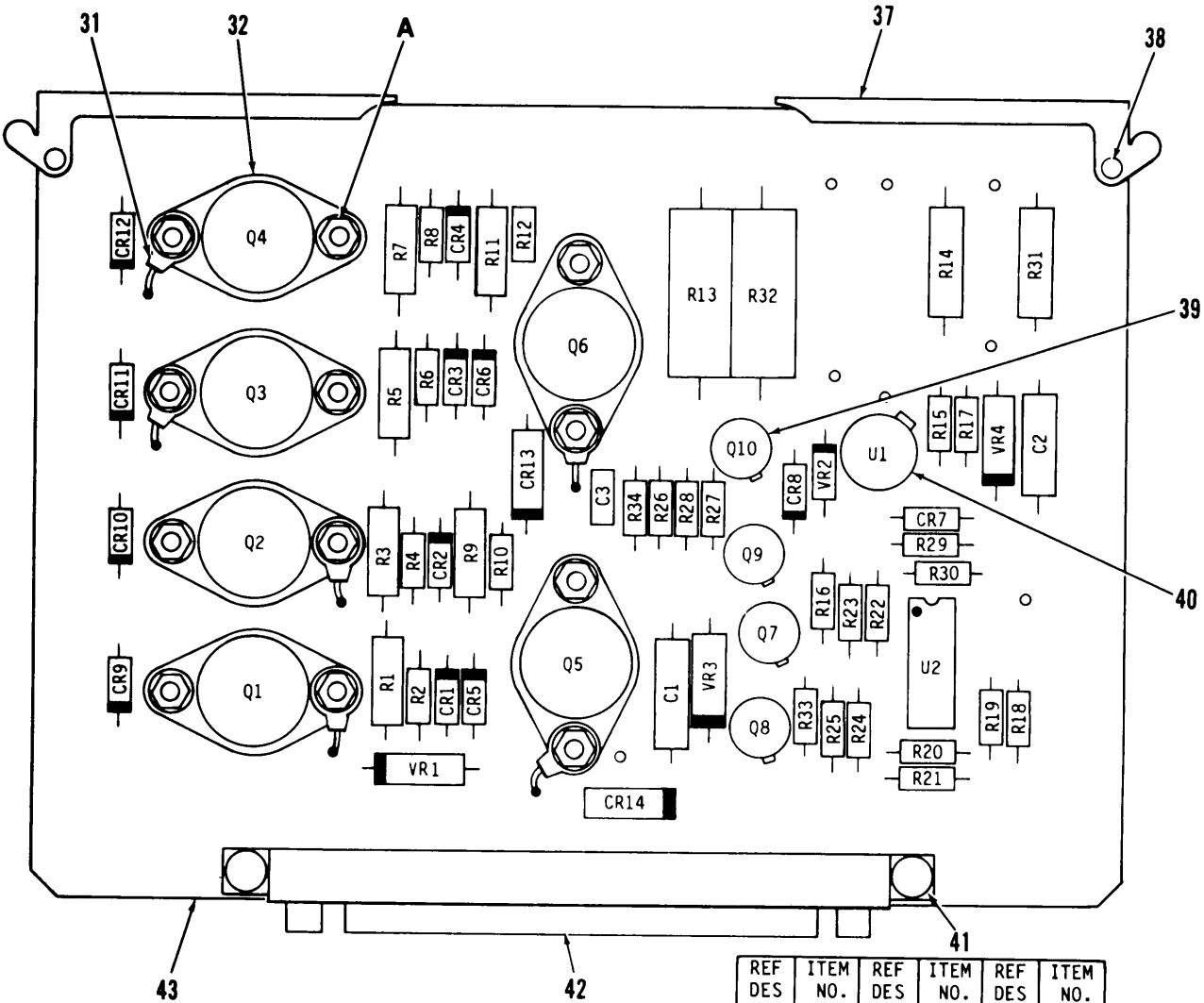

REF DES	ITEM NO.	REF DES	ITEM NO.	REF DES	ITEM NO.
CR1	1	Q8	7	R22	17
CR2	1	Q9	8	R23	19
CR3	1	Q10	7	R24	17
CR4	1	R1	9	R25	19
CR5	1	R2	10	R26	20
CR6	1	R3	9	R27	16
CR7	2	R4	10	R28	17
CR8	1	R5	9	R29	21
CR9	1	R6	10	R30	22
CR10	1	R7	9	R31	23
CR11	1	R8	10	R32	11
CR12	1	R9	9	R33	14
CR13	1	R10	10	R34	24
CR14	1	R11	9	U1	25
C1	3	R12	10	U2	26
C2	4	R13	11	VR1	27
C3	5	R14	12	VR2	28
Q1	6	R15	13	VR3	29
Q2	6	R16	14	VR4	30
Q3	6	R17	15		
Q4	6	R18	16		
Q5	6	R19	17		
Q6	6	R20	18		
Q7	7	R21	17		

EL9SP005

Figure 5. Battery Charger Circuit Card Assembly AN/GSX-1 A1

SECTION II (1) ITEM NO	(2) SMR CODE	(3) FSCM	TM11-5895-1194-24P-2 (4) PART NUMBER	(5) DESCRIPTION AND USABLE ON CODE (UOC)	(6) QTY
GROUP 04 BATTERY CHARGER CIRCUIT CARD ASSEMBLY AN/GSX-1 A1					
FIG, 5					
1	PAHZZ	81349	JANTX1N3611	SEMICONDUCTOR DEVIC UOC:ELV	13
2	PAHZZ	81349	JANTX1N4148	SEMICONDUCTOR DEVIC UOC:ELV	1
3	PAHZZ	81349	M39003-01-3024	CAPACITOR, FIXED, ELE UOC:ELV	1
4	PAHZZ	81349	M39003-01-2991	CAPACITOR, FIXED, ELE UOC:ELV	1
5	PAHZZ	81349	M39014-01-1581	CAPACITOR, FIXED, CER UOC:ELV	1
6	PAHZZ	81349	JANTX2N3741	TRANSISTOR UOC:ELV	6
7	PAHZZ	81349	JANTX2N2907A	TRANSISTOR UOC:ELV	3
8	PAHZZ	81349	JANTX2N2222A	TRANSISTOR UOC:ELV	1
9	PAHZZ	81349	RCR20G160JS	RESISTOR, FIXED, COMP UOC:ELV	6
10	PAHZZ	81349	RCR07G392JS	RESISTOR, FIXED, COMP UOC:ELV	6
11	PAHZZ	81349	RWR74S22R6FP	RESISTOR UOC:ELV	2
12	PAHZZ	81349	RWR89S3R74FP	RESISTOR UOC:ELV	1
13	PAHZZ	81349	RLR07C2321GP	RESISTOR UOC:ELV	1
14	PAHZZ	81349	RCR07G4R7JS	RESISTOR, FIXED, COMP UOC:ELV	2
15	PAHZZ	81349	RLR07C5761GP	RESISTOR UOC:ELV	1
16	PAHZZ	81349	RCR05G222JS	RESISTOR, FIXED, COMP UOC:ELV	2
17	PAHZZ	81349	RCR05G331JS	RESISTOR, FIXED, COMP UOC:ELV	5
18	PAHZZ	81349	RCR05G821JS	RESISTOR, FIXED, COMP UOC:ELV	1
19	PAHZZ	81349	RCR05G472JS	RESISTOR, FIXED, COMP UOC:ELV	2
20	PAHZZ	81349	RCR05G223JS	RESISTOR, FIXED, COMP UOC:ELV	1
21	PAHZZ	81349	RCR05G272JS	RESISTOR, FIXED, COMP UOC:ELV	1
22	PAHZZ	81349	RCR05G562JS	RESISTOR, FIXED, COMP UOC:ELV	1
23	PAHZZ	81349	RWR89S1000FR	RESISTOR, FIXED, WIRE UOC:ELV	1
24	PAHZZ	81349	RCR05G10R0JS	RESISTOR	1

SECTION II		TM11-5895-1194-24P-2			
(1)	(2)	(3)	(4)	(5)	(6)
ITEM	SMR		PART		
NO	CODE	FSCM	NUMBER	DESCRIPTION AND USABLE ON CODE (UOC)	QTY
25	PAHZZ	81349	M38510/10301BGB	UOC:ELV MICROCIRCUIT, LINEAR	1
26	PAHZZ	81349	M38510/00103BCB	UOC:ELV MICROCIRCUIT, DIGITA	1
27	PAHZZ	18876	MIS-21440-001	UOC:ELV DIODE	1
28	PAHZZ	81349	JANTX1N753A	UOC:ELV SEMICONDUCTOR DEVIC	1
29	PAHZZ	81349	JANTX1N5637A	UOC:ELV SEMICONDUCTOR DEVIC	1
30	PAHZZ	81349	JANTX1N5907	UOC:ELV SEMICONDUCTOR DEVIC	1
31	PAHZZ	18876	10101367-3	UOC:ELV TERMINAL, LUG	6
32	PAHZZ	08289	BBT066-62	UOC:ELV INSULATOR	6
33	PAHZZ	96906	MS35206-230	UOC:ELV SCREW, MACHINE	12
34	PAHZZ	96906	MS27183-5	UOC:ELV WASHER, FLAT	12
35	PAHZZ	96906	MS35338-41	UOC:ELV WASHER, LOCK	12
36	PAHZZ	80205	NAS671-6	UOC:ELV NUT, PLAIN, HEXAGON	12
37	PAHZZ	94222	90-0-6503-11	UOC:ELV HANDLE, DOOR	2
38	PAHZZ	94222	90-0-5858-24	UOC:ELV RIVET, SOLID	2
39	PAHZZ	81349	M38510/10301BGB	UOC:ELV MICROCIRCUIT, LINEAR	1
40	PAHZZ	10001	2859485A-6	UOC:ELV INSULATOR, CUP	1
41	PAHZZ	96906	MS16535-141	UOC:ELV RIVET, TUBULAR	2
42	PAHZZ	18876	MIS-21424/10-001	UOC:ELV CONNECTOR	1
43	XAHZZ	18876	13056574	UOC:ELV BOARD, PW	1

END OF FIGURE





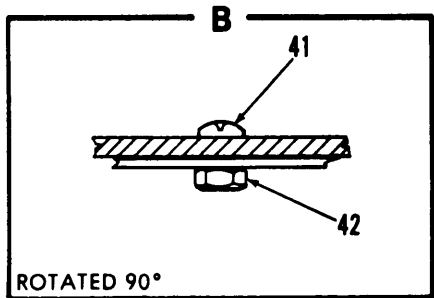
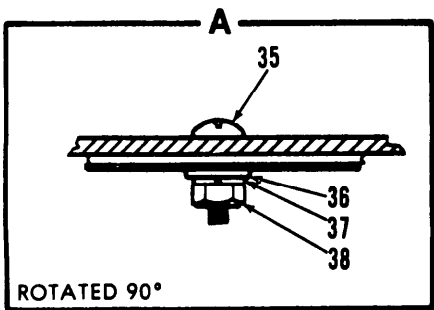
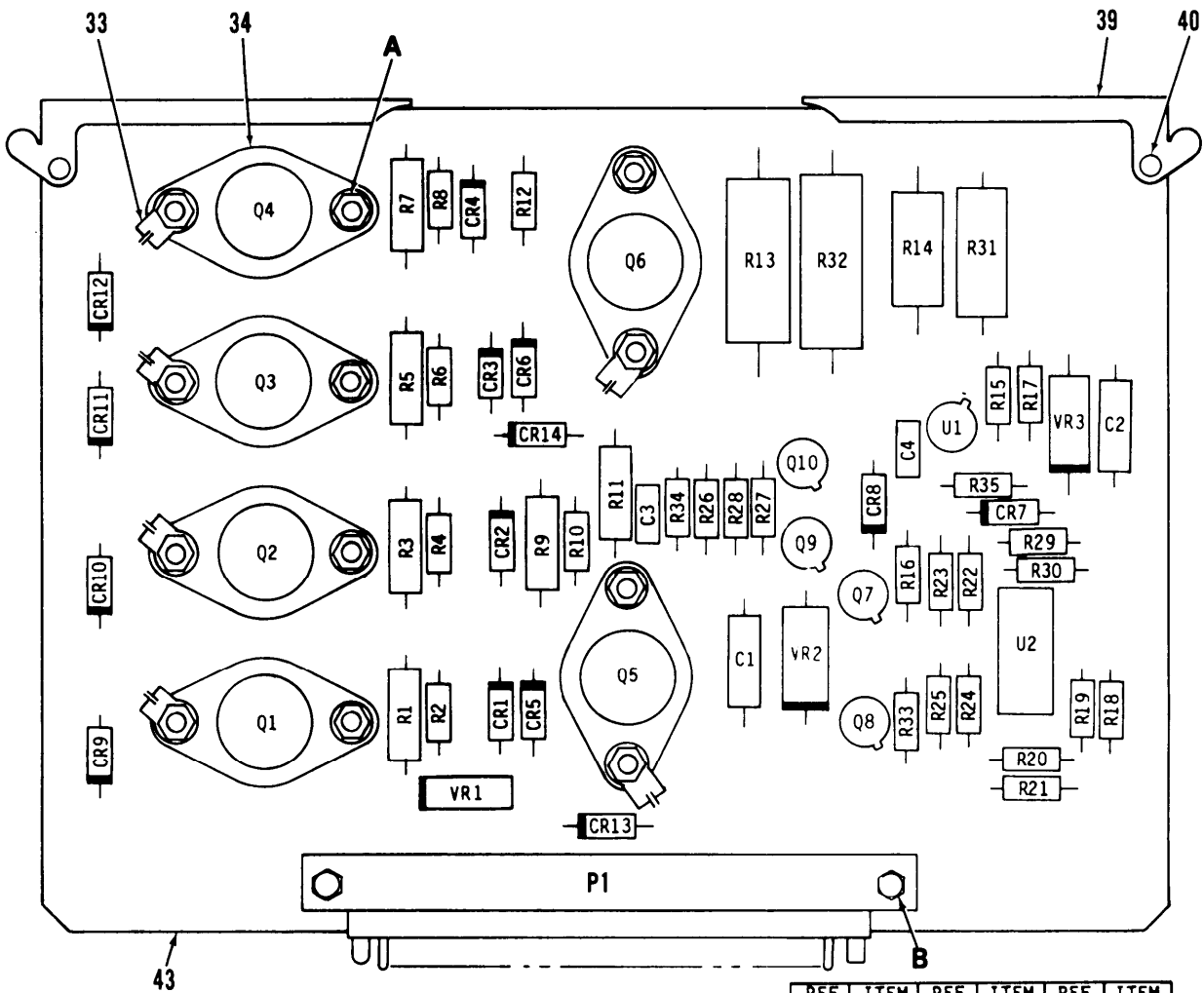

REF DES	ITEM NO.	REF DES	ITEM NO.	REF DES	ITEM NO.
CR1	1	Q6	8	R20	20
CR2	1	Q7	9	R21	19
CR3	1	Q8	9	R22	19
CR4	1	Q9	10	R23	21
CR5	1	Q10	9	R24	19
CR6	1	R1	11	R25	21
CR7	2	R2	12	R26	22
CR8	1	R3	11	R27	18
CR9	1	R4	12	R28	19
CR10	1	R5	11	R29	23
CR11	1	R6	12	R30	24
CR12	1	R7	11	R31	25
CR13	1	R8	12	R32	13
CR14	1	R9	11	R33	16
C1	3	R10	12	R34	26
C2	4	R11	11	R35	27
C3	5	R12	12	U1	28
C4	6	R13	13	U2	29
P1	7	R14	14	VR1	30
Q1	8	R15	15	VR2	31
Q2	8	R16	16	VR3	32
Q3	8	R17	17		
Q4	8	R18	18		
Q5	8	R19	19		

EL9SP006

Figure 6. Battery Charger Circuit Card Assembly AN/GSX-1A A1

SECTION II (1) ITEM NO	(2) SMR CODE	(3) FSCM	TM11-5895-1194-24P-2 (4) PART NUMBER	(5) DESCRIPTION AND USABLE ON CODE (UOC)	(6) QTY
GROUP 05 BATTERY CHARGER CIRCUIT CARD ASSEMBLY AN/GSX-1A A1					
FIG. 6					
1	PAHZZ	81349	JANTX1N3611	SEMICONDUCTOR DEVIC UOC: EZC	13
2	PAHZZ	81349	JANTX1N4148-1	SEMICONDUCTOR DEVIC UOC: EZC	1
3	PAHZZ	81349	M39003-01-3024	CAPACITOR, FIXED, ELE UOC: EZC	1
4	PAHZZ	81349	M39003-01-2991	CAPACITOR, FIXED, ELE UOC: EZC	1
5	PAHZZ	81349	M39014-01-1581	CAPACITOR, FIXED, CER UOC: EZC	1
6	PAHZZ	81349	M39014/01-1575	CAPACITOR, FIXED, CER UOC: EZC	1
7	PAHZZ	81349	M55302/57A50Y(33 )	CONNECTOR UOC: EZC	1
8	PAHZZ	81349	JANTX2N3741	TRANSISTOR UOC: EZC	6
9	PAHZZ	81349	JANTX2N2907A	TRANSISTOR UOC: EZC	3
10	PAHZZ	81349	JANTX2N2222A	TRANSISTOR UOC: EZC	1
11	PAHZZ	81349	RCR20G160JS	RESISTOR, FIXED, COMP UOC: EZC	6
12	PAHZZ	81349	RCR07G392JS	RESISTOR, FIXED, COMP UOC: EZC	6
13	PAHZZ	81349	RWR74S22R6FP	RESISTOR UOC: EZC	2
14	PAHZZ	81349	RWR89S3R74FP	RESISTOR UOC: EZC	1
15	PAHZZ	813493	RLR07C2321GP	RESISTOR UOC: EZC	1
16	PAHZZ	81349	RCR07G4R7JS	RESISTOR, FIXED, COMP UOC: EZC	2
17	PAHZZ	81349	RLR07C5761GP	RESISTOR UOC: EZC	1
18	PAHZZ	81349	RCR05G222JS	RESISTOR, FIXED, COMP UOC: EZC	2
19	PAHZZ	81349	RCR05G331JS	RESISTOR, FIXED, COMP UOC: EZC	5
20	PAHZZ	81349	RCR05G821JS	RESISTOR, FIXED, COMP UOC: EZC	1
21	PAHZZ	81349	RCR05G472JS	RESISTOR, FIXED, COMP UOC: EZC	1
22	PAHZZ	81349	RCR05G223JS	RESISTOR, FIXED, COMP UOC: EZC	1
23	PAHZZ	81349	RCR05G272JS	RESISTOR, FIXED, COMP UOC: EZC	1
24	PAHZZ	81349	RCR05G562JS	RESISTOR, FIXED, COMP	1

SECTION II (1) ITEM NO	(2) SMR CODE	(3) FSCM	TM11-5895-1194-24P-2 (4) PART NUMBER	(5) DESCRIPTION AND USABLE ON CODE (UOC)	(6) QTY
25	PAHZZ	81349	RWR89S1000FR	UOC: EZC RESISTOR, FIXED, WIRE	1
26	PAHZZ	81349	RCR05G100JS	UOC: EZC RESISTOR, FIXED, COMP	1
27	PAHZZ	81349	RCR05G102JS	UOC: EZC RESISTOR, FIXED, COMP	1
28	PAHZZ	81349	M38510/10304BGB	UOC: EZC MICROCIRCUIT	1
29	PAHZZ	81349	M38510/00103BCB	UOC: EZC MICROCIRCUIT, DIGITA	1
30	PAHZZ	18876	MIS-21440-001	UOC: EZC DIODE	1
31	PAHZZ	81349	JANTX1N5637A	UOC: EZC SEMICONDUCTOR DEVIC	1
32	PAHZZ	81349	JANTX1N5907	UOC: EZC SEMICONDUCTOR DEVIC	1
33	PAHZZ	18876	10101367-3	UOC: EZC TERMINAL, LUG	6
34	PAHZZ	08289	BBT066-62	UOC: EZC INSULATOR	6
35	PAHZZ	96906	MS51957-30	UOC: EZC SCREW, MACHINE	12
36	PAHZZ	96906	MS15795-805	UOC: EZC WASHER, FLAT	12
37	PAHZZ	96906	MS35338-136	UOC: EZC WASHER, LOCK	12
38	PAHZZ	80205	NAS671C6	UOC: EZC NUT, PLAIN, HEXAGON	12
39	PAHZZ	94222	90-0-6503-11	UOC: EZC HANDLE, DOOR	2
40	PAHZZ	94222	90-0-5858-24	UOC: EZC RIVET, SOLID	2
41	PAHZZ	96906	MS51957-14	UOC: EZC SCREW, MACHINE	2
42	PAHZZ	80205	NAS671C4	UOC: EZC NUT, PLAIN, HEXAGON	2
43	XAHZZ	18876	13143977	UOC: EZC BOARD, PW	1

END OF FIGURE



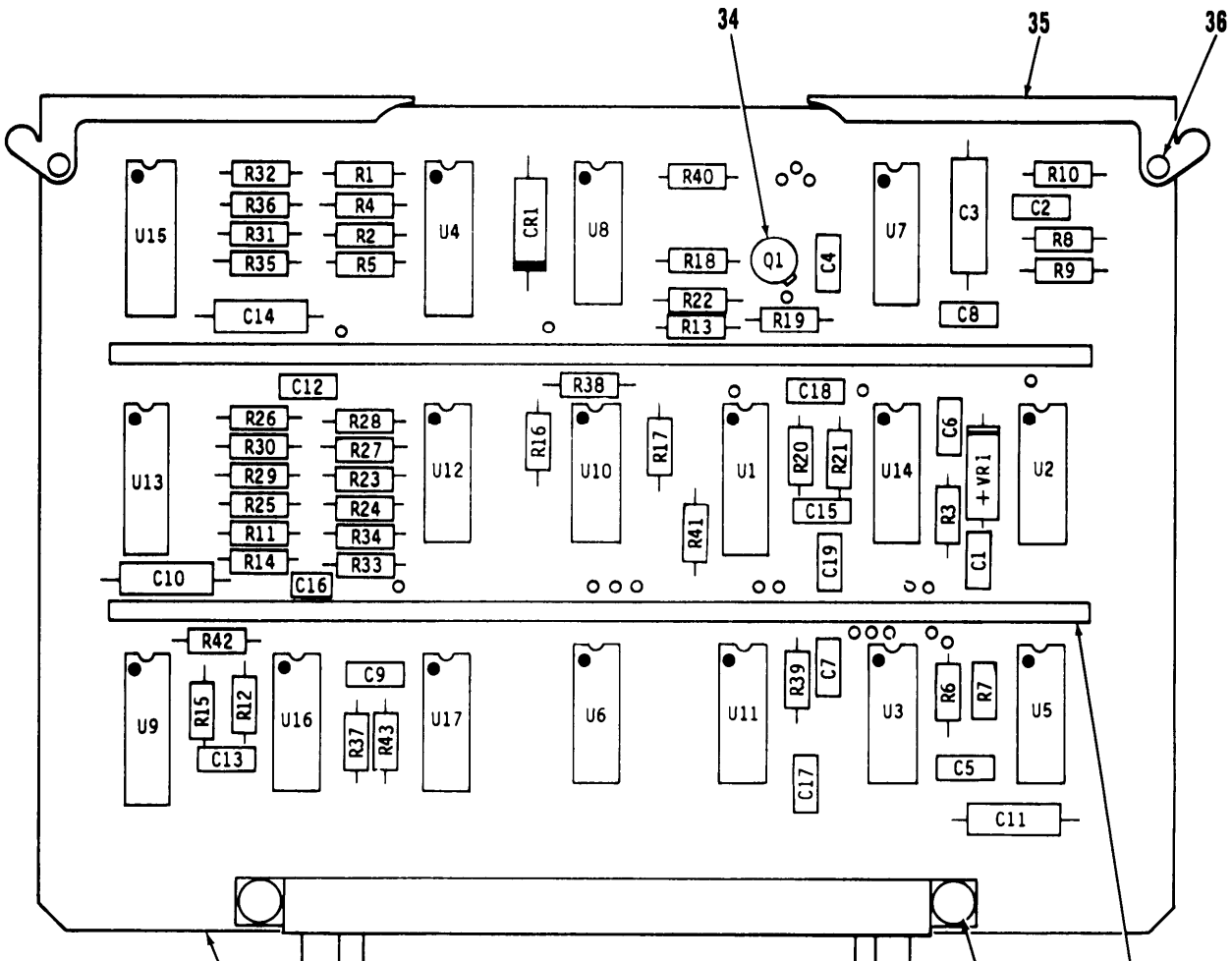

REF DES	ITEM NO.	REF DES	ITEM NO.	REF DES	ITEM NO.	REF DES	ITEM NO.
CR1	1	R4	11	R28	11	U9	27
C1	2	R5	11	R29	19	U10	31
C2	3	R6	12	R30	19	U11	29
C3	4	R7	12	R31	11	U12	31
C4	5	R8	13	R32	11	U13	27
C5	5	R9	14	R33	14	U14	26
C6	5	R10	15	R34	15	U15	27
C7	5	R11	11	R35	11	U16	29
C8	5	R12	11	R36	11	U17	32
C9	5	R13	13	R37	13	VR1	33
C10	6	R14	11	R38	19		
C11	7	R15	11	R39	20		
C12	5	R16	11	R40	21		
C13	5	R17	16	R41	22		
C14	7	R18	17	R42	23		
C15	8	R19	12	R43	11		
C16	3	R20	14	U1	24		
C17	9	R21	15	U2	25		
C18	5	R22	18	U3	26		
C19	5	R23	11	U4	27		
Q1	10	R24	11	U5	26		
R1	11	R25	19	U6	28		
R2	11	R26	19	U7	29		
R3	12	R27	11	U8	30		

EL9SP007

Figure 7. Time Set Circuit Card Assembly AN/GSX-1 A12

SECTION II (1) ITEM NO	(2) SMR CODE	(3) FSCM	TM11-5895-1194-24P-2 (4) PART NUMBER	(5) DESCRIPTION AND USABLE ON CODE (UOC)	(6) QTY
GROUP 06 TIME SET CIRCUIT CARD ASSEMBLY AN/GSX-1 A2					
FIG, 7					
1	PAHZZ	81349	JANTX1N4148	SEMICONDUCTOR DEVIC UOC:ELV	1
2	PAHZZ	81349	M39014/01-1581	CAPACITOR, FIXED, CER UOC:ELV	1
3	PAHZZ	81349	M39014/01-1357	CAPACITOR, FIXED, CER UOC:ELV	2
4	PAHZZ	81349	M39003-01-3024	CAPACITOR, FIXED, ELE UOC:ELV	1
5	PAHZZ	81349	M39014/01-1575	CAPACITOR, FIXED, CER UOC:ELV	10
6	PAHZZ	81349	M39003-01-3076	CAPACITOR, FIXED, ELE UOC:ELV	1
7	PAHZZ	81349	M39003-01-2988	CAPACITOR, FIXED, ELE UOC:ELV	2
8	PAHZZ	81349	M39014/01-1565	CAPACITOR, FIXED, CER UOC:ELV	1
9	PAHZZ	81349	M39014/01-1348	CAPACITOR, FIXED, CER UOC:ELV	1
10	PAHZZ	81349	JANTX2N2222A	TRANSISTOR UOC:ELV	1
11	PAHZZ	81349	RCR05G103JS	RESISTOR, FIXED, COMP UOC:ELV	18
12	PAHZZ	81349	RCR05G221JS	RESISTOR, FIXED, COMP UOC:ELV	4
13	PAHZZ	81349	RCR05G102JS	RESISTOR, FIXED, COMP UOC:ELV	3
14	PAHZZ	81349	RCR05G272JS	RESISTOR, FIXED, COMP UOC:ELV	3
15	PAHZZ	81349	RCR05G563JS	RESISTOR, FIXED, COMP UOC:ELV	3
16	PAHZZ	81349	RCR05G472JS	RESISTOR, FIXED, COMP UOC:ELV	1
17	PAHZZ	81349	RCR05G222JS	RESISTOR, FIXED, COMP UOC:ELV	1
18	PAHZZ	81349	RCR05G332JS	RESISTOR, FIXED, COMP UOC:ELV	1
19	PAHZZ	81349	RCR05G104JS	RESISTOR, FIXED, COMP UOC:ELV	5
20	PAHZZ	81349	RCR05G683JS	RESISTOR, FIXED, COMP UOC:ELV	1
21	PAHZZ	81349	RCR05G152JS	RESISTOR, FIXED, COMP UOC:ELV	1
22	PAHZZ	81349	RCR05G101JS	RESISTOR, FIXED, COMP UOC:ELV	1
23	PAHZZ	81349	RCR05G471JS	RESISTOR, FIXED, COMP UOC:ELV	1
24	PAHZZ	81349	JM38510-05503BEA	MICROCIRCUIT, DIGITA	1

SECTION II (1) ITEM NO	(2) SMR CODE	(3) FSCM	TM11-5895-1194-24P-2 (4) PART NUMBER	(5) DESCRIPTION AND USABLE ON CODE (UOC)	(6) QTY
25	PAHZZ	81349	M38510/00401BCB	UOC:ELV MICROCIRCUIT,DIGITA	1
26	PAHZZ	81349	M38510/00104BCB	UOC:ELV MICROCIRCUIT,DIGITA	3
27	PAHZZ	18876	MIS-23642	UOC:ELV MICROCIRCUIT	4
28	PAHZZ	81349	M38510/02005BCB	UOC:ELV MICROCIRCUIT,DIGITA	1
29	PAHZZ	81349	M38510/02004BCB	UOC:ELV MICROCIRCUIT,DIGITA	3
30	PAHZZ	81349	M38510/00801BCB	UOC:ELV MICROCIRCUIT,DIGITA	1
31	PAHZZ	18876	MIS-23643	UOC:ELV MICROCIRCUIT	2
32	PAHZZ	81349	M38510/00205BCB	UOC:ELV MICROCIRCUIT	1
33	PAHZZ	81349	JANTX1N756A	UOC:ELV SEMICONDUCTOR DEVIC	1
34	PAHZZ	10001	2859485A-7	UOC:ELV INSULATOR,CUP	1
35	PAHZZ	94222	90-0-6503-11	UOC:ELV HANDLE,DOOR	2
36	PAHZZ	94222	90-0-5858-24	UOC:ELV RIVET,SOLID	2
37	PAHZZ	29593	B11752	UOC:ELV BUS BAR	2
38	PAHZZ	96906	MS16535-141	UOC:ELV RIVET,TUBULAR	2
39	PAHZZ	18876	MIS-21424/10-008	UOC:ELV CONNECTOR	1
40	XAHZZ	18876	13056527	UOC:ELV BOARD,PW	1

END OF FIGURE





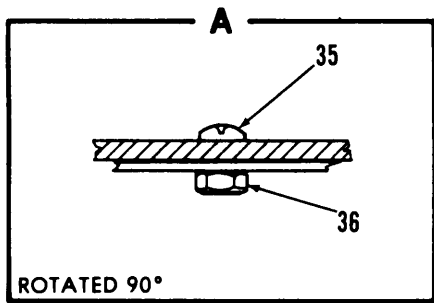
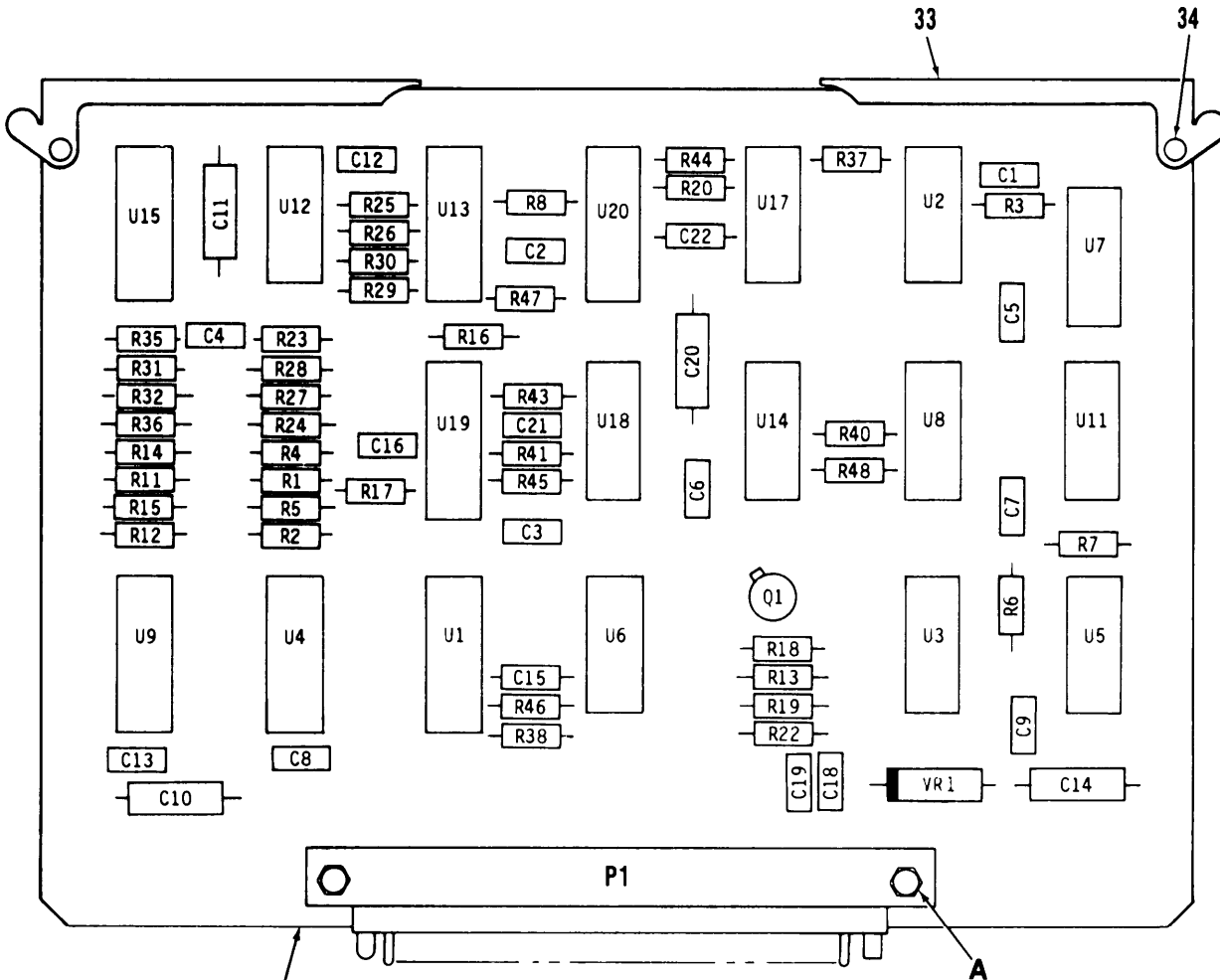

REF DES	ITEM NO.	REF DES	ITEM NO.	REF DES	ITEM NO.	REF DES	ITEM NO.
C1	1	R2	12	R29	19	U9	24
C2	2	R3	13	R30	19	U11	27
C3	3	R4	12	R31	12	U12	28
C4	3	R5	12	R32	12	U13	24
C5	3	R6	13	R35	12	U14	23
C6	3	R7	13	R36	12	U15	24
C7	3	R8	14	R37	14	U17	29
C8	3	R11	12	R38	19	U18	30
C9	3	R12	12	R40	20	U19	31
C10	4	R13	14	R41	19	U20	31
C11	5	R14	12	R43	12	VR1	32
C12	3	R15	12	R44	15		
C13	3	R16	12	R45	14		
C14	5	R17	15	R46	14		
C15	6	R18	16	R47	12		
C16	2	R19	13	R48	14		
C18	3	R20	17	U1	21		
C19	3	R22	18	U2	22		
C20	7	R23	12	U3	23		
C21	8	R24	12	U4	24		
C22	9	R25	19	U5	23		
P1	10	R26	19	U6	25		
Q1	11	R27	12	U7	23		
R1	12	R28	12	U8	26		

EL9SP008

Figure 8. Time Set Circuit Card Assembly AN/GSX-1A AZ

SECTION II (1) ITEM NO	(2) SMR CODE	(3) FSCM	TM11-5895-1194-24P-2 (4) PART NUMBER	(5) DESCRIPTION AND USABLE ON CODE (UOC)	(6) QTY
GROUP 07 TIME SET CIRCUIT CARD ASSEMBLY AN/GSX-1A A2					
FIG, 8					
1	PAHZZ	81349	M39014/01-1581	CAPACITOR, FIXED, CER UOC: EZC	1
2	PAHZZ	81349	M39014/01-1357	CAPACITOR, FIXED, CER UOC: EZC	2
3	PAHZZ	81349	M39014/01-1575	CAPACITOR, FIXED, CER UOC: EZC	11
4	PAHZZ	81349	M39003-01-3076	CAPACITOR, FIXED, ELE UOC: EZC	1
5	PAHZZ	81349	M39003-01-2988	CAPACITOR, FIXED, ELE UOC: EZC	2
6	PAHZZ	81349	M39014/01-1578	CAPACITOR, FIXED, CER UOC: EZC	1
7	PAHZZ	81349	M39003-01-3073	CAPACITOR, FIXED, ELE UOC: EZC	1
8	PAHZZ	81349	CCR75CG201FR	CAPACITOR UOC: EZC	1
9	PAHZZ	81349	CCR75CG511FM	CAPACITOR UOC: EZC	1
10	PAHZZ	81349	M55302/57A50Y(34	CONNECTOR UOC: EZC	1
11	PAHZZ	81349	JANTX2N2222A	TRANSISTOR UOC: EZC	1
12	PAHZZ	81349	RCR05G103JS	RESISTOR, FIXED, COMP UOC: EZC	19
13	PAHZZ	81349	RCR05G221JS	RESISTOR, FIXED, COMP UOC: EZC	4
14	PAHZZ	81349	RCR05G102JS	RESISTOR, FIXED, COMP UOC: EZC	6
15	PAHZZ	81349	RCR05G472JS	RESISTOR, FIXED, COMP UOC: EZC	2
16	PAHZZ	81349	RCR05G222JS	RESISTOR, FIXED, COMP UOC: EZC	1
17	PAHZZ	81349	RCR05G272JS	RESISTOR, FIXED, COMP UOC: EZC	1
18	PAHZZ	81349	RCR05G332JS	RESISTOR, FIXED, COMP UOC: EZC	1
19	PAHZZ	81349	RCR05G104JS	RESISTOR, FIXED, COMP UOC: EZC	6
20	PAHZZ	81349	RCR05G152JS	RESISTOR, FIXED, COMP UOC: EZC	1
21	PAHZZ	81349	JM38510-05503BEA	MICROCIRCUIT, DIGITA UOC: EZC	1
22	PAHZZ	81349	M38510/00401BCB	MICROCIRCUIT, DIGITA UOC: EZC	1
23	PAHZZ	81349	M38510/00104BCB	MICROCIRCUIT, DIGITA UOC: EZC	4
24	PAHZZ	18876	MIS-23642	MICROCIRCUIT	4

SECTION II (1) ITEM NO	(2) SMR CODE	(3) FSCM	TM11-5895-1194-24P-2 (4) PART NUMBER	(5) DESCRIPTION AND USABLE ON CODE (UOC)	(6) QTY
25	PAHZZ	81349	M38510/02005BCB	UOC: EZC MICROCIRCUIT, DIGITA	1
26	PAHZZ	81349	M38510/00801BCB	UOC: EZC MICROCIRCUIT, DIGITA	1
27	PAHZZ	81349	M38510/02004BCB	UOC: EZC MICROCIRCUIT, DIGITA	1
28	PAHZZ	18876	MIS-23643	UOC: EZC MICROCIRCUIT	1
29	PAHZZ	81349	M38510/00205BCB	UOC: EZC MICROCIRCUIT	1
30	PAHZZ	81349	M38510/10901BCB	UOC: EZC MICROCIRCUIT, LINEAR	1
31	PAHZZ	01295	SNJ54221J	UOC: EZC MICROCIRCUIT, DIGITA	2
32	PAHZZ	81349	JANTX1N756A	UOC: EZC SEMICONDUCTOR DEVIC	1
33	PAHZZ	94222	90-0-6503-11	UOC: EZC HANDLE, DOOR	2
34	PAHZZ	94222	90-0-5858-24	UOC: EZC RIVET, SOLID	2
35	PAHZZ	96906	MS51957-14	UOC: EZC SCREW, MACHINE	2
36	PAHZZ	80205	NAS671C4	UOC: EZC NUT, PLAIN, HEXAGON	2
37	XAHZZ	18876	13143980	UOC: EZC BOARD, PW	1

END OF FIGURE



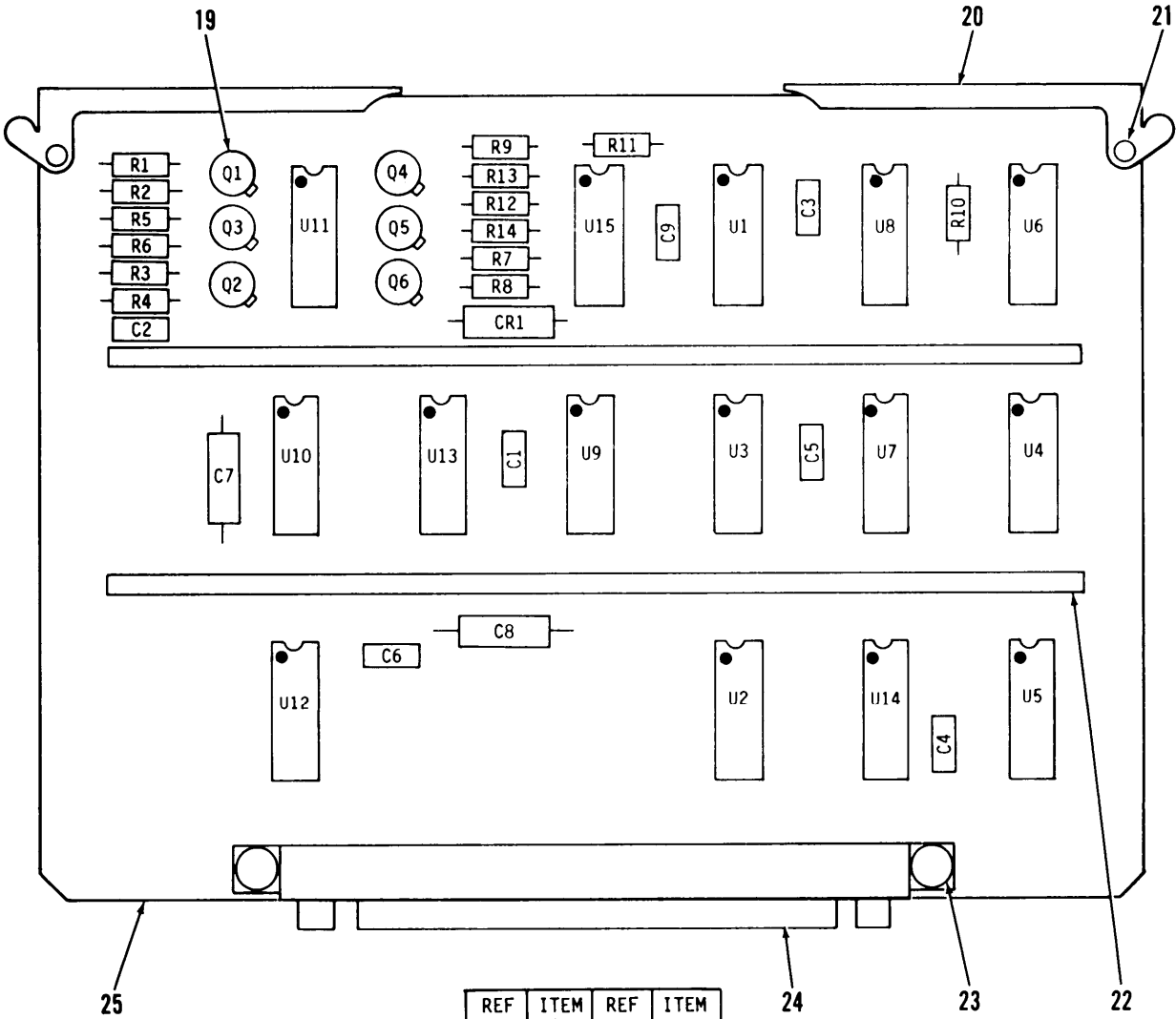

REF DES	ITEM NO.	REF DES	ITEM NO.
CR1	1	R9	6
C1	2	R10	8
C2	2	R11	9
C3	2	R12	6
C4	2	R13	7
C5	2	R14	7
C6	2	U1	10
C7	3	U2	11
C8	3	U3	10
C9	4	U4	12
Q1	5	U5	12
Q2	5	U6	13
Q3	5	U7	14
Q4	5	U8	10
Q5	5	U9	10
Q6	5	U10	14
R1	6	U11	15
R2	7	U12	16
R3	6	U13	17
R4	7	U14	10
R5	6	U15	18
R6	7		
R7	6		
R8	7		

EL9SP009

Figure 9. Mode 4 Control Circuit Card Assembly AN/GSX-1 A3

SECTION II (1) ITEM NO	(2) SMR CODE	(3) FSCM	TM11-5895-1194-24P-2 (4) PART NUMBER	(5) DESCRIPTION AND USABLE ON CODE (UOC)	(6) QTY
GROUP 08 MODE 4 CONTROL CIRCUIT CARD ASSEMBLY AN/GSX-1 A3 FIG, 9					
1	PAHZZ	81349	JANTX1N4148	SEMICONDUCTOR DEVIC UOC:ELV	1
2	PAHZZ	81349	M39014/01-1575	CAPACITOR, FIXED, CER UOC:ELV	6
3	PAHZZ	81349	M39003-01-2988	CAPACITOR, FIXED, ELE UOC:ELV	2
4	PAHZZ	81349	M39014/01-1348	CAPACITOR, FIXED, CER UOC:ELV	1
5	PAHZZ	81349	JANTX2N2222A	TRANSISTOR UOC:ELV	6
6	PAHZZ	81349	RCR05G362JS	RESISTOR, FIXED, COMP UOC:ELV	6
7	PAHZZ	81349	RCR05G202JS	RESISTOR, FIXED, COMP UOC:ELV	6
8	PAHZZ	81349	RCR05G102JS	RESISTOR, FIXED, COMP UOC:ELV	1
9	PAHZZ	81349	RCR05G331JS	RESISTOR, FIXED, COMP UOC:ELV	1
10	PAHZZ	81349	M38510/00104BCB	MICROCIRCUIT, DIGITA UOC:ELV	5
11	PAHZZ	81349	M38510/00103BCB	MICROCIRCUIT, DIGITA UOC:ELV	1
12	PAHZZ	81349	M38510/00903BCB	MICROCIRCUIT, DIGITA UOC:ELV	2
13	PAHZZ	81349	M38510/00403BCB	MICROCIRCUIT, DIGITA UOC:ELV	1
14	PAHZZ	81349	M38510/00401BCB	MICROCIRCUIT, DIGITA UOC:ELV	2
15	PAHZZ	81349	M38510/00801BCB	MICROCIRCUIT, DIGITA UOC:ELV	1
16	PAHZZ	81349	M38510/01302BCB	MICROCIRCUIT, DIGITA UOC:ELV	1
17	PAHZZ	81349	M38510/00102BCB	MICROCIRCUIT, DIGITA UOC:ELV	1
18	PAHZZ	81349	M38510/02004BCB	MICROCIRCUIT, DIGITA UOC:ELV	1
19	PAHZZ	10001	2859485A-7	INSULATOR, CUP UOC:ELV	6
20	PAHZZ	94222	90-0-6503-11	HANDLE, DOOR UOC:ELV	2
21	PAHZZ	94222	90-0-5858-24	RIVET, SOLID UOC:ELV	2
22	PAHZZ	29593	B11752	BUS BAR UOC:ELV	2
23	PAHZZ	96906	MS16535-141	RIVET, TUBULAR UOC:ELV	2
24	PAHZZ	18876	MIS-21424/10-015	CONNECTOR UOC:ELV	1

SECTION II					
(1)	(2)	(3)	(4)	(5)	(6)
ITEM NO	SMR CODE	FSCM	PART NUMBER	DESCRIPTION AND USABLE ON CODE (UOC)	QTY
25	XAHZZ	18876	13056528	BOARD,PW UOC:ELV	1
END OF FIGURE					





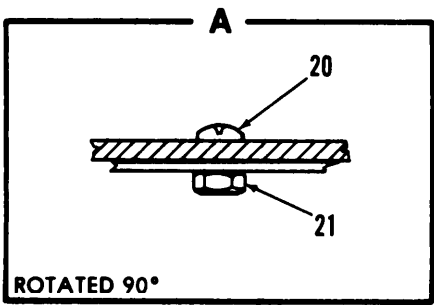
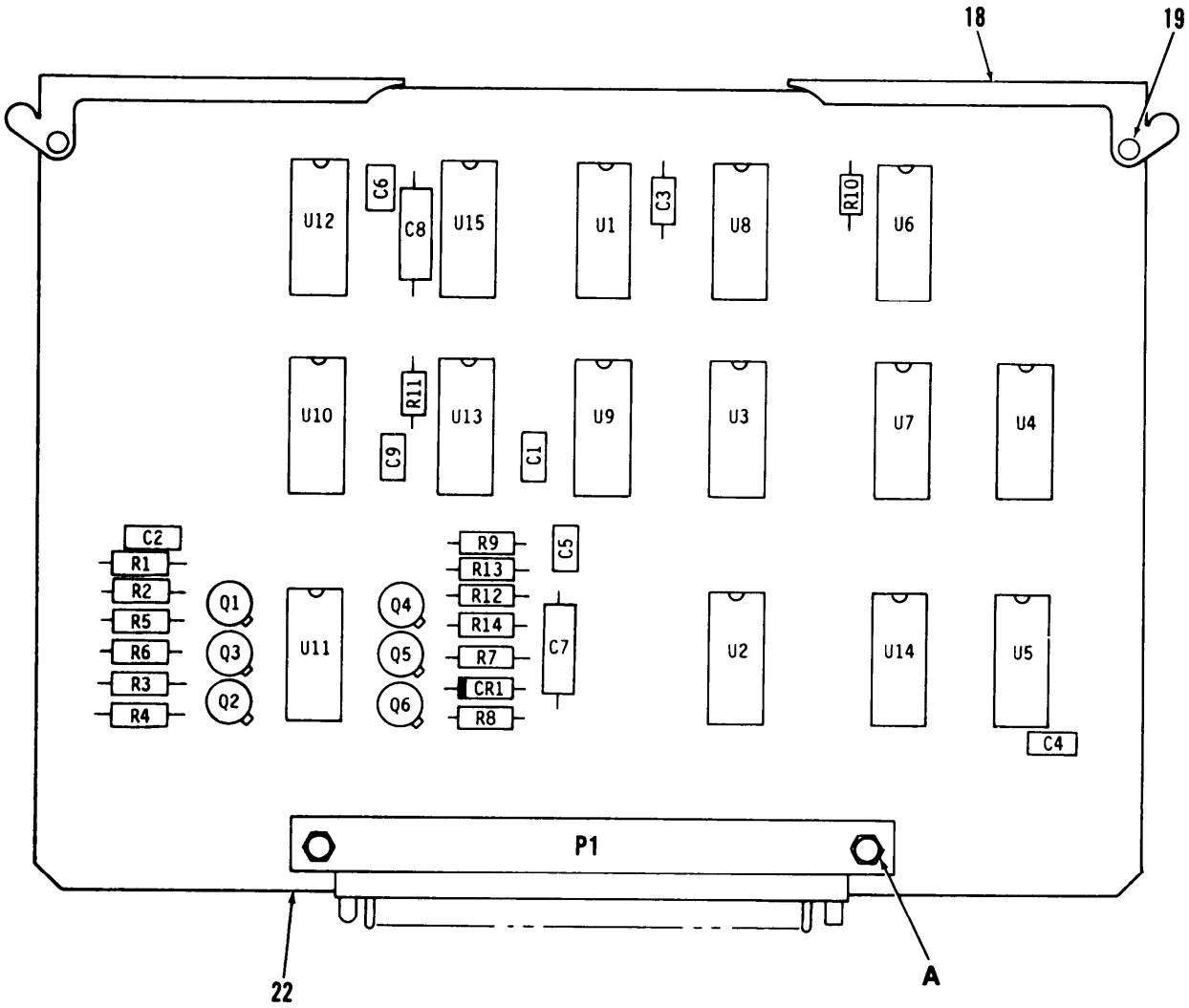

REF DES	ITEM NO.	REF DES	ITEM NO.
CR1	1	R8	8
C1	2	R9	7
C2	2	R10	9
C3	2	R11	9
C4	2	R12	7
C5	2	R13	8
C6	2	R14	8
C7	3	U1	10
C8	3	U2	11
C9	4	U3	10
P1	5	U4	12
Q1	6	U5	12
Q2	6	U6	13
Q3	6	U7	14
Q4	6	U8	10
Q5	6	U9	10
Q6	6	U10	14
R1	7	U11	15
R2	8	U12	16
R3	7	U13	17
R4	8	U14	10
R5	7	U15	10
R6	8		
R7	7		

EL9SP010

Figure 10. Mode 4 Control Circuit Card Assembly AN/GSX-1A A3

SECTION II (1) ITEM NO	(2) SMR CODE	(3) FSCM	TM11-5895-1194-24P-2 (4) PART NUMBER	(5) DESCRIPTION AND USABLE ON CODE (UOC)	(6) QTY
GROUP 09 MODE 4 CONTROL CIRCUIT CARD ASSEMBLY AN/GSX-1A A3					
FIG, 10					
1	PAHZZ	81349	JANTX1N4148-1	SEMICONDUCTOR DEVIC UOC: EZC	1
2	PAHZZ	81349	M39014/01-1575	CAPACITOR, FIXED, CER UOC: EZC	6
3	PAHZZ	81349	M39003-01-2988	CAPACITOR, FIXED, ELE UOC: EZC	2
4	PAHZZ	81349	M39014/01-1348	CAPACITOR, FIXED, CER UOC: EZC	1
5	PAHZZ	81349	M55302/57A50Y(35 )	CONNECTOR UOC: EZC	1
6	PAHZZ	81349	JANTX2N2222A	TRANSISTOR UOC: EZC	6
7	PAHZZ	81349	RCR05G362JS	RESISTOR, FIXED, COMP UOC: EZC	6
8	PAHZZ	81349	RCR05G202JS	RESISTOR, FIXED, COMP UOC: EZC	6
9	PAHZZ	81349	RCR05G102JS	RESISTOR, FIXED, COMP UOC: EZC	2
10	PAHZZ	81349	M38510/00104BCB	MICROCIRCUIT, DIGITA UOC: EZC	6
11	PAHZZ	81349	M38510/00103BCB	MICROCIRCUIT, DIGITA UOC: EZC	1
12	PAHZZ	81349	M38510/00903BCB	MICROCIRCUIT, DIGITA UOC: EZC	2
13	PAHZZ	81349	M38510/00403BCB	MICROCIRCUIT, DIGITA UOC: EZC	1
14	PAHZZ	81349	M38510/00401BCB	MICROCIRCUIT, DIGITA UOC: EZC	2
15	PAHZZ	81349	M38510/00801BCB	MICROCIRCUIT, DIGITA UOC: EZC	1
16	PAHZZ	81349	M38510/01302BCB	MICROCIRCUIT, DIGITA UOC: EZC	1
17	PAHZZ	81349	M38510/00102BCB	MICROCIRCUIT, DIGITA UOC: EZC	1
18	PAHZZ	94222	90-0-6503-11	HANDLE, DOOR UOC: EZC	2
19	PAHZZ	94222	90-0-5858-24	RIVET, SOLID UOC: EZC	2
20	PAHZZ	96906	MS51957-14	SCREW, MACHINE UOC: EZC	2
21	PAHZZ	80205	NAS671C4	NUT, PLAIN, HEXAGON UOC: EZC	2
22	XAHZZ	18876	13143983	BOARD, PW UOC: EZC	1

END OF FIGURE

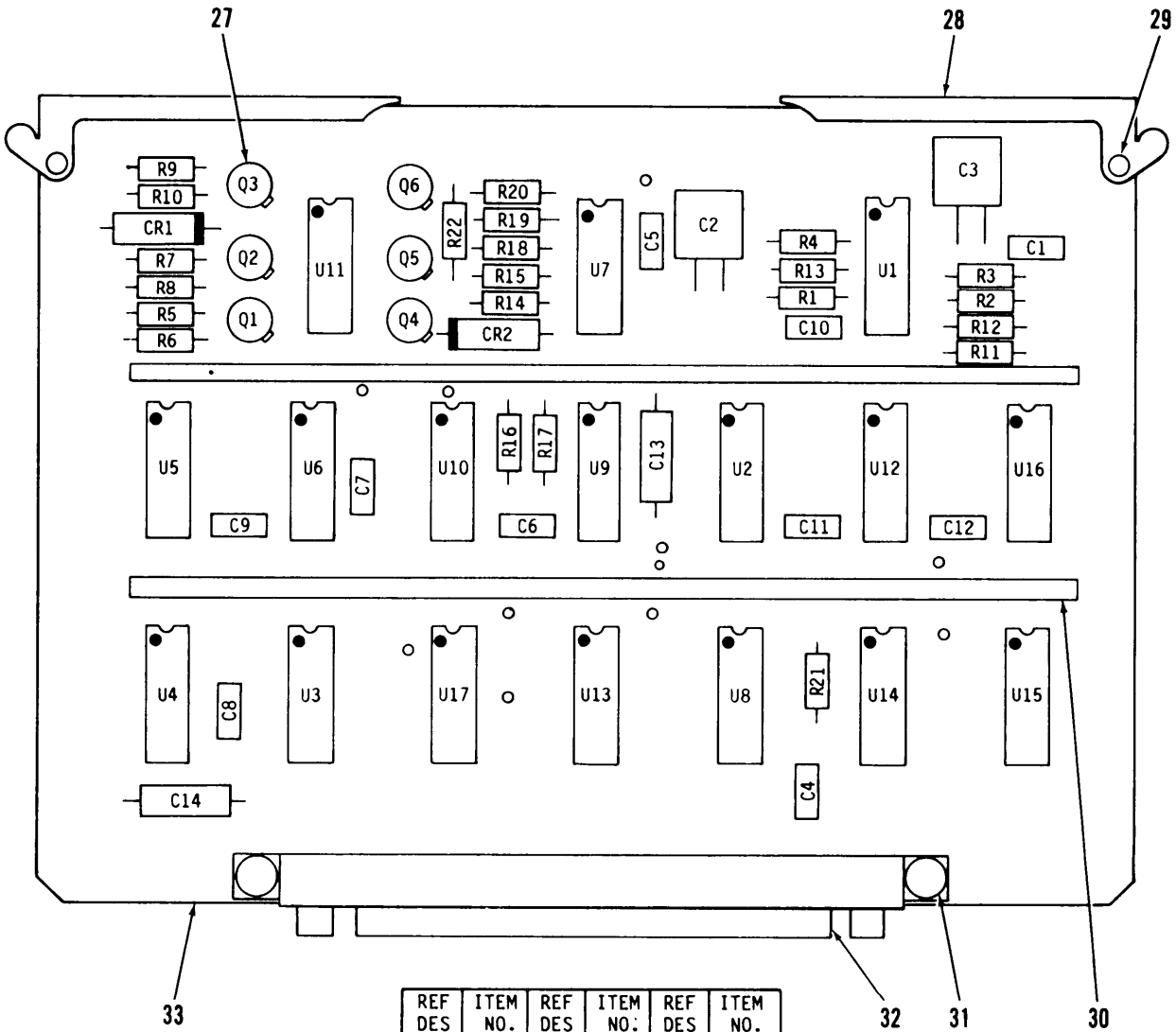

REF DES	ITEM NO.	REF DES	ITEM NO.	REF DES	ITEM NO.
CR1	1	R3	10	U5	17
CR2	1	R4	10	U6	17
C1	2	R5	11	U7	18
C2	3	R6	12	U8	19
C3	4	R7	11	U9	16
C4	5	R8	12	U10	20
C5	5	R9	11	U11	21
C6	5	R10	12	U12	22
C7	5	R11	9	U13	23
C8	5	R12	10	U14	24
C9	5	R13	8	U15	25
C10	5	R14	11	U16	25
C11	5	R15	12	U17	26
C12	5	R16	10		
C13	6	R17	9		
C14	6	R18	11		
Q1	7	R19	12		
Q2	7	R20	13		
Q3	7	R21	13		
Q4	7	R22	14		
Q5	7	U1	15		
Q6	7	U2	16		
R1	8	U3	17		
R2	9	U4	17		

EL9SP011

Figure 11. Mode 4 Address Circuit Card Assembly AN/GSX-1 A4

SECTION II (1) ITEM NO	(2) SMR CODE	(3) FSCM	TM11-5895-1194-24P-2 (4) PART NUMBER	(5) DESCRIPTION AND USABLE ON CODE (UOC)  GROUP 10 MODE 4 ADDRESS CIRCUIT CARD ASSEMBLY AN/GSX-1 A4  FIG, 11	(6) QTY
1	PAHZZ	81349	JANTX1N4148	SEMICONDUCTOR DEVIC UOC:ELV	2
2	PAHZZ	81349	M39014/01-1581	CAPACITOR, FIXED, CER UOC:ELV	1
3	PAHZZ	81349	CMR04F271G0CR	CAPACITOR, FIXED, MIC UOC:ELV	1
4	PAHZZ	81349	CMR04F121F0DP	CAPACITOR UOC:ELV	1
5	PAHZZ	81349	M39014/01-1575	CAPACITOR, FIXED, CER UOC:ELV	9
6	PAHZZ	81349	M39003-01-2988	CAPACITOR, FIXED, ELE UOC:ELV	2
7	PAHZZ	81349	JANTX2N2222A	TRANSISTOR UOC:ELV	6
8	PAHZZ	81349	RCR05G151JS	RESISTOR, FIXED, COMP UOC:ELV	2
9	PAHZZ	81349	RCR05G272JS	RESISTOR, FIXED, COMP UOC:ELV	3
10	PAHZZ	81349	RCR05G563JS	RESISTOR, FIXED, COMP UOC:ELV	4
11	PAHZZ	81349	RCR05G362JS	RESISTOR, FIXED, COMP UOC:ELV	5
12	PAHZZ	81349	RCR05G202JS	RESISTOR, FIXED, COMP UOC:ELV	5
13	PAHZZ	81349	RCR05G102JS	RESISTOR, FIXED, COMP UOC:ELV	2
14	PAHZZ	81349	RCR07G4R7JS	RESISTOR, FIXED, COMP UOC:ELV	1
15	PAHZZ	81349	M38510/02005BCB	MICROCIRCUIT, DIGITA UOC:ELV	1
16	PAHZZ	81349	M38510/02004BCB	MICROCIRCUIT, DIGITA UOC:ELV	2
17	PAHZZ	81349	M38510/00903BCB	MICROCIRCUIT, DIGITA UOC:ELV	4
18	PAHZZ	81349	M38510/08101BCB	MICROCIRCUIT, LINEAR UOC:ELV	1
19	PAHZZ	81349	M38510/00205BCB	MICROCIRCUIT UOC:ELV	1
20	PAHZZ	81349	M38510/00105BCB	MICROCIRCUIT, DIGITA UOC:ELV	1
21	PAHZZ	81349	M38510/00803BCB	MICROCIRCUIT, DIGITA UOC:ELV	1
22	PAHZZ	81349	M38510/00401BCB	MICROCIRCUIT, DIGITA UOC:ELV	1
23	PAHZZ	81349	M38510/00103BCB	MICROCIRCUIT, DIGITA UOC:ELV	1
24	PAHZZ	18876	MIS-23645	MICROCIRCUIT	1

SECTION II		TM11-5895-1194-24P-2			
(1)	(2)	(3)	(4)	(5)	(6)
ITEM	SMR		PART		
NO	CODE	FSCM	NUMBER	DESCRIPTION AND USABLE ON CODE (UOC)	QTY
25	PAHZZ	81349	M38510/01302BCB	UOC:ELV MICROCIRCUIT,DIGITA	2
26	PAHZZ	81349	M38510/00102BCB	UOC:ELV MICROCIRCUIT,DIGITA	1
27	PAHZZ	10001	2859485A-7	UOC:ELV INSULATOR,CUP	6
28	PAHZZ	94222	90-0-6503-11	UOC:ELV HANDLE,DOOR	2
29	PAHZZ	94222	90-0-5858-24	UOC:ELV RIVET,SOLID	2
30	PAHZZ	29593	B11752	UOC:ELV BUS BAR	2
31	PAHZZ	96906	MS16535-141	UOC:ELV RIVET,TUBULAR	2
32	PAHZZ	18876	MIS-21424/10-022	UOC:ELV CONNECTOR	1
33	XAHZZ	18876	13056529	UOC:ELV BOARD,PW	1

END OF FIGURE



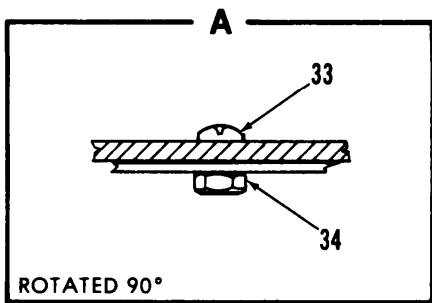
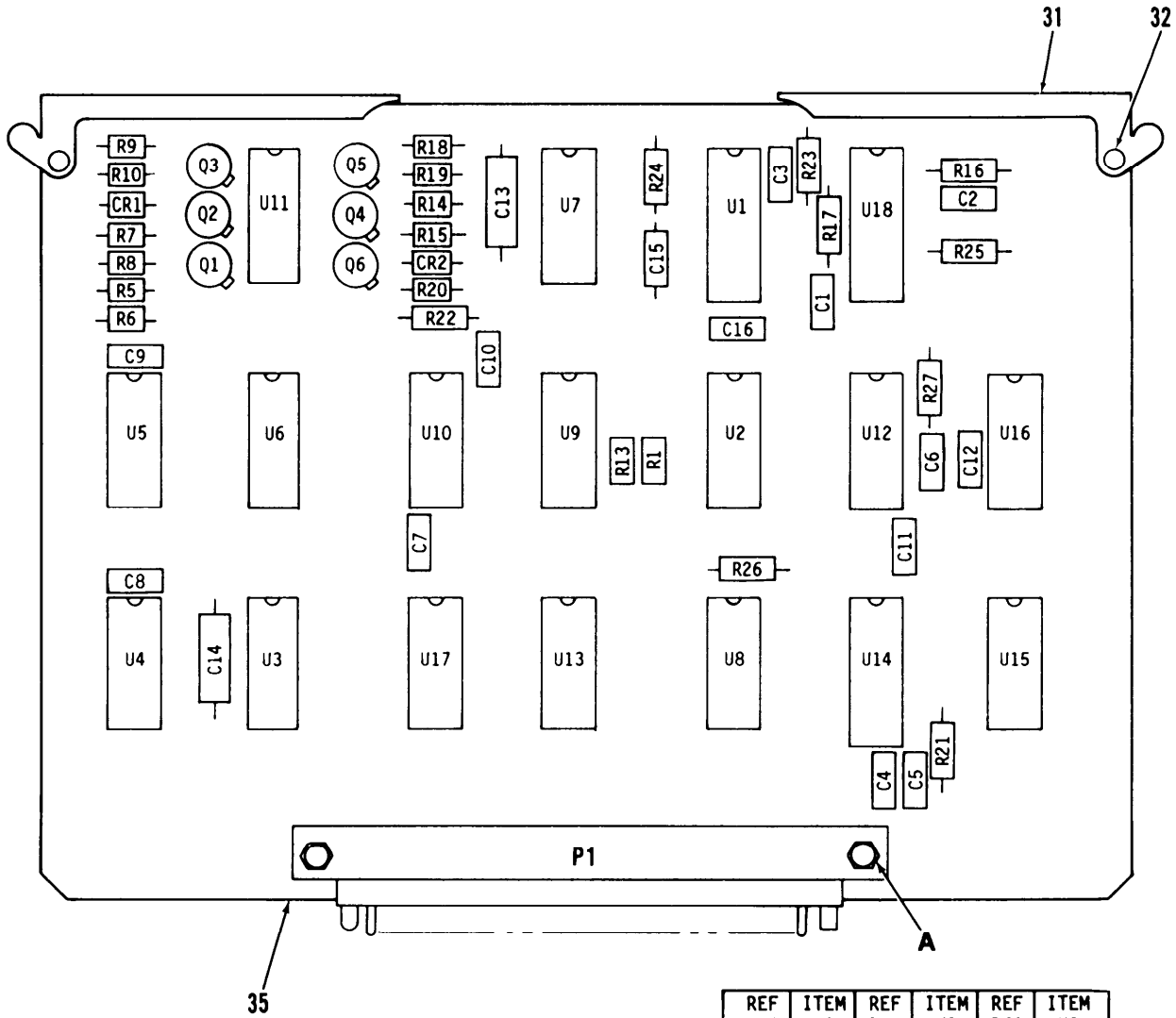

REF DES	ITEM NO.	REF DES	ITEM NO.	REF DES	ITEM NO.
CR1	1	Q6	9	U2	19
CR2	1	R1	10	U3	20
C1	2	R5	11	U4	20
C2	3	R6	12	U5	20
C3	4	R7	11	U6	20
C4	4	R8	12	U7	21
C5	4	R9	11	U8	22
C6	4	R10	12	U9	23
C7	4	R13	10	U10	24
C8	4	R14	11	U11	25
C9	4	R15	12	U12	26
C10	4	R16	13	U13	27
C11	4	R17	14	U14	28
C12	4	R18	11	U15	29
C13	5	R19	12	U16	29
C14	5	R20	15	U17	30
C15	6	R21	15	U18	18
C16	7	R22	16		
P1	8	R23	17		
Q1	9	R24	14		
Q2	9	R25	15		
Q3	9	R26	15		
Q4	9	R27	15		
Q5	9	U1	18		

EL9SP012

Figure 12. Mode 4 Address Circuit Card Assembly AN/GSX-1A A4



SECTION II (1) ITEM NO	(2) SMR CODE	(3) FSCM	TM11-5895-1194-24P-2 (4) PART NUMBER	(5) DESCRIPTION AND USABLE ON CODE (UOC)	(6) QTY
GROUP 11 MODE 4 ADDRESS CIRCUIT CARD ASSEMBLY AN/GSX-1A A4					
FIG, 12					
1	PAHZZ	81349	JANTX1N4148-1	SEMICONDUCTOR DEVIC UOC: EZC	2
2	PAHZZ	81349	M39014/01-1357	CAPACITOR, FIXED, CER UOC: EZC	1
3	PAHZZ	81349	M39014/01-1578	CAPACITOR, FIXED, CER UOC: EZC	1
4	PAHZZ	81349	M39014/01-1575	CAPACITOR, FIXED, CER UOC: EZC	10
5	PAHZZ	81349	M39003-01-2988	CAPACITOR, FIXED, ELE UOC: EZC	2
6	PAHZZ	81349	CCR75CG511FM	CAPACITOR UOC: EZC	1
7	PAHZZ	81349	M39014/02-1354	CAPACITOR, FIXED, CER UOC: EZC	1
8	PAHZZ	81349	M55302/57A50Y(36 )	CONNECTOR UOC: EZC	1
9	PAHZZ	81349	JANTX2N2222A	TRANSISTOR UOC: EZC	6
10	PAHZZ	81349	RCR05G151JS	RESISTOR, FIXED, COMP UOC: EZC	2
11	PAHZZ	81349	RCR05G362JS	RESISTOR, FIXED, COMP UOC: EZC	5
12	PAHZZ	81349	RCR05G202JS	RESISTOR, FIXED, COMP UOC: EZC	5
13	PAHZZ	81349	RCR05G203JS	RESISTOR, FIXED, COMP UOC: EZC	1
14	PAHZZ	81349	RCR05G332JS	RESISTOR, FIXED, COMP UOC: EZC	2
15	PAHZZ	81349	RCR05G102JS	RESISTOR, FIXED, COMP UOC: EZC	5
16	PAHZZ	81349	RCR07G4R7JS	RESISTOR, FIXED, COMP UOC: EZC	1
17	PAHZZ	81349	RCR05G163JS	RESISTOR, FIXED, COMP UOC: EZC	1
18	PAHZZ	01295	SNJ54221J	MICROCIRCUIT, DIGITA UOC: EZC	2
19	PAHZZ	81349	M38510/00104BCB	MICROCIRCUIT, DIGITA UOC: EZC	1
20	PAHZZ	81349	M38510/00903BCB	MICROCIRCUIT, DIGITA UOC: EZC	4
21	PAHZZ	81349	M38510/08101BCB	MICROCIRCUIT, LINEAR UOC: EZC	1
22	PAHZZ	81349	M38510/00205BCB	MICROCIRCUIT UOC: EZC	1
23	PAHZZ	81349	M38510/00302BCB	MICROCIRCUIT, DIGITA UOC: EZC	1
24	PAHZZ	81349	M38510/00105BCB	MICROCIRCUIT, DIGITA	1

SECTION II		TM11-5895-1194-24P-2			
(1)	(2)	(3)	(4)	(5)	(6)
ITEM	SMR		PART		
NO	CODE	FSCM	NUMBER	DESCRIPTION AND USABLE ON CODE (UOC)	QTY
25	PAHZZ	81349	M38510/00803BCB	UOC:EZC MICROCIRCUIT,DIGITA	1
26	PAHZZ	81349	M38510/00401BCB	UOC:EZC MICROCIRCUIT,DIGITA	1
27	PAHZZ	81349	M38510/00103BCB	UOC:EZC MICROCIRCUIT,DIGITA	1
28	PAHZZ	01295	SNJ54166J-00	UOC:EZC MICROCIRCUIT,DIGITA	1
29	PAHZZ	81349	M38510/01302BCB	UOC:EZC MICROCIRCUIT,DIGITA	2
30	PAHZZ	81349	M38510/00102BCB	UOC:EZC MICROCIRCUIT,DIGITA	1
31	PAHZZ	94222	90-0-6503-11	UOC:EZC HANDLE, DOOR	2
32	PAHZZ	94222	90-0-5858-24	UOC:EZC RIVET,SOLID	2
33	PAHZZ	96906	MS51957-14	UOC:EZC SCREW,MACHINE	2
34	PAHZZ	80205	NAS671C4	UOC:EZC NUT,PLAIN,HEXAGON	2
35	XAHZZ	18876	13143986	UOC:EZC BOARD,PW	1

END OF FIGURE



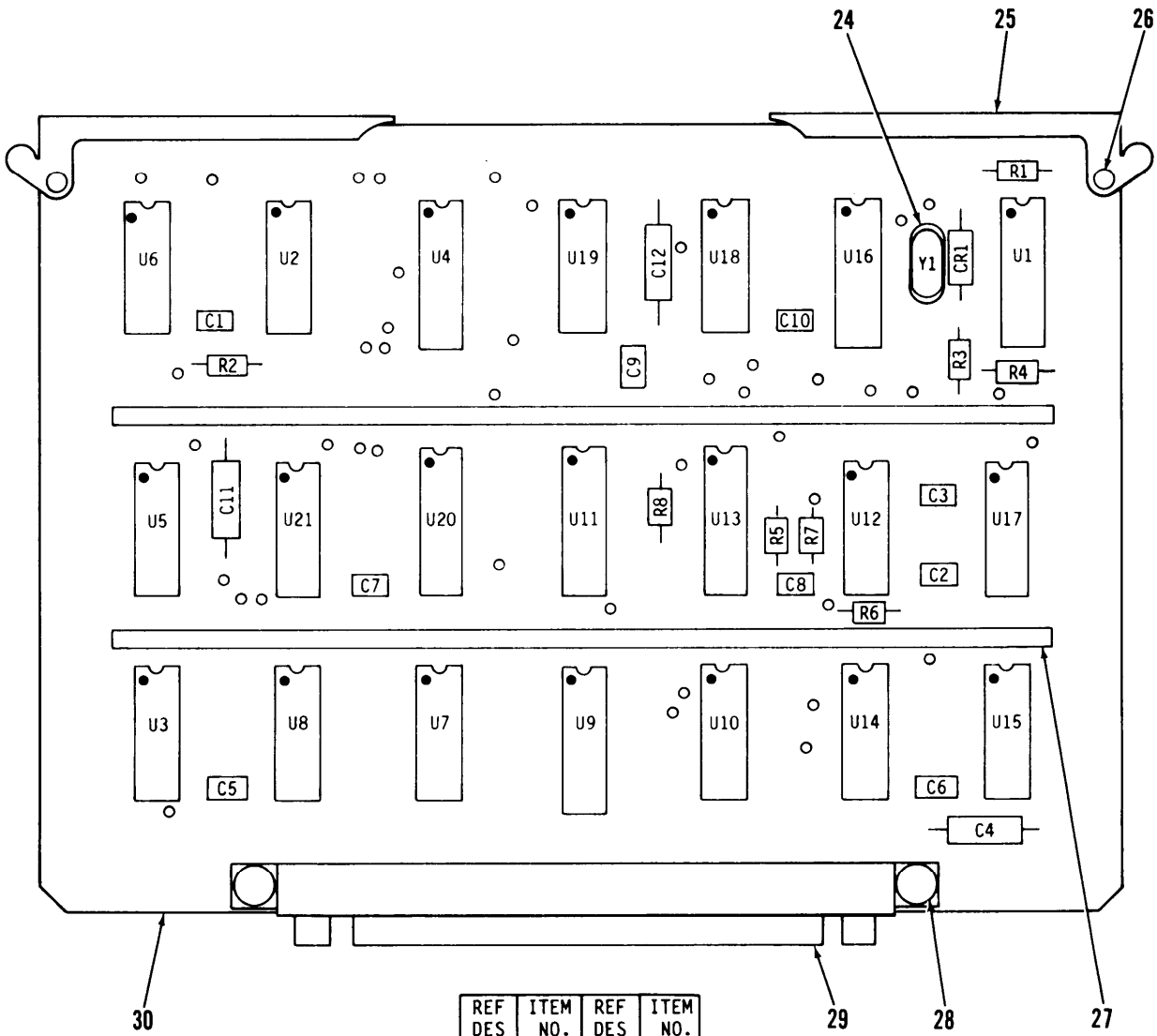

EL9SP013

Figure 13. Mode 4 Clock Circuit Card Assembly AN/GSX-1 A5

SECTION II (1) ITEM NO	(2) SMR CODE	(3) FSCM	TM11-5895-1194-24P-2 (4) PART NUMBER	(5) DESCRIPTION AND USABLE ON CODE (UOC)	(6) QTY
GROUP 12 MODE 4 CLOCK CIRCUIT CARD ASSEMBLY AN/GSX-1 A5					
FIG, 13					
1	PAHZZ	81349	JANTX1N4148	SEMICONDUCTOR DEVIC UOC:ELV	1
2	PAHZZ	81349	M39014/01-1356	CAPACITOR, FIXED, CER UOC:ELV	1
3	PAHZZ	81349	M39014/01-1575	CAPACITOR, FIXED, CER UOC:ELV	8
4	PAHZZ	81349	M39003-01-3076	CAPACITOR, FIXED, ELE UOC:ELV	1
5	PAHZZ	81349	M39003-01-2988	CAPACITOR, FIXED, ELE UOC:ELV	2
6	PAHZZ	81349	RCR05G103JS	RESISTOR, FIXED, COMP UOC:ELV	1
7	PAHZZ	81349	RCR05G101JS	RESISTOR, FIXED, COMP UOC:ELV	1
8	PAHZZ	81349	RCR05G106JS	RESISTOR, FIXED, COMP UOC:ELV	1
9	PAHZZ	81349	RCR05G102JS	RESISTOR, FIXED, COMP UOC:ELV	5
10	PAHZZ	81349	JM38510-05503BEA	MICROCIRCUIT, DIGITA UOC:ELV	1
11	PAHZZ	81349	M38510/00105BCB	MICROCIRCUIT, DIGITA UOC:ELV	3
12	PAHZZ	81349	M38510/00104BCB	MICROCIRCUIT, DIGITA UOC:ELV	1
13	PAHZZ	81349	M38510/01306BEB	MICROCIRCUIT, DIGITA UOC:ELV	2
14	PAHZZ	81349	M38510/00403BCB	MICROCIRCUIT, DIGITA UOC:ELV	1
15	PAHZZ	81349	M38510/00401BCB	MICROCIRCUIT, DIGITA UOC:ELV	2
16	PAHZZ	81349	M38510/01302BCB	MICROCIRCUIT, DIGITA UOC:ELV	3
17	PAHZZ	81349	M38510/01405BEB	MICROCIRCUIT, DIGITA UOC:ELV	1
18	PAHZZ	18876	MIS-23639	MICROCIRCUIT UOC:ELV	1
19	PAHZZ	81349	M38510/00905BEB	MICROCIRCUIT, DIGITA UOC:ELV	2
20	PAHZZ	81349	M38510/00903BCB	MICROCIRCUIT, DIGITA UOC:ELV	2
21	PAHZZ	81349	M38510/00102BCB	MICROCIRCUIT, DIGITA UOC:ELV	1
22	PAHZZ	81349	M38510/00701BCB	MICROCIRCUIT, DIGITA UOC:ELV	1
23	PAHZZ	81349	CR-64/U8.000000M HZ	CRYSTAL UNIT, QUARTZ UOC:ELV	1
24	PAHZZ	07047	10381-DAP	MOUNTING PAD, ELECTR	1

SECTION II						
(1)	(2)	(3)	TM11-5895-1194-24P-2		(6)	
ITEM	SMR		(4)	(5)		
NO	CODE	FSCM	PART	NUMBER	DESCRIPTION AND USABLE ON CODE (UOC)	QTY
25	PAHZZ	94222		90-0-6503-11	UOC:ELV HANDLE, DOOR	2
26	PAHZZ	94222		90-0-5858-24	UOC:ELV RIVET, SOLID	2
27	PAHZZ	29593		B11752	UOC:ELV BUS BAR	2
28	PAHZZ	96906		MS16535-141	UOC:ELV RIVET, TUBULAR	2
29	PAHZZ	18876		MIS-21424/10-029	UOC:ELV CONNECTOR	1
30	XAHZZ	18876		13056530	UOC:ELV BOARD, PW	1
					UOC:ELV	
					END OF FIGURE	



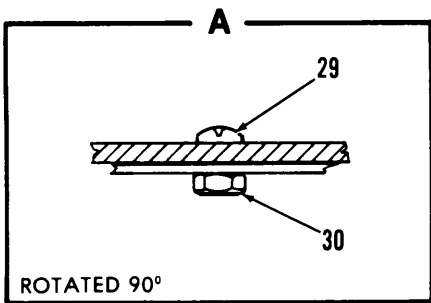
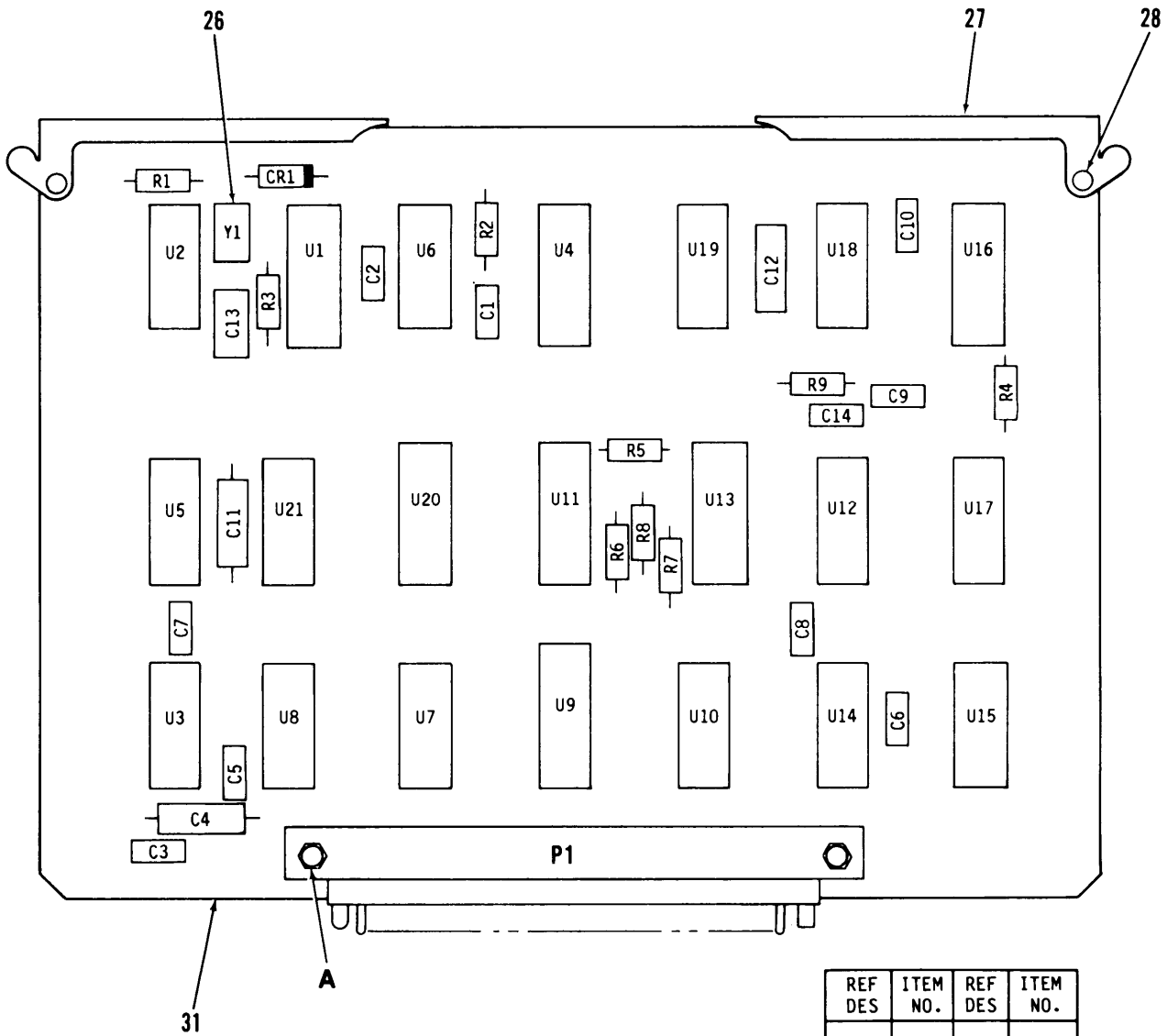

REF DES	ITEM NO.	REF DES	ITEM NO.
CR1	1	R9	11
C1	2	U1	12
C2	3	U2	13
C3	3	U3	14
C4	4	U4	15
C5	3	U5	16
C6	3	U6	17
C7	3	U7	13
C8	3	U8	18
C9	3	U9	19
C10	3	U10	18
C11	5	U11	20
C12	5	U12	13
C13	6	U13	15
C14	3	U14	18
P1	7	U15	17
R1	8	U16	21
R2	9	U17	22
R3	10	U18	23
R4	11	U19	22
R5	11	U20	21
R6	11	U21	24
R7	11	Y1	25
R8	11		

EL9SP014

Figure 14. Mode 4 Clock Circuit Card Assembly AN/GSX-1A A5



SECTION II (1) ITEM NO	(2) SMR CODE	(3) FSCM	TM11-5895-1194-24P-2 (4) PART NUMBER	(5) DESCRIPTION AND USABLE ON CODE (UOC)	(6) QTY
GROUP 13 MODE 4 CLOCK CIRCUIT CARD ASSEMBLY AN/GSX-1A A5					
FIG, 14					
1	PAHZZ	81349	JAN1N4148-1	SEMICONDUCTOR DEVIC UOC: EZC	1
2	PAHZZ	81349	M39014/01-1356	CAPACITOR, FIXED, CER UOC: EZC	1
3	PAHZZ	81349	M39014/01-1575	CAPACITOR, FIXED, CER UOC: EZC	9
4	PAHZZ	81349	M39003-01-3076	CAPACITOR, FIXED, ELE UOC: EZC	1
5	PAHZZ	81349	M39003-01-2988	CAPACITOR, FIXED, ELE UOC: EZC	2
6	PAHZZ	81349	CMR04E220J0DR	CAPACITOR, FIXED, MIC UOC: EZC	1
7	PAHZZ	81349	M55302/57A50Y(38 )	CONNECTOR UOC: EZC	1
8	PAHZZ	81349	RCR05G103JS	RESISTOR, FIXED, COMP UOC: EZC	1
9	PAHZZ	81349	RCR05G101JS	RESISTOR, FIXED, COMP UOC: EZC	1
10	PAHZZ	81349	RCR05G106JS	RESISTOR, FIXED, COMP UOC: EZC	1
11	PAHZZ	81349	RCR05G102JS	RESISTOR, FIXED, COMP UOC: EZC	6
12	PAHZZ	81349	M38510/05503BEB	MICROCIRCUIT, DIGITA UOC: EZC	1
13	PAHZZ	81349	M38510/00105BCB	MICROCIRCUIT, DIGITA UOC: EZC	3
14	PAHZZ	81349	M38510/00104BCB	MICROCIRCUIT, DIGITA UOC: EZC	1
15	PAHZZ	81349	M38510/01306BEB	MICROCIRCUIT, DIGITA UOC: EZC	2
16	PAHZZ	81349	M38510/00403BCB	MICROCIRCUIT, DIGITA UOC: EZC	1
17	PAHZZ	81349	M38510/00401BCB	MICROCIRCUIT, DIGITA UOC: EZC	2
18	PAHZZ	81349	M38510/01302BCB	MICROCIRCUIT, DIGITA UOC: EZC	3
19	PAHZZ	81349	M38510/01405BEB	MICROCIRCUIT, DIGITA UOC: EZC	1
20	PAHZZ	01295	SN54S289J	MICROCIRCUIT UOC: EZC	1
21	PAHZZ	81349	M38510/00905BEB	MICROCIRCUIT, DIGITA UOC: EZC	2
22	PAHZZ	81349	M38510/00903BCB	MICROCIRCUIT, DIGITA UOC: EZC	2
23	PAHZZ	81349	M38510/00102BCB	MICROCIRCUIT, DIGITA UOC: EZC	1
24	PAHZZ	81349	M38510/00701BCB	MICROCIRCUIT, DIGITA	1

SECTION II					
(1)	(2)	(3)	TM11-5895-1194-24P-2	(4)	(6)
ITEM	SMR		PART		
NO	CODE	FSCM	NUMBER	DESCRIPTION AND USABLE ON CODE (UOC)	QTY
25	PAHZZ	81349	CR-64/U8.000000M	UOC:EZC CRYSTAL UNIT,QUARTZ	1
26	PAHZZ	07047	10381-DAP	UOC:EZC MOUNTING PAD,ELECTR	1
27	PAHZZ	94222	90-0-6503-11	UOC:EZC HANDLE,DOOR	2
28	PAHZZ	94222	90-0-5858-24	UOC:EZC RIVET,SOLID	2
29	PAHZZ	96906	MS51957-14	UOC:EZC SCREW,MACHINE	2
30	PAHZZ	80205	NAS671C4	UOC:EZC NUT,PLAIN,HEXAGON	2
31	XAHZZ	18876	13143989	UOC:EZC BOARD,PW	1

END OF FIGURE

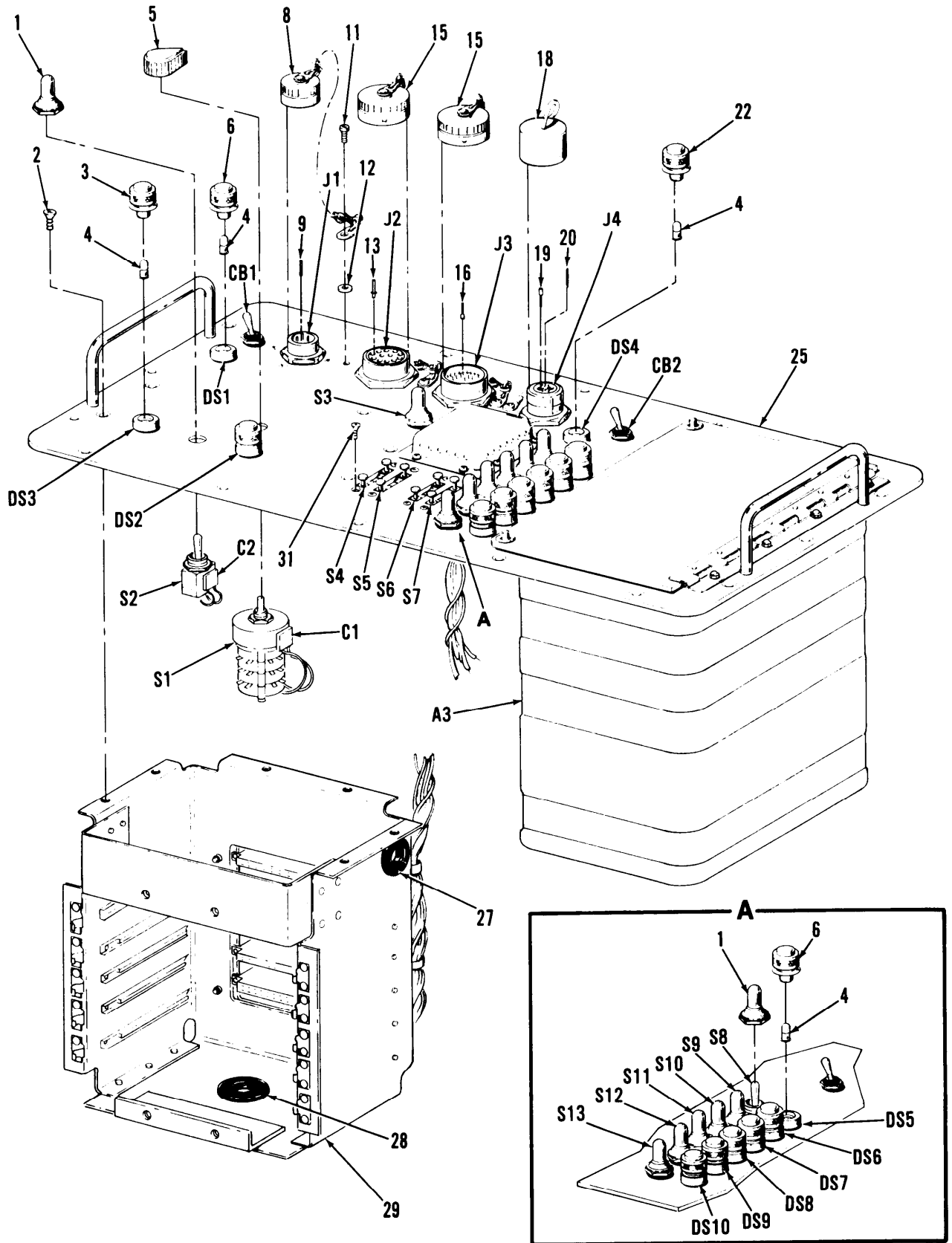

EL9SP015

Figure 15. IFF Programmer Panel Assembly A6 (Sheet 1 of 4)

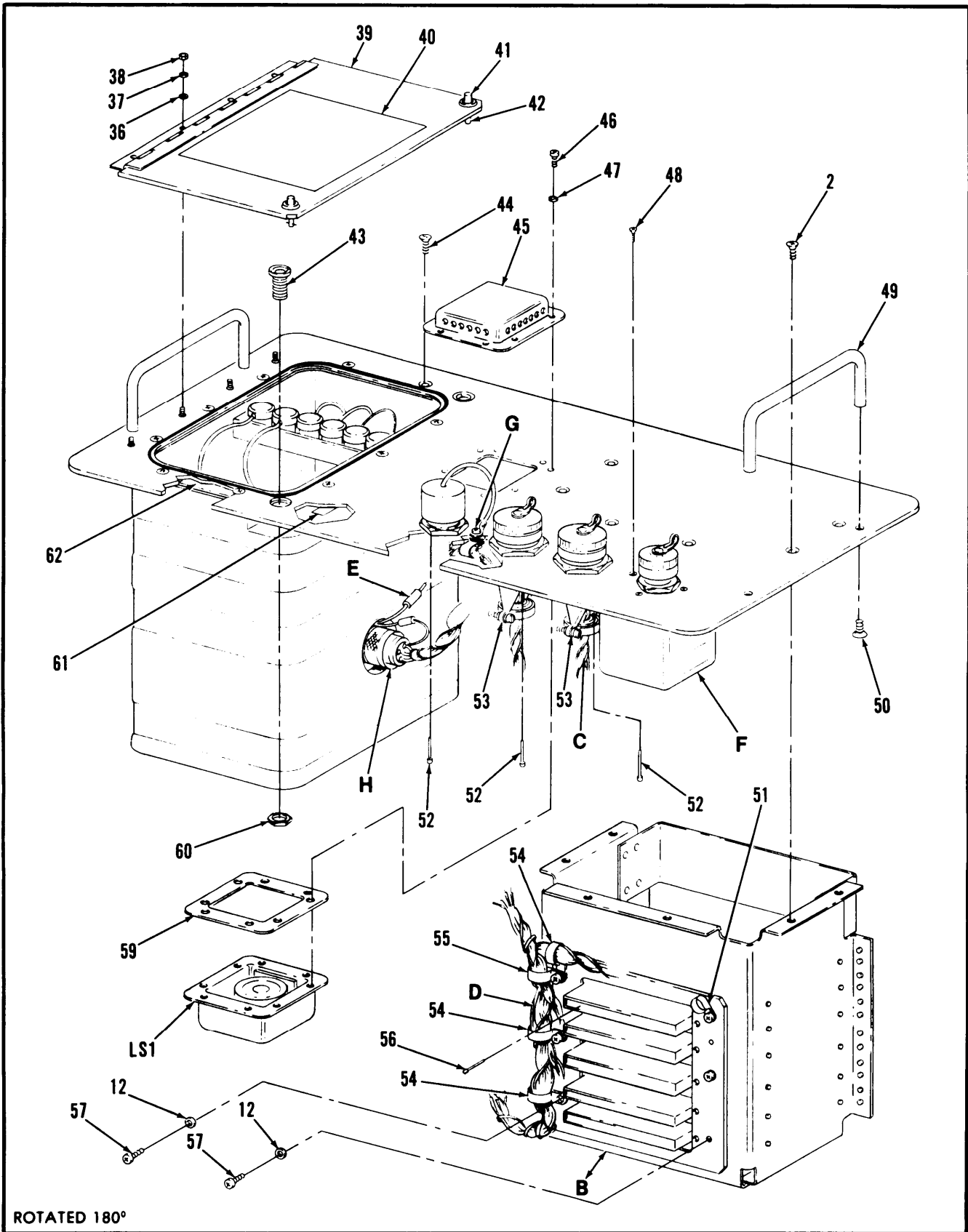
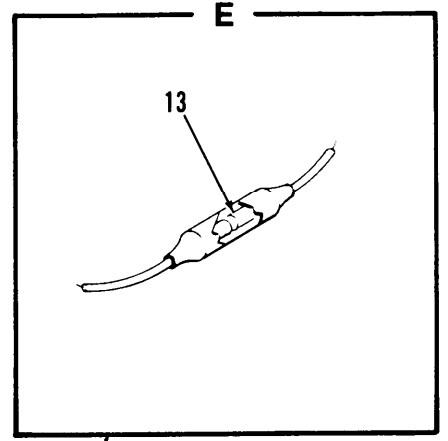
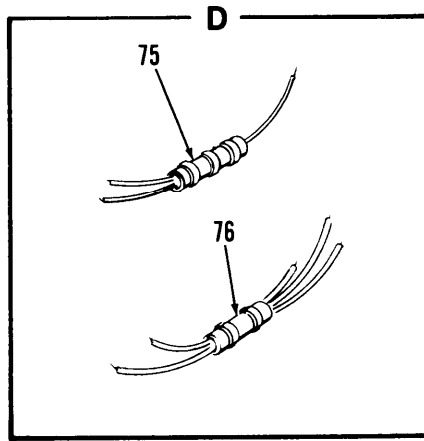
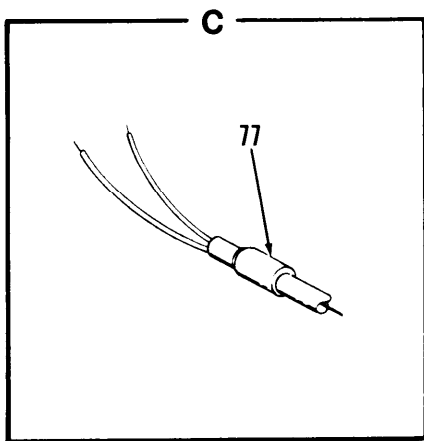
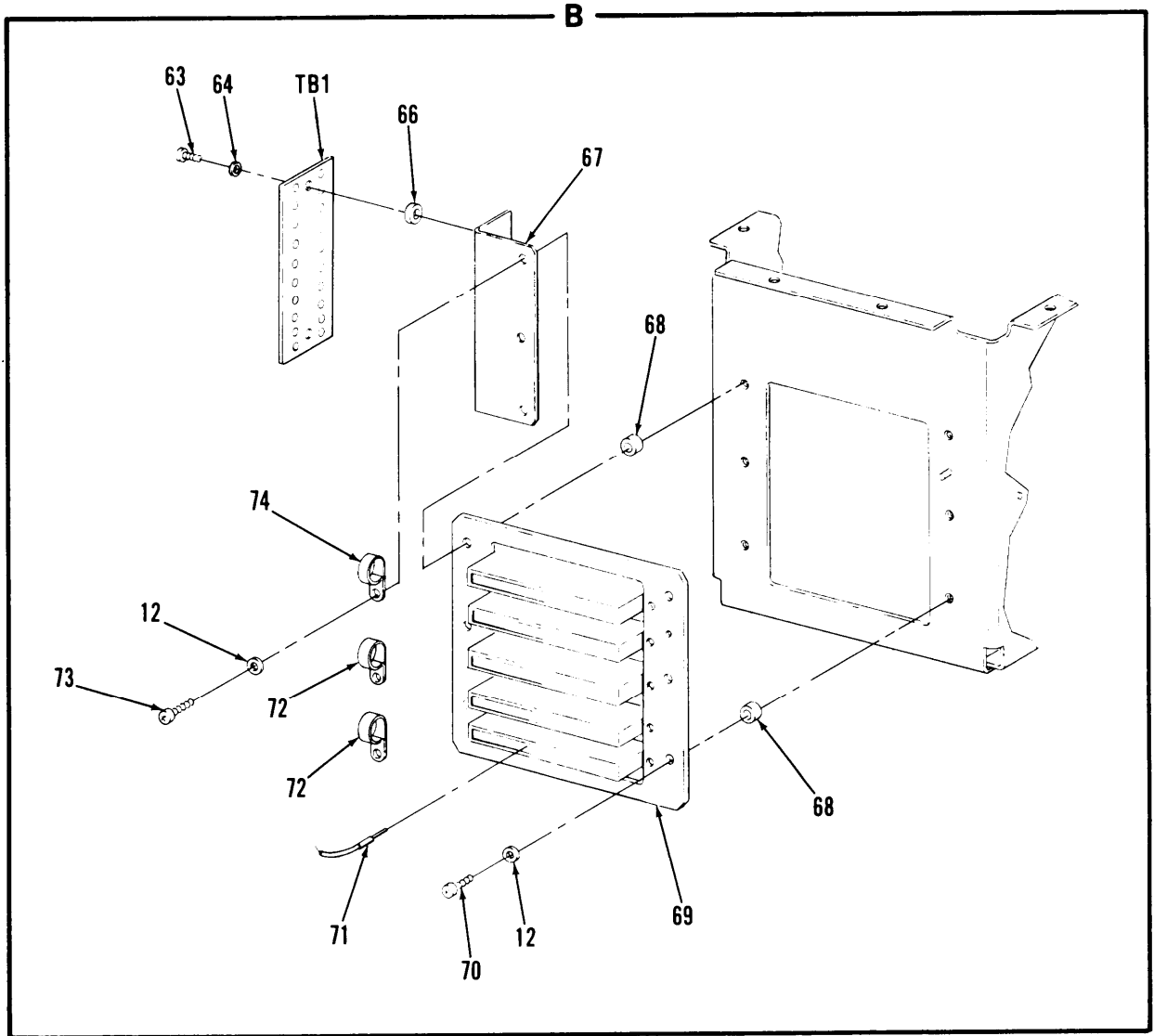

Figure 15. IFF Programmer Panel Assembly A6 (Sheet 2 of 4)

EL9SP016



EL9SP017

Figure 15. IFF Programmer Panel Assembly A6 (Sheet 3 of 4)

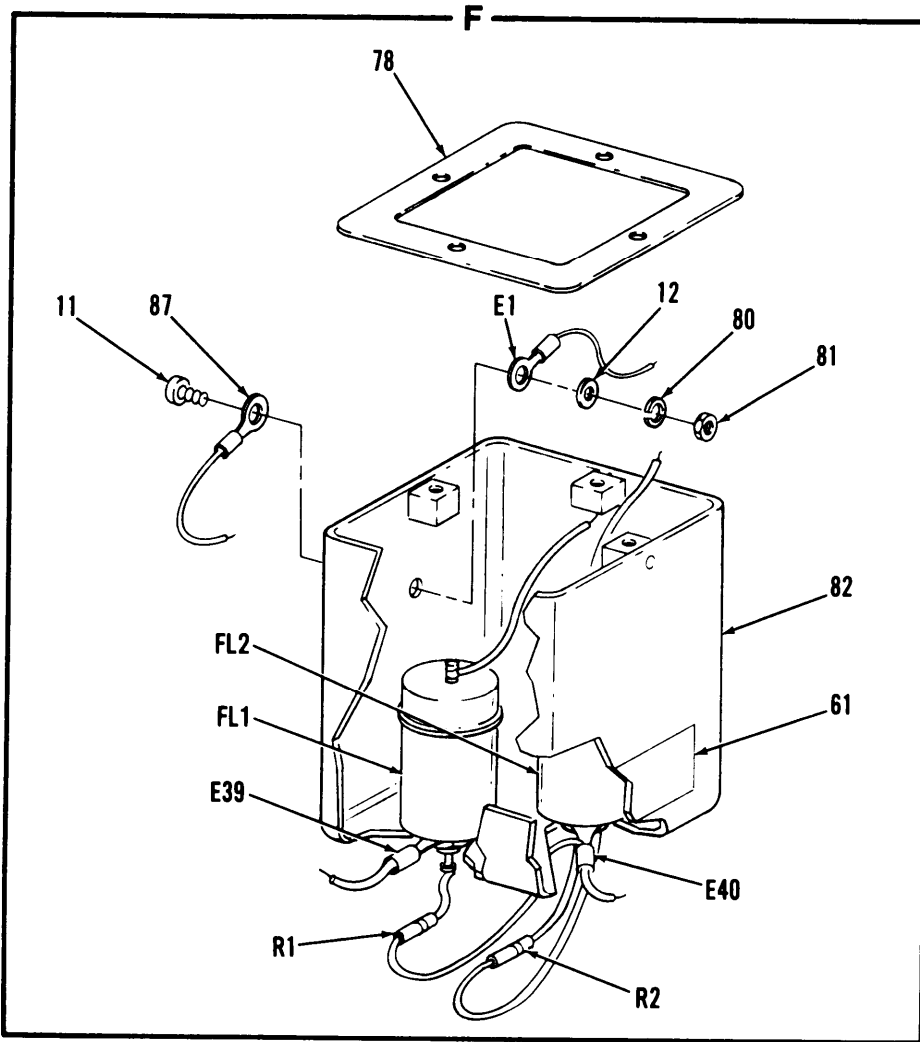

REF DES	ITEM NO.	REF DES	ITEM NO.
A3	26	LS1	58
CB1	7	P1	88
CB2	24	R1	84
C1	32	R2	84
C2	32	S1	33
DS1	23	S2	34
DS2	23	S3	34
DS3	23	S4	30
DS4	23	S5	30
DS5	23	S6	30
DS6	23	S7	30
DS7	23	S8	35
DS8	23	S9	35
DS9	23	S10	35
DS10	23	S11	35
E1	79	S12	35
E39	85	S13	35
E40	83	TB1	65
FL1	86		
FL2	86		
J1	10		
J2	14		
J3	17		
J4	21		

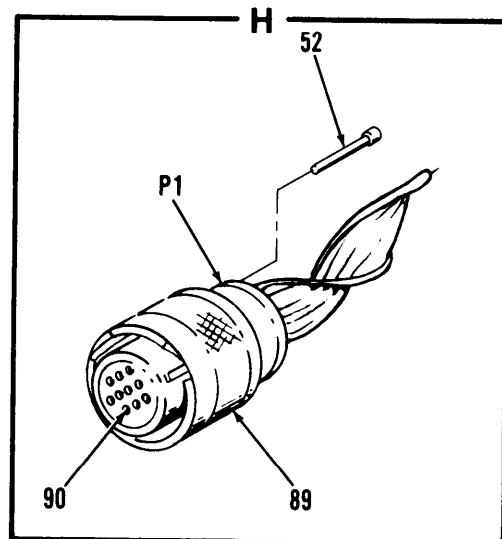
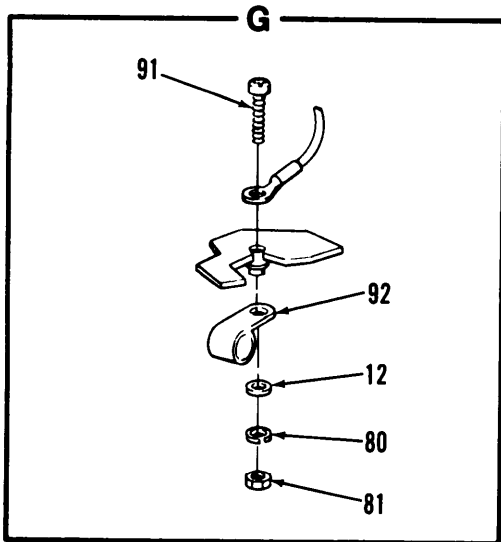

EL9SP018

Figure 15. IFF Programmer Panel Assembly A6 (Sheet 4 of 4)

SECTION II (1) ITEM NO	(2) SMR CODE	(3) FSCM	TM11-5895-1194-24P-2 (4) PART NUMBER	(5) DESCRIPTION AND USABLE ON CODE (UOC)	(6) QTY
GROUP 14 IFF PROGRAMMER ASSEMBLY A6					
FIG, 15					
1	PAHZZ	18876	MIS-23640	BOOT, TGL	8
2	PAHZZ	96906	MS51959-45	SCREW, MACHINE	6
3	PAOZZ	76854	83250-82 WT	LENS, LIGHT	1
4	PAOZZ	96906	MS25237-328	LAMP, INCANDESCENT	10
5	PAHZZ	96906	MS91528-1P4B	KNOB	1
6	PAOZZ	76854	83250-81 WT	LENS, LIGHT	7
7	PAHZZ	81349	M39019/01-248	CIRCUIT BREAKER	1
8	PAHZZ	96906	MS3181-12C	COVER, ELECTRICAL CO	1
9	PAHZZ	81349	M39029/31-228	CONTACT, ELECTRICAL	3
10	PAHZZ	96906	MS3124E12-3PN	CONNECTOR, RECPT	1
10	PAHZZ	96906	MS3124E12-3P	UOC: ELV CONNECTOR, RECEPTACL	1
11	PAHZZ	96906	MS51957-28	UOC: EZC SCREW, MACHINE	4
12	PAHZZ	96906	MS15795-805	WASHER, FLAT	12
13	PAHZZ	81349	M39029/5-115	CONTACT, ELECTRICAL	16
14	PAHZZ	96906	MS3474L18-32S	CONNECTOR, RECEPTACL	1
15	PAHZZ	96906	MS3181-18C	COVER, ELECTRICAL CO	2
16	PAHZZ	81349	M83723-33B20	CONTACT	23
16	PAHZZ	81349	M83723-33B20	CONTACT	3
17	PAHZZ	96906	MS3474L18-32PW	UOC: EZC CONNECTOR, RECEPTACL	1
18	PAHZZ	14283	6200-014-002	COVER, PROTECTIVE	1
19	PAHZZ	81349	M39029-63-368	CONTACT, ELECTRICAL	3
20	PAHZZ	18876	11509930	CONTACT, COAXIAL PIN	2
21	PAHZZ	18876	MIS-23393-007	CONNECTOR SET, ELECT	1
22	PAOZZ	76854	83250-83 WT	LENS, LIGHT	2
23	PAHZZ	87034	08-83283	LIGHT, INDICATOR	10
24	PAHZZ	81349	M39019/01-230	CIRCUIT, BREAKER	1
25	XBHZZ	18876	11509891	PANEL, MACHINED	1
26	XBHLL	18876	13012414	CHARGER ASSY, BAT A6A3	1
27	PAHZZ	96906	MS35489-11	GROMMET, NONMETALLIC	1
28	PAHZZ	96906	MS35489-45	GROMMET, NONMETALLIC	1
29	XBHZZ	18876	11509858	RACK ASSY, CARD	1
30	PAHZZ	81349	M22710/18-046	SWITCH, CODE INDICAT	4
31	PAHZZ	96906	MS51959-4	SCREW, MACHINE	8
32	PAHZZ	81349	M39014-02-1419	CAPACITOR, FIXED, CER	2
33	PAHZZ	81349	M3786/4-5060	SWITCH, ROTARY	1
34	PAHZZ	96906	MS21351-321	SWITCH, TOGGLE	2
35	PAHZZ	96906	MS90310-311	SWITCH, TOGGLE	6
36	PAHZZ	96906	MS15795-803	WASHER, FLAT	4
37	PAHZZ	96906	MS35338-135	UOC: ELV WASHER, LOCK	4
38	PAHZZ	96906	MS35649-244	UOC: ELV NUT, PLAIN, HEXAGON	4
38	PAHZZ	70318	C5947-2	UOC: ELV NUT, PLAIN, CAP	4
				UOC: EZC	

SECTION II		TM11-5895-1194-24P-2				
(1)	(2)	(3)	(4)	(5)	(6)	
ITEM NO	SMR CODE	FSCM	PART NUMBER	DESCRIPTION AND USABLE ON CODE (UOC)	QTY	
39	XBHLL	18876	11509902	COVER, BAT CHG ASSY	1	
40	XBHZZ	18876	11567503	DECAL	1	
41	PAHZZ	71286	15S1-3-1-1AF	STUD, TURN BTN FSTNR	2	
42	PAHZZ	71286	15S11-2AE	PUSH ON NUT	2	
43	PAHZZ	71286	15R1-1AE	RECEPTACLE, TURNLOCK	2	
44	PAHZZ	96906	MS51959-46	SCREW, MACHINE	10	
45	XBHZZ	18876	11509893	COVER, SPEAKER	1	
46	PAHZZ	96906	MS51957-16	SCREW, MACHINE	8	
47	PAHZZ	96906	MS15795-803	WASHER, FLAT	8	
48	PAHZZ	96906	MS51959-15	SCREW, MACHINE	4	
49	PAHZZ	96906	MS39087-4	HANDLE, BOW	2	
50	PAHZZ	96906	MS51960-66	SCREW, MACHINE	4	
51	PAHZZ	15786	81487-4	CLAMP, LOOP UOC: ELV	1	
52	PAHZZ	96906	MS27488-20	PLUG, END SEAL, ELECT	32	
53	PAHZZ	96906	MS3417-18N	CLAMP	2	
54	PAHZZ	18876	10034401-10	CLAMP, LOOP UOC: ELV	3	
55	PAHZZ	18876	10034401-8	CLAMP, LOOP UOC: ELV	1	
56	PAHZZ	96906	MS27488-22	PLUG, END SEAL, ELECT UOC: ELV	86	
57	PAHZZ	96906	MS51957-30	SCREW, MACHINE UOC: ELV	6	
58	XBHLL	18876	11509926	SPEAKER ASSY A6LS1	1	
59	PAHZZ	28817	07-0501-3032	GASKET, PREFORMED	1	
60	PAHZZ	96906	MS25082-21	NUT, PLAIN, HEXAGON	2	
61	XBHZZ	18876	11509933	PLATE, CAUTION	2	
62	PAHZZ	28817	07-0501-3033	GASKET, PREFORMED	1	
63	PAHZZ	96906	MS51957-30	SCREW, MACHINE UOC: EZC	2	
64	PAHZZ	96906	MS15795-805	WASHER, FLAT UOC: EZC	2	
65	XBHZZ	18876	13149903	TERMINAL BOARD UOC: EZC	1	
66	PAHZZ	18876	13143990-2	SPACER UOC: EZC	2	
67	XBHZZ	18876	13149902	BRACKET UOC: EZC	1	
68	PAHZZ	18876	13143990-1	SPACER UOC: EZC	6	
69	XBHLL	18876	11509923	CONN PLATE GSX-1 UOC: ELV	1	
69	XBHLL	18876	13143974	CONN PLATE GSX-1A UOC: EZC	1	
70	PAHZZ	96906	MS51957-32	SCREW, MACHINE UOC: EZC	3	
71	PAHZZ	81349	M55302/65-01	CONTACT, ELECTRICAL UOC: EZC	170	
72	PAHZZ	18876	10034401-8	CLAMP, LOOP UOC: EZC	2	
73	PAHZZ	96906	MS51957-33	SCREW, MACHINE	3	



SECTION II (1) ITEM NO	(2) SMR CODE	(3) FSCM	TM11-5895-1194-24P-2 (4) PART NUMBER	(5) DESCRIPTION AND USABLE ON CODE (UOC)	(6) QTY
74	PAHZZ	18876	10034401-10	UOC: EZC CLAMP, LOOP	1
75	PAHZZ	08795	D-100-00	UOC: EZC SPLICE, SOLDER	35
76	PAHZZ	08795	D-101-00	UOC: ELV SPLICE, SOLDER	1
77	PAHZZ	06090	D-133-06	UOC: ELV SPLICE, CONDUCTOR	8
78	PAHZZ	28817	07-0501-3031	UOC: EZC GASKET, PREFORMED	1
79	PAHZZ	96906	MS25036-101	TERMINAL, LUG	1
80	PAHZZ	96906	MS35338-136	WASHER, LOCK	2
81	PAHZZ	96906	MS35649-264	NUT, PLAIN, HEXAGON	2
82	XBHZZ	18876	11509894	ENCLOSURE, PWR FLTR	1
83	PAHZZ	96906	MS25036-104	TERMINAL, LUG	1
84	PAHZZ	81349	RCR20G105JS	UOC: EZC RESISTOR, FIXED, COMP	2
85	PAHZZ	96906	MS25036-104	UOC: EZC TERMINAL, LUG	1
86	PAHZZ	81349	M15733/27-0013	FILTER, RADIO FREQUE	2
87	PAHZZ	96906	MS25036-101	TERMINAL, LUG	1
88	PAHZZ	96906	MS3476W12-10S	UOC: EZC CONNECTOR, PLUG, ELEC	1
89	PAHZZ	96906	MS3416-12EC	BACKSHELL	1
90	PAHZZ	81349	M39029/5-20-20	CONTACT	9
91	PAHZZ	96906	MS51957-30	SCREW, MACHINE	1
91	PAHZZ	96906	MS51957-31	UOC: ELV SCREW, MACHINE	1
92	PAHZZ	80205	NAS1397P6N	UOC: EZC CLAMP, LOOP	1

END OF FIGURE



REF DES	ITEM NO.
A1	7
A1E1	22
A1E2	21
A1J1	16
A1P1	9
A1P2	9
A1P3	9
A1P4	9
A1P5	9
A1P6	9
A1S1	11
A1S2	10
HR1	25

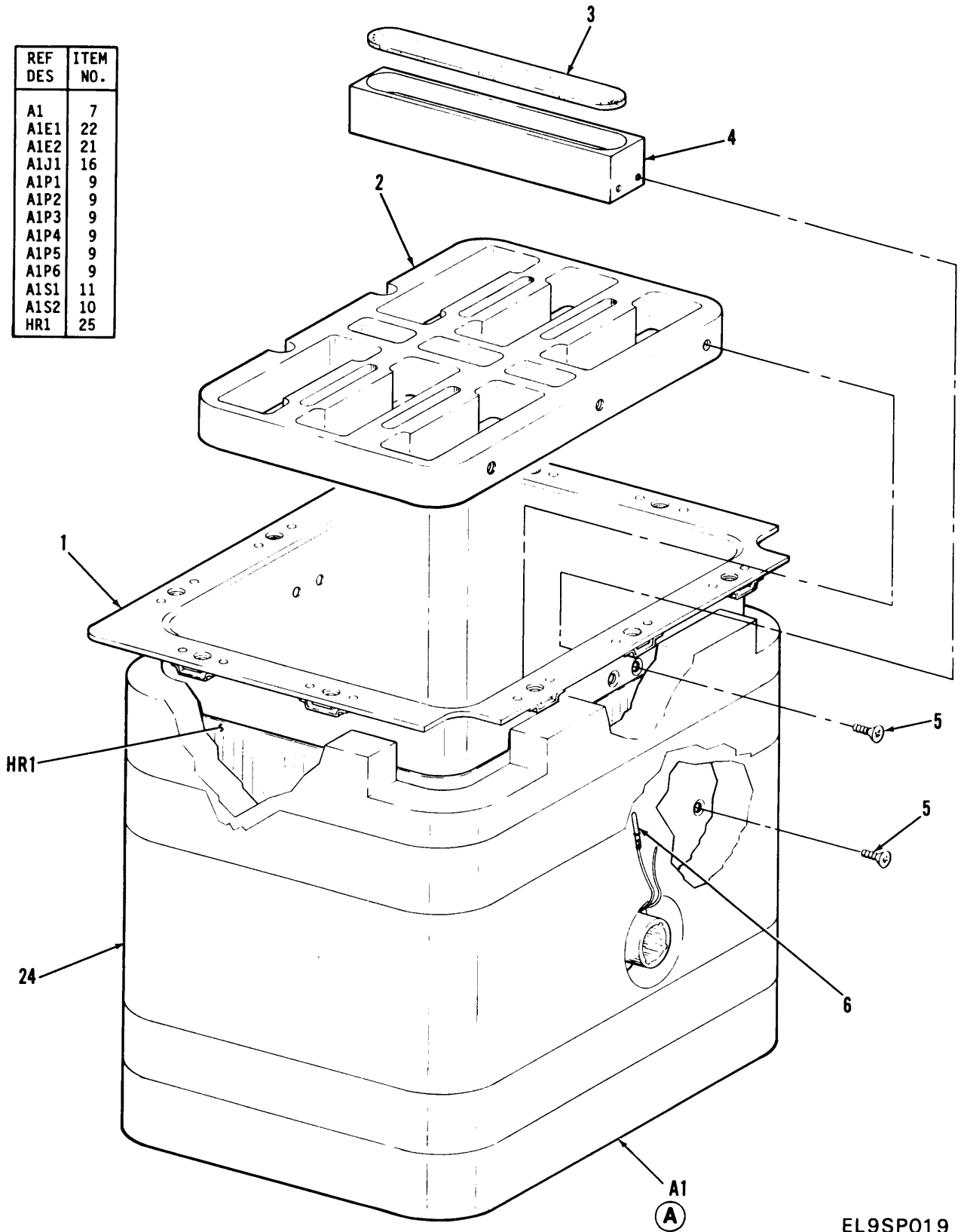

EL9SP019

Figure 16. Battery Charger Assembly A6A3 (Sheet 1 of 2)

A

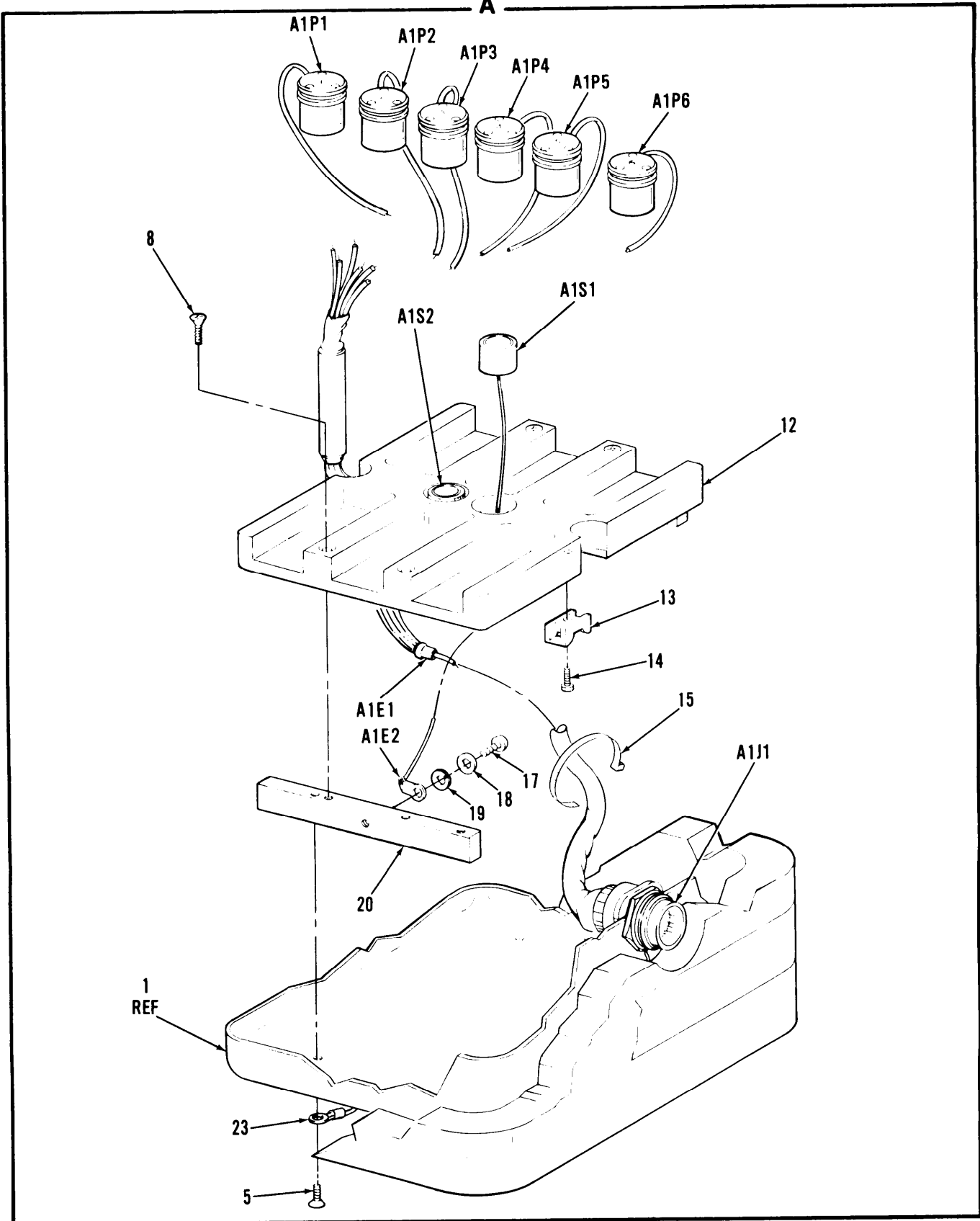

EL9SP020

Figure 16. Battery Charger Assembly A6A3 (Sheet 2 of 2)

SECTION II		TM11-5895-1194-24P-2			
(1)	(2)	(3)	(4)	(5)	(6)
ITEM NO	SMR CODE	FSCM	PART NUMBER	DESCRIPTION AND USABLE ON CODE (UOC)	QTY
GROUP 1401 BATTERY CHARGER ASSEMBLY A6A3					
FIG, 16					
1	XAHZZ	18876	11509889	HOUSING, MACHINED	1
2	XAHZZ	18876	13012416	GUIDE, BATTERY	1
3	XBHZZ	18876	13056559	PAD, CONNECTOR	1
4	XBHZZ	18876	13056558	SUPPORT, STWG CONN	1
5	PAHZZ	96906	MS24693-C24	SCREW, MACHINE	14
6	PAHZZ	81349	M39029/4-20-20	CONTACT	3
7	XAHLL	18876	13012415	SUPPORT ASSY, BASE	1
8	PAHZZ	96906	MS51959-32	SCREW, MACHINE	4
9	PAHZZ	18876	13056561	CONNECTOR ASSY, PIN	6
10	PAHZZ	81349	M24236/1-AKFJJ	SWITCH	1
11	PAHZZ	81349	M24236/1-AGGFK	SWITCH	1
12	XAHZZ	18876	13012421	SUPPORT, MOLDED	1
13	PAHZZ	06383	TM1S4	ANCHOR, STRAP RETAIN	2
14	PAHZZ	96906	MS51957-13	SCREW, MACHINE	2
15	PAHZZ	96906	MS3367-4-9	STRAP, TIEDOWN, ELECT	2
16	PAHZZ	96906	MS3124E12-10PN	CONNECTOR, RECPT	1
17	PAHZZ	96906	MS51957-26	SCREW, MACHINE	1
18	PAHZZ	96906	MS15795-805	WASHER, FLAT	1
19	PAHZZ	96906	MS35338-136	WASHER, LOCK	1
20	XBHZZ	18876	13012422	BAR, SPRT MTG	2
21	PAHZZ	18876	10101367-3	TERMINAL, LUG	1
22	PAHZZ	08795	D-101-00	SPLICE, SOLDER	1
23	PAHZZ	96906	MS25036-102	TERMINAL, LUG	1
24	XBHZZ	18876	11509915	INSULATION, BAT CHG	1
25	PAHZZ	09152	10889	HEATER	1

END OF FIGURE

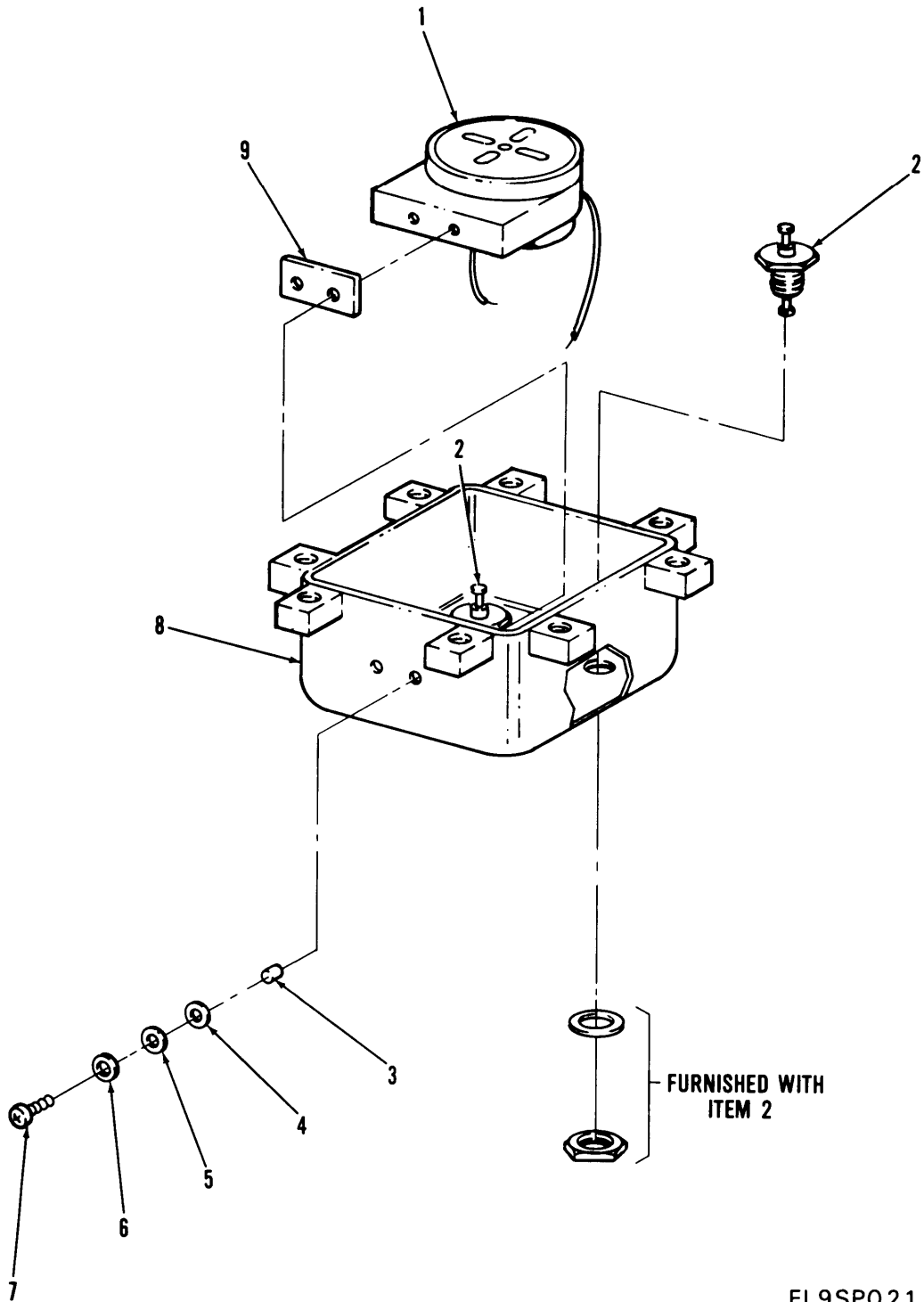

EL9SP021

Figure 17. Speaker Assembly A6LS1

SECTION II		TM11-5895-1194-24P-2			
(1)	(2)	(3)	(4)	(5)	(6)
ITEM NO	SMR CODE	FSCM	PART NUMBER	DESCRIPTION AND USABLE ON CODE (UOC)	QTY
GROUP 1402 SPEAKER ASSEMBLY A6LS1					
FIG, 17					
1	PAHZZ	18876	MIS-23408	LOUDSPEAKER, PERMANENT	1
2	PAHZZ	81349	FT019A01S	TERMINAL	2
3	PAHZZ	08289	TW096-136-100	INSULATOR, BUSHING	2
4	PAHZZ	96906	MS51859-1	WASHER, FLAT	2
5	PAHZZ	96906	MS35338-134	WASHER, LOCK	2
6	PAHZZ	80205	NAS620C3L	WASHER, FLAT	2
7	PAHZZ	96906	MS51957-4	SCREW, MACHINE	2
8	XAHZZ	18876	11509892	ENCLOSURE, SPEAKER	1
9	PAHZZ	18876	11509927	INSULATOR, SPKR	1

END OF FIGURE

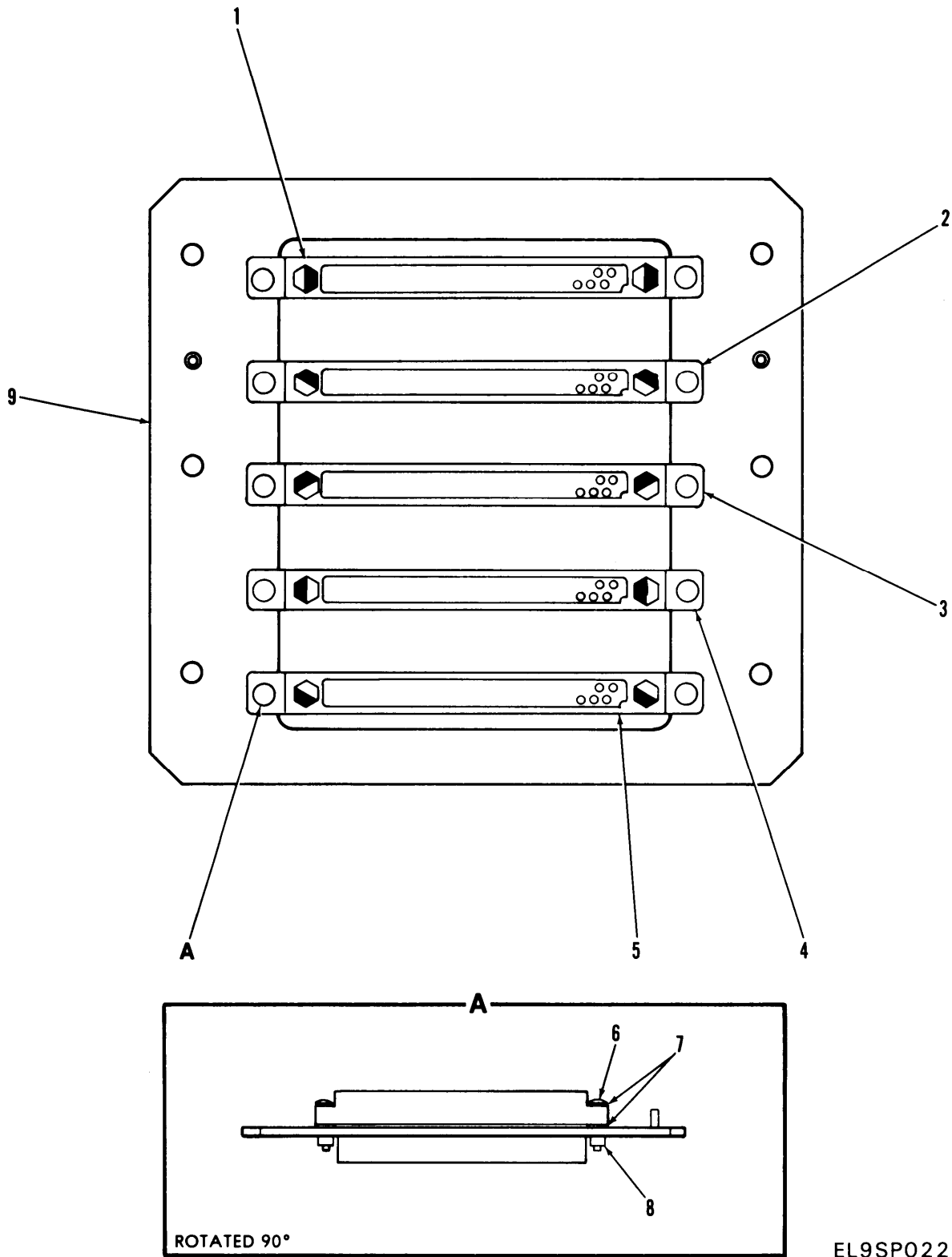

Figure 18. Connector Plate Assembly

EL9SP022



SECTION II		TM11-5895-1194-24P-2			
(1)	(2)	(3)	(4)	(5)	(6)
ITEM NO	SMR CODE	FSCM	PART NUMBER	DESCRIPTION AND USABLE ON CODE (UOC)	QTY
GROUP 1403 CONNECTOR PLATE ASSEMBLY					
FIG, 18					
1	PAHZZ	18876	MIS-21424/9-038	CONNECTOR UOC: ELV	1
1	PAHZZ	81349	M55302/65-50Y(33)	CONNECTOR UOC: EZC	1
2	PAHZZ	18876	MIS-21424/9-039	CONNECTOR UOC: ELV	1
2	PAHZZ	81349	M55302/65-50Y(34)	CONNECTOR UOC: EZC	1
3	PAHZZ	18876	MIS-21424/9-040	CONNECTOR UOC: ELV	1
3	PAHZZ	81349	M55302/65-50Y(35)	CONNECTOR UOC: EZC	1
4	PAHZZ	18876	MIS-21424/9-041	CONNECTOR UOC: ELV	1
4	PAHZZ	81349	M55302/65-50Y(36)	CONNECTOR UOC: EZC	1
5	PAHZZ	18876	MIS-21424/9-042	CONNECTOR UOC: ELV	1
5	PAHZZ	81349	M55302/65-50Y(38)	CONNECTOR UOC: EZC	1
6	PAHZZ	96906	MS16535A161	RIVET UOC: ELV	10
6	PAHZZ	96906	MS51957-18	SCREW, MACHINE UOC: EZC	10
7	PAHZZ	80205	NAS620C4	WASHER, FLAT UOC: EZC	20
8	PAHZZ	10400	WTFF125	BUSHING UOC: EZC	10
9	XAHZZ	18876	11509924	PLATE, CONN UOC: ELV	1
9	XAHZZ	18876	13143973	PLATE, CONNECTOR UOC: EZC	1

END OF FIGURE



## NATIONAL STOCK NUMBER AND PART NUMBER INDEX

STOCK NUMBER	NATIONAL STOCK NUMBER INDEX		STOCK NUMBER	FIG.	ITEM
	FIG.	ITEM			
5910-00-007-3974	5	4	5935-00-089-1145	15	15
	6	4	5910-00-098-8670	8	6
5910-00-010-8159	7	7		12	3
	8	5	5910-00-098-9237	7	8
	9	3	5910-00-098-9277	12	7
	10	3	5961-00-104-1399	5	28
	11	6	5905-00-104-5756	15	84
	12	5	5961-00-105-5734	7	33
	13	5		8	32
	14	5	5910-00-114-0510	5	5
5910-00-010-8666	7	3		6	5
	8	2		7	2
	12	2		8	1
5910-00-010-8721	15	32		11	2
5355-00-020-3511	15	5	5910-00-124-0618	13	2
5961-00-022-5666	5	7		14	2
	6	9	5910-00-124-0659	6	6
5962-00-024-0653	12	23		7	5
5310-00-045-4007	5	35		8	3
5305-00-051-0227	1	13		9	2
5305-00-054-5638	17	7		10	2
5305-00-054-5647	16	14		11	5
5305-00-054-5648	6	41		12	4
	8	35		13	3
	10	20		14	3
	12	33	5955-00-138-3418	13	23
	14	29		14	25
5305-00-054-5650	15	46	5905-00-141-0743	5	10
5305-00-054-5652	18	6		6	12
5305-00-054-6650	16	17	5910-00-144-4381	5	3
5305-00-054-6652	15	11		6	3
5305-00-054-6654	6	35		7	4
	15	57	5930-00-147-7632	15	33
	15	63	6240-00-155-7857	1	4
	15	91		15	4
5305-00-054-6655	15	91	5910-00-156-5999	7	9
5305-00-054-6656	1	29		9	4
	15	70		10	4
5305-00-054-6657	15	73	5940-00-168-3401	4	22
5305-00-054-6658	1	29		15	77
5305-00-054-6669	1	7	5999-00-172-8253	4	8
	4	14		15	13
5310-00-057-0573	18	7	5962-00-173-9776	9	12
5970-00-057-3545	2	6		10	12
	4	4		11	17
5325-00-065-5952	15	43		12	20
5305-00-066-7326	16	5		13	20
5999-00-067-8663	3	3		14	22
5305-00-071-1323	1	6	5905-00-177-7486	7	12
	15	50		8	13

## NATIONAL STOCK NUMBER AND PART NUMBER INDEX

STOCK NUMBER	NATIONAL STOCK NUMBER INDEX		STOCK NUMBER	FIG.	ITEM	
	FIG.	ITEM				
5905-00-180-8301	7	22	5962-00-365-5728	10	16	
	13	7		11	25	
	14	9		12	29	
5905-00-180-8303	7	21		13	16	
	8	20		14	18	
5961-00-199-5030	5	6	5962-00-369-7607	7	25	
	6	8		8	22	
5940-00-204-8966	1	26		9	14	
	1	27		10	14	
	16	23		11	22	
5310-00-208-3786	6	42		12	26	
	8	36		13	15	
	10	21		14	17	
	12	34		13	13	
	14	30		14	15	
				5962-00-369-7641	11	22
5935-00-235-8970	4	13	5962-00-369-9839	11	21	
	15	19		12	25	
5999-00-239-3338	5	14	5962-00-390-7958	7	29	
	6	16		8	27	
	11	14		9	18	
	12	16		11	16	
				5962-00-390-7970	7	28
	5910-00-254-8169	8		7		8
5905-00-255-3699	6	26		8	25	
	15	28		11	15	
5325-00-285-8363	15	27	5905-00-401-7424	5	16	
	15	27		6	18	
5962-00-318-2223	7	26		7	17	
	8	23		8	16	
	9	10		8	16	
	10	10		5	21	
	12	19		6	23	
	13	12		7	14	
	14	14		8	17	
				5905-00-401-7426	11	9
					7	18
					8	18
5962-00-341-0544	11	20	5905-00-401-7427	12	14	
	12	24		5	18	
	13	11		8	18	
	14	13		12	14	
5962-00-348-2715	9	17	5905-00-401-7431	5	18	
	10	17		6	20	
	11	26		15	23	
	12	30		5	20	
	13	21		6	22	
	14	23		5	23	
				5905-00-409-3415	6	25
5935-00-351-5944	15	56		5	22	
5962-00-361-8648	13	22	5905-00-411-1851	5	22	
	14	24		6	24	
5962-00-361-8732	7	30	5905-00-412-0760	7	15	
	8	26		11	10	
	9	15		12	13	
	10	15		5	1	
5962-00-365-5728	9	16	5961-00-422-3722	5	1	
				6	1	

## NATIONAL STOCK NUMBER AND PART NUMBER INDEX

STOCK NUMBER	NATIONAL STOCK NUMBER INDEX		STOCK NUMBER	FIG.	ITEM		
	FIG.	ITEM					
5320-00-424-3743	5	41	5961-00-494-4915	9	1		
	7	38		11	1		
	9	23		13	1		
	11	31		5910-00-495-0042	7	6	
	13	28			8	4	
5962-00-428-7318	9	13	5935-00-496-7171	13	4		
	10	13		14	4		
	13	14		2	13		
	14	16		4	12		
5962-00-428-8070	5	25	4	20			
5962-00-430-2641	13	17	15	52			
	14	19	5940-00-504-4703	15	83		
5999-00-432-9512	4	9		15	85		
5935-00-432-9520	4	11	5961-00-584-4527	6	2		
5935-00-448-9223	15	14		10	1		
5905-00-458-9346	7	19	5310-00-595-6211	12	1		
	8	19		15	36		
5905-00-458-9500	6	27	5310-00-616-2973	15	47		
	7	13		15	60		
	8	14		6	38		
	9	8		5905-00-617-5091	5	19	
	10	9			6	21	
	11	13		7	16		
	12	15		8	15		
	13	9		5310-00-631-1294	5	36	
	14	11			5	31	
	5905-00-465-0337	5		9	5940-00-636-7892	6	33
		6		11		16	21
		7		20		15	35
	5905-00-466-1217	12		17	5930-00-682-0757	17	4
	5905-00-468-2937	11		8	5310-00-716-5618	1	28
	5905-00-470-0369	12		10	5310-00-722-5998	6	36
9		7	15	12			
5905-00-470-9481	10	8	5975-00-727-5153	15	64		
	11	12		16	18		
	12	12		16	15		
5999-00-472-3494	13	24	5320-00-734-4603	5	38		
	14	26		6	40		
5970-00-476-7827	17	3	7	36			
5905-00-479-6658	9	6	8	34			
	10	7	9	21			
	11	11	10	19			
	12	11	11	29			
	5905-00-483-0407	13	8	12	32		
		14	10	13	26		
5905-00-489-7703	5	17	14	28			
	6	19	5905-00-761-5758	7	23		
	9	9		16	8		
5961-00-494-4915	5	2	5305-00-764-0064	15	2		
	7	1	5305-00-764-0068	1	19		
				5305-00-764-0070			

## NATIONAL STOCK NUMBER AND PART NUMBER INDEX

STOCK NUMBER	NATIONAL STOCK NUMBER INDEX		STOCK NUMBER	FIG.	ITEM
	FIG.	ITEM			
5305-00-764-0070	15	44	5310-00-990-1754	15	38
5305-00-764-2964	15	31	5935-01-005-3579	3	4
5305-00-770-2579	15	48	5999-01-010-7034	2	12
5340-00-782-8737	1	31	5930-01-014-5949	15	34
	15	51	1220-01-018-9976	18	8
5340-00-794-2490	5	37	1430-01-019-7873	16	13
	6	39	5962-01-022-6717	7	24
	7	35		8	21
	8	33		13	10
	9	20		14	12
	10	18	5962-01-024-5758	13	19
	11	28		14	21
	12	31	5915-01-029-6471	15	86
	13	25	5962-01-034-2146	11	18
	14	27		12	21
5940-00-813-0698	15	79	5935-01-035-0998	15	17
	15	87	5905-01-035-5065	7	11
5340-00-815-2538	15	55		8	12
	15	72		13	6
5935-00-838-3695	15	10		14	8
5340-00-840-0954	15	49	5925-01-037-3324	15	7
5961-00-858-3826	5	8	5961-01-038-6918	14	1
	6	10	5925-01-041-9943	15	24
	7	10	5895-01-044-0343	1	25
	8	11	5999-01-045-3132	4	7
	9	5	6210-01-046-5548	15	3
	10	6	6210-01-046-5549	15	22
	11	7	6210-01-046-5550	15	6
	12	9	5910-01-048-9185	11	3
5310-00-880-5978	1	9	5910-01-049-5677	14	6
5305-00-889-3000	5	33	5962-01-058-7937	8	30
4820-00-898-3003	1	2	5961-01-067-9799	5	30
5935-00-904-4469	15	8		6	32
5310-00-928-2690	17	5	5962-01-076-7882	12	28
5310-00-929-6395	1	30	5935-01-076-9451	15	88
	6	37	5962-01-077-8819	8	31
	15	80		12	18
	16	19	5961-01-105-2031	5	29
5310-00-933-8118	15	37		6	31
5310-00-934-9748	15	38	5935-01-111-7777	2	4
5310-00-934-9761	1	32	5999-01-125-6411	15	71
	15	81	5999-01-130-8571	4	21
5310-00-942-5139	15	42	5999-01-130-9630	15	9
5310-00-951-4679	2	9	5930-01-139-1030	15	30
	4	2	5340-01-189-0191	15	54
5340-00-964-2555	1	31		15	74
	15	92	6685-01-189-2377	1	12
5310-00-970-4841	17	6	5965-01-190-6831	17	1
5310-00-983-8483	5	34	5935-01-190-7058	15	21
5935-00-988-3541	2	11			

## NATIONAL STOCK NUMBER AND PART NUMBER INDEX

FSCM	PART NUMBER	PART NUMBER INDEX STOCK NUMBER	FIG.	ITEM
08289	BBT066-62		5	32
			6	34
29593	B11752		7	37
			9	22
			11	30
			13	27
81349	CCR75CG201FR		8	8
81349	CCR75CG511FM		8	9
			12	6
81349	CMR04E220J0DR	5910-01-049-5677	14	6
81349	CMR04F121F0DP		11	4
81349	CMR04F271G0CR	5910-01-048-9185	11	3
81349	CR-64/U8.000000M HZ	5955-00-138-3418	13	23
			14	25
70318	C5947-2	5310-00-990-1754	15	38
08795	D-100-00		15	75
08795	D-101-00		15	76
			16	22
06090	D-133-06	5940-00-168-3401	4	22
			15	77
98376	D40825		1	1
81349	FT019A01S		17	2
06324	G63113		4	19
06324	G63114		2	3
06324	G63120		2	10
81349	JANTX1N3611	5961-00-422-3722	5	1
			6	1
81349	JANTX1N4148	5961-00-494-4915	5	2
			7	1
			9	1
			11	1
			13	1
81349	JANTX1N4148-1	5961-00-584-4527	6	2
			10	1
			12	1
81349	JANTX1N5637A	5961-01-105-2031	5	29
			6	31
81349	JANTX1N5907	5961-01-067-9799	5	30
			6	32
81349	JANTX1N753A	5961-00-104-1399	5	28
81349	JANTX1N756A	5961-00-105-5734	7	33
			8	32
81349	JANTX2N2222A	5961-00-858-3826	5	8
			6	10
			7	10
			8	11
			9	5
			10	6
			11	7
			12	9

## NATIONAL STOCK NUMBER AND PART NUMBER INDEX

FSCM	PART NUMBER	PART NUMBER INDEX	
		STOCK NUMBER	FIG. ITEM
81349	JANTX2N2907A	5961-00-022-5666	5 7 6 9
81349	JANTX2N3741	5961-00-199-5030	5 6 6 8
81349	JAN1N4148-1	5961-01-038-6918	14 1
81349	JM38510-05503BEA	5962-01-022-6717	7 24 8 21 13 10 5 42
18876	MIS-21424/10-001		7 39
18876	MIS-21424/10-008		9 24
18876	MIS-21424/10-015		11 32
18876	MIS-21424/10-022		13 29
18876	MIS-21424/10-029		18 1
18876	MIS-21424/9-038		18 2
18876	MIS-21424/9-039		18 3
18876	MIS-21424/9-040		18 4
18876	MIS-21424/9-041		18 5
18876	MIS-21424/9-042		5 27 6 30
18876	MIS-21440-001		15 21
18876	MIS-23393-007	5935-01-190-7058	17 1
18876	MIS-23408	5965-01-190-6831	1 12
18876	MIS-23638	6685-01-189-2377	13 18
18876	MIS-23639		15 1
18876	MIS-23640		2 2
18876	MIS-23641		7 27 8 24
18876	MIS-23642		7 31 8 28
18876	MIS-23643		11 24
18876	MIS-23645		15 36
96906	MS15795-803	5310-00-595-6211	15 47 1 28 6 36 15 12 15 64 16 18
96906	MS15795-805	5310-00-722-5998	1 9 1 14 5 41 7 38 9 23 11 31 13 28 18 6
96906	MS15795-807	5310-00-880-5978	1 9
96906	MS15795-808		1 14
96906	MS16535-141	5320-00-424-3743	5 41 7 38 9 23 11 31 13 28 18 6
96906	MS16535A161		4 3
96906	MS21104-D10		2 7
96906	MS21104-D8		15 34
96906	MS21351-321	5930-01-014-5949	16 5
96906	MS24693-C24	5305-00-066-7326	16 5
96906	MS24693-C272	5305-00-051-0227	1 13



## NATIONAL STOCK NUMBER AND PART NUMBER INDEX

FSCM	PART NUMBER	PART NUMBER INDEX		FIG.	ITEM
		STOCK NUMBER			
96906	MS25036-101	5940-00-813-0698		15	79
				15	87
96906	MS25036-102	5940-00-204-8966		1	26
				1	27
				16	23
96906	MS25036-104	5940-00-504-4703		15	83
				15	85
96906	MS25082-21	5310-00-616-2973		15	60
96906	MS25237-328	6240-00-155-7857		1	4
				15	4
96906	MS27183-3	5310-00-951-4679		2	9
				4	2
96906	MS27183-5	5310-00-983-8483		5	34
96906	MS27488-16	5935-00-235-8970		4	13
96906	MS27488-20	5935-00-496-7171		2	13
				4	12
				4	20
				15	52
96906	MS27488-22	5935-00-351-5944		15	56
96906	MS3109-02AC			2	5
				4	15
96906	MS3124E12-10PN			16	16
96906	MS3124E12-3P	5935-00-838-3695		15	10
96906	MS3124E12-3PN			15	10
96906	MS3126E18-32PN			4	17
96906	MS3126E18-32SW	5935-00-988-3541		2	11
96906	MS3126F12-3SN			3	2
96906	MS3161-12	5935-01-111-7777		2	4
96906	MS3161-14			4	18
96906	MS3181-12C	5935-00-904-4469		15	8
96906	MS3181-18C	5935-00-089-1145		15	15
96906	MS3193-16-16A	5999-00-067-8663		3	3
96906	MS3193-20-20A	5999-01-010-7034		2	12
96906	MS3367-4-9	5975-00-727-5153		16	15
96906	MS3416-12EC			15	89
96906	MS3417-18N			15	53
96906	MS3474L18-32PW	5935-01-035-0998		15	17
96906	MS3474L18-32S	5935-00-448-9223		15	14
96906	MS3476W12-10S	5935-01-076-9451		15	88
96906	MS35206-230	5305-00-889-3000		5	33
96906	MS35338-134	5310-00-928-2690		17	5
96906	MS35338-135	5310-00-933-8118		15	37
96906	MS35338-136	5310-00-929-6395		1	30
				6	37
				15	80
				16	19
96906	MS35338-137			1	8
96906	MS35338-41	5310-00-045-4007		5	35
96906	MS35489-11	5325-00-291-9366		15	27
96906	MS35489-45	5325-00-285-8363		15	28
96906	MS35649-244	5310-00-934-9748		15	38

## NATIONAL STOCK NUMBER AND PART NUMBER INDEX

FSCM	PART NUMBER	PART NUMBER INDEX		FIG.	ITEM
		STOCK NUMBER			
96906	MS35649-264	5310-00-934-9761		1	32
				15	81
96906	MS39087-4	5340-00-840-0954		15	49
96906	MS51859-1	5310-00-716-5618		17	4
96906	MS51957-13	5305-00-054-5647		16	14
96906	MS51957-14	5305-00-054-5648		6	41
				8	35
				10	20
				12	33
				14	29
96906	MS51957-16	5305-00-054-5650		15	46
96906	MS51957-18	5305-00-054-5652		18	6
96906	MS51957-26	5305-00-054-6650		16	17
96906	MS51957-28	5305-00-054-6652		15	11
96906	MS51957-30	5305-00-054-6654		6	35
				15	57
				15	63
				15	91
96906	MS51957-31	5305-00-054-6655		15	91
96906	MS51957-32	5305-00-054-6656		1	29
				15	70
96906	MS51957-33	5305-00-054-6657		15	73
96906	MS51957-34	5305-00-054-6658		1	29
96906	MS51957-4	5305-00-054-5638		17	7
96906	MS51957-44	5305-00-054-6669		1	7
				4	14
96906	MS51959-15	5305-00-770-2579		15	48
96906	MS51959-32	5305-00-764-0064		16	8
96906	MS51959-4	5305-00-764-2964		15	31
96906	MS51959-45	5305-00-764-0068		15	2
96906	MS51959-46	5305-00-764-0070		1	19
				15	44
96906	MS51960-66	5305-00-071-1323		1	6
				15	50
96906	MS90310-311	5930-00-682-0757		15	35
96906	MS91528-1P4B	5355-00-020-3511		15	5
81349	M15733/27-0013	5915-01-029-6471		15	86
81349	M22710/18-046	5930-01-139-1030		15	30
81349	M23053/5-108-4			3	1
81349	M23053/5-109-4	5970-00-057-3545		2	6
				4	4
81349	M24236/1-AGGFK			16	11
81349	M24236/1-AKFJJ			16	10
81349	M24243/6-C402H			2	8
				4	1
81349	M3786/4-5060	5930-00-147-7632		15	33
81349	M38510/00102BCB	5962-00-348-2715		9	17
				10	17
				11	26
				12	30
				13	21

## NATIONAL STOCK NUMBER AND PART NUMBER INDEX

FSCM	PART NUMBER	PART NUMBER INDEX STOCK NUMBER	FIG.	ITEM
81349	M38510/00102BCB	5962-00-348-2715	14	23
81349	M38510/00103BCB		5	26
			6	29
			9	11
			10	11
			11	23
			12	27
81349	M38510/00104BCB	5962-00-318-2223	7	26
			8	23
			9	10
			10	10
			12	19
			13	12
			14	14
81349	M38510/00105BCB	5962-00-341-0544	11	20
			12	24
			13	11
			14	13
81349	M38510/00205BCB		7	32
			8	29
			11	19
			12	22
81349	M38510/00302BCB	5962-00-024-0653	12	23
81349	M38510/00401BCB	5962-00-369-7607	7	25
			8	22
			9	14
			10	14
			11	22
			12	26
			13	15
			14	17
81349	M38510/00403BCB	5962-00-428-7318	9	13
			10	13
			13	14
			14	16
81349	M38510/00701BCB	5962-00-361-8648	13	22
			14	24
81349	M38510/00801BCB	5962-00-361-8732	7	30
			8	26
			9	15
			10	15
81349	M38510/00803BCB	5962-00-369-9839	11	21
			12	25
81349	M38510/00903BCB	5962-00-173-9776	9	12
			10	12
			11	17
			12	20
			13	20
			14	22
81349	M38510/00905BEB	5962-01-024-5758	13	19
			14	21

## NATIONAL STOCK NUMBER AND PART NUMBER INDEX

FSCM	PART NUMBER	PART NUMBER INDEX		FIG.	ITEM			
		STOCK NUMBER						
81349	M38510/01302BCB	5962-00-365-5728		9	16			
				10	16			
				11	25			
				12	29			
				13	16			
				14	18			
			81349	M38510/01306BEB	5962-00-369-7641		13	13
							14	15
			81349	M38510/01405BEB	5962-00-430-2641		13	17
							14	19
			81349	M38510/02004BCB	5962-00-390-7958		7	29
							8	27
							9	18
							11	16
81349	M38510/02005BCB	5962-00-390-7970					7	28
							8	25
81349	M38510/05503BEB	5962-01-022-6717		11	15			
				14	12			
81349	M38510/08101BCB	5962-01-034-2146		11	18			
				12	21			
81349	M38510/10301BGB	5962-00-428-8070		5	25			
81349	M38510/10304BGB			6	28			
81349	M38510/10901BCB	5962-01-058-7937		8	30			
81349	M39003-01-2988	5910-00-010-8159		7	7			
				8	5			
				9	3			
				10	3			
				11	6			
				12	5			
				13	5			
				14	5			
			81349	M39003-01-2991	5910-00-007-3974		5	4
							6	4
			81349	M39003-01-3024	5910-00-144-4381		5	3
							6	3
							7	4
							8	7
81349	M39003-01-3073	5910-00-254-8169		7	7			
81349	M39003-01-3076	5910-00-495-0042		7	6			
				8	4			
				13	4			
				14	4			
			81349	M39014-01-1581	5910-00-114-0510		5	5
							6	5
81349	M39014-02-1419	5910-00-010-8721		15	32			
81349	M39014/01-1348	5910-00-156-5999		7	9			
				9	4			
				10	4			
				13	2			
81349	M39014/01-1356	5910-00-124-0618		14	2			
81349	M39014/01-1357	5910-00-010-8666		7	3			
				8	2			

## NATIONAL STOCK NUMBER AND PART NUMBER INDEX

FSCM	PART NUMBER	PART NUMBER INDEX	
		STOCK NUMBER	FIG. ITEM
81349	M39014/01-1357	5910-00-010-8666	12 2
81349	M39014/01-1565	5910-00-098-9237	7 8
81349	M39014/01-1575	5910-00-124-0659	6 6
			7 5
			8 3
			9 2
			10 2
			11 5
			12 4
			13 3
			14 3
81349	M39014/01-1578	5910-00-098-8670	8 6
			12 3
81349	M39014/01-1581	5910-00-114-0510	7 2
			8 1
			11 2
81349	M39014/02-1354	5910-00-098-9277	12 7
81349	M39019/01-230	5925-01-041-9943	15 24
81349	M39019/01-248	5925-01-037-3324	15 7
81349	M39029-5-16-16	5999-01-045-3132	4 7
81349	M39029-63-368	5999-00-239-3338	15 19
81349	M39029/31-223	5999-01-130-8571	4 21
81349	M39029/31-228	5999-01-130-9630	15 9
81349	M39029/4-20-20		16 6
81349	M39029/5-115	5999-00-172-8253	4 8
			15 13
81349	M39029/5-20-20		15 90
81349	M55302/57A50Y(33 )		6 7
81349	M55302/57A50Y(34 )		8 10
81349	M55302/57A50Y(35 )		10 5
81349	M55302/57A50Y(36 )		12 8
81349	M55302/57A50Y(38 )		14 7
81349	M55302/65-01	5999-01-125-6411	15 71
81349	M55302/65-50Y(33 )		18 1
81349	M55302/65-50Y(34 )		18 2
81349	M55302/65-50Y(35 )		18 3
81349	M55302/65-50Y(36 )		18 4
81349	M55302/65-50Y(38 )		18 5
81349	M83723-33B20		15 16
			15 16
80205	NAS1397P6N	5340-00-964-2555	1 31

## NATIONAL STOCK NUMBER AND PART NUMBER INDEX

FSCM	PART NUMBER	PART NUMBER INDEX		FIG.	ITEM
		STOCK NUMBER			
80205	NAS1397P6N	5340-00-964-2555		15	92
80205	NAS620C3L	5310-00-970-4841		17	6
80205	NAS620C4	5310-00-057-0573		18	7
80205	NAS671-6	5310-00-631-1294		5	36
80205	NAS671C4	5310-00-208-3786		6	42
				8	36
				10	21
				12	34
				14	30
80205	NAS671C6	5310-00-616-8660		6	38
04879	PHX-291			1	10
81349	RCR05G10R0JS			5	24
81349	RCR05G100JS	5905-00-255-3699		6	26
81349	RCR05G101JS	5905-00-180-8301		7	22
				13	7
				14	9
81349	RCR05G102JS	5905-00-458-9500		6	27
				7	13
				8	14
				9	8
				10	9
				11	13
				12	15
				13	9
				14	11
81349	RCR05G103JS	5905-01-035-5065		7	11
				8	12
				13	6
				14	8
81349	RCR05G104JS	5905-00-458-9346		7	19
				8	19
81349	RCR05G106JS	5905-00-483-0407		13	8
				14	10
81349	RCR05G151JS	5905-00-470-0369		11	8
				12	10
81349	RCR05G152JS	5905-00-180-8303		7	21
				8	20
81349	RCR05G163JS	5905-00-468-2937		12	17
81349	RCR05G202JS	5905-00-470-9481		9	7
				10	8
				11	12
				12	12
81349	RCR05G203JS	5905-00-413-1200		12	13
81349	RCR05G221JS	5905-00-177-7486		7	12
				8	13
81349	RCR05G222JS	5905-00-401-7424		5	16
				6	18
				7	17
				8	16
81349	RCR05G223JS	5905-00-403-8837		5	20
				6	22

## NATIONAL STOCK NUMBER AND PART NUMBER INDEX

FSCM	PART NUMBER	PART NUMBER INDEX		FIG.	ITEM
		STOCK NUMBER			
81349	RCR05G272JS	5905-00-401-7426		5	21
				6	23
				7	14
				8	17
				11	9
81349	RCR05G331JS	5905-00-489-7703		5	17
				6	19
				9	9
81349	RCR05G332JS	5905-00-401-7427		7	18
				8	18
				12	14
81349	RCR05G362JS	5905-00-479-6658		9	6
				10	7
				11	11
				12	11
				12	11
81349	RCR05G471JS	5905-00-761-5758		7	23
81349	RCR05G472JS	5905-00-617-5091		5	19
				6	21
				7	16
				8	15
				5	22
81349	RCR05G562JS	5905-00-411-1851		6	24
81349	RCR05G563JS	5905-00-412-0760		7	15
				11	10
81349	RCR05G683JS	5905-00-466-1217		7	20
81349	RCR05G821JS	5905-00-401-7431		5	18
				6	20
81349	RCR07G392JS	5905-00-141-0743		5	10
81349	RCR07G4R7JS	5905-00-246-9393		6	12
				5	14
				6	16
				11	14
				12	16
81349	RCR20G105JS	5905-00-104-5756		15	84
81349	RCR20G160JS	5905-00-465-0337		5	9
				6	11
81349	RLR07C2321GP			5	13
81349	RLR07C5761GP			6	15
				5	15
81349	RWR74S22R6FP			6	17
				5	11
81349	RWR89S1000FR	5905-00-409-3415		6	13
				5	23
				6	25
81349	RWR89S3R74FP			5	12
				6	14
01295	SNJ54166J-00	5962-01-076-7882		12	28
01295	SNJ54221J	5962-01-077-8819		8	31
				12	18
01295	SN54S289J			14	20
06383	TM1S4	1430-01-019-7873		16	13

## NATIONAL STOCK NUMBER AND PART NUMBER INDEX

FSCM	PART NUMBER	PART NUMBER INDEX	
		STOCK NUMBER	FIG. ITEM
08289	TW096-136-100	5970-00-476-7827	17 3
81348	W-C-596/13-3	5935-01-005-3579	3 4
10400	WTFF125	1220-01-018-9976	18 8
98376	ZSP6-037-4	4820-00-898-3003	1 2
98230	0N089558-2	5999-00-432-9512	4 9
98230	0N089563	5935-00-432-9520	4 11
28817	07-0501-3031		15 78
28817	07-0501-3032		15 59
28817	07-0501-3033		15 62
87034	08-83283	6210-00-403-5902	15 23
98278	086-0345-00DI		2 1
18876	10034401-10	5340-01-189-0191	15 54
			15 74
18876	10034401-8	5340-00-815-2538	15 55
			15 72
18876	10101367-3	5940-00-636-7892	5 31
			6 33
			16 21
07047	10381-DAP	5999-00-472-3494	13 24
			14 26
09152	10889		16 25
18876	11509858		15 29
18876	11509861	5895-01-044-0343	1 25
18876	11509862		1 21
18876	11509865		1 20
18876	11509868		1 18
18876	11509871		1 17
18876	11509874		1 16
18876	11509889		16 1
18876	11509891		15 25
18876	11509892		17 8
18876	11509893		15 45
18876	11509894		15 82
18876	11509902		15 39
18876	11509915		16 24
18876	11509923		15 69
18876	11509924		18 9
18876	11509926		15 58
18876	11509927		17 9
18876	11509930		15 20
18876	11509933		15 61
18876	11567494		1 11
18876	11567503		15 40
18876	11567515		1 15
18876	11567516		1 22
18876	11567546		1 24
18876	13012414		15 26
18876	13012415		16 7
18876	13012416		16 2
18876	13012421		16 12
18876	13012422		16 20



## NATIONAL STOCK NUMBER AND PART NUMBER INDEX

FSCM	PART NUMBER	PART NUMBER INDEX	
		STOCK NUMBER	FIG. ITEM
18876	13056527		7 40
18876	13056528		9 25
18876	13056529		11 33
18876	13056530		13 30
18876	13056558		16 4
18876	13056559		16 3
18876	13056561		16 9
18876	13056574		5 43
18876	13143973		18 9
18876	13143974		15 69
18876	13143976		1 21
18876	13143977		6 43
18876	13143979		1 20
18876	13143980		8 37
18876	13143982		1 18
18876	13143983		10 22
18876	13143985		1 17
18876	13143986		12 35
18876	13143988		1 16
18876	13143989		14 31
18876	13143990-1		15 68
18876	13143990-2		15 66
18876	13143992		1 23
18876	13149901		1 11
18876	13149902		15 67
18876	13149903		15 65
71286	15R1-1AE	5325-00-065-5952	15 43
71286	15S1-3-1-1AF		15 41
71286	15S11-2AE	5310-00-942-5139	15 42
45413	154251		1 5
45413	154252		1 3
45413	154273		4 10
45413	154279		4 6
45413	154324		4 5
10001	2859485A-6		5 40
10001	2859485A-7		5 39
			7 34
			9 19
			11 27
14283	6200-014-002		15 18
15786	81487-4	5340-00-782-8737	1 31
			15 51
76854	83250-81 WT	6210-01-046-5550	15 6
76854	83250-82 WT	6210-01-046-5548	15 3
76854	83250-83 WT	6210-01-046-5549	15 22
94222	90-0-5858-24	5320-00-734-4603	5 38
			6 40
			7 36
			8 34
			9 21
			10 19

## NATIONAL STOCK NUMBER AND PART NUMBER INDEX

FSCM	PART NUMBER	PART NUMBER INDEX STOCK NUMBER	FIG.	ITEM
94222	90-0-5858-24	5320-00-734-4603	11	29
			12	32
			13	26
			14	28
94222	90-0-6503-11	5340-00-794-2490	5	37
			6	39
			7	35
			8	33
			9	20
			10	18
			11	28
			12	31
			13	25
			14	27
31461	900-414		4	16

By Order of the Secretary of the Army:

**JOHN A. WICKHAM JR.**  
*General, United States Army*  
*Chief of Staff*

Official:

**DONALD J. DELANDRO**  
*Brigadier General, United States Army*  
*The Adjutant General!*

DISTRIBUTION:

To be distributed in accordance with DA Form 12-32 literature requirements for STINGER.

RECOMMENDED CHANGES TO EQUIPMENT TECHNICAL PUBLICATIONS



THEN... JOT DOWN THE DOPE ABOUT IT ON THIS FORM. CAREFULLY TEAR IT OUT. FOLD IT AND DROP IT IN THE MAIL!

SOMETHING WRONG WITH THIS PUBLICATION?

FROM: (PRINT YOUR UNIT'S COMPLETE ADDRESS)  
 Commander  
 Stateside Army Depot  
 ATTN: AMSTA-US  
 Stateside, N.J. 07703-5007

DATE SENT  
 10 July 1975

PUBLICATION NUMBER TM 11-5840-340-20P	PUBLICATION DATE 23 Jan 78	PUBLICATION TITLE Radar Set AN/PRC-76
--	-------------------------------	--

BE EXACT . . . PIN-POINT WHERE IT IS				IN THIS SPACE TELL WHAT IS WRONG AND WHAT SHOULD BE DONE ABOUT IT:
PAGE NO	PARA-GRAPH	FIGURE NO	TABLE NO	
33				For item 2, change the NSN to read: 5835-00-134-9186. Reason: Accuracy.
44		19		Identify the cover on the junction box (item no. 5). Reason: It is a separate item and is not called out on figure 19.
45				Add the cover of the junction box as an item in the listing for figure 19. Reason: Same as above

EXAMPLE

PRINTED NAME, GRADE OR TITLE AND TELEPHONE NUMBER  
 SSG I. M. DeSpirit of 999-1776

SIGN HERE

TEAR ALONG PERFORATED LINE

FILL IN YOUR  
UNIT'S ADDRESS

FOLD BACK

DEPARTMENT OF THE ARMY

\_\_\_\_\_  
\_\_\_\_\_

POSTAGE AND FEES PAID  
DEPARTMENT OF THE ARMY  
DOD 314



OFFICIAL BUSINESS  
PENALTY FOR PRIVATE USE \$300

**SAMPLE**

Commander  
US Army Communications-Electronics Command  
and Fort Monmouth  
ATTN: AMSEL-ME-MP  
Fort Monmouth, New Jersey 07703-5007

TEAR ALONG PERFORATED LINE



FILL IN YOUR  
UNIT'S ADDRESS

FOLD BACK

DEPARTMENT OF THE ARMY

\_\_\_\_\_  
\_\_\_\_\_

OFFICIAL BUSINESS  
PENALTY FOR PRIVATE USE \$300

POSTAGE AND FEES PAID  
DEPARTMENT OF THE ARMY  
DOD 314



TEAR ALONG PERFORATED LINE

Commander  
US Army Communications-Electronics Command  
and Fort Monmouth  
ATTN: AMSEL-ME-MP  
Fort Monmouth, New Jersey 07703-5007





This fine document...

Was brought to you by me:



## [Liberated Manuals -- free army and government manuals](#)

Why do I do it? I am tired of sleazy CD-ROM sellers, who take publicly available information, slap “watermarks” and other junk on it, and sell it. Those masters of search engine manipulation make sure that their sites that sell free information, come up first in search engines. They did not create it... They did not even scan it... Why should they get your money? Why are not letting you give those free manuals to your friends?

I am setting this document FREE. This document was made by the US Government and is NOT protected by Copyright. Feel free to share, republish, sell and so on.

I am not asking you for donations, fees or handouts. If you can, please provide a link to [liberatedmanuals.com](http://liberatedmanuals.com), so that free manuals come up first in search engines:

<A HREF=<http://www.liberatedmanuals.com/>>Free Military and Government Manuals</A>

- Sincerely  
Igor Chudov  
<http://igor.chudov.com/>
- [Chicago Machinery Movers](#)